



Gruvlok Fire Products

Effective Date: 05/03/2021 | Replaces Prior Date: 01/04/2021 | Sheet # GR.FP-5.21

FREIGHT ALLOWANCE:

Freight terms are F.O.B. point of shipment.

Product Line	Standard Terms	General Service Product Combined Terms	Sharpe High-Performance Combined Terms
Pipe Fittings	\$ 2,500	\$ 2,500	\$ 5,000
Pipe Nipples, Pipe & Tubing	\$ 2,500		
Grooved	\$ 2,500		
High-Pressure Fittings	\$ 2,500		
Press Products	\$ 2,500		
O-Lets	\$ 2,500		
FPPI	\$ 2,500		
Flexhead	\$ 2,500		
Pipe Hangers	\$ 2,500		
Strut & Strut Fittings	\$ 2,500		
Seismic (Afcon)	\$ 2,500		
SCI Valves	\$ 2,500		
Sharpe General Service Valves	\$ 2,500		
Sharpe High-performance Valves	\$ 5,000		
Sharpe Engineered Valves	\$ 5,000		
Sharpe Actuation Products	\$ 5,000		

If multiple products are combined on one order, the combined prepaid freight level will default to the highest product line value. For example, when pipe fittings are combined with Sharpe High-performance Valves, the order's combined prepaid freight terms will be \$5,000.

NOTE:

All orders are accepted on the basis of prices in effect at the time of shipment.

NOTICE:

To the prices and terms quoted, there will be added any manufacturers or sales tax payable on the transaction under any effective statute.

GENERAL

- UPC numbers are available upon request.
- To obtain current ISO certifications, listings, and other approvals, visit ASC's website at www.asc-es.com
- Pricing is subject to change without notice.

LOSS OR DAMAGE CLAIMS:

All goods are shipped at buyer's risk. Shipments should be carefully examined upon delivery and before the carrier's delivery receipt is signed. If any loss or damage is evident, the buyer should make an appropriate notation on the delivery receipt and insist that the carrier's driver initial such exception. The contents of all packages should be carefully examined for concealed damage as soon as possible after delivery, so that the carrier can be requested, within 48 hours after delivery, to arrange for prompt inspection of the damaged goods.

1. CONTROLLING PROVISIONS:

These terms and conditions shall control with respect to any purchase order or sale of Seller's products. No waiver, alteration or modification of these terms and conditions whether on Buyer's purchase order or otherwise shall be valid unless the waiver, alteration or modification is specifically accepted in writing and signed by an authorized representative of Seller.

2. DELIVERY:

Seller will make every effort to complete delivery of products as indicated on Seller's acceptance of an order, but Seller assumes no responsibility or liability, and will accept no backcharge, for loss or damage due to delay or inability to deliver caused by acts of God, war, labor difficulties, accident, delays of carriers, by contractors or suppliers, inability to obtain materials, shortages of fuel and energy, or any other causes of any kind whatever beyond the control of Seller. Seller may terminate any contract of sale of its products without liability of any nature, by written notice to Buyer, in the event that the delay in delivery or performance resulting from any of the aforesaid causes shall continue for a period of sixty (60) days. Under no circumstances shall Seller be liable for any special or consequential damages or for loss, damage, or expense (whether or not based on negligence) directly or indirectly arising from delays or failure to give notice of delay.

3. WARRANTY:

Seller warrants for one year from the date of shipment Seller's manufactured products to the extent that Seller will replace those having defects in material or workmanship when used for the purpose and in the manner which Seller recommends. If Seller examination shall disclose to its satisfaction that the products are defective, and an adjustment is required, the amount of such adjustment shall not exceed the net sales price of the defective products only and no allowance will be made for labor or expense of repairing or replacing defective products or workmanship of damage resulting from the same. Seller warrants the products which it sells of other manufacturers to the extent of the warranties of their respective makers. Where engineering design or fabrication work is supplied. Buyer's acceptance of Seller's design or of delivery of work shall relieve Seller of all further obligation, other than expressed in Seller's product warranty. THIS IS SELLER'S SOLE WARRANTY. SELLER MAKES NO OTHER WARRANTY OF ANY KIND, EXPRESSED OR IMPLIED AND ALL IMPLIED WARRANTIES OF MERCHANTABILITY AND FOR A PARTICULAR PURPOSE WHICH EXCEED SELLER'S AFORESTATED OBLIGATION ARE HEREBY DISCLAIMED BY SELLER AND EXCLUDED FROM THIS WARRANTY. Seller neither assumes, nor authorizes any person to assume for it, any other obligation in connection with the sale of its engineering designs or products. This warranty shall not apply to any products or parts of products which (a) have been repaired or altered outside of Seller's factory, in any manner; (b) have been subjected to misuse, negligence or accidents; (c) have been used in a manner contrary to Seller's instructions or recommendations. Seller shall not be responsible for design errors due to inaccurate or incomplete information supplied by Buyer or its representatives.

4. SELLER'S LIABILITY:

Seller will not be liable for any loss, damage, cost of repairs, incidental or consequential damages of any kind, whether based upon warranty (except for the obligation accepted by Seller under "Warranty" above), contract or negligence, arising in connection with the design, manufacture, sale, use or repair of the products or of the engineering designs supplied to Buyer.

5. RETURNS:

Seller cannot accept return of any products unless its written permission has been first obtained, in which case same will be credited subject to the following (a) All material returned must, on its arrival at Seller's Plant, be found to be in first-class condition; if not, cost of putting in saleable condition will be deducted from credit memoranda; (b) A handling charge deduction of twenty percent (20%) will be made from all credit memoranda issued for material returned; (c) Transportation charges, if not prepaid will be deducted from credit memoranda.

6. SHIPMENTS:

All products sent out will be carefully examined, counted and packed. The cost of any special packing or special handling caused by Buyer's requirements or requests shall be added to the amount of the order. No claim for shortages will be allowed unless made in writing within ten (10) days of receipt of a shipment.

Claims for products damaged or lost in transit should be made on the carrier, as Seller's responsibility ceases, and title passes, on delivery to the carrier.

7. SPECIAL PRODUCTS:

Orders covering special or nonstandard products are not subject to cancellation except on such terms as Seller may specify on application.

8. PRICES AND DESIGNS:

Prices and designs are subject to change without notice. All prices are F.O.B. Point of shipment, unless otherwise stated.

9. TAXES:

The amount of any sales, excise or other taxes, if any, applicable to the products covered by this order, shall be paid by Buyer unless Buyer provides Seller with an exemption certificate acceptance to the taxing authorities.

10. NUCLEAR PLANTS:

Where the products, engineering design or fabrication is for nuclear plant applications. Buyer agrees (a) to take all necessary steps to add Seller as an insured under the American Nuclear Insurers' (ANI) pool and under the Mutual Atomic Energy Reinsurance Pool (MAERP) for property damage and liability insurance and if necessary steps could have been taken, but are not taken, Buyer shall hold Seller harmless against all such losses which could have been thus covered (b) Buyer agrees to hold Seller harmless with respect to any personal injury (or death), property damage or other loss in a nuclear incident which is caused directly or indirectly by defective design, material, workmanship furnished by Buyer (or which could be so covered but with respect to which Buyer has elected to self-insure), and further agrees to waive subrogation by its carriers of such insurance against Seller, and (c) as to nuclear hazards for which Buyer cannot obtain insurance coverage, the liability of Seller for any personal injury (or death), property damage or other loss directly caused by defective design, material, or workmanship furnished by Seller shall not exceed the value at the time of the loss occurrence.

11. MINIMUM INVOICE:

Domestic: \$100 plus transportation.
 International: \$500 plus transportation.

12. TERMS:

Cash, net 30 days unless otherwise specified.

NOTE: All orders are accepted on the basis of prices in effect at the time of shipment.

NOTICE: The prices and terms quoted, there will be added any manufacturers or sales tax payable on the transaction under any effective statute.

FREIGHT ALLOWANCE: Freight terms are F.O.B. point of shipment.

Product Line	Standard Terms	General Service Product Combined Terms	Sharpe High-Performance Combined Terms
Pipe Fittings	\$ 2,500		
Pipe Nipples, Pipe & Tubing	\$ 2,500		
Grooved	\$ 2,500		
High-Pressure Fittings	\$ 2,500		
Press Products	\$ 2,500		
O-Lets	\$ 2,500		
FPPI	\$ 2,500	\$ 2,500	
Flexhead	\$ 2,500		\$ 5,000
Pipe Hangers	\$ 2,500		
Strut & Strut Fittings	\$ 2,500		
Seismic (Afcon)	\$ 2,500		
SCI Valves	\$ 2,500		
Sharpe General Service Valves	\$ 2,500		
Sharpe High-performance Valves	\$ 5,000		
Sharpe Engineered Valves	\$ 5,000		
Sharpe Actuation Products	\$ 5,000		

If multiple products are combined on one order, the combined prepaid freight level will default to the highest product line value. For example, when pipe fittings are combined with Sharpe High-Performance Valves, the order's combined prepaid freight terms will be \$5,000.

Table of Contents

Lightweight Flexible Coupling Fig. 7000†	4
Reducing Coupling Fig. 7010† (Coupling Complete “E” Gasket)	5
Gruvlok Flange Fig. 7012† (Coupling Complete “E” Gasket)	5
Rigidlite® Coupling Fig. 7400†	6
Standard Tees Fig. 7060S† for Fire Protection Fitting	7
Standpipe Tees Fig. 7065	7
Bullhead Tees Fig. 7062 for Fire Protection Fitting	8
Cap Fig. 7074†	9
Fire-Rite Tees Fig. 7460† Short Pattern Fitting	9
Fire-Rite 90° Elbows Fig. 7450† Short Pattern Fitting for Fire Protection	10
Concentric Reducer Fig. 7072, Groove by Groove (Gr x Gr)	11
Concentric Reducer Fig. 7076, Groove by Thread (Gr x Thd)	12
Mechanical Tee Products Clamp-T®, Fig. 7046 Grooved Outlet	13
Mechanical Tee Products Clamp-T®, Fig. 7045 with Female Threaded Outlet	14
Mechanical Tee Products Clamp-T® Cross, Fig. 7047	16
Mechanical Tee Products Clamp-T® Cross, Fig. 7048	18
Mechanical Tee Products Clamp-T® Cross, Fig. 7049	19
Steel Cross Fig. 7068	20
LUBRICANTS	20
Standard 90° Elbows Fig. 7050S† for Fire Protection	21
90° Drain Elbows Fig. 7050DR	22
Standard 45° Elbows Fig. 7051† for Fire Protection	22
Sock-It® 90° Straight Elbow Fig. 7100	23
Sock-It® Straight Tee Fig. 7103	24
Sock-It® Reducing Elbow Fig. 7101	24
Sock-It® Reducing Outlet Tee Fig. 7105	25
Sock-It® Reducing Run Outlet Tee Fig. 7106	26
Sock-It® Coupling Fig. 7107	27
For use with Fig. 7000 and 7400 Coupling	27
Reducing Coupling Fig. 7010 (Grade “E” Gasket) Loose	0
For use with Fig. FP7012 (Grade “E” Gasket)	27

Domestic Fire Products

Lightweight Flexible Coupling Fig. 7000†

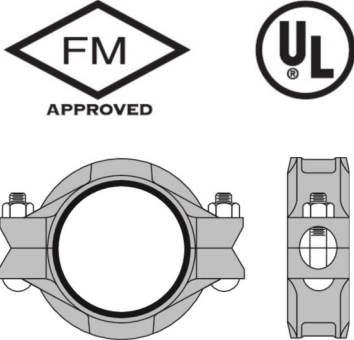

Nominal Pipe Size (in)	Approx Weight EACH (lbs)	COUPLING COMPLETE WITH PRE-LUBRICATED GRADE E GASKET (TYPE A)				COUPLING COMPLETE WITH GRADE E FLUSH GAP™ GASKET			
		Painted		Galvanized		Painted		Galvanized	
		ITEM#	Price Ea	ITEM#	Price Ea	ITEM#	Price Ea	ITEM#	Price Ea
1 ¼	1.35	1605005980	\$74.600	1605105988	\$95.190	1605006269	\$119.630	1605106465	\$144.710
1 ½	1.39	1605005998	\$89.390	1605105996	\$112.550	1605006277	\$133.770	1605106473	\$158.220
2	2.03	1605006004	\$92.620	1605106002	\$115.760	1605006285	\$136.990	1605106481	\$162.720
2 ½	2.29	1605006053	\$105.470	1605106101	\$133.770	1605006293	\$162.720	1605106499	\$192.310
3	3.04	1605006103	\$122.210	1605106200	\$154.360	1605006301	\$173.650	1605106507	\$208.390
4	4.57	1605006152	\$170.440	1605106309	\$222.530	1605006319	\$246.320	1605106515	\$300.990
5	6.13	1605006186	\$245.030	1605106358	\$313.860	1605006327	\$421.270	1605106523	\$504.230
6	8.89	1605006202	\$294.560	1605106408	\$382.030	1605006335	\$465.650	1605106531	\$562.750
8	14.00	1605006210	\$460.500	1605106416	\$613.560	1605006343	\$600.700	1605106549	\$760.850

All bolts are oval-neck track head design to ASTM A-183, with heavy hex nuts to ASTM A-563, and are zinc plated to ASTM B-633. Two bolts per coupling. Spare parts available on page 12.

†When ordering, refer to product as FP7000.

Reducing Coupling Fig. 7010† (Coupling Complete "E" Gasket)

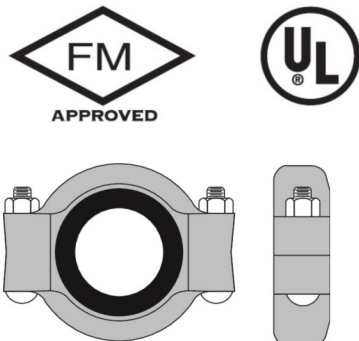

Approx Weight EACH (lbs)	Size 1	Size 2	Painted		Galvanized	
			ITEM#	Price Ea	ITEM#	Price Ea
3.13	2	1 ½	0390009280	\$152.430	0390111581	\$184.590
3.57	2 ½	2	0390009306	\$198.090	0390111607	\$246.320
4.30	3	2	0390009348	\$223.820	0390111649	\$282.990
4.12	3	2 ½	0390009389	\$194.880	0390111680	\$246.320

Reducing Coupling Fig. 7010† (Coupling Complete “E” Gasket)

Approx Weight EACH (lbs)	Size 1	Size 2	Painted		Galvanized	
			ITEM#	Price Ea	ITEM#	Price Ea
7.60	4	2	0390009421	\$353.730	0390111722	\$444.420
7.37	4	2 ½	0390009439	\$316.430	0390111730	\$416.110
6.61	4	3	0390009447	\$297.780	0390111748	\$382.670
11.40	5	4	0390009488	\$398.750	0390111789	\$521.590
13.35	6	4	0390009520	\$598.760	0390111821	\$753.770
13.41	6	5	0390009546	\$525.450	0390111847	\$679.810
17.81	8	6	0390009645	\$893.980	0390111946	\$1,130.660

All bolts are oval-neck track head design to ASTM A-183, with heavy hex nuts to ASTM A-563, and are zinc plated to ASTM B-633. Spare parts available on page 12.

†When ordering, refer to product as FP7010.

Gruvlok Flange Fig. 7012† (Coupling Complete “E” Gasket)

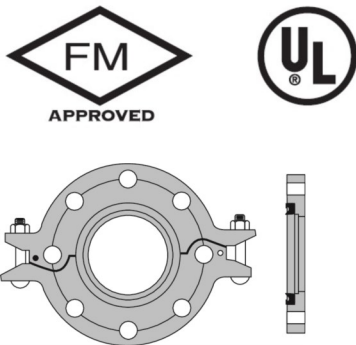

Nominal Pipe Size (in)	Approx Weight EACH (lbs)	Gruvlok Flange Fig. 7012† (Coupling Complete “E” Gasket)			
		Painted		Galvanized	
		ITEM#	Price Ea	ITEM#	Price Ea
2*	4.05	1605006723	\$329.940	1605106622	\$381.390
2 ½	4.68	1605006731	\$383.950	1605106630	\$455.990
3*	5.94	1605006749	\$432.190	1605106648	\$518.370
4*	6.51	1605006756	\$562.120	1605106655	\$684.960
5	8.87	1605006764	\$674.020	1605106663	\$820.650
6*	9.53	1605006772	\$735.120	1605106671	\$893.330
8*	15.32	1605006780	\$922.270	1605106689	\$1,153.160

The Gruvlok Flange bolt hole pattern conforms to ANSI Class 150 and Class 125 flanges. Gruvlok Flange adapter insert required when mating to rubber surfaces or serrated faced mating flanges. Refer to Gruvlok Products Catalog or Anvil's Web site for more information on installing this flange. Mating flange bolts must be at least intermediate strength bolting per ASME B16.5. Bolts with material properties equal to or greater than SAE J429 Grade 5 are acceptable.

†When ordering, refer to product as FP7012.

Rigidlite® Coupling Fig. 7400†

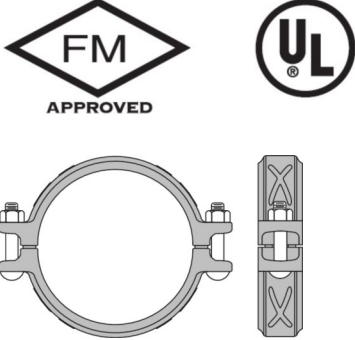

Nominal Pipe Size (in)	Approx Weight EACH (lbs)	COUPLING COMPLETE WITH PRE-LUBRICATED GRADE E GASKET (TYPE A)				COUPLING COMPLETE WITH GRADE E FLUSH GAP™ GASKET			
		Painted		Galvanized		Painted		Galvanized	
		ITEM#	Price Ea	ITEM#	Price Ea	ITEM#	Price Ea	ITEM#	Price Ea
1 ¼	1.30	1605012283	\$69.460	1605111986	\$82.970	1605013018	\$103.550	1605112919	\$117.060
1 ½	1.40	1605012291	\$70.100	1605111994	\$84.900	1605013026	\$111.270	1605112927	\$127.980
2	1.60	1605012309	\$79.110	1605112000	\$94.540	1605013034	\$118.970	1605112935	\$137.630
2 ½	1.90	1605012358	\$90.050	1605112109	\$109.340	1605013042	\$140.850	1605112943	\$163.360
3	2.10	1605012408	\$104.830	1605112208	\$126.700	1605013059	\$151.790	1605112950	\$177.510
4	3.10	1605012457	\$147.280	1605112307	\$177.510	1605013067	\$214.810	1605112968	\$249.550
5	4.60	1605012481	\$209.670	1605112356	\$264.340	1605013091	\$360.810	1605112992	\$417.410
6	5.50	1605012507	\$252.110	1605112406	\$306.770	1605013075	\$400.030	1605112976	\$466.280
8	8.40	1605012515	\$421.900	1605112414	\$513.240	1605013083	\$647.650	1605112984	\$750.550

All bolts are oval-neck track head design to ASTM A-183, with heavy hex nuts to ASTM A-563, and are zinc plated to ASTM B-633. Two bolts per coupling. Spare parts available on page 12.

†When ordering, refer to product as FP7400.

Standard Tees Fig. 7060S† for Fire Protection Fitting

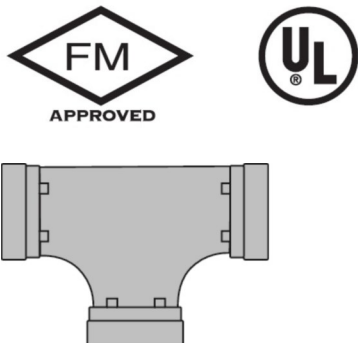

Nominal Pipe Size (in)	Approx Weight EACH (lbs)	Standard Tees Fig. 7060S† for Fire Protection Fitting			
		Painted		Galvanized	
		ITEM#	Price Ea	ITEM#	Price Ea
1 ¼	1.50	1605008232	\$112.550	1605107943	\$151.130
1 ½	1.80	1605008240	\$112.550	1605107950	\$151.130
2	2.32	1605008307	\$112.550	1605108008	\$151.130
2 ½	3.93	1605008356	\$151.790	1605108107	\$207.090

Standard Tees Fig. 7060S† for Fire Protection Fitting

Nominal Pipe Size (in)	Approx Weight EACH (lbs)	Standard Tees Fig. 7060S† for Fire Protection Fitting			
		Painted		Galvanized	
		ITEM#	Price Ea	ITEM#	Price Ea
3	5.65	1605008406	\$210.960	1605108206	\$290.060
4	10.50	1605008455	\$322.220	1605108305	\$446.360
5	16.40	1605008497	\$748.630	1605108354	\$999.450
6	25.73	1605008505	\$864.400	1605108404	\$1,202.050
8	41.10	1605008521	\$1,840.050	1605108412	\$2,589.950

†When ordering, refer to product as FP7060S.

Standpipe Tees Fig. 7065

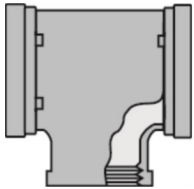

Approx Weight EACH (lbs)	Size 1	Size 2	Size 3	Standpipe Tees Fig. 7065			
				Painted		Galvanized	
				ITEM#	Price Ea	ITEM#	Price Ea
7.60	4	4	2 ½	0390021608	\$608.420	0390123388	\$774.350
11.20	6	6	2 ½	0390021624	\$905.560	0390123776	\$1,127.450

* Fabricated steel.

Additional sizes quoted on application.

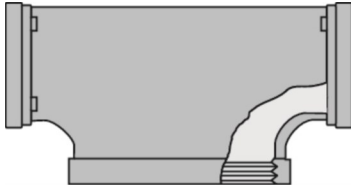
Bullhead Tees Fig. 7062 for Fire Protection Fitting

Approx Weight EACH (lbs)	Size 1	Size 2	Size 3	Painted			
				Painted		Galvanized	
				ITEM#	Price Ea	ITEM#	Price Ea
31.00	5	5	8	0390019966	\$3,270.410	0390121564	\$4,121.940
37.60	6	6	8	0390019974	\$3,739.270	0390121572	\$4,623.590

* Fabricated steel.

Additional sizes quoted on application.

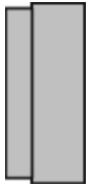
Cap Fig. 7074†

Nominal Pipe Size (in)	Approx Weight EACH (lbs)	Cap Fig. 7074†			
		Painted		Galvanized	
		ITEM#	Price Ea	ITEM#	Price Ea
1	0.01	1605009321	\$36.670	1605108909	\$57.240
1 ¼	0.50	1605009370	\$36.670	1605108917	\$57.240
1 ½	0.50	1605009388	\$38.580	1605108925	\$57.240
2	0.50	1605009396	\$46.300	1605108933	\$62.380
2 ½	0.70	1605009404	\$52.750	1605108941	\$67.530
3	1.10	1605009412	\$63.040	1605108958	\$81.040
4	2.80	1605009420	\$92.620	1605108966	\$126.700
5	4.00	1605009438	\$185.870	1605108974	\$252.760
6	6.00	1605009446	\$207.090	1605108982	\$284.910

Cap Fig. 7074†

Nominal Pipe Size (in)	Approx Weight EACH (lbs)	Cap Fig. 7074†			
		Painted		Galvanized	
		ITEM#	Price Ea	ITEM#	Price Ea
8	0.01	1605009453	\$391.680	1605108990	\$535.750

†When ordering, refer to product as FP7074.

Fire-Rite Tees Fig. 7460† Short Pattern Fitting

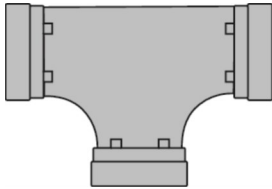

Nominal Pipe Size (in)	Approx Weight EACH (lbs)	Fire-Rite Tees Fig. 7460† Short Pattern Fitting			
		Painted		Galvanized	
		ITEM#	Price Ea	ITEM#	Price Ea
2	2.34	1605202686	\$102.260	1605204427	\$127.350
2 ½	3.56	1605202702	\$133.770	1605204435	\$170.440
3	4.71	1605202728	\$185.870	1605204443	\$237.970
4	7.90	1605202744	\$281.060	1605204450	\$364.660
6	19.45	1605202769	\$742.840	1605204476	\$969.870
8	38.00	1605202785	\$1,578.290	1605204492	\$2,084.450

†When ordering, refer to product as FP7460.

Fire-Rite 90° Elbows Fig. 7450† Short Pattern Fitting for Fire Protection

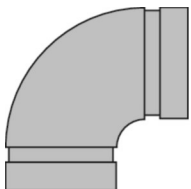

Nominal Pipe Size (in)	Approx Weight EACH (lbs)	Fire-Rite 90° Elbows Fig. 7450† Short Pattern Fitting for Fire Protection			
		Painted		Galvanized	
		ITEM#	Price Ea	ITEM#	Price Ea
2	1.66	1605202405	\$67.530	1605203783	\$86.820
2 ½	2.48	1605202421	\$90.050	1605203791	\$120.910
3	3.45	1605202447	\$117.060	1605203809	\$155.640

Fire-Rite 90° Elbows Fig. 7450† Short Pattern Fitting for Fire Protection

Nominal Pipe Size (in)	Approx Weight EACH (lbs)	Fire-Rite 90° Elbows Fig. 7450† Short Pattern Fitting for Fire Protection			
		Painted		Galvanized	
		ITEM#	Price Ea	ITEM#	Price Ea
4	5.51	1605202462	\$167.860	1605203817	\$231.530
6	14.30	1605202488	\$461.780	1605203833	\$634.150
8	25.56	1605202504	\$899.770	1605203841	\$1,279.870

†When ordering, refer to product as FP7450.

Concentric Reducer Fig. 7072, Groove by Groove (Gr x Gr)

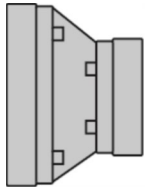

(Cast)

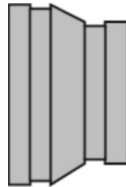

(Weld)

Nominal Run Size (in)	Outlet Size (in)	Approx Weight EACH (lbs)	Painted		Galvanized	
			ITEM#	Price Ea	ITEM#	Price Ea
1 ¼	1*	0.60	0390028199	\$632.850	0390130094	\$695.890
1 ½	1*	0.60	0390028264	\$158.850	0390130102	\$186.520
1 ½	1 ¼*	0.60	0390028272	\$158.850	0390130110	\$186.520
2	1*	0.66	0390028330	\$158.850	0390130177	\$186.520
2	1 ¼	0.75	0390028348	\$173.650	0390130185	\$202.600
2	1 ½	0.75	0390028355	\$158.850	0390130193	\$186.520
2 ½	1 ¼*	1.00	0390028363	\$158.850	0390130250	\$186.520
2 ½	1*	1.00	0390028371	\$215.460	0390130219	\$247.610
2 ½	1 ½*	1.30	0390028389	\$158.850	0390130227	\$186.520
3	1*	1.20	0390028405	\$173.650	0390130243	\$201.940
2 ½	2	1.10	0390028413	\$158.850	0390130235	\$186.520
3	1 ½*	1.30	0390028439	\$190.380	0390130276	\$231.530
3	2	1.40	0390028447	\$140.850	0390130284	\$170.440
3	1 ¼*	1.30	0390028454	\$275.270	0390130268	\$317.070
3	2 ½*	1.58	0390028462	\$190.380	0390130300	\$229.610
3 ½	3*	1.50	0390028546	\$201.940	0390130383	\$243.110
4	1	2.20	0390028587	\$209.670	0390130425	\$257.260
4	1 ¼*	2.20	0390028595	\$1,591.160	0390130433	\$1,783.460
4	1 ½*	2.30	0390028603	\$409.040	0390130441	\$450.850
4	2	2.34	0390028629	\$186.520	0390130466	\$228.310
4	2 ½	2.41	0390028645	\$229.610	0390130482	\$279.130
4	3	2.68	0390028660	\$229.610	0390130508	\$279.130
4	3 ½	3.60	0390028686	\$229.610	0390130524	\$279.130
5	2	4.60	0390028694	\$2,237.510	0390130607	\$2,470.980
5	2 ½*	4.50	0390028751	\$531.240	0390130615	\$578.200
5	3*	4.40	0390028769	\$265.610	0390130631	\$328.010

Concentric Reducer Fig. 7072, Groove by Groove (Gr x Gr)

Nominal Run Size (in)	Outlet Size (in)	Approx Weight EACH (lbs)	Painted		Galvanized	
			ITEM#	Price Ea	ITEM#	Price Ea
5	4	4.50	0390028785	\$315.780	0390130623	\$394.890
6	1*	6.80	0390028843	\$418.040	0390130680	\$520.950
6	1 ½*	6.90	0390028868	\$2,480.630	0390130706	\$2,827.920
6	2	4.70	0390028884	\$418.040	0390130722	\$520.950
6	2 ½*	6.00	0390028892	\$465.000	0390130748	\$571.120
6	3	5.40	0390028926	\$418.040	0390130763	\$520.950
6	4	5.60	0390028967	\$366.600	0390130805	\$472.710
6	5	6.00	0390029007	\$538.960	0390130847	\$668.220
8	3*	12.00	0390029106	\$743.470	0390130946	\$925.490
8	4	10.10	0390029148	\$743.470	0390130987	\$925.490
8	5*	11.50	0390029189	\$743.470	0390131027	\$935.140
8	6	11.60	0390029221	\$942.860	0390131068	\$1,180.170

* Gruvlok fittings are full flow fittings made of ductile iron except those marked (*) which are fabricated steel.

Concentric Reducer Fig. 7076, Groove by Thread (Gr x Thd)

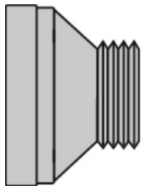

(Weld)

Nominal Run Size (in)	Outlet Size (in)	Approx Weight EACH (lbs)	Painted		Galvanized	
			ITEM#	Price Ea	ITEM#	Price Ea
2 ½	1 ¼*	1.00	0390036978	\$232.820	0390138410	\$286.200
2 ½	1	1.00	0390036994	\$222.530	0390138402	\$255.980
2	¾*	1.00	0390037018	\$165.300	0390137917	\$201.940
2	1	0.80	0390037026	\$165.300	0390137925	\$201.940
2	1 ¼	1.30	0390037034	\$165.300	0390137933	\$201.940
2	1 ½	1.30	0390037042	\$165.300	0390137941	\$201.940
3	1*	1.20	0390037059	\$178.800	0390137958	\$216.100
2 ½	2	1.20	0390037067	\$165.300	0390137883	\$201.940
2 ½	1 ½*	1.30	0390037075	\$243.760	0390137867	\$286.200
3	2*	1.30	0390037083	\$201.940	0390137990	\$241.820
3	1 ½*	1.30	0390037091	\$201.940	0390137974	\$241.820
3	2 ½	1.50	0390037109	\$243.760	0390138022	\$286.200
3	¾*	1.20	0390037117	\$1,171.810	0390137966	\$1,247.060
3	1 ¼	1.40	0390037125	\$201.940	0390137982	\$216.100
4	1*	2.20	0390037133	\$230.890	0390138071	\$279.130

Concentric Reducer Fig. 7076, Groove by Thread (Gr x Thd)

Nominal Run Size (in)	Outlet Size (in)	Approx Weight EACH (lbs)	Painted		Galvanized	
			ITEM#	Price Ea	ITEM#	Price Ea
4	1 ½*	2.30	0390037141	\$537.030	0390138089	\$701.680
4	2*	2.40	0390037158	\$245.030	0390138113	\$293.270
4	2 ½	2.30	0390037174	\$246.320	0390138139	\$301.640
4	3	2.60	0390037182	\$300.990	0390138147	\$355.660
4	1 ¼	2.30	0390037190	\$1,194.970	0390138097	\$1,225.840
1 ½	1	0.60	0390037208	\$165.300	0390137909	\$201.940
5	4	4.50	0390037216	\$1,697.260	0390138220	\$1,845.200
6	1 ¼	6.00	0390037232	\$432.840	0390138378	\$591.060
6	1*	6.00	0390037240	\$465.000	0390138261	\$571.120
6	1 ½*	6.10	0390037257	\$432.840	0390138386	\$591.060
6	2	6.00	0390037265	\$465.000	0390138303	\$571.120
6	3	6.00	0390037281	\$465.000	0390138345	\$571.120
6	4	5.90	0390037307	\$2,786.130	0390138394	\$3,085.180

* Fabricated Steel

Reducer sizes not shown, will be priced on application.

Mechanical Tee Products Clamp-T®, Fig. 7046 Grooved Outlet

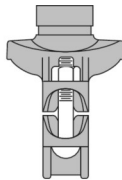
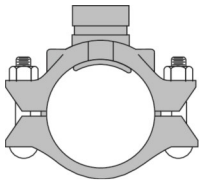

Nominal Run Size (in)	Outlet Size (in)	Approx Weight EACH (lbs)	Painted		Painted		Galvanized	
			ITEM#	Price Ea	ITEM#	Price Ea	ITEM#	Price Ea
2 ½**	1 ¼	2.50	0390173110	\$178.140	-	-	0390177111	\$217.380
2 ½**	1 ½	2.09	0390173128	\$178.140	-	-	0390177129	\$217.380
3	1 ¼	3.80	0390173201	\$185.220	-	-	0390177202	\$231.530
3	1 ½	3.90	0390173219	\$185.220	-	-	0390177210	\$231.530
3	2	4.12	0390173243	\$212.880	-	-	0390177244	\$264.340
4	1 ¼	4.41	0390173334	\$216.100	0390174332	\$216.100	0390177335	\$254.050
4	1 ½	4.23	0390173342	\$223.820	0390174340	\$223.820	0390177343	\$282.340
4	2	4.60	0390173367	\$223.820	-	-	0390177368	\$284.270
4	2 ½	4.68	0390173383	\$233.470	-	-	0390177384	\$302.280
4	3	6.75	0390173417	\$248.900	-	-	0390177418	\$319.000
5	1 ¼	5.70	0390173482	\$268.840	0390174464	\$268.840	0390177483	\$373.660
5	1 ½	5.30	0390173490	\$273.340	0390174498	\$273.340	0390177491	\$358.240

Mechanical Tee Products Clamp-T®, Fig. 7046 Grooved Outlet

Nominal Run Size (in)	Outlet Size (in)	Approx Weight EACH (lbs)	Painted		Painted		Galvanized	
			ITEM#	Price Ea	ITEM#	Price Ea	ITEM#	Price Ea
5	2	6.40	0390173516	\$273.340	0390174514	\$273.340	0390177517	\$346.650
5	2 ½	6.80	0390173532	\$288.140	-	-	0390177533	\$380.740
5	3	8.40	0390173557	\$306.770	0390174555	\$306.770	0390177558	\$393.610
6	1 ¼	7.66	0390173565	\$281.060	0390174563	\$281.060	0390177566	\$358.240
6	1 ½	7.17	0390173615	\$281.060	0390174613	\$281.060	0390177616	\$358.240
6	2	7.13	0390173631	\$281.060	0390174639	\$281.060	0390177632	\$358.240
6	2 ½	7.85	0390173664	\$306.770	-	-	0390177665	\$389.740
6	3	8.37	0390173698	\$319.640	-	-	0390177699	\$412.260
6	4	10.11	0390173755	\$355.020	-	-	0390177756	\$461.780
8	2	11.00	0390173805	\$488.150	-	-	0390177806	\$641.870
8	2 ½	10.58	0390173821	\$488.150	-	-	0390177822	\$615.500
8	3	12.20	0390173847	\$515.160	-	-	0390177848	\$653.440
8	4	13.20	0390173904	\$530.590	-	-	0390177905	\$684.960

Clamp T's are available in Grade E Gasket or Grade T Buna on request.

All bolts and nuts are of track head design and are zinc plated conforming to physical properties of ASTM B-633.

**Clamp-T supplied with U-bolt lower housing.

Mechanical Tee Products Clamp-T®, Fig. 7045 with Female Threaded Outlet

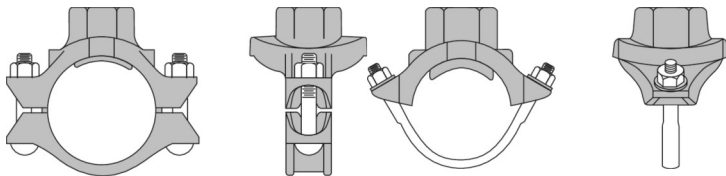

Fig. 7045 (U-Bolt)

Nominal Run Size (in)	Outlet Size (in)	Approx Weight EACH (lbs)	Painted		Galvanized	
			ITEM#	Price Ea	ITEM#	Price Ea
2	½**	2.30	0390171007	\$126.700	0390175008	\$160.140
2	¾**	2.20	0390171015	\$126.700	0390175016	\$160.140
2	1**	2.07	0390171023	\$126.700	0390175024	\$160.140
2	1 ¼**	2.80	0390171031	\$146.640	0390175032	\$181.380
2	1 ½**	2.56	0390171049	\$146.640	0390175040	\$182.650
2 ½	½**	2.60	0390171064	\$126.700	0390175073	\$160.140
2 ½	¾**	2.50	0390171072	\$126.700	0390175081	\$160.140
2 ½	1**	1.81	0390171080	\$126.700	0390175099	\$160.140
2 ½	1 ¼**	2.32	0390171098	\$178.140	0390175115	\$217.380
2 ½	1 ½**	2.14	0390171106	\$178.140	0390175123	\$217.380

Mechanical Tee Products Clamp-T®, Fig. 7045 with Female Threaded Outlet

Nominal Run Size (in)	Outlet Size (in)	Approx Weight EACH (lbs)	Painted		Galvanized	
			ITEM#	Price Ea	ITEM#	Price Ea
3	½**	2.79	0390171122	\$146.640	0390175164	\$178.140
3	¾**	2.75	0390171130	\$146.640	0390175172	\$178.140
3	1**	2.51	0390171148	\$146.640	0390175180	\$178.140
3	1 ¼	4.04	0390171155	\$185.220	0390175206	\$231.530
3	1 ½	3.75	0390171163	\$185.220	0390175214	\$231.530
3	2	4.04	0390171189	\$212.880	0390175248	\$264.340
4	½**	3.21	0390171221	\$184.590	0390175305	\$219.310
4	¾**	3.17	0390171239	\$184.590	0390175313	\$219.310
4	1**	3.03	0390171247	\$184.590	0390175321	\$219.310
4	1 ¼	4.44	0390171254	\$216.100	0390175339	\$254.050
4	1 ½	4.40	0390171262	\$223.820	0390175347	\$282.340
4	2	4.67	0390171288	\$223.820	0390175362	\$284.270
4	2 ½	5.15	0390171304	\$233.470	0390175388	\$302.280
4	3	7.09	0390171320	\$248.900	0390175412	\$319.000
5	1 ¼	6.34	0390171361	\$228.960	0390175420	\$373.020
5	1 ½	6.20	0390171379	\$273.340	0390175495	\$346.650
5	2	6.61	0390171395	\$273.340	0390175511	\$346.650
5	2 ½	7.24	0390171429	\$288.140	0390175537	\$367.240
5	3	8.50	0390171445	\$306.770	0390175552	\$393.610
6	1 ¼	7.04	0390171486	\$234.100	0390175602	\$387.820
6	1 ½	6.86	0390171494	\$280.410	0390175610	\$358.240
6	2	7.31	0390171528	\$281.060	0390175636	\$358.240
6	2 ½	7.80	0390171544	\$301.640	0390175669	\$389.740
6	3	9.60	0390171569	\$319.640	0390175693	\$412.260
6	4	12.98	0390171601	\$355.020	0390175750	\$461.780
8	2***	11.36	0390171700	\$488.150	0390175800	\$615.500
8	2 ½	11.13	0390171726	\$488.150	0390175826	\$615.500
8	3	12.40	0390171767	\$515.160	0390175842	\$653.440
8	4	16.00	0390171825	\$530.590	0390175909	\$684.960

Clamp T's are available with grooved or female threaded outlet with Grade E or Grade T gasket.

Weights are approximate and subject to change.

*All bolts and nuts are of track head design and are zinc plated conforming to physical properties of ASTM B-633.

**Clamp-T supplied with U-bolt lower housing.

***Note: 8 x 2 is actually 8 x 2½ bushed down.

Mechanical Tee Products Clamp-T® Cross, Fig. 7047

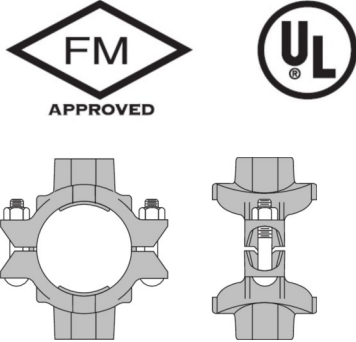

Fig. 7047 — Thread x Thread

Nominal Run Size (in)	Size 2	Size 3	Approx Weight EACH (lbs)	Grade "E" Gasket			
				Painted		Galvanized	
				ITEM#	Price Ea	ITEM#	Price Ea
2 ½	1 ¼	1 ¼ *	4.46	0390088607	\$273.980	0390090579	\$354.370
3	1	1 *	0.01	0390088615	\$223.820	0390086676	\$288.140
3	1	1 ¼	0.01	0390088623	\$273.980	0390086684	\$273.980
3	1	1 ½	0.01	0390088631	\$273.980	0390086692	\$341.510
3	1	2	0.01	0390088649	\$316.430	0390086700	\$391.680
3	1 ¼	1 ¼	0.01	0390088755	\$273.980	0390090587	\$341.510
3	1 ½	1 ¼	0.01	0390088763	\$273.980	0390090595	\$341.510
3	1 ½	1 ½	0.01	0390088771	\$273.980	0390090603	\$341.510
3	2	1 ¼	0.01	0390088789	\$316.430	0390090611	\$391.680
3	2	1 ½	0.01	0390088797	\$316.430	0390090629	\$391.680
3	2	2	6.50	0390088805	\$316.430	0390090637	\$391.680
4	1	1*	0.01	0390088813	\$273.980	0390090645	\$355.660
4	1 ¼	1 ¼	0.01	0390088821	\$333.150	0390090652	\$417.410
4	1 ½	1 ¼	0.01	0390088839	\$333.150	0390090660	\$417.410
4	1 ½	1 ½	0.01	0390088847	\$333.150	0390090678	\$417.410
4	2	1 ¼	0.01	0390088854	\$355.660	0390090686	\$419.980
4	2	1 ½	0.01	0390088862	\$355.660	0390090694	\$419.980
4	2	2	7.20	0390088870	\$355.660	0390090702	\$419.980
4	1	1 ¼	0.01	0390088896	\$333.150	0390086726	\$419.980
4	1	1 ½	0.01	0390088904	\$355.660	0390086734	\$417.410
4	2 ½	2 ½	0.01	0390088912	\$355.660	0390090744	\$452.780
4	1	2	0.01	0390088920	\$355.660	0390086742	\$419.980
4	3	3	12.00	0390088961	\$371.100	0390090793	\$479.150
5	1 ½	1 ½	0.01	0390088987	\$406.480	0390090819	\$515.160
5	2	1 ½	0.01	0390088995	\$428.340	0390090827	\$515.160
5	2	2	0.01	0390089001	\$406.480	0390090835	\$515.160
5	2 ½	1 ½	0.01	0390089019	\$428.340	0390090843	\$546.040
5	2 ½	2	0.01	0390089027	\$428.340	0390090850	\$587.830
5	2 ½	2 ½	0.01	0390089035	\$428.340	0390090868	\$546.040
5	3	1 ½	0.01	0390089043	\$457.920	0390090876	\$587.830
5	3	2	0.01	0390089050	\$457.920	0390090884	\$587.830
5	3	2 ½	0.01	0390089068	\$457.920	0390090892	\$587.830
5	3	3	0.01	0390089076	\$457.920	0390090900	\$587.830
6	1 ½	1 ½	0.01	0390089092	\$416.110	0390090926	\$535.750

Mechanical Tee Products Clamp-T® Cross, Fig. 7047

Nominal Run Size (in)	Size 2	Size 3	Approx Weight EACH (lbs)	Grade "E" Gasket			
				Painted		Galvanized	
				ITEM#	Price Ea	ITEM#	Price Ea
6	2	1 ½	0.01	0390089100	\$416.110	0390090934	\$535.750
6	2	2	7.90	0390089118	\$433.490	0390090942	\$578.200
6	2 ½	2 ½	0.01	0390089126	\$446.360	0390090959	\$578.200
6	3	2 ½	0.01	0390089159	\$477.860	0390090983	\$612.280
6	3	3	9.60	0390089183	\$477.860	0390091015	\$612.280
6	4	2 ½	0.01	0390089191	\$528.030	0390091049	\$684.960
6	4	3	0.01	0390089225	\$528.030	0390091056	\$684.960
6	4	4	0.01	0390089233	\$528.030	0390091064	\$684.960
8	2 ½	2 ½	0.01	0390089258	\$729.970	0390091072	\$920.990
8	3	2 ½	0.01	0390089266	\$767.930	0390091098	\$975.660
8	3	3	16.00	0390089274	\$767.930	0390091106	\$975.660
8	4	2 ½	0.01	0390089282	\$794.280	0390091114	\$1,025.830
8	4	3	18.00	0390089290	\$794.280	0390091122	\$1,025.830
8	4	4	16.00	0390089308	\$794.280	0390091130	\$1,025.830
2 ½	1	1 *	0.01	0390088482	\$200.670	0390090546	\$255.980
2 ½	1	1 ¼ *	0.01	0390088490	\$273.980	0390090553	\$354.370
2 ½	1	1 ½ *	0.01	0390088508	\$273.980	0390090561	\$354.370
2 ½	1 ½	1 ¼ *	0.01	0390088516	\$273.980	0390086650	\$354.370
2 ½	1 ½	1 ½ *	0.01	0390088524	\$273.980	0390086668	\$293.270

*Available with female threaded outlet only.

Always Verify Figure Number for Appropriate Combination of Outlets.

Always specify gasket grade when ordering. Some additional configurations available. Contact your Anvil Representative for details.

Mechanical Tee Products Clamp-T® Cross, Fig. 7048

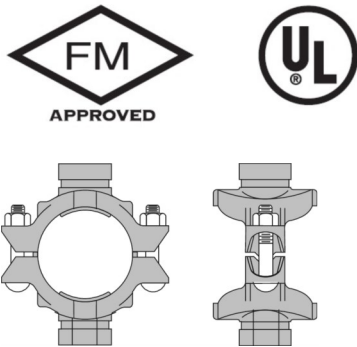

Fig. 7048 — Groove x Groove

Nominal Run Size (in)	Size 2	Size 3	Approx Weight EACH (lbs)	Grade "E" Gasket			
				Painted		Galvanized	
				ITEM#	Price Ea	ITEM#	Price Ea
2 ½	1 ¼	1 ¼*	4.60	0390086437	\$273.980	0390091171	\$354.370
2 ½	1 ½	1 ¼*	0.01	0390086445	\$273.980	0390086767	\$354.370
2 ½	1 ½	1 ½*	4.50	0390086452	\$273.980	0390086775	\$293.270

Mechanical Tee Products Clamp-T® Cross, Fig. 7048

Nominal Run Size (in)	Size 2	Size 3	Approx Weight EACH (lbs)	Grade "E" Gasket			
				Painted		Galvanized	
				ITEM#	Price Ea	ITEM#	Price Ea
3	1	1*	0.01	0390086460	\$223.820	0390086783	\$286.850
3	1	1 ¼	0.01	0390086478	\$273.980	0390086791	\$273.340
3	1	1 ½	0.01	0390086486	\$273.980	0390086809	\$341.510
3	1	2	0.01	0390086494	\$316.430	0390086817	\$391.680
4	1	1 ¼	0.01	0390086502	\$333.150	0390091239	\$417.410
4	1	1 ½	0.01	0390086510	\$355.660	0390086841	\$418.040
4	1	2	0.01	0390086528	\$355.660	0390086858	\$418.690
2 ½	1	1*	0.01	0390089316	\$200.670	0390091148	\$255.980
2 ½	1	1 ¼*	0.01	0390089324	\$273.980	0390091155	\$354.370
2 ½	1	1 ½*	0.01	0390089332	\$273.980	0390091163	\$354.370
3	1 ¼	1 ¼	0.01	0390089340	\$273.980	0390086825	\$341.510
3	1 ½	1 ¼	0.01	0390089357	\$273.980	0390091189	\$341.510
3	1 ½	1 ½	5.35	0390089365	\$273.980	0390091197	\$341.510
3	2	1 ¼	0.01	0390089373	\$316.430	0390091205	\$391.680
3	2	1 ½	0.01	0390089381	\$316.430	0390091213	\$391.680
3	2	2	6.00	0390089399	\$316.430	0390086833	\$391.680
4	1 ¼	1 ¼	6.00	0390089415	\$333.150	0390091247	\$417.410
4	1 ½	1 ¼	0.01	0390089423	\$333.150	0390091254	\$417.410
4	1 ½	1 ½	5.75	0390089431	\$332.510	0390091262	\$416.110
4	2	1 ¼	7.23	0390089449	\$355.660	0390091270	\$419.980
4	2	1 ½	0.01	0390089456	\$355.660	0390091288	\$419.980
4	2	2	6.00	0390089464	\$355.660	0390091296	\$419.980
4	2 ½	2 ½	7.50	0390089506	\$355.660	0390091338	\$452.780
4	3	3	10.40	0390089555	\$369.170	0390091387	\$479.150
5	1 ½	1 ½	0.01	0390089571	\$406.480	0390091403	\$515.160
5	2	1 ½	0.01	0390089589	\$428.340	0390091411	\$515.160
5	2	2	0.01	0390089597	\$406.480	0390091429	\$515.160
5	2 ½	1 ½	0.01	0390089605	\$428.340	0390091437	\$546.040
5	2 ½	2	0.01	0390089613	\$428.340	0390091445	\$587.830
5	2 ½	2 ½	7.40	0390089621	\$426.410	0390091452	\$515.160
5	3	1 ½	0.01	0390089639	\$457.920	0390091460	\$629.000
5	3	2	0.01	0390089647	\$457.920	0390091478	\$587.830
5	3	2 ½	0.01	0390089654	\$457.920	0390091486	\$587.830
5	3	3	8.70	0390089662	\$457.920	0390091494	\$587.830
6	1 ½	1 ½	0.01	0390089688	\$416.110	0390091510	\$535.750
6	2	1 ½	0.01	0390089696	\$416.110	0390091528	\$535.750
6	2	2	8.41	0390089704	\$433.490	0390091536	\$578.200
6	2 ½	2 ½	0.01	0390089712	\$446.360	0390091544	\$578.200
6	3	2 ½	0.01	0390089746	\$477.860	0390091577	\$612.280
6	3	3	12.00	0390089779	\$477.860	0390091601	\$612.280
6	4	2 ½	0.01	0390089803	\$528.030	0390091635	\$684.960
6	4	3	0.01	0390089811	\$528.030	0390091643	\$684.960
6	4	4	14.25	0390089829	\$528.030	0390091650	\$684.960
8	2 ½	2 ½	11.78	0390089845	\$729.970	0390091676	\$920.990
8	3	2 ½	0.01	0390089852	\$767.930	0390091684	\$975.660
8	3	3	16.00	0390089860	\$767.930	0390091692	\$975.660
8	4	2 ½	0.01	0390089878	\$794.280	0390091700	\$1,025.830

Mechanical Tee Products Clamp-T® Cross, Fig. 7048

Nominal Run Size (in)	Size 2	Size 3	Approx Weight EACH (lbs)	Grade "E" Gasket			
				Painted		Galvanized	
				ITEM#	Price Ea	ITEM#	Price Ea
8	4	3	0.01	0390089886	\$794.280	0390091718	\$1,025.830
8	4	4	0.01	0390089894	\$794.280	0390091726	\$1,025.830

*Available with female threaded outlet only.

Always Verify Figure Number for Appropriate Combination of Outlets.

Always specify gasket grade when ordering. Some additional configurations available. Contact your Anvil Representative for details.

Mechanical Tee Products Clamp-T® Cross, Fig. 7049

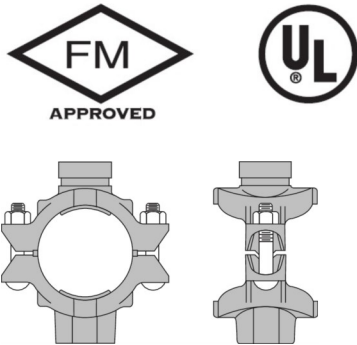

Fig. 7049 — Groove x Thread

Run Size (in)	Size 2	Size 3	Galvanized		Painted	
			ITEM#	Price Ea	ITEM#	Price Ea
8	4	4	0390092310	\$1,025.830	0390090538	\$794.280
2 ½	1 ½	1 ¼*	0390086874	\$356.310	0390086544	\$273.980
3	1	1*	0390086890	\$288.140	0390086569	\$223.820
3	1	1 ¼	0390086908	\$273.980	0390086577	\$273.980
3	1	1 ½	0390086916	\$341.510	0390086585	\$273.980
3	1	2	0390086924	\$391.680	0390086593	\$316.430
4	1	1 ¼	0390086940	\$419.980	0390086619	\$333.150
4	1	1 ½	0390086957	\$417.410	0390086627	\$355.660
4	1	2	0390086965	\$419.980	0390086635	\$355.660
2 ½	1	1 ¼*	-	-	0390089910	\$273.980
2 ½	1	1 ½*	-	-	0390089928	\$273.980
4	1 ¼	1 ¼	-	-	0390090009	\$333.150
2 ½	1	1*	0390091734	\$255.980	0390089902	\$200.670
2 ½	1 ¼	1 ¼*	0390086866	\$356.310	0390086536	\$273.980
2 ½	1 ½	1 ½*	0390086882	\$293.270	0390086551	\$293.270
3	1 ¼	1 ¼	0390091767	\$341.510	0390089936	\$273.980
3	1 ½	1 ¼	0390091775	\$341.510	0390089944	\$273.980
3	1 ½	1 ½	0390091783	\$341.510	0390089951	\$273.980
3	2	1 ¼	0390091791	\$391.680	0390089969	\$316.430
3	2	1 ½	0390091809	\$391.680	0390089977	\$316.430

Mechanical Tee Products Clamp-T® Cross, Fig. 7049

Run Size (in)	Size 2	Size 3	Galvanized		Painted	
			ITEM#	Price Ea	ITEM#	Price Ea
3	2	2	0390091817	\$391.680	0390089985	\$316.430
4	1 ½	1 ¼	0390091841	\$417.410	0390090017	\$333.150
4	1 ½	1 ½	0390091858	\$417.410	0390090025	\$333.150
4	2	1 ¼	0390091866	\$419.980	0390090033	\$355.660
4	2	1 ½	0390091874	\$419.980	0390090041	\$355.660
4	2	2	0390091882	\$419.980	0390090058	\$355.660
4	2 ½	2 ½	0390091924	\$452.780	0390090082	\$355.660
4	3	3	0390091973	\$479.150	0390090165	\$371.100
5	1 ½	1 ½	0390091999	\$515.160	0390090181	\$406.480
5	2	1 ½	0390092005	\$515.160	0390090199	\$428.340
5	2	2	0390092013	\$515.160	0390090215	\$406.480
5	2 ½	1 ½	0390092021	\$546.040	0390090231	\$428.340
5	2 ½	2	0390092039	\$587.830	0390090256	\$428.340
5	2 ½	2 ½	0390092047	\$546.040	0390090264	\$428.340
5	3	1 ½	0390092054	\$587.830	0390090272	\$457.920
5	3	2	0390092062	\$587.830	0390090280	\$457.920
5	3	2 ½	0390092070	\$587.830	0390090298	\$457.920
5	3	3	0390092088	\$587.830	0390090306	\$457.920
6	1 ½	1 ½	0390092104	\$535.750	0390090322	\$416.110
6	2	1 ½	0390092112	\$535.750	0390090330	\$416.110
6	2	2	0390092120	\$578.200	0390090348	\$433.490
6	2 ½	2 ½	0390092138	\$578.200	0390090355	\$446.360
6	3	2 ½	0390092161	\$612.280	0390090389	\$477.860
6	3	3	0390092195	\$612.280	0390090413	\$477.860
6	4	2 ½	0390092229	\$684.960	0390090447	\$528.030
6	4	3	0390092237	\$684.960	0390090454	\$528.030
6	4	4	0390092245	\$684.960	0390090462	\$528.030
8	2 ½	2 ½	0390092260	\$920.990	0390090488	\$729.970
8	3	2 ½	0390092278	\$975.660	0390090496	\$767.930
8	3	3	0390092286	\$975.660	0390090504	\$767.930
8	4	2 ½	0390092294	\$1,025.830	0390090512	\$794.280
8	4	3	0390092302	\$1,025.830	0390090520	\$794.280

*Available with female threaded outlet only.

Always Verify Figure Number for Appropriate Combination of Outlets.

Always specify gasket grade when ordering. Some additional configurations available. Contact your Anvil Representative for details.

Steel Cross Fig. 7068

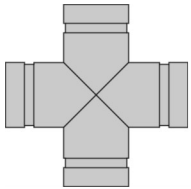

Nominal Pipe Size (in)	Approx Weight EACH (lbs)	Steel Cross Fig. 7068			
		Painted		Galvanized	
		ITEM#	Price Ea	ITEM#	Price Ea
1	1.30	0390023869	\$503.580	0390125334	\$580.120
1 ¼	2.10	0390023877	\$604.560	0390125342	\$703.610
1 ½	2.50	0390023885	\$650.870	0390125359	\$754.420
2	2.90	0390023943	\$372.390	0390125367	\$443.120
2 ½	5.20	0390023984	\$372.390	0390125375	\$443.120
3	7.50	0390024024	\$661.160	0390125383	\$809.080
3 ½	9.80	0390024032	\$1,327.460	0390125391	\$1,582.150
4	12.20	0390024107	\$1,095.290	0390125409	\$1,348.040
5	17.60	0390024149	\$2,231.720	0390125417	\$2,688.360
6	28.30	0390024180	\$2,862.660	0390125425	\$3,474.930
8	48.00	0390024222	\$3,771.420	0390126084	\$4,665.400

LUBRICANTS

Size	STANDARD LUBRICANT	
	ITEM#	Price Ea
1 qt Can	0390163137	\$324.780

Standard Dimension Fittings

Standard 90° Elbows Fig. 7050S† for Fire Protection

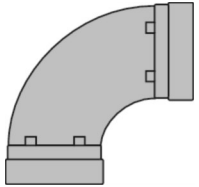

Nominal Pipe Size (in)	Approx Weight EACH (lbs)	Standard 90° Elbows Fig. 7050S† for Fire Protection			
		Painted		Galvanized	
		ITEM#	Price Ea	ITEM#	Price Ea
1 ¼	1.00	1605007184	\$74.600	1605106986	\$94.540
1 ½	1.20	1605007192	\$74.600	1605106994	\$94.540
2	1.89	1605007309	\$74.600	1605107000	\$94.540
2 ½	2.80	1605007358	\$100.330	1605107109	\$134.420
3	3.75	1605007408	\$124.770	1605107208	\$175.590
4	7.40	1605007457	\$186.520	1605107307	\$263.690
5	11.40	1605007465	\$454.710	1605107315	\$596.200
6	17.50	1605007507	\$532.530	1605107406	\$733.190
8	30.60	1605007556	\$1,045.750	1605107414	\$1,485.030

†When ordering, refer to product as FP7050S.

90° Drain Elbows Fig. 7050DR

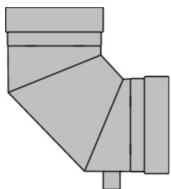

Nominal Pipe Size (in)	Approx Weight EACH (lbs)	90° Drain Elbows Fig. 7050DR			
		Painted		Galvanized	
		ITEM#	Price Ea	ITEM#	Price Ea
2	2.76	5551000887	\$193.590	5551002008	\$288.140
2 ½	4.33	5551000903	\$193.590	5551002024	\$288.140
3	5.60	5551000929	\$209.670	5551002040	\$313.860
4	8.80	5551000945	\$237.320	5551002065	\$353.730
6	18.77	5551000960	\$371.740	5551002107	\$553.750

90° Drain Elbows Fig. 7050DR

Nominal Pipe Size (in)	Approx Weight EACH (lbs)	90° Drain Elbows Fig. 7050DR			
		Painted		Galvanized	
		ITEM#	Price Ea	ITEM#	Price Ea
8	32.64	5551000986	\$559.540	5551002149	\$835.450

Standard 45° Elbows Fig. 7051† for Fire Protection

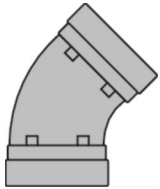

Nominal Pipe Size (in)	Approx Weight EACH (lbs)	Standard 45° Elbows Fig. 7051† for Fire Protection			
		Painted		Galvanized	
		ITEM#	Price Ea	ITEM#	Price Ea
1 ¼	0.70	1605007853	\$74.600	1605107711	\$94.540
1 ½	0.90	1605007861	\$74.600	1605107729	\$94.540
2	1.50	1605007879	\$74.600	1605107737	\$94.540
2 ½	1.90	1605007887	\$100.330	1605107745	\$134.420
3	3.30	1605007895	\$124.770	1605107752	\$175.590
4	5.40	1605007903	\$186.520	1605107760	\$263.690
5	9.00	1605007911	\$454.710	1605107778	\$596.200
6	11.20	1605007929	\$532.530	1605107786	\$733.190
8	19.80	1605007937	\$1,045.750	1605107794	\$1,485.030

†When ordering, refer to product as FP7051.

Sock-It® Fittings

Sock-It® 90° Straight Elbow Fig. 7100

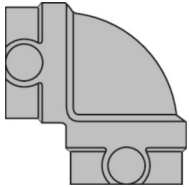

Nominal Run Size (in)	Approx Weight EACH (lbs)	PRICE PER UNIT "E" GASKET BLACK		Box Quantity
		ITEM#	Price Ea	
1	2.15	0390043420	\$100.330	10
1 ¼	2.65	0390043446	\$116.410	10
1 ½	3.21	0390043461	\$127.350	8
2	4.85	0390043487	\$149.850	10

Provided in carton quantity only.

Grade E gaskets unless otherwise specified.

Sock-It® Straight Tee Fig. 7103

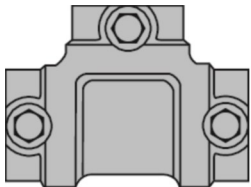

Nominal Run Size (in)	Approx Weight EACH (lbs)	PRICE PER UNIT "E" GASKET BLACK		Box Quantity
		ITEM#	Price Ea	
1	2.95	0390043800	\$153.060	8
1 ¼	3.80	0390043818	\$161.430	8
1 ½	4.57	0390043826	\$187.800	6

Sock-It® Straight Tee Fig. 7103

Nominal Run Size (in)	Approx Weight EACH (lbs)	PRICE PER UNIT "E" GASKET BLACK		Box Quantity
		ITEM#	Price Ea	
2	7.70	0390043834	\$196.150	10

Provided in carton quantity only.

Grade E gaskets unless otherwise specified.

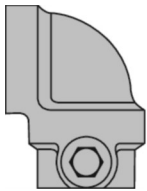
Sock-It® Reducing Elbow Fig. 7101

Nominal Run Size (in)	Outlet Size (in)	Approx Weight EACH (lbs)	PRICE PER UNIT "E" GASKET BLACK		Box Quantity
			ITEM#	Price Ea	
1	½	1.64	0390043602	\$118.970	10
1	¾	1.64	0390043610	\$118.970	45
1	1	1.64	0390043628	\$118.970	10
1 ¼	½	1.99	0390043636	\$122.840	30
1 ¼	¾	1.99	0390043644	\$122.840	30
1 ¼	1	1.99	0390043651	\$122.840	30
1 ½	½	2.34	0390043669	\$126.700	30
1 ½	¾	2.34	0390043677	\$126.700	10
1 ½	1	2.34	0390043685	\$126.700	10

Provided in carton quantity only.

Grade E gaskets unless otherwise specified.

Sock-It® Reducing Outlet Tee Fig. 7105

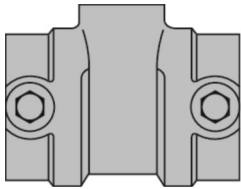

Outlet Size (in)	Approx Weight EACH (lbs)	PRICE PER UNIT "E" GASKET BLACK		Box Quantity
		ITEM#	Price Ea	
½	2.53	0390045060	\$94.540	30
¾	2.53	0390045086	\$94.540	30
1	2.53	0390045102	\$94.540	10
½	2.78	0390045185	\$94.540	8
¾	2.78	0390045201	\$94.540	8
1	2.78	0390045227	\$94.540	8
½	3.30	0390045300	\$99.680	25
¾	3.30	0390045326	\$99.680	25
1	3.30	0390045342	\$99.680	8
½	4.40	0390045425	\$120.910	15
¾	4.40	0390045441	\$120.910	15
1	4.40	0390045466	\$120.910	6
¾	6.37	0390045508	\$161.430	5
1	6.37	0390045516	\$161.430	5

Provided in carton quantity only.

Grade E gaskets unless otherwise specified.

Sock-It® Reducing Run Outlet Tee Fig. 7106

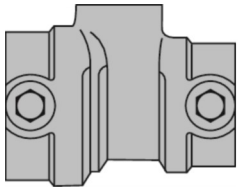

Size 1	Size 2	Outlet Size (in)	Approx Weight EACH (lbs)	PRICE PER UNIT "E" GASKET BLACK		Box Quantity
				ITEM#	Price Ea	
1 ¼	1	½	2.68	0390045128	\$100.980	30
1 ¼	1	¾	2.68	0390045144	\$100.980	30
1 ¼	1	1	2.68	0390045169	\$100.980	10
1 ½	1 ¼	½	3.10	0390045243	\$108.050	25
1 ½	1 ¼	¾	3.10	0390045268	\$108.050	25
1 ½	1 ¼	1	3.10	0390045284	\$108.050	25
2	1 ½	½	3.94	0390045367	\$127.980	15
2	1 ½	¾	3.94	0390045383	\$127.980	15
2	1 ½	1	3.94	0390045409	\$127.980	15

Provided in carton quantity only.

Grade E gaskets unless otherwise specified.

Sock-It® Coupling Fig. 7107

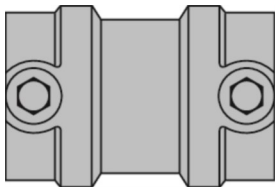

Nominal Run Size (in)	Approx Weight EACH (lbs)	PRICE PER UNIT "E" GASKET BLACK		Box Quantity
		ITEM#	Price Ea	
1	1.80	0390046092	\$90.050	15
1 ¼	2.30	0390046100	\$90.050	10

Sock-It® Coupling Fig. 7107

Nominal Run Size (in)	Approx Weight EACH (lbs)	PRICE PER UNIT "E" GASKET BLACK		Box Quantity
		ITEM#	Price Ea	
1 ½	2.63	0390046126	\$112.550	10
2	3.76	0390046142	\$112.550	8

Provided in carton quantity only.

Grade E gaskets unless otherwise specified.

Spare Parts

For use with Fig. 7000 and 7400 Coupling

Nominal Pipe Size (in)	Spare Parts Type A Gasket Only	
	ITEM#	Price Ea
1 ¼	1605113495	\$54.660
1 ½	1605113503	\$56.590
2	1605113511	\$59.170
2 ½	1605113529	\$71.390
3	1605113537	\$81.040
4	1605113545	\$100.330
5	1605113552	\$131.210
6	1605113560	\$145.350
8	1605113578	\$207.740

Pre-Lubricated Gaskets are non-cancellable and non-returnable.

For use with Fig. FP7012 (Grade "E" Gasket)

Nominal Pipe Size (in)	Spare Parts "E" Gasket Only	
	ITEM#	Price Ea
2	1605113206	\$50.810
2 ½	1605113214	\$59.170
3	1605113222	\$63.040
4	1605113230	\$81.670
5	1605113248	\$98.400
6	1605113255	\$110.620
8	1605113263	\$148.560

Gaskets are non-cancellable and non-returnable.

Numerical Index

Group1 Items

1605006103.....	4	1605006053.....	4	1605006004.....	4	1605005998.....	4	1605005980.....	4
0390009280.....	4	1605006210.....	4	1605006202.....	4	1605006186.....	4	1605006152.....	4
0390009439.....	5	0390009421.....	5	0390009389.....	4	0390009348.....	4	0390009306.....	4
0390009645.....	5	0390009546.....	5	0390009520.....	5	0390009488.....	5	0390009447.....	5
1605006764.....	5	1605006756.....	5	1605006749.....	5	1605006731.....	5	1605006723.....	5
1605012309.....	6	1605012291.....	6	1605012283.....	6	1605006780.....	5	1605006772.....	5
1605012507.....	6	1605012481.....	6	1605012457.....	6	1605012408.....	6	1605012358.....	6
1605008356.....	6	1605008307.....	6	1605008240.....	6	1605008232.....	6	1605012515.....	6
1605008521.....	7	1605008505.....	7	1605008497.....	7	1605008455.....	7	1605008406.....	7
1605009321.....	8	0390019974.....	8	0390019966.....	8	0390021624.....	7	0390021608.....	7
1605009412.....	8	1605009404.....	8	1605009396.....	8	1605009388.....	8	1605009370.....	8
1605202686.....	9	1605009453.....	9	1605009446.....	8	1605009438.....	8	1605009420.....	8
1605202785.....	9	1605202769.....	9	1605202744.....	9	1605202728.....	9	1605202702.....	9
1605202488.....	10	1605202462.....	10	1605202447.....	9	1605202421.....	9	1605202405.....	9
0390028330.....	10	0390028272.....	10	0390028264.....	10	0390028199.....	10	1605202504.....	10
0390028389.....	10	0390028371.....	10	0390028363.....	10	0390028355.....	10	0390028348.....	10
0390028454.....	10	0390028447.....	10	0390028439.....	10	0390028413.....	10	0390028405.....	10
0390028603.....	10	0390028595.....	10	0390028587.....	10	0390028546.....	10	0390028462.....	10
0390028694.....	10	0390028686.....	10	0390028660.....	10	0390028645.....	10	0390028629.....	10
0390028868.....	11	0390028843.....	11	0390028785.....	11	0390028769.....	10	0390028751.....	10
0390029007.....	11	0390028967.....	11	0390028926.....	11	0390028892.....	11	0390028884.....	11
0390036978.....	11	0390029221.....	11	0390029189.....	11	0390029148.....	11	0390029106.....	11
0390037042.....	11	0390037034.....	11	0390037026.....	11	0390037018.....	11	0390036994.....	11
0390037091.....	11	0390037083.....	11	0390037075.....	11	0390037067.....	11	0390037059.....	11
0390037141.....	12	0390037133.....	11	0390037125.....	11	0390037117.....	11	0390037109.....	11
0390037208.....	12	0390037190.....	12	0390037182.....	12	0390037174.....	12	0390037158.....	12
0390037265.....	12	0390037257.....	12	0390037240.....	12	0390037232.....	12	0390037216.....	12
0390173201.....	12	0390173128.....	12	0390173110.....	12	0390037307.....	12	0390037281.....	12
0390173367.....	12	0390173342.....	12	0390173334.....	12	0390173243.....	12	0390173219.....	12
0390173516.....	13	0390173490.....	12	0390173482.....	12	0390173417.....	12	0390173383.....	12
0390173631.....	13	0390173615.....	13	0390173565.....	13	0390173557.....	13	0390173532.....	13
0390173821.....	13	0390173805.....	13	0390173755.....	13	0390173698.....	13	0390173664.....	13
0390171023.....	13	0390171015.....	13	0390171007.....	13	0390173904.....	13	0390173847.....	13
0390171080.....	13	0390171072.....	13	0390171064.....	13	0390171049.....	13	0390171031.....	13
0390171148.....	14	0390171130.....	14	0390171122.....	14	0390171106.....	13	0390171098.....	13
0390171239.....	14	0390171221.....	14	0390171189.....	14	0390171163.....	14	0390171155.....	14
0390171304.....	14	0390171288.....	14	0390171262.....	14	0390171254.....	14	0390171247.....	14
0390171429.....	14	0390171395.....	14	0390171379.....	14	0390171361.....	14	0390171320.....	14
0390171544.....	14	0390171528.....	14	0390171494.....	14	0390171486.....	14	0390171445.....	14
0390171767.....	14	0390171726.....	14	0390171700.....	14	0390171601.....	14	0390171569.....	14
0390088631.....	15	0390088623.....	15	0390088615.....	15	0390088607.....	15	0390171825.....	14
0390088789.....	15	0390088771.....	15	0390088763.....	15	0390088755.....	15	0390088649.....	15
0390088839.....	15	0390088821.....	15	0390088813.....	15	0390088805.....	15	0390088797.....	15
0390088896.....	15	0390088870.....	15	0390088862.....	15	0390088854.....	15	0390088847.....	15
0390088987.....	15	0390088961.....	15	0390088920.....	15	0390088912.....	15	0390088904.....	15
0390089035.....	15	0390089027.....	15	0390089019.....	15	0390089001.....	15	0390088995.....	15
0390089092.....	15	0390089076.....	15	0390089068.....	15	0390089050.....	15	0390089043.....	15
0390089183.....	16	0390089159.....	16	0390089126.....	16	0390089118.....	16	0390089100.....	16
0390089266.....	16	0390089258.....	16	0390089233.....	16	0390089225.....	16	0390089191.....	16
0390088482.....	16	0390089308.....	16	0390089290.....	16	0390089282.....	16	0390089274.....	16
0390086437.....	16	0390088524.....	16	0390088516.....	16	0390088508.....	16	0390088490.....	16
0390086486.....	17	0390086478.....	17	0390086460.....	17	0390086452.....	16	0390086445.....	16
0390089316.....	17	0390086528.....	17	0390086510.....	17	0390086502.....	17	0390086494.....	17
0390089365.....	17	0390089357.....	17	0390089340.....	17	0390089332.....	17	0390089324.....	17
0390089423.....	17	0390089415.....	17	0390089399.....	17	0390089381.....	17	0390089373.....	17
0390089506.....	17	0390089464.....	17	0390089456.....	17	0390089449.....	17	0390089431.....	17
0390089605.....	17	0390089597.....	17	0390089589.....	17	0390089571.....	17	0390089555.....	17
0390089654.....	17	0390089647.....	17	0390089639.....	17	0390089621.....	17	0390089613.....	17
0390089712.....	17	0390089704.....	17	0390089696.....	17	0390089688.....	17	0390089662.....	17
0390089829.....	17	0390089811.....	17	0390089803.....	17	0390089779.....	17	0390089746.....	17
0390089886.....	18	0390089878.....	17	0390089860.....	17	0390089852.....	17	0390089845.....	17
0390086908.....	18	0390086890.....	18	0390086874.....	18	0390092310.....	18	0390089894.....	18

Numerical Index

Group1 Items

0390086965.....	18	0390086957.....	18	0390086940.....	18	0390086924.....	18	0390086916.....	18
0390091775.....	18	0390091767.....	18	0390086882.....	18	0390086866.....	18	0390091734.....	18
0390091841.....	19	0390091817.....	19	0390091809.....	18	0390091791.....	18	0390091783.....	18
0390091924.....	19	0390091882.....	19	0390091874.....	19	0390091866.....	19	0390091858.....	19
0390092021.....	19	0390092013.....	19	0390092005.....	19	0390091999.....	19	0390091973.....	19
0390092070.....	19	0390092062.....	19	0390092054.....	19	0390092047.....	19	0390092039.....	19
0390092138.....	19	0390092120.....	19	0390092112.....	19	0390092104.....	19	0390092088.....	19
0390092245.....	19	0390092237.....	19	0390092229.....	19	0390092195.....	19	0390092161.....	19
0390092302.....	19	0390092294.....	19	0390092286.....	19	0390092278.....	19	0390092260.....	19
0390023984.....	20	0390023943.....	20	0390023885.....	20	0390023877.....	20	0390023869.....	20
0390024180.....	20	0390024149.....	20	0390024107.....	20	0390024032.....	20	0390024024.....	20
1605007309.....	21	1605007192.....	21	1605007184.....	21	0390163137.....	20	0390024222.....	20
1605007507.....	21	1605007465.....	21	1605007457.....	21	1605007408.....	21	1605007358.....	21
5551000945.....	21	5551000929.....	21	5551000903.....	21	5551000887.....	21	1605007556.....	21
1605007879.....	22	1605007861.....	22	1605007853.....	22	5551000986.....	21	5551000960.....	21
1605007929.....	22	1605007911.....	22	1605007903.....	22	1605007895.....	22	1605007887.....	22
0390043487.....	23	0390043461.....	23	0390043446.....	23	0390043420.....	23	1605007937.....	22
0390043602.....	24	0390043834.....	23	0390043826.....	23	0390043818.....	23	0390043800.....	23
0390043651.....	24	0390043644.....	24	0390043636.....	24	0390043628.....	24	0390043610.....	24
0390045086.....	25	0390045060.....	25	0390043685.....	24	0390043677.....	24	0390043669.....	24
0390045300.....	25	0390045227.....	25	0390045201.....	25	0390045185.....	25	0390045102.....	25
0390045466.....	25	0390045441.....	25	0390045425.....	25	0390045342.....	25	0390045326.....	25
0390045169.....	26	0390045144.....	26	0390045128.....	26	0390045516.....	25	0390045508.....	25
0390045383.....	26	0390045367.....	26	0390045284.....	26	0390045268.....	26	0390045243.....	26
0390046142.....	27	0390046126.....	27	0390046100.....	26	0390046092.....	26	0390045409.....	26
1605113537.....	27	1605113529.....	27	1605113511.....	27	1605113503.....	27	1605113495.....	27
0390080406.....	0	1605113578.....	27	1605113560.....	27	1605113552.....	27	1605113545.....	27
1605113248.....	27	1605113230.....	27	1605113222.....	27	1605113214.....	27	1605113206.....	27
						1605113263.....	27	1605113255.....	27

Group2 Items

1605106200.....	4	1605106101.....	4	1605106002.....	4	1605105996.....	4	1605105988.....	4
0390111581.....	4	1605106416.....	4	1605106408.....	4	1605106358.....	4	1605106309.....	4
0390111730.....	5	0390111722.....	5	0390111680.....	4	0390111649.....	4	0390111607.....	4
0390111946.....	5	0390111847.....	5	0390111821.....	5	0390111789.....	5	0390111748.....	5
1605106663.....	5	1605106655.....	5	1605106648.....	5	1605106630.....	5	1605106622.....	5
1605112000.....	6	1605111994.....	6	1605111986.....	6	1605106689.....	5	1605106671.....	5
1605112406.....	6	1605112356.....	6	1605112307.....	6	1605112208.....	6	1605112109.....	6
1605108107.....	6	1605108008.....	6	1605107950.....	6	1605107943.....	6	1605112414.....	6
1605108412.....	7	1605108404.....	7	1605108354.....	7	1605108305.....	7	1605108206.....	7
1605108909.....	8	0390121572.....	8	0390121564.....	8	0390123776.....	7	0390123388.....	7
1605108958.....	8	1605108941.....	8	1605108933.....	8	1605108925.....	8	1605108917.....	8
1605204427.....	9	1605108990.....	9	1605108982.....	8	1605108974.....	8	1605108966.....	8
1605204492.....	9	1605204476.....	9	1605204450.....	9	1605204443.....	9	1605204435.....	9
1605203833.....	10	1605203817.....	10	1605203809.....	9	1605203791.....	9	1605203783.....	9
0390130177.....	10	0390130110.....	10	0390130102.....	10	0390130094.....	10	1605203841.....	10
0390130227.....	10	0390130219.....	10	0390130250.....	10	0390130193.....	10	0390130185.....	10
0390130268.....	10	0390130284.....	10	0390130276.....	10	0390130235.....	10	0390130243.....	10
0390130441.....	10	0390130433.....	10	0390130425.....	10	0390130383.....	10	0390130300.....	10
0390130607.....	10	0390130524.....	10	0390130508.....	10	0390130482.....	10	0390130466.....	10
0390130706.....	11	0390130680.....	11	0390130623.....	11	0390130631.....	10	0390130615.....	10
0390130847.....	11	0390130805.....	11	0390130763.....	11	0390130748.....	11	0390130722.....	11
0390138410.....	11	0390131068.....	11	0390131027.....	11	0390130987.....	11	0390130946.....	11
0390137941.....	11	0390137933.....	11	0390137925.....	11	0390137917.....	11	0390138402.....	11
0390137974.....	11	0390137990.....	11	0390137867.....	11	0390137883.....	11	0390137958.....	11
0390138089.....	12	0390138071.....	11	0390137982.....	11	0390137966.....	11	0390138022.....	11
0390137909.....	12	0390138097.....	12	0390138147.....	12	0390138139.....	12	0390138113.....	12
0390138303.....	12	0390138386.....	12	0390138261.....	12	0390138378.....	12	0390138220.....	12
0390174464.....	12	0390174340.....	12	0390174332.....	12	0390138394.....	12	0390138345.....	12
0390174613.....	13	0390174563.....	13	0390174555.....	13	0390174514.....	13	0390174498.....	12
0390175032.....	13	0390175024.....	13	0390175016.....	13	0390175008.....	13	0390174639.....	13
0390175115.....	13	0390175099.....	13	0390175081.....	13	0390175073.....	13	0390175040.....	13

Numerical Index

Group2 Items

0390175206.....	14	0390175180.....	14	0390175172.....	14	0390175164.....	14	0390175123.....	13
0390175321.....	14	0390175313.....	14	0390175305.....	14	0390175248.....	14	0390175214.....	14
0390175412.....	14	0390175388.....	14	0390175362.....	14	0390175347.....	14	0390175339.....	14
0390175552.....	14	0390175537.....	14	0390175511.....	14	0390175495.....	14	0390175420.....	14
0390175693.....	14	0390175669.....	14	0390175636.....	14	0390175610.....	14	0390175602.....	14
0390175909.....	14	0390175842.....	14	0390175826.....	14	0390175800.....	14	0390175750.....	14
0390086700.....	15	0390086692.....	15	0390086684.....	15	0390086676.....	15	0390090579.....	15
0390090629.....	15	0390090611.....	15	0390090603.....	15	0390090595.....	15	0390090587.....	15
0390090678.....	15	0390090660.....	15	0390090652.....	15	0390090645.....	15	0390090637.....	15
0390086734.....	15	0390086726.....	15	0390090702.....	15	0390090694.....	15	0390090686.....	15
0390090827.....	15	0390090819.....	15	0390090793.....	15	0390086742.....	15	0390090744.....	15
0390090876.....	15	0390090868.....	15	0390090850.....	15	0390090843.....	15	0390090835.....	15
0390090934.....	16	0390090926.....	15	0390090900.....	15	0390090892.....	15	0390090884.....	15
0390091049.....	16	0390091015.....	16	0390090983.....	16	0390090959.....	16	0390090942.....	16
0390091106.....	16	0390091098.....	16	0390091072.....	16	0390091064.....	16	0390091056.....	16
0390090553.....	16	0390090546.....	16	0390091130.....	16	0390091122.....	16	0390091114.....	16
0390086767.....	16	0390091171.....	16	0390086668.....	16	0390086650.....	16	0390090561.....	16
0390086817.....	17	0390086809.....	17	0390086791.....	17	0390086783.....	17	0390086775.....	16
0390091155.....	17	0390091148.....	17	0390086858.....	17	0390086841.....	17	0390091239.....	17
0390091205.....	17	0390091197.....	17	0390091189.....	17	0390086825.....	17	0390091163.....	17
0390091262.....	17	0390091254.....	17	0390091247.....	17	0390086833.....	17	0390091213.....	17
0390091387.....	17	0390091338.....	17	0390091296.....	17	0390091288.....	17	0390091270.....	17
0390091445.....	17	0390091437.....	17	0390091429.....	17	0390091411.....	17	0390091403.....	17
0390091494.....	17	0390091486.....	17	0390091478.....	17	0390091460.....	17	0390091452.....	17
0390091577.....	17	0390091544.....	17	0390091536.....	17	0390091528.....	17	0390091510.....	17
0390091676.....	17	0390091650.....	17	0390091643.....	17	0390091635.....	17	0390091601.....	17
0390091726.....	18	0390091718.....	18	0390091700.....	17	0390091692.....	17	0390091684.....	17
0390086585.....	18	0390086577.....	18	0390086569.....	18	0390086544.....	18	0390090538.....	18
0390089910.....	18	0390086635.....	18	0390086627.....	18	0390086619.....	18	0390086593.....	18
0390086551.....	18	0390086536.....	18	0390089902.....	18	0390090009.....	18	0390089928.....	18
0390089977.....	18	0390089969.....	18	0390089951.....	18	0390089944.....	18	0390089936.....	18
0390090041.....	19	0390090033.....	19	0390090025.....	19	0390090017.....	19	0390089985.....	19
0390090199.....	19	0390090181.....	19	0390090165.....	19	0390090082.....	19	0390090058.....	19
0390090272.....	19	0390090264.....	19	0390090256.....	19	0390090231.....	19	0390090215.....	19
0390090330.....	19	0390090322.....	19	0390090306.....	19	0390090298.....	19	0390090280.....	19
0390090447.....	19	0390090413.....	19	0390090389.....	19	0390090355.....	19	0390090348.....	19
0390090504.....	19	0390090496.....	19	0390090488.....	19	0390090462.....	19	0390090454.....	19
0390125359.....	20	0390125342.....	20	0390125334.....	20	0390090520.....	19	0390090512.....	19
0390125409.....	20	0390125391.....	20	0390125383.....	20	0390125375.....	20	0390125367.....	20
1605106994.....	21	1605106986.....	21	0390126084.....	20	0390125425.....	20	0390125417.....	20
1605107315.....	21	1605107307.....	21	1605107208.....	21	1605107109.....	21	1605107000.....	21
5551002040.....	21	5551002024.....	21	5551002008.....	21	1605107414.....	21	1605107406.....	21
1605107729.....	22	1605107711.....	22	5551002149.....	21	5551002107.....	21	5551002065.....	21
1605107778.....	22	1605107760.....	22	1605107752.....	22	1605107745.....	22	1605107737.....	22
						1605107794.....	22	1605107786.....	22

Group3 Items

1605006301.....	4	1605006293.....	4	1605006285.....	4	1605006277.....	4	1605006269.....	4
1605013018.....	6	1605006343.....	4	1605006335.....	4	1605006327.....	4	1605006319.....	4
1605013067.....	6	1605013059.....	6	1605013042.....	6	1605013034.....	6	1605013026.....	6
0390177129.....	12	0390177111.....	12	1605013083.....	6	1605013075.....	6	1605013091.....	6
0390177343.....	12	0390177335.....	12	0390177244.....	12	0390177210.....	12	0390177202.....	12
0390177491.....	12	0390177483.....	12	0390177418.....	12	0390177384.....	12	0390177368.....	12
0390177616.....	13	0390177566.....	13	0390177558.....	13	0390177533.....	13	0390177517.....	13
0390177806.....	13	0390177756.....	13	0390177699.....	13	0390177665.....	13	0390177632.....	13
				0390177905.....	13	0390177848.....	13	0390177822.....	13

Group4 Items

1605106507.....	4	1605106499.....	4	1605106481.....	4	1605106473.....	4	1605106465.....	4
1605112919.....	6	1605106549.....	4	1605106531.....	4	1605106523.....	4	1605106515.....	4
1605112968.....	6	1605112950.....	6	1605112943.....	6	1605112935.....	6	1605112927.....	6
				1605112984.....	6	1605112976.....	6	1605112992.....	6