



## **GRUVLOK® DOMESTIC FIRE PRODUCTS**

Price Sheet GR.FP-5.19 | Effective: May 6, 2019 | Cancels Price Sheet GR.FP-9.18 of

### **FREIGHT ALLOWANCE:**

All prices are F.O.B. point of shipment. On shipments weighing 2,500 pounds or more, rail freight or motor freight at the lowest published rate, is allowed to all continental U.S. rail points or all U.S. highway points listed in published tariffs (Alaska and Hawaii excluded). In no case will more than actual freight be allowed.

### **NOTE:**

All orders are accepted on the basis of prices in effect at the time of shipment.

### **NOTICE:**

To the prices and terms quoted, there will be added any manufacturers or sales tax payable on the transaction under any effective statute.

### **GENERAL**

- UPC numbers are available upon request.
- To obtain current ISO certifications, listings, and other approvals, visit Anvil's website at [www.anvilintl.com](http://www.anvilintl.com).
- Pricing is subject to change without notice.

### **LOSS OR DAMAGE CLAIMS:**

All goods are shipped at buyer's risk. Shipments should be carefully examined upon delivery and before the carrier's delivery receipt is signed. If any loss or damage is evident, the buyer should make an appropriate notation on the delivery receipt and insist that the carrier's driver initial such exception. The contents of all packages should be carefully examined for concealed damage as soon as possible after delivery, so that the carrier can be requested, within 48 hours after delivery, to arrange for prompt inspection of the damaged goods.

### **CUSTOMER SERVICE CENTER**

Tel: 800-301-2701

Fax: 708-534-5441

[customerservice@anvilintl.com](mailto:customerservice@anvilintl.com)

[www.anvilintl.com](http://www.anvilintl.com)



# DOMESTIC FIRE PRODUCTS *PriceList*

Effective Date: May 6, 2019 | Replaces Prior Date: September 2018 | Sheet # GR.FP-5.19

## 1. CONTROLLING PROVISIONS:

These terms and conditions shall control with respect to any purchase order or sale of Seller's products. No waiver, alteration or modification of these terms and conditions whether on Buyer's purchase order or otherwise shall be valid unless the waiver, alteration or modification is specifically accepted in writing and signed by an authorized representative of Seller.

## 2. DELIVERY:

Seller will make every effort to complete delivery of products as indicated on Seller's acceptance of an order, but Seller assumes no responsibility or liability, and will accept no backcharge, for loss or damage due to delay or inability to deliver caused by acts of God, war, labor difficulties, accident, delays of carriers, by contractors or suppliers, inability to obtain materials, shortages of fuel and energy, or any other causes of any kind whatever beyond the control of Seller. Seller may terminate any contract of sale of its products without liability of any nature, by written notice to Buyer, in the event that the delay in delivery or performance resulting from any of the aforesaid causes shall continue for a period of sixty (60) days. Under no circumstances shall Seller be liable for any special or consequential damages or for loss, damage, or expense (whether or not based on negligence) directly or indirectly arising from delays or failure to give notice of delay.

## 3. WARRANTY:

Seller warrants for one year from the date of shipment Seller's manufactured products to the extent that Seller will replace those having defects in material or workmanship when used for the purpose and in the manner which Seller recommends. If Seller examination shall disclose to its satisfaction that the products are defective, and an adjustment is required, the amount of such adjustment shall not exceed the net sales price of the defective products only and no allowance will be made for labor or expense of repairing or replacing defective products or workmanship of damage resulting from the same. Seller warrants the products which it sells of other manufacturers to the extent of the warranties of their respective makers. Where engineering design or fabrication work is supplied. Buyer's acceptance of Seller's design or of delivery of work shall relieve Seller of all further obligation, other than expressed in Seller's product warranty. THIS IS SELLER'S SOLE WARRANTY. SELLER MAKES NO OTHER WARRANTY OF ANY KIND, EXPRESSED OR IMPLIED AND ALL IMPLIED WARRANTIES OF MERCHANTABILITY AND FOR A PARTICULAR PURPOSE WHICH EXCEED SELLER'S AFORESAID OBLIGATION ARE HEREBY DISCLAIMED BY SELLER AND EXCLUDED FROM THIS WARRANTY. Seller neither assumes, nor authorizes any person to assume for it, any other obligation in connection with the sale of its engineering designs or products. This warranty shall not apply to any products or parts of products which (a) have been repaired or altered outside of Seller's factory, in any manner; (b) have been subjected to misuse, negligence or accidents; (c) have been used in a manner contrary to Seller's instructions or recommendations. Seller shall not be responsible for design errors due to inaccurate or incomplete information supplied by Buyer or its representatives.

## 4. SELLER'S LIABILITY:

Seller will not be liable for any loss, damage, cost of repairs, incidental or consequential damages of any kind, whether based upon warranty (except for the obligation accepted by Seller under "Warranty" above), contract or negligence, arising in connection with the design, manufacture, sale, use or repair of the products or of the engineering designs supplied to Buyer.

## 5. RETURNS:

Seller cannot accept return of any products unless its written permission has been first obtained, in which case same will be credited subject to the following (a) All material returned must, on its arrival at Seller's Plant, be found to be in first-class condition; if not, cost of putting in saleable condition will be deducted from credit memoranda; (b) A handling charge deduction of twenty percent (20%) will be made from all credit memoranda issued for material returned; (c) Transportation charges, if not prepaid will be deducted from credit memoranda.

## 6. SHIPMENTS:

All products sent out will be carefully examined, counted and packed. The cost of any special packing or special handling caused by Buyer's requirements or requests shall be added to the amount of the order. No claim for shortages will be allowed unless made in writing within ten (10) days of receipt of a shipment.

Claims for products damaged or lost in transit should be made on the carrier, as Seller's responsibility ceases, and title passes, on delivery to the carrier.

## 7. SPECIAL PRODUCTS:

Orders covering special or nonstandard products are not subject to cancellation except on such terms as Seller may specify on application.

## 8. PRICES AND DESIGNS:

Prices and designs are subject to change without notice. All prices are F.O.B. Point of shipment, unless otherwise stated.

## 9. TAXES:

The amount of any sales, excise or other taxes, if any, applicable to the products covered by this order, shall be paid by Buyer unless Buyer provides Seller with an exemption certificate acceptance to the taxing authorities.

## 10. NUCLEAR PLANTS:

Where the products, engineering design or fabrication is for nuclear plant applications. Buyer agrees (a) to take all necessary steps to add Seller as an insured under the American Nuclear Insurers' (ANI) pool and under the Mutual Atomic Energy Reinsurance Pool (MAERP) for property damage and liability insurance and if necessary steps could have been taken, but are not taken, Buyer shall hold Seller harmless against all such losses which could have been thus covered (b) Buyer agrees to hold Seller harmless with respect to any personal injury (or death), property damage or other loss in a nuclear incident which is caused directly or indirectly by defective design, material, workmanship furnished by Buyer (or which could be so covered but with respect to which Buyer has elected to self-insure), and further agrees to waive subrogation by its carriers of such insurance against Seller, and (c) as to nuclear hazards for which Buyer cannot obtain insurance coverage, the liability of Seller for any personal injury (or death), property damage or other loss directly caused by defective design, material, or workmanship furnished by Seller shall not exceed the value at the time of the loss occurrence.

## 11. MINIMUM INVOICE:

Domestic: \$100 plus transportation.  
International: \$500 plus transportation.

## 12. TERMS:

Cash, net 30 days unless otherwise specified.

NOTE: All orders are accepted on the basis of prices in effect at the time of shipment.

NOTICE: The prices and terms quoted, there will be added any manufacturers or sales tax payable on the transaction under any effective statute.

FREIGHT ALLOWANCE: All prices are F.O.B. point of shipment. On (non-engineered product) shipments of 2,500 pounds or more, rail freight or motor freight at the lowest published rates is allowed to all continental U.S. rail points or all U.S. highway points listed in published tariffs (Alaska and Hawaii excluded). In no case will more than actual freight be allowed.

EXCEPTIONS: All Constant Supports, Spring Hangers, Sway Braces and all Engineered, Bundled assemblies are F.O.B. Plants, with No Freight Allowed.

# Table of Contents

Lightweight Flexible Coupling Fig. 7000† .....	4
Reducing Coupling Fig. 7010† (Coupling Complete “E” Gasket) .....	4
Gruvlok Flange Fig. 7012† (Coupling Complete “E” Gasket) .....	4
Rigidlite® Coupling Fig. 7400† .....	5
SlideLOK® Coupling Fig. 74FP .....	5
Standard 90° Elbows Fig. 7050S† for Fire Protection .....	6
Standard 45° Elbows Fig. 7051† for Fire Protection .....	6
90° Drain Elbows Fig. 7050DR .....	6
Standard Tees Fig. 7060S† for Fire Protection Fitting .....	7
Standpipe Tees Fig. 7065 .....	7
Bullhead Tees Fig. 7062 for Fire Protection Fitting .....	7
Cap Fig. 7074† .....	7
Fire-Rite Tees Fig. 7460† Short Pattern Fitting .....	8
Concentric Reducer Fig. 7072, Groove by Groove (Gr x Gr).....	8
Fire-Rite 90° Elbows Fig. 7450† Short Pattern Fitting for Fire Protection .....	8
Concentric Reducer Fig. 7076, Groove by Thread (Gr x Thd) .....	9
Mechanical Tee Products Clamp-T®, Fig. 7046 Grooved Outlet .....	10
Mechanical Tee Products Clamp-T®, Fig. 7045 with Female Threaded Outlet .....	11
Mechanical Tee Products Clamp-T® Cross, Fig. 7047.....	13
Mechanical Tee Products Clamp-T® Cross, Fig. 7048.....	15
Mechanical Tee Products Clamp-T® Cross, Fig. 7049.....	17
Steel Cross Fig. 7068.....	18
Sock-It® 90° Straight Elbow Fig. 7100.....	19
Sock-It® Straight Tee Fig. 7103 .....	19
Sock-It® Reducing Elbow Fig. 7101 .....	19
Sock-It® Reducing Outlet Tee Fig. 7105 .....	19
Sock-It® Reducing Run Outlet Tee Fig. 7106 .....	20
For use with Fig. 7000 and 7400 Coupling .....	20
LUBRICANTS .....	20
Reducing Coupling Fig. 7010 (Grade “E” Gasket) Loose.....	20
Sock-It® Coupling Fig. 7107 .....	20
For use with Fig. FP7012 (Grade “E” Gasket).....	20

**Note: Price List intended for Gruvlok Fire Products. Other Gruvlok Products may be found in GR.STD-5.19.**



# DOMESTIC FIRE PRODUCTS *Price List*

Effective Date: May 6, 2019 | Replaces Prior Date: September 2018 | Sheet # GR.FP-5.19

## Lightweight Flexible Coupling Fig. 7000<sup>†</sup>

<sup>†</sup>When ordering, refer to product as FP7000.

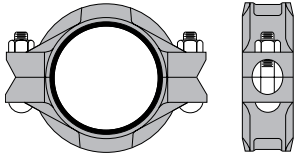

For listing / approval details contact your Gruvlok Representative.

Nominal Pipe Size (in)	Approx Weight EACH (lbs)	COUPLING COMPLETE WITH PRE-LUBRICATED GRADE E GASKET (TYPE A)				COUPLING COMPLETE WITH GRADE E FLUSH GAP™ GASKET			
		Painted		Galvanized		Painted		Galvanized	
		ITEM#	Price Ea	ITEM#	Price Ea	ITEM#	Price Ea	ITEM#	Price Ea
1 1/4	1.35	1605005980	\$66.40	1605105988	\$84.72	1605006269	\$106.47	1605106465	\$128.79
1 1/2	1.39	1605005998	\$79.56	1605105996	\$100.17	1605006277	\$119.06	1605106473	\$140.81
2	2.03	1605006004	\$82.43	1605106002	\$103.03	1605006285	\$121.92	1605106481	\$144.82
2 1/2	2.29	1605006053	\$93.87	1605106101	\$119.06	1605006293	\$144.82	1605106499	\$171.15
3	3.04	1605006103	\$108.76	1605106200	\$137.38	1605006301	\$154.55	1605106507	\$185.46
4	4.57	1605006152	\$151.69	1605106309	\$198.05	1605006319	\$219.23	1605106515	\$267.88
5	6.13	1605006186	\$218.08	1605106358	\$279.33	1605006327	\$374.92	1605106523	\$448.76
6	8.89	1605006202	\$262.16	1605106408	\$340.01	1605006335	\$414.42	1605106531	\$500.85
8	14.00	1605006210	\$409.84	1605106416	\$546.07	1605006343	\$534.62	1605106549	\$677.15

All bolts are oval-neck track head design to ASTM A-183, with heavy hex nuts to ASTM A-563, and are zinc plated to ASTM B-633. Two bolts per coupling. Spare parts available on page 12.

## Reducing Coupling Fig. 7010<sup>†</sup> (Coupling Complete "E" Gasket)

<sup>†</sup>When ordering, refer to product as FP7010.



For listing / approval details contact your Gruvlok Representative.

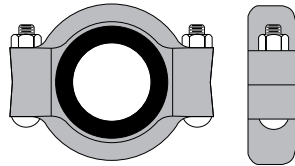

Nominal Pipe Size (in)		Approx Weight EACH (lbs)	Painted		Galvanized	
Size 1	Size 2		ITEM#	Price Ea	ITEM#	Price Ea
2	1 1/2	3.13	0390009280	\$135.66	0390111581	\$164.28
2 1/2	2	3.57	0390009306	\$176.30	0390111607	\$219.23
3	2	4.30	0390009348	\$199.20	0390111649	\$251.86
3	2 1/2	4.12	0390009389	\$173.44	0390111680	\$219.23
4	2	7.60	0390009421	\$314.82	0390111722	\$395.53
4	2 1/2	7.37	0390009439	\$281.62	0390111730	\$370.34
4	3	6.61	0390009447	\$265.02	0390111748	\$340.58
5	4	11.40	0390009488	\$354.89	0390111789	\$464.22
6	4	13.35	0390009520	\$532.90	0390111821	\$670.85
6	5	13.41	0390009546	\$467.65	0390111847	\$605.03
8	6	17.81	0390009645	\$795.64	0390111946	\$1,006.28

All bolts are oval-neck track head design to ASTM A-183, with heavy hex nuts to ASTM A-563, and are zinc plated to ASTM B-633. Spare parts available on page 12.

## Gruvlok Flange Fig. 7012<sup>†</sup> (Coupling Complete "E" Gasket)

<sup>†</sup>When ordering, refer to product as FP7012.



For listing / approval details contact your Gruvlok Representative.

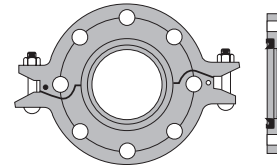

Nominal Pipe Size (in)	Approx Weight EACH (lbs)	Painted		Galvanized	
		ITEM#	Price Ea	ITEM#	Price Ea
2*	4.05	1605006723	\$293.64	1605106622	\$339.43
2 1/2	4.68	1605006731	\$341.72	1605106630	\$405.83
3*	5.94	1605006749	\$384.65	1605106648	\$461.35
4*	6.51	1605006756	\$500.28	1605106655	\$609.61
5	8.87	1605006764	\$599.88	1605106663	\$730.38
6*	9.53	1605006772	\$654.25	1605106671	\$795.06
8*	15.32	1605006780	\$820.82	1605106689	\$1,026.31

The Gruvlok Flange bolt hole pattern conforms to ANSI Class 150 and Class 125 flanges. Gruvlok Flange adapter insert required when mating to rubber surfaces or serrated faced mating flanges. Refer to Gruvlok Products Catalog or Anvil's Web site for more information on installing this flange. Mating flange bolts must be at least intermediate strength bolting per ASME B16.5. Bolts with material properties equal to or greater than SAE J429 Grade 5 are acceptable.

## Rigidlite® Coupling Fig. 7400<sup>†</sup>

<sup>†</sup>When ordering, refer to product as FP7400.

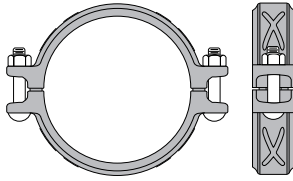

For listing / approval details contact your Gruvlok Representative.

Nominal Pipe Size (in)	Approx Weight EACH (lbs)	COUPLING COMPLETE WITH PRE-LUBRICATED GRADE E GASKET (TYPE A)				COUPLING COMPLETE WITH GRADE E FLUSH GAP™ GASKET			
		Painted		Galvanized		Painted		Galvanized	
		ITEM#	Price Ea	ITEM#	Price Ea	ITEM#	Price Ea	ITEM#	Price Ea
1 ¼	1.30	1605012283	\$61.82	1605111986	\$73.84	1605013018	\$92.16	1605112919	\$104.18
1 ½	1.40	1605012291	\$62.39	1605111994	\$75.56	1605013026	\$99.03	1605112927	\$113.91
2	1.60	1605012309	\$70.41	1605112000	\$84.14	1605013034	\$105.89	1605112935	\$122.49
2 ½	1.90	1605012358	\$80.14	1605112109	\$97.31	1605013042	\$125.36	1605112943	\$145.39
3	2.10	1605012408	\$93.30	1605112208	\$112.76	1605013059	\$135.09	1605112950	\$157.98
4	3.10	1605012457	\$131.08	1605112307	\$157.98	1605013067	\$191.18	1605112968	\$222.09
5	4.60	1605012481	\$186.60	1605112356	\$235.26	1605013091	\$321.12	1605112992	\$371.49
6	5.50	1605012507	\$224.38	1605112406	\$273.03	1605013075	\$356.03	1605112976	\$414.99
8	8.40	1605012515	\$375.49	1605112414	\$456.78	1605013083	\$576.41	1605112984	\$667.99

All bolts are oval-neck track head design to ASTM A-183, with heavy hex nuts to ASTM A-563, and are zinc plated to ASTM B-633. Two bolts per coupling. Spare parts available on page 12.

## SlideLOK® Coupling Fig. 74FP

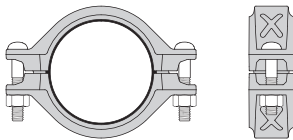

Nominal Pipe Size (in)	Approx Weight EACH (lbs)	Painted		Galvanized		Box Quantity
		ITEM#	Price Ea	ITEM#	Price Ea	
1 ¼	1.95	1605012202	\$20.61	1605111902	\$24.61	22
1 ½	2.10	1605012204	\$21.18	1605111904	\$25.19	20
2	2.69	1605012206	\$23.47	1605111906	\$28.05	15
2 ½	2.87	1605012208	\$26.90	1605111908	\$32.63	15
3	3.58	1605012210	\$30.34	1605111910	\$36.63	12
4	4.55	1605012214	\$42.93	1605111914	\$51.52	10
5	5.66	1605012216	\$74.98	1605111916	\$89.87	8
6	6.37	1605012218	\$97.88	1605111918	\$113.34	6
8	13.20	1605012220	\$161.99	1605111920	\$186.03	1

For use in Dry Pipe Systems: The SlideLOK pressure responsive gasket is featured with four sealing surfaces to increase protection in low temperature applications. Once the SlideLOK gasket is installed, the performance of the gasket is equivalent to the Gruvlok Flush Gap Gasket. Note: The Flush Gap Gasket is not interchangeable with the SlideLOK gasket.



For dry pipe systems and freezer applications lubrication of the gasket is required, Gruvlok® Xtreme™ Lubricant is required.

## Standard Dimension Fittings

### Standard 90° Elbows Fig. 7050S<sup>†</sup> for Fire Protection

<sup>†</sup>When ordering, refer to product as FP7050S.



For listing / approval details contact your Gruvlok Representative.

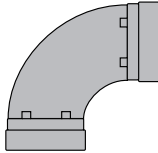

Nominal Pipe Size (in)	Approx Weight EACH (lbs)	Painted		Galvanized	
		ITEM#	Price Ea	ITEM#	Price Ea
1 ¼	1.00	1605007184	\$66.40	1605106986	\$84.14
1 ½	1.20	1605007192	\$66.40	1605106994	\$84.14
2	1.89	1605007309	\$66.40	1605107000	\$84.14
2 ½	2.80	1605007358	\$89.29	1605107109	\$119.63
3	3.75	1605007408	\$111.05	1605107208	\$156.27
4	7.40	1605007457	\$166.00	1605107307	\$234.68
5	11.40	1605007465	\$404.69	1605107315	\$530.61
6	17.50	1605007507	\$473.95	1605107406	\$652.54
8	30.60	1605007556	\$930.72	1605107414	\$1,321.67

### 90° Drain Elbows Fig. 7050DR



For listing / approval details contact your Gruvlok Representative.

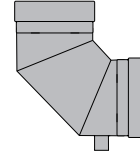

Nominal Pipe Size (in)	Approx Weight EACH (lbs)	Painted		Galvanized	
		ITEM#	Price Ea	ITEM#	Price Ea
2	2.76	5551000887	\$172.29	5551002008	\$256.44
2 ½	4.33	5551000903	\$172.29	5551002024	\$256.44
3	5.60	5551000929	\$186.60	5551002040	\$279.33
4	8.80	5551000945	\$211.22	5551002065	\$314.82
6	18.77	5551000960	\$330.85	5551002107	\$492.84
8	32.64	5551000986	\$497.99	5551002149	\$743.55

### Standard 45° Elbows Fig. 7051<sup>†</sup> for Fire Protection

<sup>†</sup>When ordering, refer to product as FP7051.



For listing / approval details contact your Gruvlok Representative.

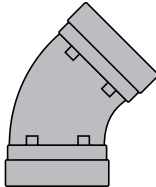

Nominal Pipe Size (in)	Approx Weight EACH (lbs)	Painted		Galvanized	
		ITEM#	Price Ea	ITEM#	Price Ea
1 ¼	0.70	1605007853	\$66.40	1605107711	\$84.14
1 ½	0.90	1605007861	\$66.40	1605107729	\$84.14
2	1.50	1605007879	\$66.40	1605107737	\$84.14
2 ½	1.90	1605007887	\$89.29	1605107745	\$119.63
3	3.30	1605007895	\$111.05	1605107752	\$156.27
4	5.40	1605007903	\$166.00	1605107760	\$234.68
5	9.00	1605007911	\$404.69	1605107778	\$530.61
6	11.20	1605007929	\$473.95	1605107786	\$652.54
8	19.80	1605007937	\$930.72	1605107794	\$1,321.67

## Standard Tees Fig. 7060S<sup>†</sup> for Fire Protection Fitting

<sup>†</sup>When ordering, refer to product as FP7060S.



For listing / approval details contact your Gruvlok Representative.

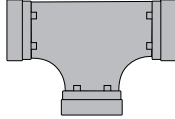

Nominal Pipe Size (in)	Approx Weight EACH (lbs)	Painted		Galvanized	
		ITEM#	Price Ea	ITEM#	Price Ea
1 ¼	1.50	1605008232	\$100.17	1605107943	\$134.51
1 ½	1.80	1605008240	\$100.17	1605107950	\$134.51
2	2.32	1605008307	\$100.17	1605108008	\$134.51
2 ½	3.93	1605008356	\$135.09	1605108107	\$184.31
3	5.65	1605008406	\$187.75	1605108206	\$258.15
4	10.50	1605008455	\$286.77	1605108305	\$397.25
5	16.40	1605008497	\$666.27	1605108354	\$889.51
6	25.73	1605008505	\$769.31	1605108404	\$1,069.82
8	41.10	1605008521	\$1,637.64	1605108412	\$2,305.05

## Bullhead Tees Fig. 7062 for Fire Protection Fitting



For listing / approval details contact your Gruvlok Representative.

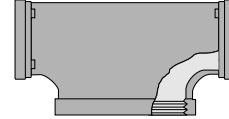

Nominal Pipe Size (in)			Approx Weight EACH (lbs)	Painted		Galvanized	
Size 1	Size 2	Size 3		ITEM#	Price Ea	ITEM#	Price Ea
5	5	8	31.00	0390019966	\$2,910.65	0390121564	\$3,668.51
6	6	8	37.60	0390019974	\$3,327.93	0390121572	\$4,114.98

\* Fabricated steel.  
Additional sizes quoted on application.

## Standpipe Tees Fig. 7065



For listing / approval details contact your Gruvlok Representative.

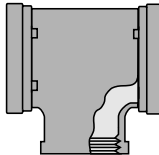

Nominal Pipe Size (in)			Approx Weight EACH (lbs)	Painted		Galvanized	
Size 1	Size 2	Size 3		ITEM#	Price Ea	ITEM#	Price Ea
4	4	2 ½	7.60	0390021608	\$541.49	0390123388	\$689.17
6	6	2 ½	11.20	0390021624	\$805.94	0390123776	\$1,003.42

\* Fabricated steel.  
Additional sizes quoted on application.

## Cap Fig. 7074<sup>†</sup>

<sup>†</sup>When ordering, refer to product as FP7074.



For listing / approval details contact your Gruvlok Representative.

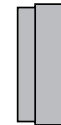

Nominal Pipe Size (in)	Approx Weight EACH (lbs)	Painted		Galvanized	
		ITEM#	Price Ea	ITEM#	Price Ea
1	0.01	1605009321	POA	1605108909	POA
1 ¼	0.50	1605009370	\$32.63	1605108917	\$50.94
1 ½	0.50	1605009388	\$34.34	1605108925	\$50.94
2	0.50	1605009396	\$41.21	1605108933	\$55.52
2 ½	0.70	1605009404	\$46.94	1605108941	\$60.10
3	1.10	1605009412	\$56.10	1605108958	\$72.12
4	2.80	1605009420	\$82.43	1605108966	\$112.76
5	4.00	1605009438	\$165.42	1605108974	\$224.95
6	6.00	1605009446	\$184.31	1605108982	\$253.57
8	0.01	1605009453	\$348.59	1605108990	\$476.81



## Fire-Rite Tees Fig. 7460<sup>†</sup> Short Pattern Fitting

†When ordering, refer to product as FP7460.



For listing / approval details contact your Gruvlok Representative.

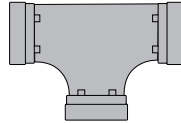

Nominal Pipe Size (in)	Approx Weight EACH (lbs)	Painted		Galvanized	
		ITEM#	Price Ea	ITEM#	Price Ea
2	2.34	1605202686	\$91.01	1605204427	\$113.34
2 1/2	3.56	1605202702	\$119.06	1605204435	\$151.69
3	4.71	1605202728	\$165.42	1605204443	\$211.79
4	7.90	1605202744	\$250.14	1605204450	\$324.55
6	19.45	1605202769	\$661.12	1605204476	\$863.18
8	38.00	1605202785	\$1,404.67	1605204492	\$1,855.15

## Fire-Rite 90° Elbows Fig. 7450<sup>†</sup> Short Pattern Fitting for Fire Protection

†When ordering, refer to product as FP7450.



For listing / approval details contact your Gruvlok Representative.

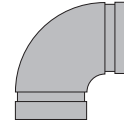

Nominal Pipe Size (in)	Approx Weight EACH (lbs)	Painted		Galvanized	
		ITEM#	Price Ea	ITEM#	Price Ea
2	1.66	1605202405	\$60.10	1605203783	\$77.27
2 1/2	2.48	1605202421	\$80.14	1605203791	\$107.61
3	3.45	1605202447	\$104.18	1605203809	\$138.52
4	5.51	1605202462	\$149.40	1605203817	\$206.06
6	14.30	1605202488	\$410.98	1605203833	\$564.39
8	25.56	1605202504	\$800.79	1605203841	\$1,139.08

## Concentric Reducer Fig. 7072, Groove by Groove (Gr x Gr)



For listing / approval details contact your Gruvlok Representative.

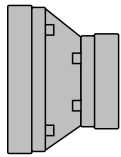

(Cast)

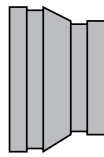

(Weld)

Nominal Run Size (in)	Outlet Size (in)	Approx Weight EACH (lbs)	Painted		Galvanized	
			ITEM#	Price Ea	ITEM#	Price Ea
1 1/4	1*	0.60	0390028199	\$563.24	0390130094	\$619.34
1 1/2	1*	0.60	0390028264	\$141.38	0390130102	\$166.00
	1 1/4*	0.60	0390028272	\$141.38	0390130110	\$166.00
2	1*	0.66	0390028330	\$141.38	0390130177	\$166.00
	1 1/4	0.75	0390028348	\$154.55	0390130185	\$180.31
	1 1/2	0.75	0390028355	\$141.38	0390130193	\$166.00
2 1/2	1*	1.00	0390028371	\$191.75	0390130219	\$220.37
	1 1/4*	1.00	0390028363	\$141.38	0390130250	\$166.00
	1 1/2*	1.30	0390028389	\$141.38	0390130227	\$166.00
	2	1.10	0390028413	\$141.38	0390130235	\$166.00
3	1*	1.20	0390028405	\$154.55	0390130243	\$179.73
	1 1/4*	1.30	0390028454	\$244.99	0390130268	\$282.19
	1 1/2*	1.30	0390028439	\$169.43	0390130276	\$206.06
	2	1.40	0390028447	\$125.36	0390130284	\$151.69
3 1/2	2 1/2*	1.58	0390028462	\$169.43	0390130300	\$204.35
	3*	1.50	0390028546	\$179.73	0390130383	\$216.37
4	1	2.20	0390028587	\$186.60	0390130425	\$228.96
	1 1/4*	2.20	0390028595	\$1,416.12	0390130433	\$1,587.27
	1 1/2*	2.30	0390028603	\$364.05	0390130441	\$401.25
	2	2.34	0390028629	\$166.00	0390130466	\$203.20
	2 1/2	2.41	0390028645	\$204.35	0390130482	\$248.42
	3	2.68	0390028660	\$204.35	0390130508	\$248.42
	3 1/2	3.60	0390028686	\$204.35	0390130524	\$248.42



## Concentric Reducer Fig. 7072, Groove by Groove (Gr x Gr) (Continued)

Nominal Run Size (in)	Outlet Size (in)	Approx Weight EACH (lbs)	Painted		Galvanized	
			ITEM#	Price Ea	ITEM#	Price Ea
5	2	4.60	0390028694	\$1,991.38	0390130607	\$2,199.16
	2 1/2*	4.50	0390028751	\$472.80	0390130615	\$514.59
	3*	4.40	0390028769	\$236.40	0390130631	\$291.92
	4	4.50	0390028785	\$281.05	0390130623	\$351.45
	1*	6.80	0390028843	\$372.06	0390130680	\$463.64
6	1 1/2*	6.90	0390028868	\$2,207.75	0390130706	\$2,516.84
	2	4.70	0390028884	\$372.06	0390130722	\$463.64
	2 1/2*	6.00	0390028892	\$413.85	0390130748	\$508.29
	3	5.40	0390028926	\$372.06	0390130763	\$463.64
	4	5.60	0390028967	\$326.27	0390130805	\$420.71
8	5	6.00	0390029007	\$479.67	0390130847	\$594.72
	3*	12.00	0390029106	\$661.69	0390130946	\$823.68
	4	10.10	0390029148	\$661.69	0390130987	\$823.68
	5*	11.50	0390029189	\$661.69	0390131027	\$832.27
	6	11.60	0390029221	\$839.14	0390131068	\$1,050.35

\* Gruvlok fittings are full flow fittings made of ductile iron except those marked (\*) which are fabricated steel.

## Concentric Reducer Fig. 7076, Groove by Thread (Gr x Thd)



For listing / approval details contact your Gruvlok Representative.

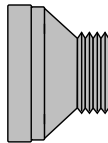

(Weld)

Nominal Run Size (in)	Outlet Size (in)	Approx Weight EACH (lbs)	Painted		Galvanized	
			ITEM#	Price Ea	ITEM#	Price Ea
1 1/2	1	0.60	0390037208	\$147.11	0390137909	\$179.73
2	3/4*	1.00	0390037018	\$147.11	0390137917	\$179.73
	1	0.80	0390037026	\$147.11	0390137925	\$179.73
	1 1/4	1.30	0390037034	\$147.11	0390137933	\$179.73
	1 1/2	1.30	0390037042	\$147.11	0390137941	\$179.73
2 1/2	1	1.00	0390036994	\$198.05	0390138402	\$227.82
	1 1/4*	1.00	0390036978	\$207.21	0390138410	\$254.72
	1 1/2*	1.30	0390037075	\$216.94	0390137867	\$254.72
	2	1.20	0390037067	\$147.11	0390137883	\$179.73
3	3/4*	1.20	0390037117	\$1,042.91	0390137966	\$1,109.88
	1*	1.20	0390037059	\$159.13	0390137958	\$192.33
	1 1/4	1.40	0390037125	\$179.73	0390137982	\$192.33
	1 1/2*	1.30	0390037091	\$179.73	0390137974	\$215.22
	2*	1.30	0390037083	\$179.73	0390137990	\$215.22
	2 1/2	1.50	0390037109	\$216.94	0390138022	\$254.72

## Concentric Reducer Fig. 7076, Groove by Thread (Gr x Thd) (Continued)

Nominal Run Size (in)	Outlet Size (in)	Approx Weight EACH (lbs)	Painted		Galvanized	
			ITEM#	Price Ea	ITEM#	Price Ea
4	1*	2.20	0390037133	\$205.49	0390138071	\$248.42
	1 ¼	2.30	0390037190	\$1,063.52	0390138097	\$1,090.99
	1 ½*	2.30	0390037141	\$477.95	0390138089	\$624.49
	2*	2.40	0390037158	\$218.08	0390138113	\$261.01
	2 ½	2.30	0390037174	\$219.23	0390138139	\$268.46
5	3	2.60	0390037182	\$267.88	0390138147	\$316.54
	4	4.50	0390037216	\$1,510.56	0390138220	\$1,642.22
6	1*	6.00	0390037240	\$413.85	0390138261	\$508.29
	1 ¼	6.00	0390037232	\$385.23	0390138378	\$526.04
	1 ½*	6.10	0390037257	\$385.23	0390138386	\$526.04
	2	6.00	0390037265	\$413.85	0390138303	\$508.29
	3	6.00	0390037281	\$413.85	0390138345	\$508.29
	4	5.90	0390037307	\$2,479.64	0390138394	\$2,745.80

\* Fabricated Steel

Reducer sizes not shown, will be priced on application.

## Mechanical Tee Products Clamp-T®, Fig. 7046 Grooved Outlet



For listing / approval details contact your Gruviok Representative

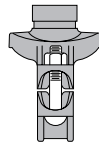
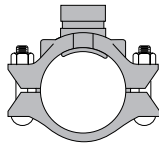

Nominal Run Size (in)	Outlet Size (in)	Approx Weight EACH (lbs)	COMPLETE WITH CLAMP-T GROOVED BRANCH					
			Painted			Galvanized		
			Grade "E" Gasket		Grade "T" Gasket		Grade "E" Gasket	
			ITEM#	Price Ea	ITEM#	Price Ea	ITEM#	Price Ea
2 ½**	1 ¼	2.50	0390173110	\$158.55	-	-	0390177111	\$193.47
	1 ½	2.09	0390173128	\$158.55	-	-	0390177129	\$193.47
3	1 ¼	3.80	0390173201	\$164.85	-	-	0390177202	\$206.06
	1 ½	3.90	0390173219	\$164.85	-	-	0390177210	\$206.06
	2	4.12	0390173243	\$189.46	-	-	0390177244	\$235.26
4	1 ¼	4.41	0390173334	\$192.33	0390174332	\$192.33	0390177335	\$226.10
	1 ½	4.23	0390173342	\$199.20	0390174340	\$199.20	0390177343	\$251.28
	2	4.60	0390173367	\$199.20	-	-	0390177368	\$253.00
	2 ½	4.68	0390173383	\$207.78	-	-	0390177384	\$269.03
	3	6.75	0390173417	\$221.52	-	-	0390177418	\$283.91
5	1 ¼	5.70	0390173482	\$239.26	0390174464	\$239.26	0390177483	\$332.56
	1 ½	5.30	0390173490	\$243.27	0390174498	\$243.27	0390177491	\$318.83
	2	6.40	0390173516	\$243.27	0390174514	\$243.27	0390177517	\$308.52
	2 ½	6.80	0390173532	\$256.44	-	-	0390177533	\$338.86
	3	8.40	0390173557	\$273.03	0390174555	\$273.03	0390177558	\$350.31

## Mechanical Tee Products Clamp-T®, Fig. 7046 Grooved Outlet (Continued)

Nominal Run Size (in)	Outlet Size (in)	Approx Weight EACH (lbs)	COMPLETE WITH CLAMP-T GROOVED BRANCH					
			Painted				Galvanized	
			Grade "E" Gasket		Grade "T" Gasket		Grade "E" Gasket	
			ITEM#	Price Ea	ITEM#	Price Ea	ITEM#	Price Ea
6	1 ¼	7.66	0390173565	\$250.14	0390174563	\$250.14	0390177566	\$318.83
	1 ½	7.17	0390173615	\$250.14	0390174613	\$250.14	0390177616	\$318.83
	2	7.13	0390173631	\$250.14	0390174639	\$250.14	0390177632	\$318.83
	2 ½	7.85	0390173664	\$273.03	-	-	0390177665	\$346.87
	3	8.37	0390173698	\$284.48	-	-	0390177699	\$366.91
	4	10.11	0390173755	\$315.96	-	-	0390177756	\$410.98
8	2	11.00	0390173805	\$434.45	-	-	0390177806	\$571.26
	2 ½	10.58	0390173821	\$434.45	-	-	0390177822	\$547.79
	3	12.20	0390173847	\$458.49	-	-	0390177848	\$581.56
	4	13.20	0390173904	\$472.23	-	-	0390177905	\$609.61

Clamp T's are available in Grade E Gasket or Grade T Buna on request.  
All bolts and nuts are of track head design and are zinc plated conforming to physical properties of ASTM B-633.  
\*\*Clamp-T supplied with U-bolt lower housing.

## Mechanical Tee Products Clamp-T®, Fig. 7045 with Female Threaded Outlet

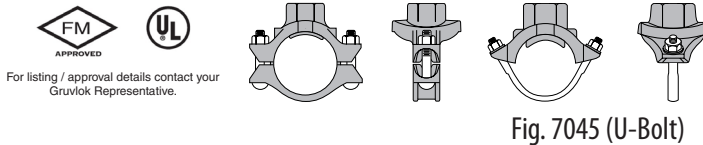

Nominal Run Size (in)	Outlet Size (in)	Approx Weight EACH (lbs)	COMPLETE WITH CLAMP-T WITH "E" GRADE GASKET FEMALE THREADED OUTLET			
			Painted		Galvanized	
			ITEM#	Price Ea	ITEM#	Price Ea
2	½**	2.30	0390171007	\$112.76	0390175008	\$142.53
	¾**	2.20	0390171015	\$112.76	0390175016	\$142.53
	1**	2.07	0390171023	\$112.76	0390175024	\$142.53
	1 ¼**	2.80	0390171031	\$130.51	0390175032	\$161.42
	1 ½**	2.56	0390171049	\$130.51	0390175040	\$162.56
2 ½	½**	2.60	0390171064	\$112.76	0390175073	\$142.53
	¾**	2.50	0390171072	\$112.76	0390175081	\$142.53
	1**	1.81	0390171080	\$112.76	0390175099	\$142.53
	1 ¼**	2.32	0390171098	\$158.55	0390175115	\$193.47
	1 ½**	2.14	0390171106	\$158.55	0390175123	\$193.47
3	½**	2.79	0390171122	\$130.51	0390175164	\$158.55
	¾**	2.75	0390171130	\$130.51	0390175172	\$158.55
	1**	2.51	0390171148	\$130.51	0390175180	\$158.55
	1 ¼	4.04	0390171155	\$164.85	0390175206	\$206.06
	1 ½	3.75	0390171163	\$164.85	0390175214	\$206.06
	2	4.04	0390171189	\$189.46	0390175248	\$235.26



# DOMESTIC FIRE PRODUCTS *Price List*

Effective Date: May 6, 2019 | Replaces Prior Date: September 2018 | Sheet # GR.FP-5.19

## Mechanical Tee Products Clamp-T<sup>®</sup>, Fig. 7045 with Female Threaded Outlet (Continued)

Nominal Run Size (in)	Outlet Size (in)	Approx Weight EACH (lbs)	COMPLETE WITH CLAMP-T WITH "E" GRADE GASKET FEMALE THREADED OUTLET			
			Painted		Galvanized	
			ITEM#	Price Ea	ITEM#	Price Ea
4	1/2**	3.21	0390171221	\$164.28	0390175305	\$195.19
	3/4**	3.17	0390171239	\$164.28	0390175313	\$195.19
	1**	3.03	0390171247	\$164.28	0390175321	\$195.19
	1 1/4	4.44	0390171254	\$192.33	0390175339	\$226.10
	1 1/2	4.40	0390171262	\$199.20	0390175347	\$251.28
	2	4.67	0390171288	\$199.20	0390175362	\$253.00
	2 1/2	5.15	0390171304	\$207.78	0390175388	\$269.03
5	3	7.09	0390171320	\$221.52	0390175412	\$283.91
	1 1/4	6.34	0390171361	\$203.77	0390175420	\$331.99
	1 1/2	6.20	0390171379	\$243.27	0390175495	\$308.52
	2	6.61	0390171395	\$243.27	0390175511	\$308.52
	2 1/2	7.24	0390171429	\$256.44	0390175537	\$326.84
6	3	8.50	0390171445	\$273.03	0390175552	\$350.31
	1 1/4	7.04	0390171486	\$208.35	0390175602	\$345.16
	1 1/2	6.86	0390171494	\$249.57	0390175610	\$318.83
	2	7.31	0390171528	\$250.14	0390175636	\$318.83
	2 1/2	7.80	0390171544	\$268.46	0390175669	\$346.87
	3	9.60	0390171569	\$284.48	0390175693	\$366.91
8	4	12.98	0390171601	\$315.96	0390175750	\$410.98
	2 ***	11.36	0390171700	\$434.45	0390175800	\$547.79
	2 1/2	11.13	0390171726	\$434.45	0390175826	\$547.79
	3	12.40	0390171767	\$458.49	0390175842	\$581.56
	4	16.00	0390171825	\$472.23	0390175909	\$609.61

Clamp T's are available with grooved or female threaded outlet with Grade E or Grade T gasket.

Weights are approximate and subject to change.

\*All bolts and nuts are of track head design and are zinc plated conforming to physical properties of ASTM B-633.

\*\*Clamp-T supplied with U-bolt lower housing.

\*\*\*Note: 8 x 2 is actually 8 x 2 1/2 bushed down.

## Mechanical Tee Products Clamp-T® Cross, Fig. 7047



For listing / approval details contact your Gruvlok Representative.

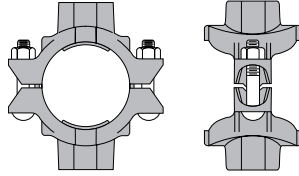

Fig. 7047 — Thread x Thread

Nominal Run Size (in)	Outlet Size (in)		Approx Weight EACH (lbs)	COMPLETE WITH CLAMP-T CROSS WITH "E" GASKET			
	Size 2	Size 3		Painted		Galvanized	
				ITEM#	Price Ea	ITEM#	Price Ea
2 1/2	1	1 *	0.01	0390088482	\$178.59	0390090546	\$227.82
	1	1 1/4 *	0.01	0390088490	\$243.84	0390090553	\$315.39
	1	1 1/2 *	0.01	0390088508	\$243.84	0390090561	\$315.39
	1 1/4	1 1/4 *	4.46	0390088607	\$243.84	0390090579	\$315.39
	1 1/2	1 1/4 *	0.01	0390088516	\$243.84	0390086650	\$315.39
	1 1/2	1 1/2 *	0.01	0390088524	\$243.84	0390086668	\$261.01
3	1	1 *	0.01	0390088615	\$199.20	0390086676	\$256.44
	1	1 1/4	0.01	0390088623	\$243.84	0390086684	\$243.84
	1	1 1/2	0.01	0390088631	\$243.84	0390086692	\$303.94
	1	2	0.01	0390088649	\$281.62	0390086700	\$348.59
	1 1/4	1 1/4	0.01	0390088755	\$243.84	0390090587	\$303.94
	1 1/2	1 1/4	0.01	0390088763	\$243.84	0390090595	\$303.94
	1 1/2	1 1/2	0.01	0390088771	\$243.84	0390090603	\$303.94
	2	1 1/4	0.01	0390088789	\$281.62	0390090611	\$348.59
	2	1 1/2	0.01	0390088797	\$281.62	0390090629	\$348.59
	2	2	6.50	0390088805	\$281.62	0390090637	\$348.59
4	1	1*	0.01	0390088813	\$243.84	0390090645	\$316.54
	1	1 1/4	0.01	0390088896	\$296.50	0390086726	\$373.78
	1	1 1/2	0.01	0390088904	\$316.54	0390086734	\$371.49
	1	2	0.01	0390088920	\$316.54	0390086742	\$373.78
	1 1/4	1 1/4	0.01	0390088821	\$296.50	0390090652	\$371.49
	1 1/2	1 1/4	0.01	0390088839	\$296.50	0390090660	\$371.49
	1 1/2	1 1/2	0.01	0390088847	\$296.50	0390090678	\$371.49
	2	1 1/4	0.01	0390088854	\$316.54	0390090686	\$373.78
	2	1 1/2	0.01	0390088862	\$316.54	0390090694	\$373.78
	2	2	7.20	0390088870	\$316.54	0390090702	\$373.78
	2 1/2	2 1/2	0.01	0390088912	\$316.54	0390090744	\$402.97
	3	3	12.00	0390088961	\$330.27	0390090793	\$426.44



# DOMESTIC FIRE PRODUCTS *Price List*

Effective Date: May 6, 2019 | Replaces Prior Date: September 2018 | Sheet # GR.FP-5.19

## Mechanical Tee Products Clamp-T® Cross, Fig. 7047 (Continued)

Nominal Run Size (in)	Outlet Size (in)		Approx Weight EACH (lbs)	COMPLETE WITH CLAMP-T CROSS WITH "E" GASKET			
	Size 2	Size 3		Painted		Galvanized	
				ITEM#	Price Ea	ITEM#	Price Ea
5	1 ½	1 ½	0.01	0390088987	\$361.76	0390090819	\$458.49
	2	1 ½	0.01	0390088995	\$381.22	0390090827	\$458.49
	2	2	0.01	0390089001	\$361.76	0390090835	\$458.49
	2 ½	1 ½	0.01	0390089019	\$381.22	0390090843	\$485.97
	2 ½	2	0.01	0390089027	\$381.22	0390090850	\$523.17
	2 ½	2 ½	0.01	0390089035	\$381.22	0390090868	\$485.97
	3	1 ½	0.01	0390089043	\$407.55	0390090876	\$523.17
	3	2	0.01	0390089050	\$407.55	0390090884	\$523.17
	3	2 ½	0.01	0390089068	\$407.55	0390090892	\$523.17
	3	3	0.01	0390089076	\$407.55	0390090900	\$523.17
6	1 ½	1 ½	0.01	0390089092	\$370.34	0390090926	\$476.81
	2	1 ½	0.01	0390089100	\$370.34	0390090934	\$476.81
	2	2	7.90	0390089118	\$385.80	0390090942	\$514.59
	2 ½	2 ½	0.01	0390089126	\$397.25	0390090959	\$514.59
	3	2 ½	0.01	0390089159	\$425.29	0390090983	\$544.92
	3	3	9.60	0390089183	\$425.29	0390091015	\$544.92
	4	2 ½	0.01	0390089191	\$469.94	0390091049	\$609.61
	4	3	0.01	0390089225	\$469.94	0390091056	\$609.61
	4	4	0.01	0390089233	\$469.94	0390091064	\$609.61
	4	4	0.01	0390089258	\$649.67	0390091072	\$819.68
8	3	2 ½	0.01	0390089266	\$683.45	0390091098	\$868.33
	3	3	16.00	0390089274	\$683.45	0390091106	\$868.33
	4	2 ½	0.01	0390089282	\$706.91	0390091114	\$912.98
	4	3	18.00	0390089290	\$706.91	0390091122	\$912.98
	4	4	16.00	0390089308	\$706.91	0390091130	\$912.98

\*Available with female threaded outlet only.

Always Verify Figure Number for Appropriate Combination of Outlets.

**Always specify gasket grade when ordering. Some additional configurations available. Contact your Anvil Representative for details.**

## Mechanical Tee Products Clamp-T® Cross, Fig. 7048



For listing / approval details contact your Gruvlok Representative.

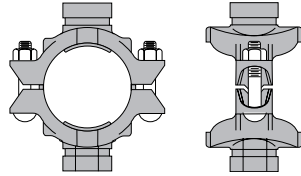

Fig. 7048 — Groove x Groove

Nominal Run Size (in)	Outlet Size (in)		Approx Weight EACH (lbs)	COMPLETE WITH CLAMP-T CROSS WITH "E" GASKET			
	Size 2	Size 3		Painted		Galvanized	
				ITEM#	Price Ea	ITEM#	Price Ea
2 1/2	1	1*	0.01	0390089316	\$178.59	0390091148	\$227.82
	1	1 1/4*	0.01	0390089324	\$243.84	0390091155	\$315.39
	1	1 1/2*	0.01	0390089332	\$243.84	0390091163	\$315.39
	1 1/4	1 1/4*	4.60	0390086437	\$243.84	0390091171	\$315.39
	1 1/2	1 1/4*	0.01	0390086445	\$243.84	0390086767	\$315.39
	1 1/2	1 1/2*	4.50	0390086452	\$243.84	0390086775	\$261.01
3	1	1*	0.01	0390086460	\$199.20	0390086783	\$255.29
	1	1 1/4	0.01	0390086478	\$243.84	0390086791	\$243.27
	1	1 1/2	0.01	0390086486	\$243.84	0390086809	\$303.94
	1	2	0.01	0390086494	\$281.62	0390086817	\$348.59
	1 1/4	1 1/4	0.01	0390089340	\$243.84	0390086825	\$303.94
	1 1/2	1 1/4	0.01	0390089357	\$243.84	0390091189	\$303.94
	1 1/2	1 1/2	5.35	0390089365	\$243.84	0390091197	\$303.94
	2	1 1/4	0.01	0390089373	\$281.62	0390091205	\$348.59
	2	1 1/2	0.01	0390089381	\$281.62	0390091213	\$348.59
	2	2	6.00	0390089399	\$281.62	0390086833	\$348.59
4	1	1 1/4	0.01	0390086502	\$296.50	0390091239	\$371.49
	1	1 1/2	0.01	0390086510	\$316.54	0390086841	\$372.06
	1	2	0.01	0390086528	\$316.54	0390086858	\$372.63
	1 1/4	1 1/4	6.00	0390089415	\$296.50	0390091247	\$371.49
	1 1/2	1 1/4	0.01	0390089423	\$296.50	0390091254	\$371.49
	1 1/2	1 1/2	5.75	0390089431	\$295.93	0390091262	\$370.34
	2	1 1/4	7.23	0390089449	\$316.54	0390091270	\$373.78
	2	1 1/2	0.01	0390089456	\$316.54	0390091288	\$373.78
	2	2	6.00	0390089464	\$316.54	0390091296	\$373.78
	2 1/2	2 1/2	7.50	0390089506	\$316.54	0390091338	\$402.97
3	3	10.40	0390089555	\$328.56	0390091387	\$426.44	





# DOMESTIC FIRE PRODUCTS *Price List*

Effective Date: May 6, 2019 | Replaces Prior Date: September 2018 | Sheet # GR.FP-5.19

## Mechanical Tee Products Clamp-T® Cross, Fig. 7048 (Continued)

Nominal Run Size (in)	Outlet Size (in)		Approx Weight EACH (lbs)	COMPLETE WITH CLAMP-T CROSS WITH "E" GASKET			
	Size 2	Size 3		Painted		Galvanized	
				ITEM#	Price Ea	ITEM#	Price Ea
5	1 ½	1 ½	0.01	0390089571	\$361.76	0390091403	\$458.49
	2	1 ½	0.01	0390089589	\$381.22	0390091411	\$458.49
	2	2	0.01	0390089597	\$361.76	0390091429	\$458.49
	2 ½	1 ½	0.01	0390089605	\$381.22	0390091437	\$485.97
	2 ½	2	0.01	0390089613	\$381.22	0390091445	\$523.17
	2 ½	2 ½	7.40	0390089621	\$379.50	0390091452	\$458.49
	3	1 ½	0.01	0390089639	\$407.55	0390091460	\$559.81
	3	2	0.01	0390089647	\$407.55	0390091478	\$523.17
	3	2 ½	0.01	0390089654	\$407.55	0390091486	\$523.17
	3	3	8.70	0390089662	\$407.55	0390091494	\$523.17
6	1 ½	1 ½	0.01	0390089688	\$370.34	0390091510	\$476.81
	2	1 ½	0.01	0390089696	\$370.34	0390091528	\$476.81
	2	2	8.41	0390089704	\$385.80	0390091536	\$514.59
	2 ½	2 ½	0.01	0390089712	\$397.25	0390091544	\$514.59
	3	2 ½	0.01	0390089746	\$425.29	0390091577	\$544.92
	3	3	12.00	0390089779	\$425.29	0390091601	\$544.92
	4	2 ½	0.01	0390089803	\$469.94	0390091635	\$609.61
	4	3	0.01	0390089811	\$469.94	0390091643	\$609.61
	4	4	14.25	0390089829	\$469.94	0390091650	\$609.61
	4	4	11.78	0390089845	\$649.67	0390091676	\$819.68
8	3	2 ½	0.01	0390089852	\$683.45	0390091684	\$868.33
	3	3	16.00	0390089860	\$683.45	0390091692	\$868.33
	4	2 ½	0.01	0390089878	\$706.91	0390091700	\$912.98
	4	3	0.01	0390089886	\$706.91	0390091718	\$912.98
	4	4	0.01	0390089894	\$706.91	0390091726	\$912.98

\*Available with female threaded outlet only.

Always Verify Figure Number for Appropriate Combination of Outlets.

Always specify gasket grade when ordering. Some additional configurations available. Contact your Anvil Representative for details.

## Mechanical Tee Products Clamp-T® Cross, Fig. 7049



For listing / approval details contact your Gruvlok Representative.

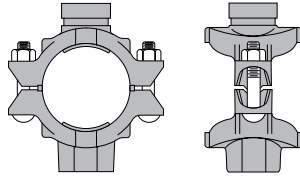

Fig. 7049 — Groove x Thread

Run Size (in)	Outlet Size (in)		COMPLETE WITH CLAMP-T CROSS WITH "E" GASKET			
	Size 2	Size 3	Painted		Galvanized	
			ITEM#	Price Ea	ITEM#	Price Ea
2 1/2	1	1*	0390089902	\$178.59	0390091734	\$227.82
	1	1 1/4*	0390089910	\$243.84	-	-
	1	1 1/2*	0390089928	\$243.84	-	-
	1 1/4	1 1/4*	0390086536	\$243.84	0390091742	\$315.39
	1 1/2	1 1/4*	0390086544	\$243.84	0390086874	\$317.11
	1 1/2	1 1/2*	0390086551	\$261.01	0390091759	\$315.39
3	1	1*	0390086569	\$199.20	0390086890	\$256.44
	1	1 1/4	0390086577	\$243.84	0390086908	\$243.84
	1	1 1/2	0390086585	\$243.84	0390086916	\$303.94
	1	2	0390086593	\$281.62	0390086924	\$348.59
	1 1/4	1 1/4	0390089936	\$243.84	0390091767	\$303.94
	1 1/2	1 1/4	0390089944	\$243.84	0390091775	\$303.94
	1 1/2	1 1/2	0390089951	\$243.84	0390091783	\$303.94
	2	1 1/4	0390089969	\$281.62	0390091791	\$348.59
	2	1 1/2	0390089977	\$281.62	0390091809	\$348.59
4	2	2	0390089985	\$281.62	0390091817	\$348.59
	1	1 1/4	0390086619	\$296.50	0390086940	\$373.78
	1	1 1/2	0390086627	\$316.54	0390086957	\$371.49
	1	2	0390086635	\$316.54	0390086965	\$373.78
	1 1/4	1 1/4	0390090009	\$296.50	-	-
	1 1/2	1 1/4	0390090017	\$296.50	0390091841	\$371.49
	1 1/2	1 1/2	0390090025	\$296.50	0390091858	\$371.49
	2	1 1/4	0390090033	\$316.54	0390091866	\$373.78
	2	1 1/2	0390090041	\$316.54	0390091874	\$373.78
	2	2	0390090058	\$316.54	0390091882	\$373.78
5	2 1/2	2 1/2	0390090082	\$316.54	0390091924	\$402.97
	3	3	0390090165	\$330.27	0390091973	\$426.44
	1 1/2	1 1/2	0390090181	\$361.76	0390091999	\$458.49
	2	1 1/2	0390090199	\$381.22	0390092005	\$458.49
	2	2	0390090215	\$361.76	0390092013	\$458.49
	2 1/2	1 1/2	0390090231	\$381.22	0390092021	\$485.97
	2 1/2	2	0390090256	\$381.22	0390092039	\$523.17
	2 1/2	2 1/2	0390090264	\$381.22	0390092047	\$485.97
	3	1 1/2	0390090272	\$407.55	0390092054	\$523.17
	3	2	0390090280	\$407.55	0390092062	\$523.17
5	3	2 1/2	0390090298	\$407.55	0390092070	\$523.17
	3	3	0390090306	\$407.55	0390092088	\$523.17

## Mechanical Tee Products Clamp-T® Cross, Fig. 7049 (Continued)

Run Size (in)	Outlet Size (in)		COMPLETE WITH CLAMP-T CROSS WITH "E" GASKET			
	Size 2	Size 3	Painted		Galvanized	
			ITEM#	Price Ea	ITEM#	Price Ea
6	1 ½	1 ½	0390090322	\$370.34	0390092104	\$476.81
	2	1 ½	0390090330	\$370.34	0390092112	\$476.81
	2	2	0390090348	\$385.80	0390092120	\$514.59
	2 ½	2 ½	0390090355	\$397.25	0390092138	\$514.59
	3	2 ½	0390090389	\$425.29	0390092161	\$544.92
	3	3	0390090413	\$425.29	0390092195	\$544.92
	4	2 ½	0390090447	\$469.94	0390092229	\$609.61
	4	3	0390090454	\$469.94	0390092237	\$609.61
	4	4	0390090462	\$469.94	0390092245	\$609.61
	8	2 ½	2 ½	0390090488	\$649.67	0390092260
3		2 ½	0390090496	\$683.45	0390092278	\$868.33
3		3	0390090504	\$683.45	0390092286	\$868.33
4		2 ½	0390090512	\$706.91	0390092294	\$912.98
4		3	0390090520	\$706.91	0390092302	\$912.98
4		4	0390090538	\$706.91	0390092310	\$912.98

\*Available with female threaded outlet only.

Always Verify Figure Number for Appropriate Combination of Outlets.

Always specify gasket grade when ordering. Some additional configurations available. Contact your Anvil Representative for details.

## Steel Cross Fig. 7068



For listing / approval details contact your Gruvlok Representative.

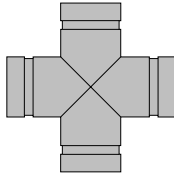

Nominal Pipe Size (in)	Approx Weight EACH (lbs)	Painted		Galvanized	
		ITEM#	Price Ea	ITEM#	Price Ea
1	1.30	0390023869	\$448.19	0390125334	\$516.30
1 ¼	2.10	0390023877	\$538.06	0390125342	\$626.21
1 ½	2.50	0390023885	\$579.27	0390125359	\$671.43
2	2.90	0390023943	\$331.42	0390125367	\$394.38
2 ½	5.20	0390023984	\$331.42	0390125375	\$394.38
3	7.50	0390024024	\$588.43	0390125383	\$720.08
3 ½	9.80	0390024032	\$1,181.43	0390125391	\$1,408.10
4	12.20	0390024107	\$974.80	0390125409	\$1,199.75
5	17.60	0390024149	\$1,986.23	0390125417	\$2,392.63
6	28.30	0390024180	\$2,547.75	0390125425	\$3,092.68
8	48.00	0390024222	\$3,356.55	0390126084	\$4,152.19

## Sock-It® Fittings

### Sock-It® 90° Straight Elbow Fig. 7100



For listing / approval details contact your Gruvlok Representative.

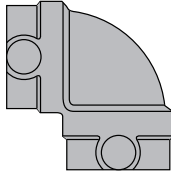

Nominal Run Size (in)	Approx Weight EACH (lbs)	Box Quantity	PRICE PER UNIT "E" GASKET BLACK	
			ITEM#	Price Ea
1	2.15	10	0390043420	\$89.29
1 ¼	2.65	10	0390043446	\$103.60
1 ½	3.21	8	0390043461	\$113.34
2	4.85	10	0390043487	\$133.37

Provided in carton quantity only.  
Grade E gaskets unless otherwise specified.

### Sock-It® Reducing Elbow Fig. 7101



For listing / approval details contact your Gruvlok Representative.

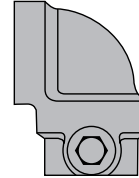

Nominal Run Size (in)	Outlet Size (in)	Approx Weight EACH (lbs)	Box Quantity	PRICE PER UNIT "E" GASKET BLACK	
				ITEM#	Price Ea
1	½	1.64	10	0390043602	\$105.89
	¾	1.64	45	0390043610	\$105.89
	1	1.64	10	0390043628	\$105.89
1 ¼	½	1.99	30	0390043636	\$109.33
	¾	1.99	30	0390043644	\$109.33
	1	1.99	30	0390043651	\$109.33
1 ½	½	2.34	30	0390043669	\$112.76
	¾	2.34	10	0390043677	\$112.76
	1	2.34	10	0390043685	\$112.76

Provided in carton quantity only.  
Grade E gaskets unless otherwise specified.

### Sock-It® Straight Tee Fig. 7103



For listing / approval details contact your Gruvlok Representative.

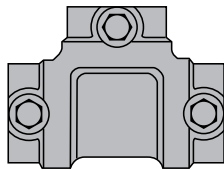

Nominal Run Size (in)	Approx Weight EACH (lbs)	Box Quantity	PRICE PER UNIT "E" GASKET BLACK	
			ITEM#	Price Ea
1	2.95	8	0390043800	\$136.23
1 ¼	3.80	8	0390043818	\$143.67
1 ½	4.57	6	0390043826	\$167.14
2	7.70	10	0390043834	\$174.58

Provided in carton quantity only.  
Grade E gaskets unless otherwise specified.

### Sock-It® Reducing Outlet Tee Fig. 7105



For listing / approval details contact your Gruvlok Representative.

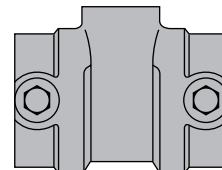

Nominal Run Size 1 (in)	Nominal Run Size 2 (in)	Outlet Size (in)	Approx Weight EACH (lbs)	Box Quantity	PRICE PER UNIT "E" GASKET BLACK	
					ITEM#	Price Ea
1	1	½	2.53	30	0390045060	\$84.14
		¾	2.53	30	0390045086	\$84.14
		1	2.53	10	0390045102	\$84.14
1 ¼	1 ¼	½	2.78	8	0390045185	\$84.14
		¾	2.78	8	0390045201	\$84.14
		1	2.78	8	0390045227	\$84.14
1 ½	1 ½	½	3.30	25	0390045300	\$88.72
		¾	3.30	25	0390045326	\$88.72
		1	3.30	8	0390045342	\$88.72
2	2	½	4.40	15	0390045425	\$107.61
		¾	4.40	15	0390045441	\$107.61
		1	4.40	6	0390045466	\$107.61
2 ½	2 ½	¾	6.37	5	0390045508	\$143.67
		1	6.37	5	0390045516	\$143.67

Provided in carton quantity only.  
Grade E gaskets unless otherwise specified.

## Sock-It® Reducing Run Outlet Tee Fig. 7106



For listing / approval details contact your Gruvlok Representative.

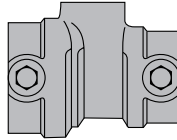

## Sock-It® Coupling Fig. 7107



For listing / approval details contact your Gruvlok Representative.

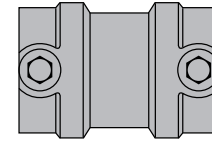

Nominal Run Size (in)		Outlet Size (in)	Approx Weight EACH (lbs)	Box Quantity	PRICE PER UNIT "E" GASKET BLACK	
Size 1	Size 2				ITEM#	Price Ea
1 ¼	1	½	2.68	30	0390045128	\$89.87
		¾	2.68	30	0390045144	\$89.87
		1	2.68	10	0390045169	\$89.87
1 ½	1 ¼	½	3.10	25	0390045243	\$96.16
		¾	3.10	25	0390045268	\$96.16
		1	3.10	25	0390045284	\$96.16
2	1 ½	½	3.94	15	0390045367	\$113.91
		¾	3.94	15	0390045383	\$113.91
		1	3.94	15	0390045409	\$113.91

Nominal Run Size (in)	Approx Weight EACH (lbs)	Box Quantity	PRICE PER UNIT "E" GASKET BLACK	
			ITEM#	Price Ea
1	1.80	15	0390046092	\$80.14
1 ¼	2.30	10	0390046100	\$80.14
1 ½	2.63	10	0390046126	\$100.17
2	3.76	8	0390046142	\$100.17

Provided in carton quantity only.  
Grade E gaskets unless otherwise specified.

Provided in carton quantity only.  
Grade E gaskets unless otherwise specified.

## Spare Parts

For use with Fig. 7000 and 7400 Coupling (Pre-Lubricated Grade E Type A Gasket)

Nominal Pipe Size (in)	Spare Parts Type A Gasket Only	
	ITEM#	Price Ea
1 ¼	1605113495	\$48.65
1 ½	1605113503	\$50.37
2	1605113511	\$52.66
2 ½	1605113529	\$63.54
3	1605113537	\$72.12
4	1605113545	\$89.29
5	1605113552	\$116.77
6	1605113560	\$129.36
8	1605113578	\$184.89

Pre-Lubricated Gaskets are non-cancellable and non-returnable.

## Reducing Coupling Fig. 7010 (Grade "E" Gasket) Loose

Nominal Pipe Size (in)		Spare Parts "E" Gasket Only	
Size 1	Size 2	ITEM#	Price Ea
2	1 ½	0390080406	\$52.09
2 ½	2	0390080414	\$66.97
3	2	0390080422	\$76.13
3	2 ½	0390080430	\$76.13
4	2	0390080448	\$88.72
4	2 ½	0390080455	\$89.29
4	3	0390080463	\$91.58
5	4	0390080471	\$106.47
6	4	0390080489	\$121.35
6	5	0390080497	\$132.80
8	6	0390080505	\$147.11

Gaskets are non-cancellable and non-returnable.

## For use with Fig. FP7012 (Grade "E" Gasket)

Nominal Pipe Size (in)	Spare Parts "E" Gasket Only	
	ITEM#	Price Ea
2	1605113206	\$45.22
2 ½	1605113214	\$52.66
3	1605113222	\$56.10
4	1605113230	\$72.69
5	1605113248	\$87.58
6	1605113255	\$98.45
8	1605113263	\$132.22

Gaskets are non-cancellable and non-returnable.

## LUBRICANTS

### STANDARD LUBRICANT

Size	ITEM#	Price Ea
2 lb Tub	0390163046	\$286.20
5 gal Pail	0390163053	\$2,394.92
1 qt Can	0390163137	\$289.06

### XTREME LUBRICANT (SILICONE)

Size	ITEM#	Price Ea
10 oz Tube	0390162881	\$144.24
2.2 lb Tub	0390163103	\$497.99

# Numerical Index

0390009280.....	4	1605006764.....	4	1605007358.....	6	0390019974.....	7
0390111581.....	4	1605106663.....	4	1605107109.....	6	0390121572.....	7
0390009306.....	4	1605006772.....	4	1605007408.....	6	1605009321.....	7
0390111607.....	4	1605106671.....	4	1605107208.....	6	1605108909.....	7
0390009348.....	4	1605006780.....	4	1605007457.....	6	1605009370.....	7
0390111649.....	4	1605106689.....	4	1605107307.....	6	1605108917.....	7
0390009389.....	4	1605012283.....	5	1605007465.....	6	1605009388.....	7
0390111680.....	4	1605111986.....	5	1605107315.....	6	1605108925.....	7
0390009421.....	4	1605013018.....	5	1605007507.....	6	1605009396.....	7
0390111722.....	4	1605112919.....	5	1605107406.....	6	1605108933.....	7
0390009439.....	4	1605012291.....	5	1605007556.....	6	1605009404.....	7
0390111730.....	4	1605111994.....	5	1605107414.....	6	1605108941.....	7
0390009447.....	4	1605013026.....	5	1605007853.....	6	1605009412.....	7
0390111748.....	4	1605112927.....	5	1605107711.....	6	1605108958.....	7
0390009488.....	4	1605012309.....	5	1605007861.....	6	1605009420.....	7
0390111789.....	4	1605112000.....	5	1605107729.....	6	1605108966.....	7
0390009520.....	4	1605013034.....	5	1605007879.....	6	1605009438.....	7
0390111821.....	4	1605112935.....	5	1605107737.....	6	1605108974.....	7
0390009546.....	4	1605012358.....	5	1605007887.....	6	1605009446.....	7
0390111847.....	4	1605112109.....	5	1605107745.....	6	1605108982.....	7
0390009645.....	4	1605013042.....	5	1605007895.....	6	1605009453.....	7
0390111946.....	4	1605112943.....	5	1605107752.....	6	1605108990.....	7
1605005980.....	4	1605012408.....	5	1605007903.....	6	1605202686.....	8
1605105988.....	4	1605112208.....	5	1605107760.....	6	1605204427.....	8
1605006269.....	4	1605013059.....	5	1605007911.....	6	1605202702.....	8
1605106465.....	4	1605112950.....	5	1605107778.....	6	1605204435.....	8
1605005998.....	4	1605012457.....	5	1605007929.....	6	1605202728.....	8
1605105996.....	4	1605112307.....	5	1605107786.....	6	1605204443.....	8
1605006277.....	4	1605013067.....	5	1605007937.....	6	1605202744.....	8
1605106473.....	4	1605112968.....	5	1605107794.....	6	1605204450.....	8
1605006004.....	4	1605012481.....	5	5551000887.....	6	1605202769.....	8
1605106002.....	4	1605112356.....	5	5551002008.....	6	1605204476.....	8
1605006285.....	4	1605013091.....	5	5551000903.....	6	1605202785.....	8
1605106481.....	4	1605112992.....	5	5551002024.....	6	1605204492.....	8
1605006053.....	4	1605012507.....	5	5551000929.....	6	0390028199.....	8
1605106101.....	4	1605112406.....	5	5551002040.....	6	0390130094.....	8
1605006293.....	4	1605013075.....	5	5551000945.....	6	0390028264.....	8
1605106499.....	4	1605112976.....	5	5551002065.....	6	0390130102.....	8
1605006103.....	4	1605012515.....	5	5551000960.....	6	0390028272.....	8
1605106200.....	4	1605112414.....	5	5551002107.....	6	0390130110.....	8
1605006301.....	4	1605013083.....	5	5551000986.....	6	0390028330.....	8
1605106507.....	4	1605112984.....	5	5551002149.....	6	0390130177.....	8
1605006152.....	4	1605012202.....	5	1605008232.....	7	0390028348.....	8
1605106309.....	4	1605111902.....	5	1605107943.....	7	0390130185.....	8
1605006319.....	4	1605012204.....	5	1605008240.....	7	0390028355.....	8
1605106515.....	4	1605111904.....	5	1605107950.....	7	0390130193.....	8
1605006186.....	4	1605012206.....	5	1605008307.....	7	0390028371.....	8
1605106358.....	4	1605111906.....	5	1605108008.....	7	0390130219.....	8
1605006327.....	4	1605012208.....	5	1605008356.....	7	0390028363.....	8
1605106523.....	4	1605111908.....	5	1605108107.....	7	0390130250.....	8
1605006202.....	4	1605012210.....	5	1605008406.....	7	0390028389.....	8
1605106408.....	4	1605111910.....	5	1605108206.....	7	0390130227.....	8
1605006335.....	4	1605012214.....	5	1605008455.....	7	0390028413.....	8
1605106531.....	4	1605111914.....	5	1605108305.....	7	0390130235.....	8
1605006210.....	4	1605012216.....	5	1605008497.....	7	0390028405.....	8
1605106416.....	4	1605111916.....	5	1605108354.....	7	0390130243.....	8
1605006343.....	4	1605012218.....	5	1605008505.....	7	0390028454.....	8
1605106549.....	4	1605111918.....	5	1605108404.....	7	0390130268.....	8
1605006723.....	4	1605012220.....	5	1605008521.....	7	0390028439.....	8
1605106622.....	4	1605111920.....	5	1605108412.....	7	0390130276.....	8
1605006731.....	4	1605007184.....	6	0390021608.....	7	0390028447.....	8
1605106630.....	4	1605106986.....	6	0390123388.....	7	0390130284.....	8
1605006749.....	4	1605007192.....	6	0390021624.....	7	0390028462.....	8
1605106648.....	4	1605106994.....	6	0390123776.....	7	0390130300.....	8
1605006756.....	4	1605007309.....	6	0390019966.....	7	0390028546.....	8
1605106655.....	4	1605107000.....	6	0390121564.....	7	0390130383.....	8

0390028587.....	8	0390036994.....	9	0390173417.....	10	0390175206.....	11
0390130425.....	8	0390138402.....	9	0390177418.....	10	0390171163.....	11
0390028595.....	8	0390036978.....	9	0390173482.....	10	0390175214.....	11
0390130433.....	8	0390138410.....	9	0390174464.....	10	0390171189.....	11
0390028603.....	8	0390037075.....	9	0390177483.....	10	0390175248.....	11
0390130441.....	8	0390137867.....	9	0390173490.....	10	0390171221.....	12
0390028629.....	8	0390037067.....	9	0390174498.....	10	0390175305.....	12
0390130466.....	8	0390137883.....	9	0390177491.....	10	0390171239.....	12
0390028645.....	8	0390037117.....	9	0390173516.....	10	0390175313.....	12
0390130482.....	8	0390137966.....	9	0390174514.....	10	0390171247.....	12
0390028660.....	8	0390037059.....	9	0390177517.....	10	0390175321.....	12
0390130508.....	8	0390137958.....	9	0390173532.....	10	0390171254.....	12
0390028686.....	8	0390037125.....	9	0390177533.....	10	0390175339.....	12
0390130524.....	8	0390137982.....	9	0390173557.....	10	0390171262.....	12
0390028694.....	9	0390037091.....	9	0390174555.....	10	0390175347.....	12
0390130607.....	9	0390137974.....	9	0390177558.....	10	0390171288.....	12
0390028751.....	9	0390037083.....	9	0390173565.....	11	0390175362.....	12
0390130615.....	9	0390137990.....	9	0390174563.....	11	0390171304.....	12
0390028769.....	9	0390037109.....	9	0390177566.....	11	0390175388.....	12
0390130631.....	9	0390138022.....	9	0390173615.....	11	0390171320.....	12
0390028785.....	9	0390037133.....	10	0390174613.....	11	0390175412.....	12
0390130623.....	9	0390138071.....	10	0390177616.....	11	0390171361.....	12
0390028843.....	9	0390037190.....	10	0390173631.....	11	0390175420.....	12
0390130680.....	9	0390138097.....	10	0390174639.....	11	0390171379.....	12
0390028868.....	9	0390037141.....	10	0390177632.....	11	0390175495.....	12
0390130706.....	9	0390138089.....	10	0390173664.....	11	0390171395.....	12
0390028884.....	9	0390037158.....	10	0390177665.....	11	0390175511.....	12
0390130722.....	9	0390138113.....	10	0390173698.....	11	0390171429.....	12
0390028892.....	9	0390037174.....	10	0390177699.....	11	0390175537.....	12
0390130748.....	9	0390138139.....	10	0390173755.....	11	0390171445.....	12
0390028926.....	9	0390037182.....	10	0390177756.....	11	0390175552.....	12
0390130763.....	9	0390138147.....	10	0390173805.....	11	0390171486.....	12
0390028967.....	9	0390037216.....	10	0390177806.....	11	0390175602.....	12
0390130805.....	9	0390138220.....	10	0390173821.....	11	0390171494.....	12
0390029007.....	9	0390037240.....	10	0390177822.....	11	0390175610.....	12
0390130847.....	9	0390138261.....	10	0390173847.....	11	0390171528.....	12
0390029106.....	9	0390037232.....	10	0390177848.....	11	0390175636.....	12
0390130946.....	9	0390138378.....	10	0390173904.....	11	0390171544.....	12
0390029148.....	9	0390037257.....	10	0390177905.....	11	0390175669.....	12
0390130987.....	9	0390138386.....	10	0390171007.....	11	0390171569.....	12
0390029189.....	9	0390037265.....	10	0390175008.....	11	0390175693.....	12
0390131027.....	9	0390138303.....	10	0390171015.....	11	0390171601.....	12
0390029221.....	9	0390037281.....	10	0390175016.....	11	0390175750.....	12
0390131068.....	9	0390138345.....	10	0390171023.....	11	0390171700.....	12
1605202405.....	8	0390037307.....	10	0390175024.....	11	0390175800.....	12
1605203783.....	8	0390138394.....	10	0390171031.....	11	0390171726.....	12
1605202421.....	8	0390173110.....	10	0390175032.....	11	0390175826.....	12
1605203791.....	8	0390177111.....	10	0390171049.....	11	0390171767.....	12
1605202447.....	8	0390173128.....	10	0390175040.....	11	0390175842.....	12
1605203809.....	8	0390177129.....	10	0390171064.....	11	0390171825.....	12
1605202462.....	8	0390173201.....	10	0390175073.....	11	0390175909.....	12
1605203817.....	8	0390177202.....	10	0390171072.....	11	0390088482.....	13
1605202488.....	8	0390173219.....	10	0390175081.....	11	0390090546.....	13
1605203833.....	8	0390177210.....	10	0390171080.....	11	0390088490.....	13
1605202504.....	8	0390173243.....	10	0390175099.....	11	0390090553.....	13
1605203841.....	8	0390177244.....	10	0390171098.....	11	0390088508.....	13
0390037208.....	9	0390173334.....	10	0390175115.....	11	0390090561.....	13
0390137909.....	9	0390174332.....	10	0390171106.....	11	0390088607.....	13
0390037018.....	9	0390177335.....	10	0390175123.....	11	0390090579.....	13
0390137917.....	9	0390173342.....	10	0390171122.....	11	0390088516.....	13
0390037026.....	9	0390174340.....	10	0390175164.....	11	0390086650.....	13
0390137925.....	9	0390177343.....	10	0390171130.....	11	0390088524.....	13
0390037034.....	9	0390173367.....	10	0390175172.....	11	0390086668.....	13
0390137933.....	9	0390177368.....	10	0390171148.....	11	0390088615.....	13
0390037042.....	9	0390173383.....	10	0390175180.....	11	0390086676.....	13
0390137941.....	9	0390177384.....	10	0390171155.....	11	0390088623.....	13



0390086684.....	13	0390090942.....	14	0390091254.....	15	0390089928.....	17
0390088631.....	13	0390089126.....	14	0390089431.....	15	0390086536.....	17
0390086692.....	13	0390090959.....	14	0390091262.....	15	0390091742.....	17
0390088649.....	13	0390089159.....	14	0390089449.....	15	0390086544.....	17
0390086700.....	13	0390090983.....	14	0390091270.....	15	0390086874.....	17
0390088755.....	13	0390089183.....	14	0390089456.....	15	0390086551.....	17
0390090587.....	13	0390091015.....	14	0390091288.....	15	0390091759.....	17
0390088763.....	13	0390089191.....	14	0390089464.....	15	0390086569.....	17
0390090595.....	13	0390091049.....	14	0390091296.....	15	0390086890.....	17
0390088771.....	13	0390089225.....	14	0390089506.....	15	0390086577.....	17
0390090603.....	13	0390091056.....	14	0390091338.....	15	0390086908.....	17
0390088789.....	13	0390089233.....	14	0390089555.....	15	0390086585.....	17
0390090611.....	13	0390091064.....	14	0390091387.....	15	0390086916.....	17
0390088797.....	13	0390089258.....	14	0390089571.....	16	0390086593.....	17
0390090629.....	13	0390091072.....	14	0390091403.....	16	0390086924.....	17
0390088805.....	13	0390089266.....	14	0390089589.....	16	0390089936.....	17
0390090637.....	13	0390091098.....	14	0390091411.....	16	0390091767.....	17
0390088813.....	13	0390089274.....	14	0390089597.....	16	0390089944.....	17
0390090645.....	13	0390091106.....	14	0390091429.....	16	0390091775.....	17
0390088896.....	13	0390089282.....	14	0390089605.....	16	0390089951.....	17
0390086726.....	13	0390091114.....	14	0390091437.....	16	0390091783.....	17
0390088904.....	13	0390089290.....	14	0390089613.....	16	0390089969.....	17
0390086734.....	13	0390091122.....	14	0390091445.....	16	0390091791.....	17
0390088920.....	13	0390089308.....	14	0390089621.....	16	0390089977.....	17
0390086742.....	13	0390091130.....	14	0390091452.....	16	0390091809.....	17
0390088821.....	13	0390089316.....	15	0390089639.....	16	0390089985.....	17
0390090652.....	13	0390091148.....	15	0390091460.....	16	0390091817.....	17
0390088839.....	13	0390089324.....	15	0390089647.....	16	0390086619.....	17
0390090660.....	13	0390091155.....	15	0390091478.....	16	0390086940.....	17
0390088847.....	13	0390089332.....	15	0390089654.....	16	0390086627.....	17
0390090678.....	13	0390091163.....	15	0390091486.....	16	0390086957.....	17
0390088854.....	13	0390086437.....	15	0390089662.....	16	0390086635.....	17
0390090686.....	13	0390091171.....	15	0390091494.....	16	0390086965.....	17
0390088862.....	13	0390086445.....	15	0390089688.....	16	0390090009.....	17
0390090694.....	13	0390086767.....	15	0390091510.....	16	0390090017.....	17
0390088870.....	13	0390086452.....	15	0390089696.....	16	0390091841.....	17
0390090702.....	13	0390086775.....	15	0390091528.....	16	0390090025.....	17
0390088912.....	13	0390086460.....	15	0390089704.....	16	0390091858.....	17
0390090744.....	13	0390086783.....	15	0390091536.....	16	0390090033.....	17
0390088961.....	13	0390086478.....	15	0390089712.....	16	0390091866.....	17
0390090793.....	13	0390086791.....	15	0390091544.....	16	0390090041.....	17
0390088987.....	14	0390086486.....	15	0390089746.....	16	0390091874.....	17
0390090819.....	14	0390086809.....	15	0390091577.....	16	0390090058.....	17
0390088995.....	14	0390086494.....	15	0390089779.....	16	0390091882.....	17
0390090827.....	14	0390086817.....	15	0390091601.....	16	0390090082.....	17
0390089001.....	14	0390089340.....	15	0390089803.....	16	0390091924.....	17
0390090835.....	14	0390086825.....	15	0390091635.....	16	0390090165.....	17
0390089019.....	14	0390089357.....	15	0390089811.....	16	0390091973.....	17
0390090843.....	14	0390091189.....	15	0390091643.....	16	0390090181.....	17
0390089027.....	14	0390089365.....	15	0390089829.....	16	0390091999.....	17
0390090850.....	14	0390091197.....	15	0390091650.....	16	0390090199.....	17
0390089035.....	14	0390089373.....	15	0390089845.....	16	0390092005.....	17
0390090868.....	14	0390091205.....	15	0390091676.....	16	0390090215.....	17
0390089043.....	14	0390089381.....	15	0390089852.....	16	0390092013.....	17
0390090876.....	14	0390091213.....	15	0390091684.....	16	0390090231.....	17
0390089050.....	14	0390089399.....	15	0390089860.....	16	0390092021.....	17
0390090884.....	14	0390086833.....	15	0390091692.....	16	0390090256.....	17
0390089068.....	14	0390086502.....	15	0390089878.....	16	0390092039.....	17
0390090892.....	14	0390091239.....	15	0390091700.....	16	0390090264.....	17
0390089076.....	14	0390086510.....	15	0390089886.....	16	0390092047.....	17
0390090900.....	14	0390086841.....	15	0390091718.....	16	0390090272.....	17
0390089092.....	14	0390086528.....	15	0390089894.....	16	0390092054.....	17
0390090926.....	14	0390086858.....	15	0390091726.....	16	0390090280.....	17
0390089100.....	14	0390089415.....	15	0390089902.....	17	0390092062.....	17
0390090934.....	14	0390091247.....	15	0390091734.....	17	0390090298.....	17
0390089118.....	14	0390089423.....	15	0390089910.....	17	0390092070.....	17

0390090306.....	17	0390043644.....	19
0390092088.....	17	0390043651.....	19
0390090322.....	18	0390043669.....	19
0390092104.....	18	0390043677.....	19
0390090330.....	18	0390043685.....	19
0390092112.....	18	0390045060.....	19
0390090348.....	18	0390045086.....	19
0390092120.....	18	0390045102.....	19
0390090355.....	18	0390045185.....	19
0390092138.....	18	0390045201.....	19
0390090389.....	18	0390045227.....	19
0390092161.....	18	0390045300.....	19
0390090413.....	18	0390045326.....	19
0390092195.....	18	0390045342.....	19
0390090447.....	18	0390045425.....	19
0390092229.....	18	0390045441.....	19
0390090454.....	18	0390045466.....	19
0390092237.....	18	0390045508.....	19
0390090462.....	18	0390045516.....	19
0390092245.....	18	0390045128.....	20
0390090488.....	18	0390045144.....	20
0390092260.....	18	0390045169.....	20
0390090496.....	18	0390045243.....	20
0390092278.....	18	0390045268.....	20
0390090504.....	18	0390045284.....	20
0390092286.....	18	0390045367.....	20
0390090512.....	18	0390045383.....	20
0390092294.....	18	0390045409.....	20
0390090520.....	18	1605113495.....	20
0390092302.....	18	1605113503.....	20
0390090538.....	18	1605113511.....	20
0390092310.....	18	1605113529.....	20
0390023869.....	18	1605113537.....	20
0390125334.....	18	1605113545.....	20
0390023877.....	18	1605113552.....	20
0390125342.....	18	1605113560.....	20
0390023885.....	18	1605113578.....	20
0390125359.....	18	0390163046.....	20
0390023943.....	18	0390163053.....	20
0390125367.....	18	0390163137.....	20
0390023984.....	18	0390080406.....	20
0390125375.....	18	0390080414.....	20
0390024024.....	18	0390080422.....	20
0390125383.....	18	0390080430.....	20
0390024032.....	18	0390080448.....	20
0390125391.....	18	0390080455.....	20
0390024107.....	18	0390080463.....	20
0390125409.....	18	0390080471.....	20
0390024149.....	18	0390080489.....	20
0390125417.....	18	0390080497.....	20
0390024180.....	18	0390080505.....	20
0390125425.....	18	0390162881.....	20
0390024222.....	18	0390163103.....	20
0390126084.....	18	0390046092.....	20
0390043420.....	19	0390046100.....	20
0390043446.....	19	0390046126.....	20
0390043461.....	19	0390046142.....	20
0390043487.....	19	1605113206.....	20
0390043800.....	19	1605113214.....	20
0390043818.....	19	1605113222.....	20
0390043826.....	19	1605113230.....	20
0390043834.....	19	1605113248.....	20
0390043602.....	19	1605113255.....	20
0390043610.....	19	1605113263.....	20
0390043628.....	19		
0390043636.....	19		