

125 MAIDEN LA



WATER STREET PLAZA | DOWNTOWN

RETAIL SPACE FOR LEASE

2,080 RSF
**Ground
Floor
Corner**

NEW YORK, NEW YORK

Ideal Food Location on
Downtown's Prime Corridor

Unit: **Ground Floor - A**

RSF: **2,080**

Frontage: **31' on Maiden Lane
63' on Pearl St**

Avail: **Immediate**

Price: **\$200/SF**

Prime FiDi Corner
High Visibility

New Hotels coming soon

Dual Marriott Hotels With 320 Rooms
Opening Soon on Pearl St off Fletcher

Scott Klatsky
(212)206-6155

sklatsky@timeequities.com



NYC RETAIL
BY TIME EQUITIES INC.

Scott Schneidman
(212)206-6163

sschneidman@timeequities.com

125 MAIDEN LA

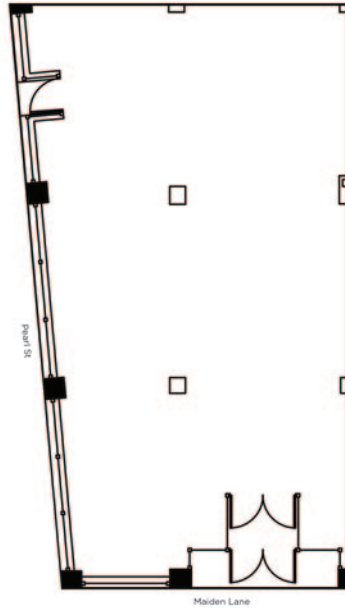

Click on Plan
For Additional Information,
Photos, Videos...

WATER STREET PLAZA | DOWNTOWN

RETAIL SPACE FOR LEASE
2,080 RSF
Ground
Floor
Corner

NEW YORK, NEW YORK



Coming Soon:
(2) Hotels on Pearl St near Fletcher St



No warranty, or representation is made as to the accuracy of the above information and same is submitted subject to errors, omissions, change of price, rental or other conditions, prior lease or withdrawal without notice, and to any special listing conditions, including the rate and manner of payment of commissions for particular offering, the terms of which are available to duly licensed brokers. This listing is subject to the aforesaid conditions and is not to be deemed an employment nor a binding contract of any kind unless or until our brokerage agreement is fully executed.

Scott Klatsky
(212)206-6155
sklatsky@timeequities.com



NYC RETAIL
BY TIME EQUITIES INC.

Scott Schneidman
(212)206-6163
sschneidman@timeequities.com