

1212 Lexington

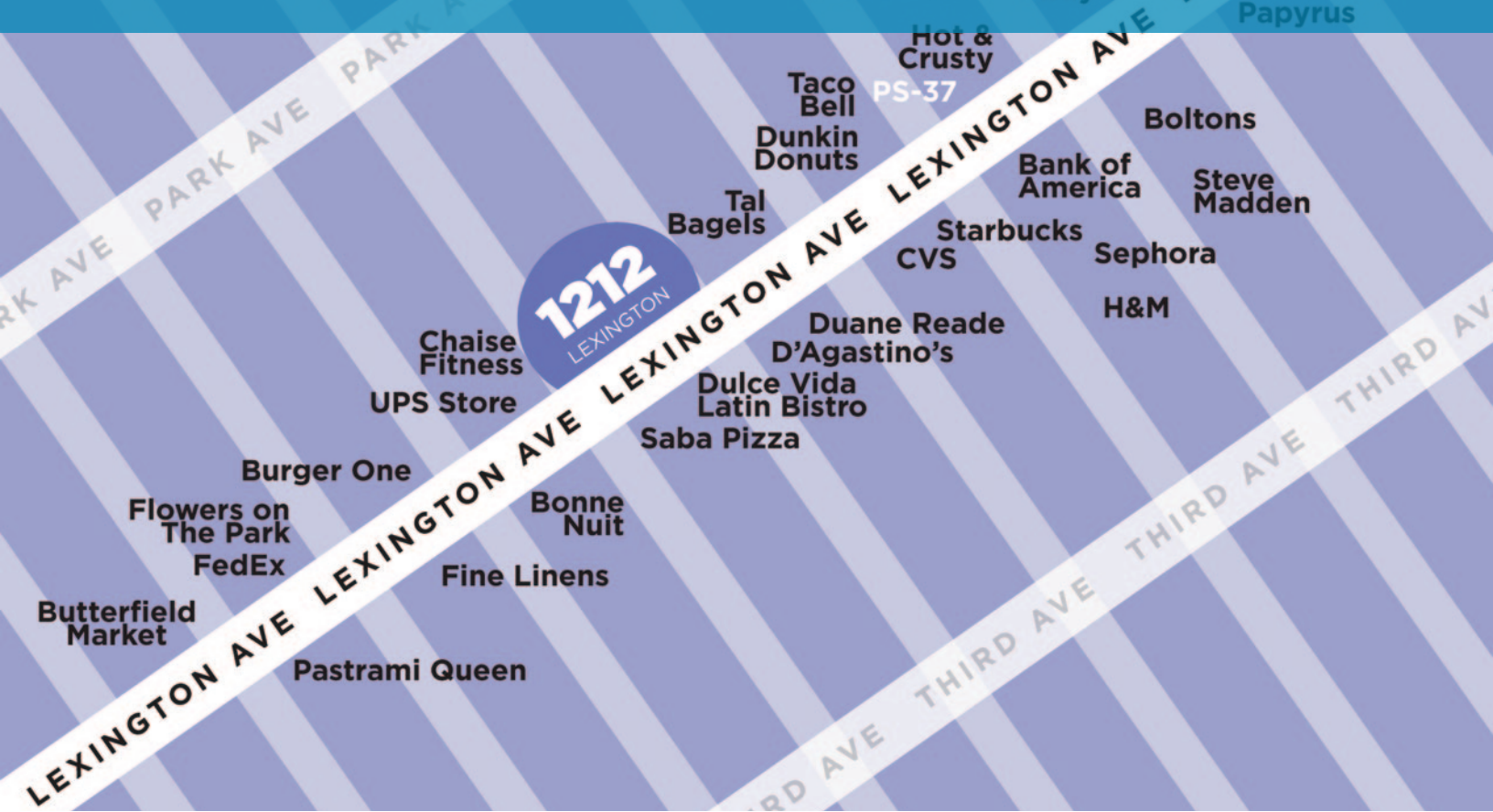

UPPER EAST SIDE | NEW TO MARKET

RETAIL SPACE FOR LEASE

225 RSF
Ground Floor

NEW YORK, NEW YORK

Upper East Side

New retail opportunity in Upscale Residential Neighborhood.

Unit: **Ground Floor**
RSF: **225 RSF**
Avail: **Immed**
Price: **\$215/SqFt**

Scott Klatsky
(212)206-6155
sklatsky@timeequities.com



NYC RETAIL
BY TIME EQUITIES INC.

Scott Schneidman
(212)206-6163
sschneidman@timeequities.com

1212 Lexington

225 RSF
Ground
Floor

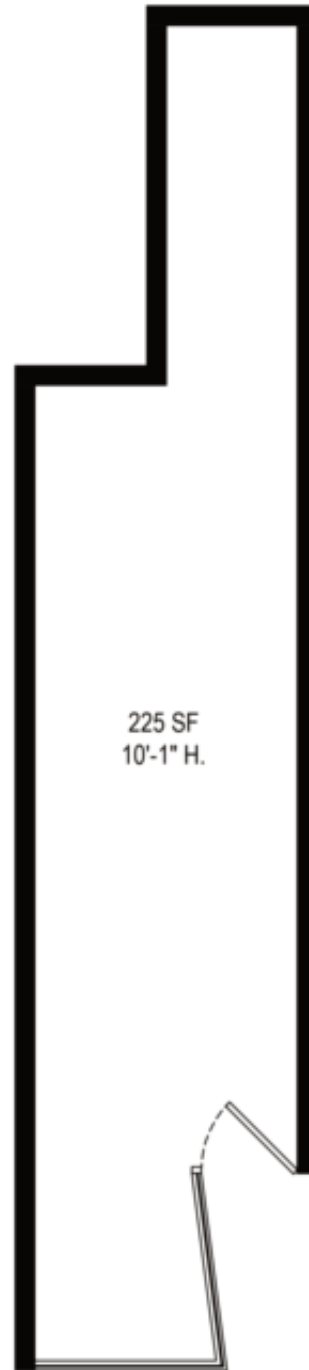

RETAIL SPACE FOR LEASE

225 RSF
Ground
Floor

NEW YORK, NEW YORK

No warranty, or representation is made as to the accuracy of the above information and same is submitted subject to errors, omissions, change of price, rental or other conditions, prior lease or withdrawal without notice, and to any special listing conditions, including the rate and manner of payment of commissions for particular offering, the terms of which are available to duly licensed brokers. This listing is subject to the aforesaid conditions and is not to be deemed an employment nor a binding contract of any kind unless or until our brokerage agreement is fully executed.

Scott Klatsky
(212)206-6155

sklatsky@timeequities.com



NYC RETAIL
BY TIME EQUITIES INC.

Scott Schneidman
(212)206-6163

sschneidman@timeequities.com

55 FIFTH AVE | 15TH FLOOR | NEW YORK, NY | 10003-4398 | 212-206-6000 | TIMEEQUITIES.COM
LICENSED REAL ESTATE BROKER