

Topography Contours

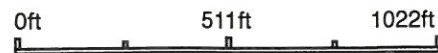

Maps Provided By:

Source: USGS 10 meter dem
 Interval(ft): 3.0
 Min: 380.7
 Max: 387.8
 Range: 7.1



Hopkins County

1 field, 110 acres in Hopkins County, KY

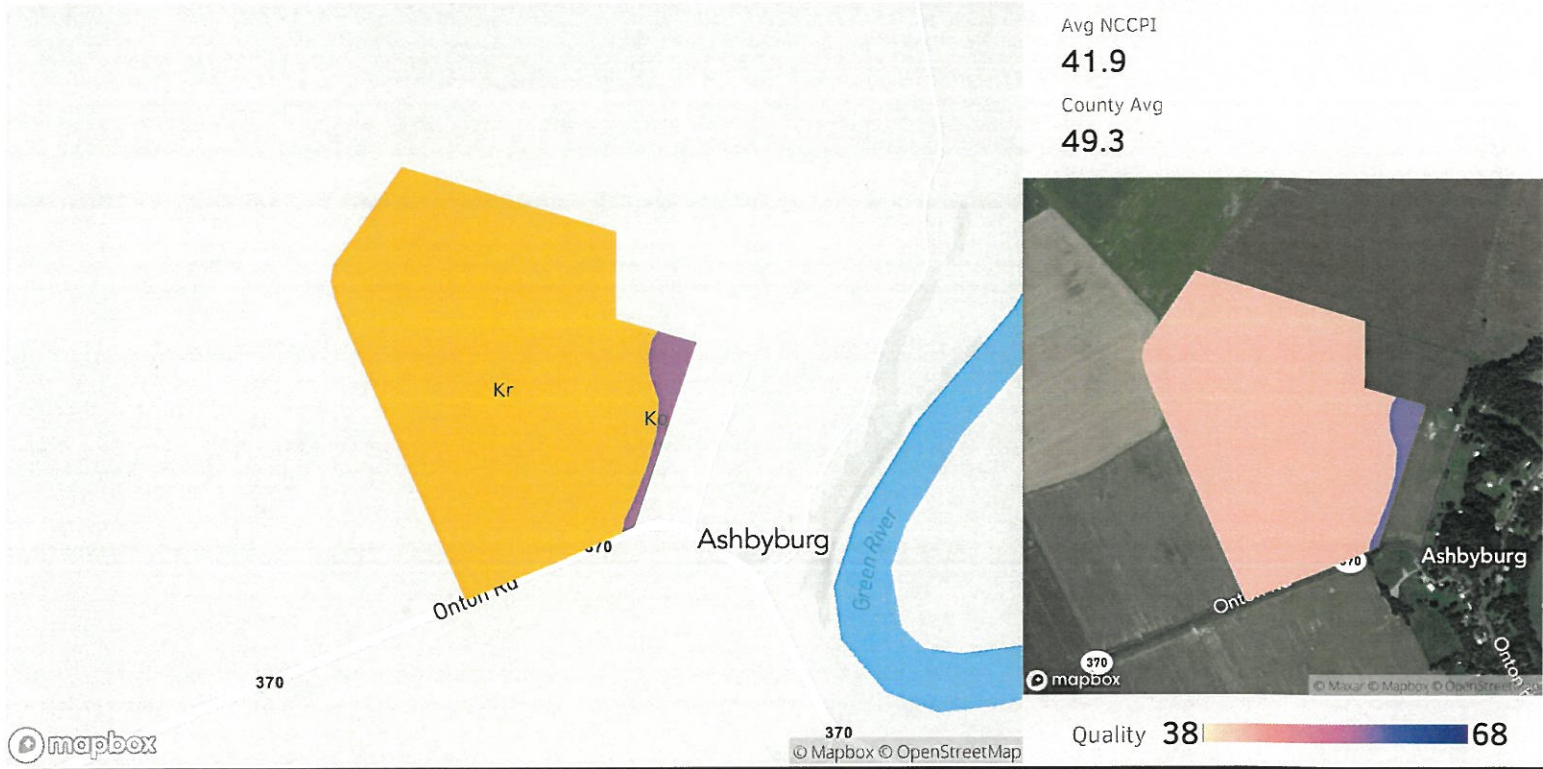

Field 1

110 ac.

Soil Code	Soil Description	Acres	Percentage of Field	Soil Class	NCCPI
Kr	Karnak silty clay, 0 to 2 percent slopes, occasionally flooded	106.02	96.2%	3	41.3
Ko	Karnak silt loam, overwash, 0 to 2 percent slopes, occasionally flooded	4.24	3.8%	3	56.8
		110.26			41.9

FEMA Report

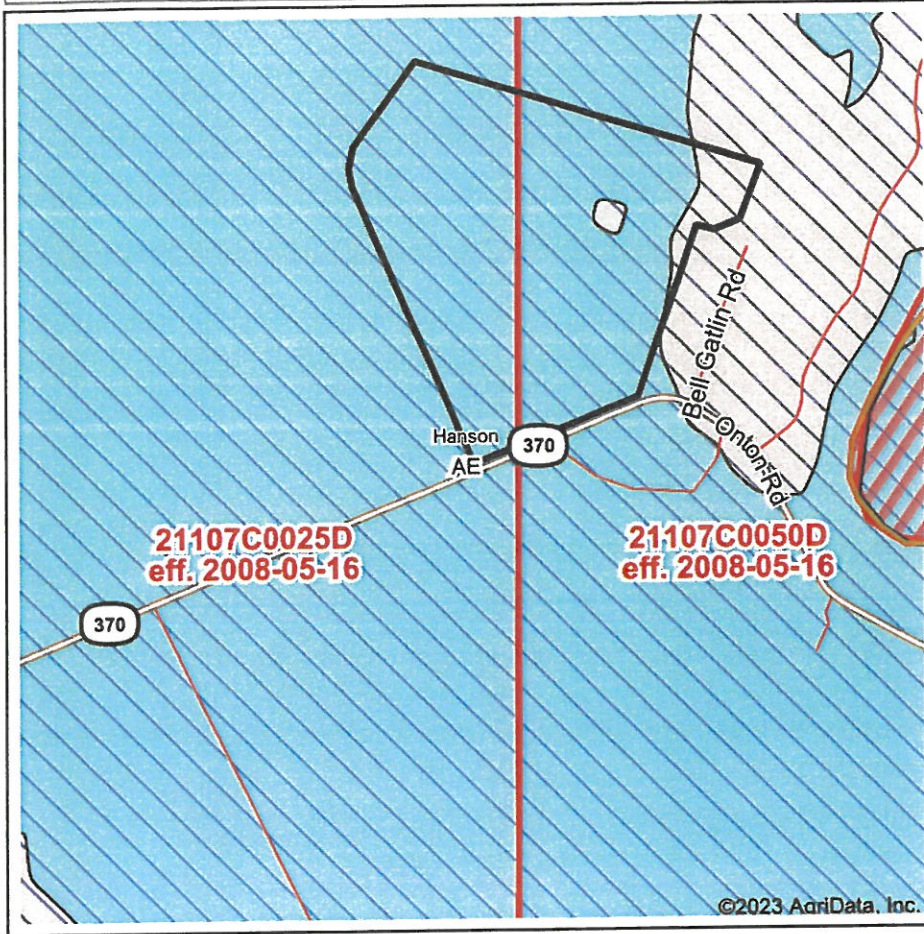

Map Center: 37° 32' 3.74, -87° 22' 34.18
 State: KY Acres: 117.44
 County: Hopkins Date: 8/29/2023
 Location:
 Township: Hanson



Maps Provided By:

 CUSTOMIZED ONLINE MAPPING
 © AgriData, Inc. 2023 www.AgriDataInc.com



Name	Number	County	NFIP Participation	Acres	Percent
HOPKINS COUNTY	210112	Hopkins	Regular	117.44	100%
Total				117.44	100%
Map Change	Date	Case No.	Acres	Percent	
No			0	0%	
Zone	SubType	Description	Acres	Percent	
AE		100-year Floodplain	110.15	93.8%	
X	AREA OF MINIMAL FLOOD HAZARD	Outside 500-year Floodplain	6.26	5.3%	
X	AREA OF MINIMAL FLOOD HAZARD	Outside 500-year Floodplain	1.03	0.9%	
Total			117.44	100%	
Panel	Effective Date	Acres	Percent		
21107C0050D	5/16/2008	62.59	53.3%		
21107C0025D	5/16/2008	54.85	46.7%		
Total		117.44	100%		

1 field, 110 acres in Hopkins County, KY



Legend

SPECIAL FLOOD HAZARD AREAS
High flood risk

- Without Base Flood Elevation (BFE) Zone A, V, A99
- With BFE or Depth Zone AE, AO, AH, VE, AR
- Floodway Colorado River Floodway, Area of Special Consideration, Density Fringe Area

OTHER AREAS OF FLOOD HAZARD
Moderate flood risk

- 0.2% Annual Chance Flood Hazard, Areas of 1% annual chance flood with average depth less than one foot or with drainage areas of less than one square mile Zone X
- Future Conditions 1% Annual Chance Flood Hazard Zone X
- Areas with Reduced Flood Risk due to Levee Zone X
- Areas with Flood Risk due to Levee Zone D

OTHER AREAS

- Area of Minimal Flood Hazard Zone X
- Area of Undetermined Flood Hazard Zone D

SEE FIS REPORT FOR DETAILED LEGEND AND INDEX MAP FOR FIRM PANEL LAYOUT

* **High Flood Risk** - areas with 1% annual chance or greater of flooding, also referred to as base flood zones or 100-year flood zones. Classified as Special Flood Hazard Areas (SFHAs) by FEMA. **Moderate Flood Risk** - areas in between the limits of the 1% annual and the 0.2% annual (or 500-year) flood zones. **Minimal Flood Risk** - areas that are above the 500-year flood zones. **Undetermined Flood Risk** - areas where flood analysis has not been conducted.

Source: FEMA National Flood Hazard Layer

Field 1

110 ac.

Flood Zone	Flood Risk*	Flood Zone Subtype	Acres	Percentage of Field
AE	HIGH	N/A	107.82	97.8%
X	MINIMAL	AREA OF MINIMAL FLOOD HAZARD	2.43	2.2%
			110.26	

Aerial Map



Company: Kurtz Auction Realty Company
 Address: 305 Frederica Street
 Address: Owensboro, KY 42301
 Phone: _____

Date Ordered: 8/29/2023
 Invoice Number: _____
 Customer/Sub-Contractor: _____
 Address: _____
 Address: _____
 Phone: _____
 Owner/Operator: _____
 Address: _____
 Address: _____
 Phone: _____
 Field ID: _____
 Crop: _____
 Mapped Acres: 117.44
 Actual Acres: 117.44
 Airport: _____



Hopkins, KY

Boundary Center:
37° 32' 18.54, -87° 22' 26.68

Field Notes:

Parcel # 5



Maps Provided By:

 CUSTOMIZED ONLINE MAPPING
 © AgriData, Inc. 2023 www.AgriDataInc.com

Pest	Product (Supplier)	EPA Reg. #	A.I.	Rate	Unit	Carrier	Total	Unit

REI: 0 Hour(s) - Rainfast Time: Not Set - Protective Clothing Required:

Logs: Application: _____ Date of _____ Start Time: _____ End Time: _____ Acres Applied: _____
 Applicator: _____ Temperature: _____ Clear Partly Cloudy Cloudy
 Applicator's ID: _____ Wind Speed: _____ Wind Direction: _____ Desired Wind: _____
 Logs: Application: _____ Date of _____ Start Time: _____ End Time: _____ Acres Applied: _____

Aerial Map



©2023 AgriData, Inc.

Boundary Center: 37° 32' 18.54, -87° 22' 26.68

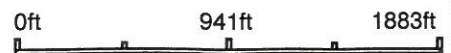

Maps Provided By:

Hopkins County



Soils Map

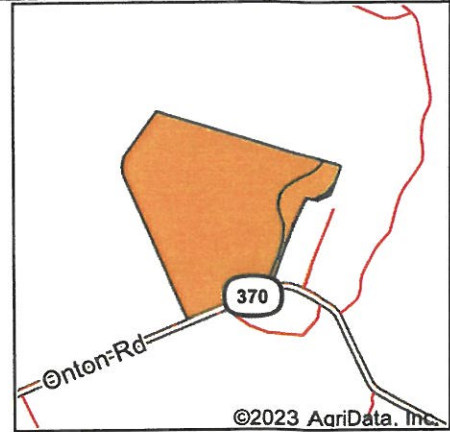
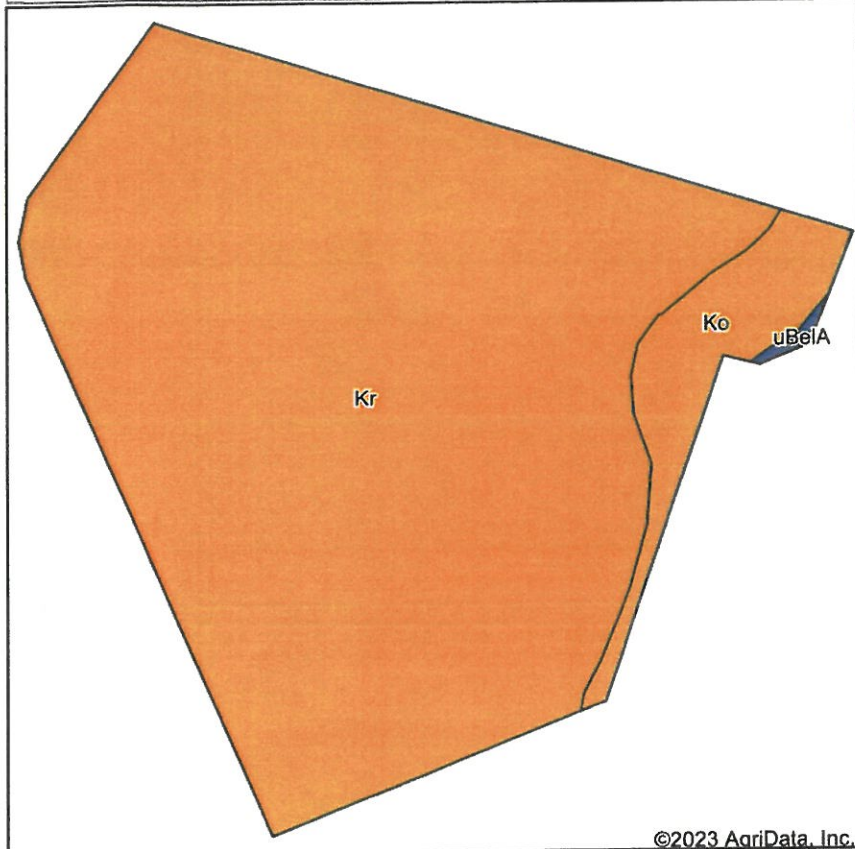

State: **Kentucky**
 County: **Hopkins**
 Location: **37° 32' 3.74, -87° 22' 34.18**
 Township: **Hanson**
 Acres: **117.44**
 Date: **8/29/2023**



Soils data provided by USDA and NRCS.

Area Symbol: KY107, Soil Area Version: 21												
Code	Soil Description	Acres	Percent of field	Non-Irr Class Legend	Non-Irr Class *c	Corn Bu	Grass legume hay Tons	Pasture AUM	Soybeans Bu	Winter wheat Bu	*n NCCPI Soybeans	
Kr	Karnak silty clay, 0 to 2 percent slopes, occasionally flooded	108.41	92.3%		IIIw	140	4.7	10	59		30	
Ko	Karnak silt loam, overwash, 0 to 2 percent slopes, occasionally flooded	8.72	7.4%		IIIw	140	4.7	10	59	72	40	
uBeIA	Belknap silt loam, 0 to 2 percent slopes, occasionally flooded	0.31	0.3%		IIw	166	5.2	9.5	62	60	52	
Weighted Average						3.00	140.1	4.7	10	59	5.5	*n 30.8

*n: The aggregation method is "Weighted Average using all components"

*c: Using Capabilities Class Dominant Condition Aggregation Method

Topography Map

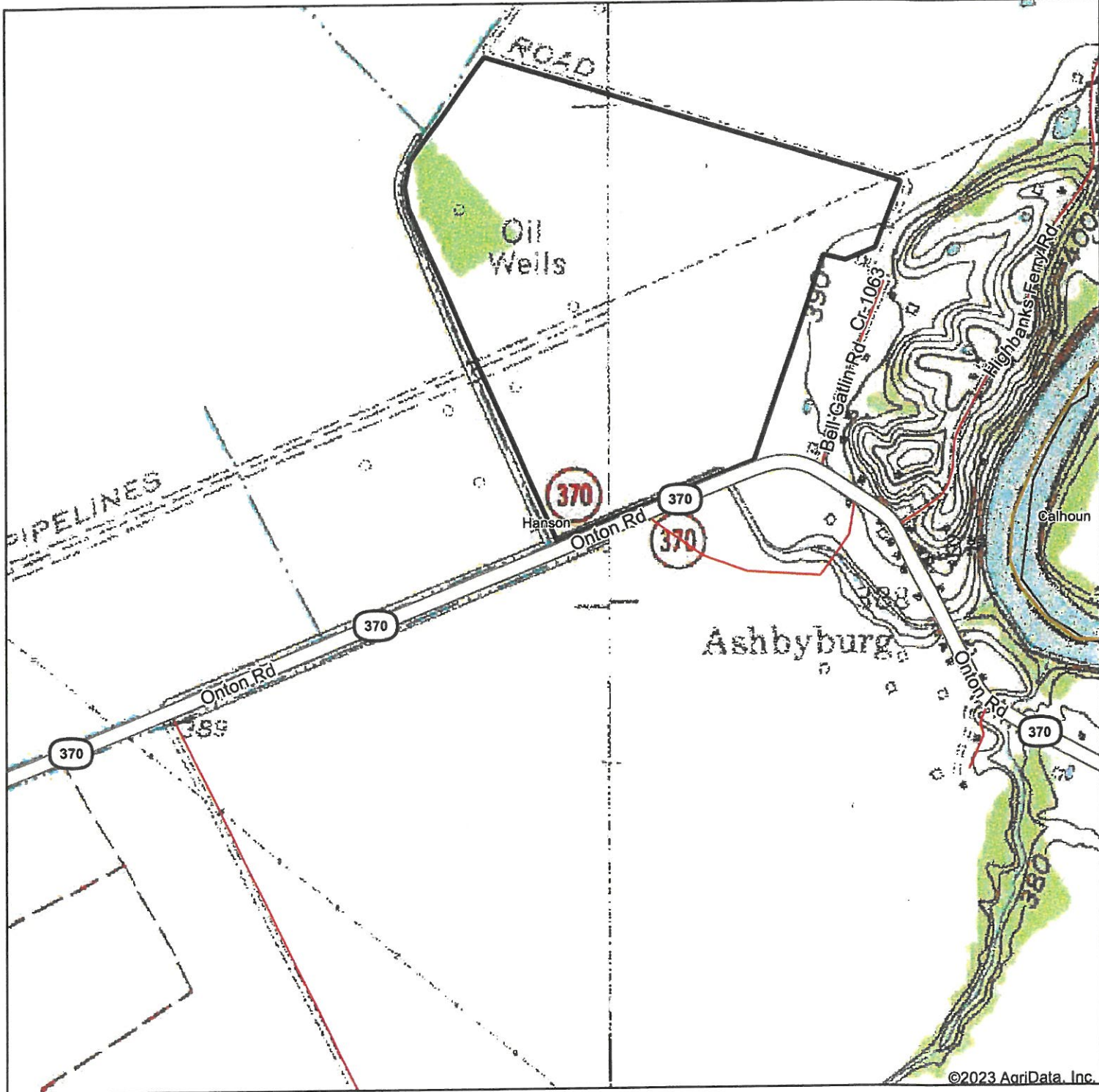

©2023 AgriData, Inc.

Map Center: 37° 32' 3.74, -87° 22' 34.18

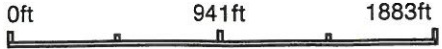

Hopkins County Kentucky

1 field, 110 acres in Hopkins County, KY

AVG ACREVALUE (\$/AC.)

\$7,627

TOTAL VALUE
\$840,961

COUNTY AVG (\$/AC.)

\$7,014

AVG NCCPI

41.9

COUNTY AVG

49.3



Economic Attributes

Hopkins County is a high tax county.
Expected Corn Basis: \$0.07

Physical Attributes

Annual Precipitation: 45.76 inches
Annual GDD: 4,057

Land Use

Land Use: Cropland, Developed, Grass/
Pasture, Non-Cropland









Field	Acres	Latitude Longitude	Slope	2024 Crops	Avg NCCPI	Avg AcreValue (\$/ac.)
1 	110.26	37.53866 -87.37510	0.57%	99% Soybeans, 1% Other	41.9	\$7,627

1 field, 110 acres in Hopkins County, KY



All fields
110 ac.

Avg. Elevation
382.85 ft

	Elevation Range	Acres	Percent Area
	386.12 ft - 387.14 ft	0.02	0.02%
	385.11 ft - 386.12 ft	0.23	0.21%
	384.10 ft - 385.11 ft	2.47	2.24%
	383.09 ft - 384.10 ft	14.80	13.42%
	382.08 ft - 383.09 ft	87.96	79.78%
	381.06 ft - 382.08 ft	2.86	2.59%
	380.05 ft - 381.06 ft	1.30	1.18%
	379.04 ft - 380.05 ft	0.50	0.45%
	378.03 ft - 379.04 ft	0.11	0.1%