

(FILE IN TRIPLICATE)

TO JULIUS ROSENWALD FUND
Southern Office
Nashville, Tennessee

PAID		
DATE	CHECK NO.	AMOUNT
5-13-32	5734	\$8.00

APPLICATION FOR AID ON TRANSPORTATION OF NEGRO PUPILS

1931-32

No. Teachers 4 Application No. 2 - b

1. State Arkansas, County Woodruff, School Fitzhugh
2. The school: (a) When built 1928 (b) Type of construction brick
- (c) No. of schools included in the consolidation 3 (d) No. pupils, (1) elementary 300
- (2) high school 30 (e) Is there vocational work for both boys and girls? yes
- (f) No. of high school grades 1 (g) Accredited for how many years of high school work? 1
- (Attach map or drawing showing area to be served and bus routes).

3. Give: (a) Length of school term 7 (b) Salary of each teacher employed:
- | | | | | | | |
|-----------------------|-----------------|----------------------|---------------|---------------|---------------|----------|
| Principal | \$ <u>1,200</u> | elementary teachers, | \$ <u>525</u> | \$ <u>420</u> | \$ <u>350</u> | \$ _____ |
| | \$ _____ | | \$ _____ | \$ _____ | \$ _____ | \$ _____ |
| high school teachers, | \$ _____ | | \$ _____ | \$ _____ | \$ _____ | \$ _____ |
| | \$ _____ | | \$ _____ | \$ _____ | \$ _____ | \$ _____ |
- (State on back of application educational qualifications of each regular teacher employed).

4. (a) Describe the school bus to be used in transporting pupils and attach pictures showing front, side and rear Chevrolet chassis. Oak body, well constructed. 3 rows of seats.
- (b) Give number of round trips to be made daily 3 (c) No. of miles traveled daily 60
- (d) No. pupils to be transported (1) elementary 120 (2) high school 12

5. BUSES PURCHASED BY AID OF FUND IN 1929-30:
- (a) Cost of operating 1 busses for 1931-32 7 months at \$ 75.00 a month... \$ 525.00
- (b) Aid requested of the Julius Rosenwald Fund..... \$ 55.00
- (Fund's aid one-fourth cost not to exceed \$55 per bus).

6. BUSES OPERATED BY AID OF FUND BEGINNING IN 1929-30:
- (a) Total cost of operating _____ busses _____ months at \$ _____ a month in 1931-32. \$ _____
- (b) Aid requested of the Julius Rosenwald Fund..... \$ _____
- (Fund's aid is one-fourth cost the third year not to exceed three-fourths of amount paid last year).

(Application for transportation aid was approved in 1929-30 for this school on condition that the term would be not less than six months and no teacher's salary less than \$50 a month. While the requirements are higher for new projects this year—a minimum of eight months and no salary less than \$60 a month—the Fund will comply fully with its agreement on schools qualifying in 1929-30, but would be glad to see any of these schools that can, meet the new requirements).

March 28, 1932 (Signed) C. C. Hunnicutt
County Superintendent.

We hereby recommend \$ 55.00 aid on this application.

C. M. Hirst State Superintendent. Helen M. Selby State Agent.

Approved April 15th 1932 for \$ 55.00

S. L. Smith
Director for Southern Schools.

By Russell W. Carney

(SEE OTHER SIDE)

C. Gammon
Annie Brandon
Ethel Lacey
Cordelia Briscoe

4 yr. col.
2 yrs. col.
2 yrs. col.
1 yr. col.

1 yr. exp.
10 yrs. exp.
10 yrs. exp.
16 yrs. exp.



Fitzhugh Consolidated School Dist.

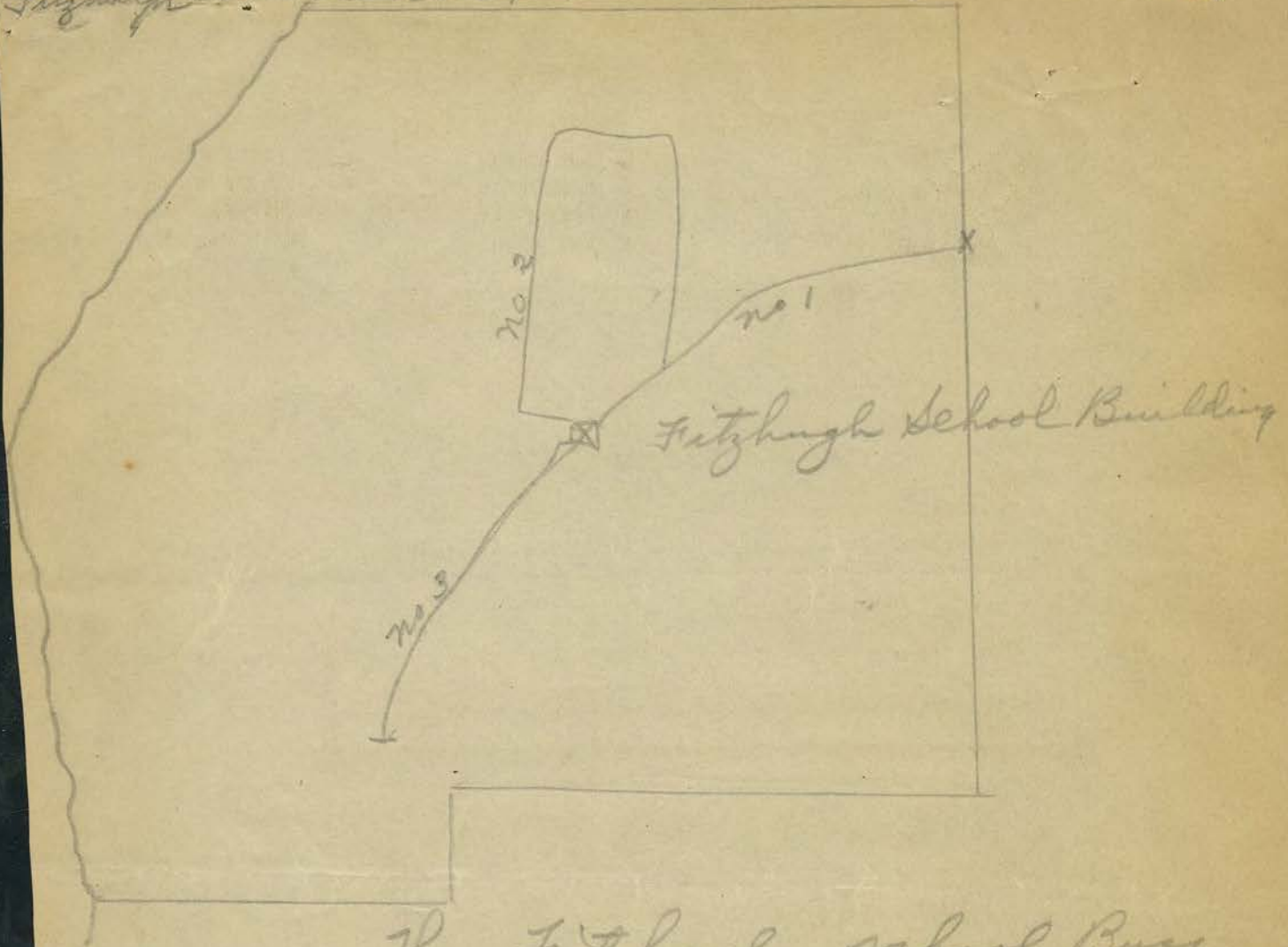

The Fitzhugh school Bus makes three trips and indicated in diagram a total distance of 60 miles.

(FILE IN TRIPLICATE)

TO JULIUS ROSENWALD FUND
Nashville, Tennessee

APPLICATION FOR AID ON TRANSPORTATION OF NEGRO PUPILS
1930-31

PAID
2-9-31 4692 75.00
SECOND YEAR

No. Teachers 5 Application No. 2-A

1. State Arkansas, County Woodruff, School Fitzhugh

2. The school: (a) When built 1929 (b) Type of construction brick veneer

(c) No. of schools included in the consolidation 4 (d) No. pupils, (1) elementary 350

(2) high school none (e) Is there vocational work for both boys and girls? yes

(f) No. of high school grades none (g) Accredited for how many years of high school work? none

(Attach map or drawing showing area to be served and bus routes).

3. Give: (a) Length of school term 8 (b) Salary of each teacher employed:

Principal \$ 1350, elementary teachers, \$ 800, \$ 520, \$ 520, \$ 520

\$ _____, \$ _____, \$ _____, \$ _____, \$ _____, \$ _____, \$ _____

high school teachers, \$ _____, \$ _____, \$ _____, \$ _____, \$ _____, \$ _____, \$ _____

\$ _____, \$ _____, \$ _____, \$ _____, \$ _____, \$ _____, \$ _____

(State on back of application educational qualifications of each regular teacher employed).

4. (a) Describe the school bus to be used in transporting pupils and attach pictures showing front, side and rear _____

(b) Give number of round trips to be made daily 3 (c) No. of miles traveled daily 66

(d) No. pupils to be transported (1) elementary 150 (2) high school _____

5. AID ON BUSES PURCHASED—1929-30:

(a) Total cost of purchase and operation..... \$ 1280

(b) Amount paid by the Julius Rosenwald Fund 1929-30..... \$ 500

(c) Cost of operating 1 busses for 1930-31 8 months at \$ 75.00 a month... \$ 600

(d) Aid requested of the Julius Rosenwald Fund..... \$ 75

(Fund's aid one-third cost not to exceed \$75).

6. AID ON BUSES FOR OPERATION ONLY:

(a) Total cost of operating _____ busses _____ months at \$ _____ a month in 1929-30.. \$ _____

(b) Amount paid by the Julius Rosenwald Fund 1929-30..... \$ _____

(c) Total cost of operating _____ busses _____ months at \$ _____ a month in 1930-31.. \$ _____

(d) Aid requested of the Julius Rosenwald Fund..... \$ _____

(Fund's aid is one-third cost the second year not to exceed two-thirds of amount paid last year).

(Application for transportation aid was approved last year for this school on condition that the term would be not less than six months and no teacher's salary less than \$50 a month. While the requirements are higher for new projects this year—a minimum of eight months and no salary less than \$60 a month—the Fund will comply fully with its agreement on schools qualifying in 1929-30, but would be glad to see any of these schools that can, meet the new requirements).

March 4, 1931

C. C. Hunnicutt
County Superintendent.

We hereby recommend \$ 75.00 aid on this application.

C. M. Hirst
State Superintendent.

Walter M. Deley
State Agent.

Approved March 9th 1931 for \$ 75.00

S. L. Smith
Director for Southern Schools.

By Bessie W. Casney

(SEE OTHER SIDE)

TO JULIUS ROSENWALD FUND
Nashville, Tennessee

ok. au
PAID

APPLICATION FOR AID ON TRANSPORTATION OF NEGRO PUPILS
1929-30

No. Teachers 5 Application No. 2

1 State Arkansas County Woodruff School Fitzhugh

Give (1) Kind of building brick veneer (2) No. of grades 8

(3) No. of pupils to be transported 100 (4) No. of trips 2

(5) No. of miles daily 40 (6) Length of school term in months 8

2 State salaries of teachers: Principal \$ 1800 (1) 640 (2) 480

(3) 480 (4) 400 (5) _____ (6) _____ (7) _____ (8) _____ (9) _____ (10) _____

3 Request for aid in transportation:

(1) One-half the cost of operating _____ busses _____ months at \$ _____
each per month, Total \$ _____ Or,

(2) One-half the cost of (a) purchasing 1 busses at \$ 800 each,
and (b) operating 1 busses 8 months at \$ 60 per
month each, total for both (a) and (b).....\$ 1280

(the Fund's share for (a) and (b) not to exceed \$500 per bus the first year)

Description of the bus to be purchased, including the capacity _____
Ford chassis with good body supplied with seats and windows. Body made
on style of Graham body. Capacity 50
The type of bus under either (1) or (2) is to be approved by the
State Department of Education and the Fund.

4 In accepting aid from the Fund - one-half the cost the first year,
one-third the second year and one-fourth the third year - the public
school authorities agree to continue the service at the end of the
period without further aid. It is understood that the school term
is not to be less than six months and no teacher's salary less than
\$50 per month.

October 5, 19 29 (Signed) C. C. Hunnicutt
County Superintendent

We hereby recommend aid on this application.

C. M. Hirst
State Superintendent

J. T. Mitchell
State Agent

Approved Oct. 21, 19 29 for \$ 500 (max. for 1 bus)

L. R. Smith
Director for Rural Schools

2a = 15.00
2b = 55.00



TO JULIUS ROBERTSON
Nashville, Tennessee

APPLICATION FOR AID ON TRANSPORTATION OF NEGRO PEOPLE
1932-33

