

(FILE IN TRIPLICATE)

TO JULIUS ROSENWALD FUND
Southern Office
Nashville, Tennessee

PAID		
DATE	NO.	AMOUNT
		THIRD YEAR
26.32	6024	200.00

APPLICATION FOR AID ON TRANSPORTATION OF NEGRO PUPILS

1931-32

- No. Teachers 6 Application No. 4 - b
- State TENNESSEE, County HENDERSON, School MONTGOMERY HIGH
 - The school: (a) When built 1922 (b) Type of construction Frame
(c) No. of schools included in the consolidation 3 (d) No. pupils, (1) elementary 175
(2) high school 30 (e) Is there vocational work for both boys and girls? Yes
(f) No. of high school grades 2 (g) Accredited for how many years of high school work? 2
(Attach map or drawing showing area to be served and bus routes).
 - Give: (a) Length of school term 9 months (b) Salary of each teacher employed:
Principal \$ 900, elementary teachers, \$ 675, \$ 630, \$ _____, \$ _____
\$ _____, \$ _____, \$ _____, \$ _____, \$ _____, \$ _____, \$ _____
high school teachers, \$ 720, \$ 800, \$ 832.50, \$ _____, \$ _____, \$ _____, \$ _____
\$ _____, \$ _____, \$ _____, \$ _____, \$ _____, \$ _____, \$ _____
(State on back of application educational qualifications of each regular teacher employed).
 - (a) Describe the school bus to be used in transporting pupils and attach pictures showing front, side and rear Chevrolet Bus, closed, with windows on side and rear. 1930 Model.
(b) Give number of round trips to be made daily 4 (c) No. of miles traveled daily 48
(d) No. pupils to be transported (1) elementary 17 (2) high school 6
 - BUSSES PURCHASED BY AID OF FUND IN 1929-30:
(a) Cost of operating _____ busses for 1931-32 _____ months at \$ _____ a month...\$ _____
(b) Aid requested of the Julius Rosenwald Fund.....\$ _____
(Fund's aid one-fourth cost not to exceed \$55 per bus).
 - BUSSES OPERATED BY AID OF FUND BEGINNING IN 1929-30:
(a) Total cost of operating 1 busses 9 months at \$ 125.00 a month in 1931-32. \$ 1,125.00
(b) Aid requested of the Julius Rosenwald Fund.....\$ 250.00
(Fund's aid is one-fourth cost the third year not to exceed three-fourths of amount paid last year).

(Application for transportation aid was approved in 1929-30 for this school on condition that the term would be not less than six months and no teacher's salary less than \$50 a month. While the requirements are higher for new projects this year—a minimum of eight months and no salary less than \$60 a month—the Fund will comply fully with its agreement on schools qualifying in 1929-30, but would be glad to see any of these schools that can, meet the new requirements).

December 7, 1931 (Signed) G. Tillman Stewart
County Superintendent.

We hereby recommend \$ 250.00 aid on this application.
P. D. Harned State Superintendent. Sudley Tanner State Agent.

Approved January 6th 1932 for \$ 250.00
S. L. Smith Director for Southern Schools.

By Bessie W. Cannon
(SEE OTHER SIDE)

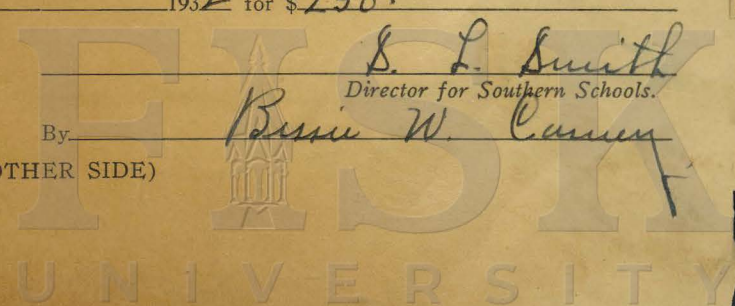

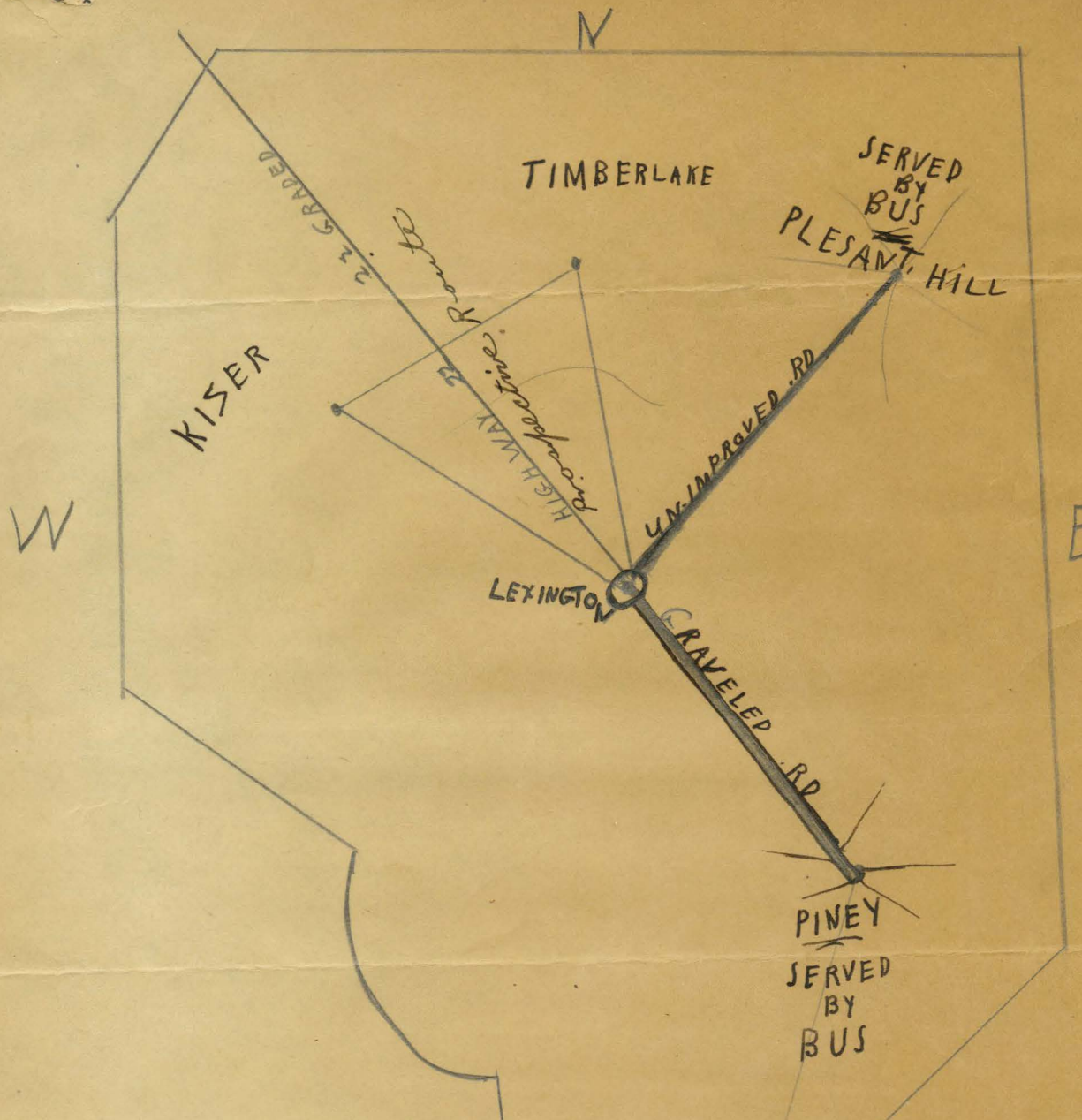

(FILE IN TRIPLICATE)

PAID		
DATE	CHK. NO.	AMOUNT
1-19-31	4578	333.33

TO JULIUS ROSENWALD FUND
Nashville, Tennessee

SECOND YEAR

APPLICATION FOR AID ON TRANSPORTATION OF NEGRO PUPILS
1930-31

No. Teachers 5 Application No. 4-a

1. State TENNESSEE, County HENDERSON, School MONTGOMERY HIGH

2. The school: (a) When built 1922 (b) Type of construction Frame

(c) No. of schools included in the consolidation 3 (d) No. pupils, (1) elementary 150

(2) high school 25 (e) Is there vocational work for both boys and girls? Yes

(f) No. of high school grades 2 (g) Accredited for how many years of high school work? 2

(Attach map or drawing showing area to be served and bus routes).

3. Give: (a) Length of school term 9 months (b) Salary of each teacher employed:

Principal \$ 900, elementary teachers, \$ 720, \$ 630, \$ 630, \$ 630

\$ _____, \$ _____, \$ _____, \$ _____, \$ _____

high school teachers, \$ 900 - Principal, \$ _____, \$ _____, \$ _____, \$ _____

\$ _____, \$ _____, \$ _____, \$ _____, \$ _____

(State on back of application educational qualifications of each regular teacher employed).

4. (a) Describe the school bus to be used in transporting pupils and attach pictures showing front, side and rear _____

(b) Give number of round trips to be made daily 2 (c) No. of miles traveled daily 10

(d) No. pupils to be transported (1) elementary _____ (2) high school _____

5. AID ON BUSES PURCHASED—1929-30:

(a) Total cost of purchase and operation..... \$ _____

(b) Amount paid by the Julius Rosenwald Fund 1929-30..... \$ _____

(c) Cost of operating _____ busses for 1930-31 _____ months at \$ _____ a month... \$ _____

(d) Aid requested of the Julius Rosenwald Fund..... \$ _____

(Fund's aid one-third cost not to exceed \$75).

6. AID ON BUSES FOR OPERATION ONLY:

(a) Total cost of operating 1 bus ~~es~~ 9 months at \$ 125.00 a month in 1929-30... \$ 1,125.00

(b) Amount paid by the Julius Rosenwald Fund 1929-30..... \$ 500.00

(c) Total cost of operating 1 bus ~~es~~ 9 months at \$ 125.00 a month in 1930-31... \$ 1,125.00

(d) Aid requested of the Julius Rosenwald Fund..... \$ 333.33

* (Fund's aid is one-third cost the second year not to exceed two-thirds of amount paid last year).

(Application for transportation aid was approved last year for this school on condition that the term would be not less than six months and no teacher's salary less than \$50 a month. While the requirements are higher for new projects this year—a minimum of eight months and no salary less than \$60 a month—the Fund will comply fully with its agreement on schools qualifying in 1929-30, but would be glad to see any of these schools that can, meet the new requirements).

January 5, 1931 (Signed) R. E. Powers,

County Superintendent.

We hereby recommend \$ 333.33 aid on this application.

[Signature]
Commissioner of Education
Approved _____

[Signature]
State Agent.

January 6 1931 for \$ 333 [Signature]

[Signature]
Director for Southern Schools.

By [Signature]

(SEE OTHER SIDE)

TO JULIUS ROSENWALD FUND
Nashville, Tennessee

ok all
PAID

APPLICATION FOR AID ON TRANSPORTATION OF NEGRO PUPILS
1929-30

No. Teachers 5

Application No. 4

1 State TENNESSEE County HENDERSON School MONTGOMERY HIGH SCHOOL

Give (1) Kind of building FRAME (2) No. of grades 10

(3) No. of pupils to be transported 45 (4) No. of trips 4

(5) No. of miles daily 48 (6) Length of school term in months 9

2 State salaries of teachers: Principal \$ 900 (1) 720 (2) 630

(3) \$540 (4) \$540 (5) _____ (6) _____ (7) _____ (8) _____ (9) _____ (10) _____

3 Request for aid in transportation:

(1) One-half the cost of operating 1 bus ~~over~~ 9 months at \$125.00 each per month, Total \$ 1,125.00 Or,

(2) One-half the cost of (a) purchasing _____ busses at \$ _____ each, and (b) operating _____ busses _____ months at \$ _____ per month each, total for both (a) and (b).....\$ _____

(the Fund's share for (a) and (b) not to exceed \$500 per bus the first year)

Description of the bus to be purchased, including the capacity 30
1929 Chevrolet 6

The type of bus under either (1) or (2) is to be approved by the State Department of Education and the Fund.

4 In accepting aid from the Fund - one-half the cost the first year, one-third the second year and one-fourth the third year - the public school authorities agree to continue the service at the end of the period without further aid. It is understood that the school term is not to be less than six months and no teacher's salary less than \$50 per month.

August 30, 19 29

R. E. Powers.
County Superintendent

We hereby recommend aid on this application.

P. L. Harner
State Superintendent

Ludley Tanner
State Agent

Approved Sept. 6 19 29 for \$ 500 (Max. aid)

L. L. Smith
Director for Rural Schools



*La = 333.33
48 = 250.00*

UNIVERSITY



FISK
UNIVERSITY