



42' X 64' GRAND ESCAPE



Designing Vehicle Storage Buildings:

Boats and Other Smaller Recreational Vehicles

Situation: Design mistakes can turn dream buildings into nightmares. A common complaint within the post-frame industry is, "I wish I would have gone bigger." Other leading complaints include window placement, door sizes, and placement of doors—all of these are design-related.

Big Idea: Designing and constructing purpose-built buildings for boats and other smaller recreational vehicles is a core strength of Morton and how we create dream buildings for our customers.

How it Works: Over a series of conversations, a Morton sales consultant will visit with you to understand your wants and needs, assess the build site,

and design a building tailored to how you intend to use the space now and in the future. Thinking through the interior layout will help ensure the proper amount and placement of windows and doors and avoid costly building modifications in the future.

The Benefits: Morton knows how to protect your boat and other smaller recreational vehicles and enable you to access and play with them in a better looking, longer lasting building. A proper flow in, out, and around the building is seamless when designed correctly.

Next Steps: Finalize and approve the design.

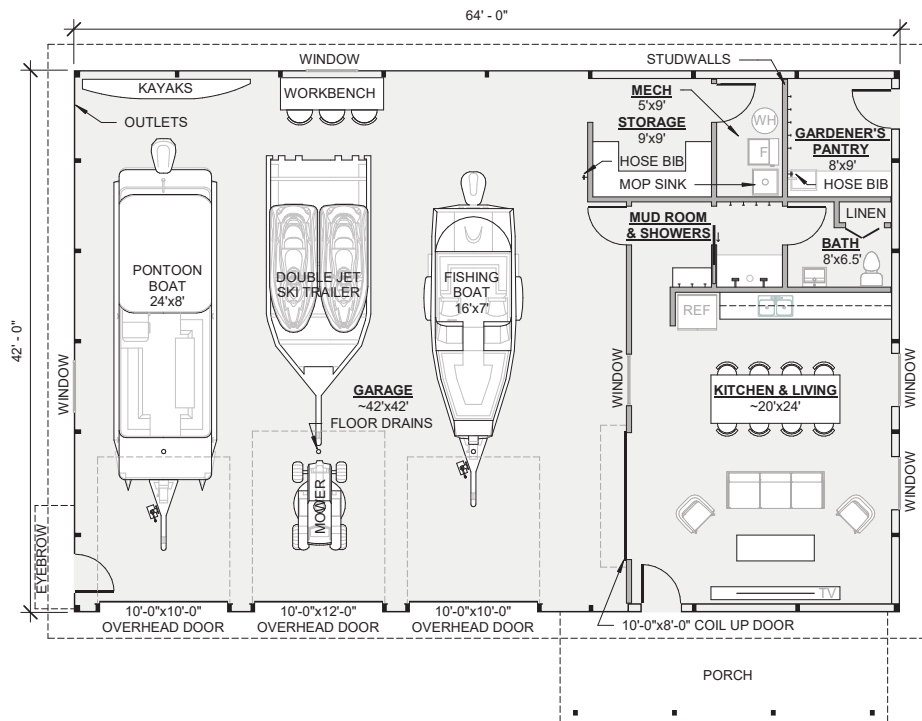
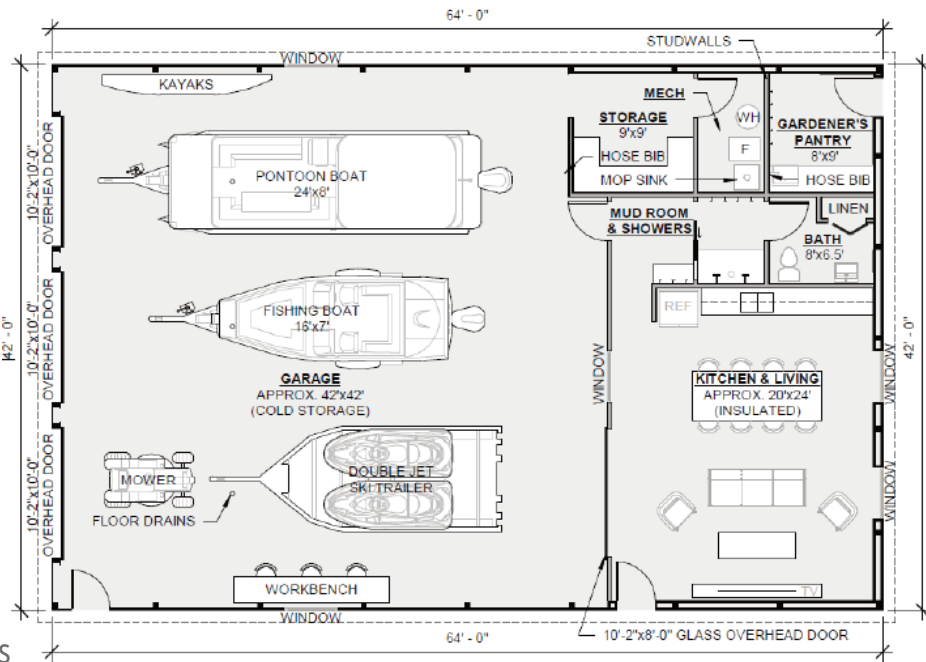

800-447-7436 • mortonbuildings.com



Three Steps to Designing a Building Optimized for Boat and Small Vehicle Storage

1 Design Guidelines. These tips can make storing and accessing boats and other smaller recreational vehicles more efficient and ensure an optimized interior layout.

RECOMMENDATION	BENEFIT
Position largest boat to one side	<ul style="list-style-type: none">• Boat less likely to be damaged during storage• Reduces charging cord tripping hazards• Enables owner to unload and place items on nearby wall storage system while in the boat
Additional height & raised trusses	<ul style="list-style-type: none">• Provides clearance for larger boats and boats with towers
Vertical or high track overhead door	<ul style="list-style-type: none">• Maintains tall open space with the garage door open
Engineered end wall	<ul style="list-style-type: none">• Creates mezzanine storage options

2 Subcontracting Guidelines. Consider the unique mechanical, electrical, and plumbing needs for boats and other smaller recreational vehicles and the impact on the building design or construction process.

RECOMMENDATION	BENEFIT
Mechanical: In floor heating	<ul style="list-style-type: none">• Most efficient method for heating wide and tall spaces
Electrical: 50-amp connections	<ul style="list-style-type: none">• Convenient charging station without the need for lengthy cords or creating tripping hazards
Plumbing: Water, septic/sewer, oil-water separator (some areas)	<ul style="list-style-type: none">• Access where you need it for filling tanks and washing down after the last trip• Simplify black & grey water management (eliminating the 'bucket' method)• Keep environmental impact low
Site Prep/Concrete: Exterior size equal to interior dimensions of the building	<ul style="list-style-type: none">• Clean, smooth, dirt-free environment• Creates outdoor staging areas to prepare for departure or storage

3 Interior Modules. Modules help buyers finalize building design faster.

WHAT MORTON DOES	BENEFIT
Designs and Engineers building with module placement in mind	<ul style="list-style-type: none">• Reduced total overall cost to the customer• Faster overall building completion time• Interior and exterior become seamless design vs. forcing interior layout to align with shell• Ensures building code compliance when all construction is completed
Brings approved, insured external trade professionals to construct the module	<ul style="list-style-type: none">• Hassle free construction process as the Sales Consultant remains single point of contact• Reduced time customer spends searching for, vetting, and confirming licenses and insurance for additional trades

©2022 Morton Buildings, Inc. All rights reserved. Construction details and material specifications shown are subject to change without notice. Colors reproduced on this flyer are for illustrative purposes only and may vary from actual colors or finishes. A listing of GC licenses available at mortonbuildings.com/licenses. SS45.