

Radiance 101 – Sewing and Quilting Basics

Jazzy Journal Cover

Getting Started

Showcase your new sewing and quilting skills by creating this fun and simple journal cover. First, piece together strips or other size pieces to create the cover background. Then, use the various sewing techniques to add cording with the Digital Dual Feed Foot, use taper stitches, add decorative stitches and even quilt using the new Stitch Sync Stitch Regulation built into the Radiance. The sky is the limited! Do as little or as much as you want to create a unique journal cover.



© 2025 Baby Lock USA and Canada. The Jazzy Journal Cover project is part a Baby Lock Radiance 101 Class and is not for individual use only and may not be sold or distributed without prior written approval from Baby Lock. Provided Instructions, graphics, embroidery files, design file and any included video may not be sold shared or produced for commercial purposes.

Project Introduction

This class project is created using the Radiance and showcases the sewing and quilting side of the machine. This project is designed to showcase ways to use the sewing stitches to embellish the journal cover. You could also include embroidery or IQ Designer stitching to this project as well to customize it even more!

Supplies Needed

- Baby Lock Radiance
- J Foot (General Purpose foot) or Optional BLSO-QGF (1/4" Piecing foot)
- 1/4" Piecing Foot or Optional 1/4" Piecing foot with Guide– BLSO-QGF
- Compact Digital Dual Feed Foot, Couching Sole and Yarn Couching Guide
- Stitch Sync Foot and Sole

Notions

- Embroidery Thread and Bobbins
- Sewing Thread and Bobbins
- Appropriate needle for project
- BLC204 Baby Lock Ultra Soft Fusible interfacing or Fusible Fleece Batting
- Chording or Yarn for couching
- Temporary Adhesive Spray
- Marking Pen
- General sewing supplies

Fabric - For this project, you can use any fabric of choice. Strips of fabrics were cut and pieced together for the journal cover.

- Finished cover piece will be trimmed to 12 3/4" X 23 1/2".
- Use 12 - 2.5" X 14" strips – pieced together larger than the trimmed size.
 - OR one solid piece of 14" X 24" fabric for the center.
- 1 – 13" X 24" piece of Ultra Soft Fusible Interfacing or Fleece batting
- 1 – 12 3/4" X 20" piece for the journal lining
- 2- 10" X 12 3/4" pieces for the flaps
- Notebook/journal

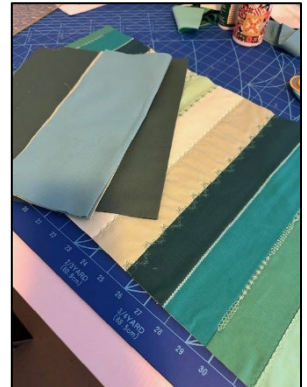

Creating Jazzy Journal Cover

Piecing the Front Cover

1. From the Home Screen, select **Sewing**.
2. Under Tab Q of the Utility Stitches, select **stitch Q-01**. Attach your ¼” piecing foot including with the Radiance or optional BLSO-QGF (¼” Piecing foot)
3. Collect your 2.5” X 14” strips of fabric for the notebook cover.
4. Select the top two strips and with right sides together, stitch along the long edge of the fabrics.
5. Repeat for the other remaining 10 strips.
6. Press the seams along the way.
7. Once stitched, back with Ultrasoft or Fusible fleece batting.
8. Please note, if you would rather do more piecing or stitch the fabrics on a diagonal, feel free. Having the stitched lines and the area for quilting is what is the fun part of this project

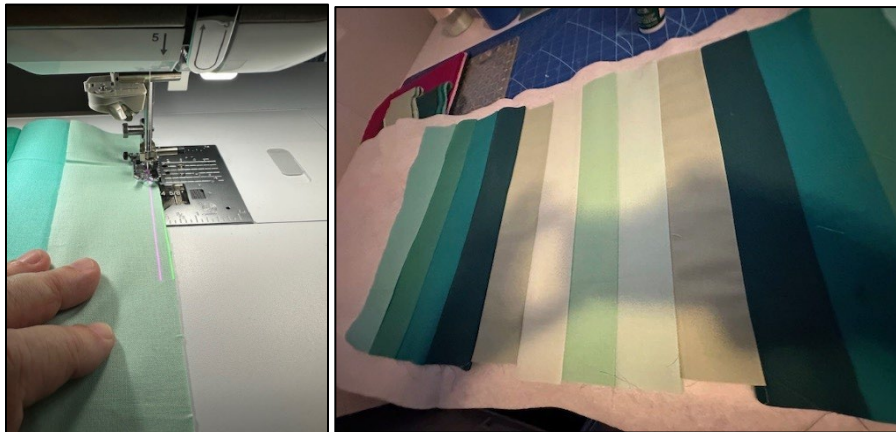

Adding Embellishments to Journal Cover

Couching with the Compact Digital Dual Feed Foot

1. Attach the Digital Dual feed foot leaving the the yarn couching sole off.
 - a. Be sure to plug the foot into the machine
2. Place the yarn couching guide and thread stand on the machine.
3. Thread the machine with a decorative embroidery thread of choice.
4. Select the yarn or cording you would like to use for the project. Thread this through the yarn guide and into the opening in the couching sole.

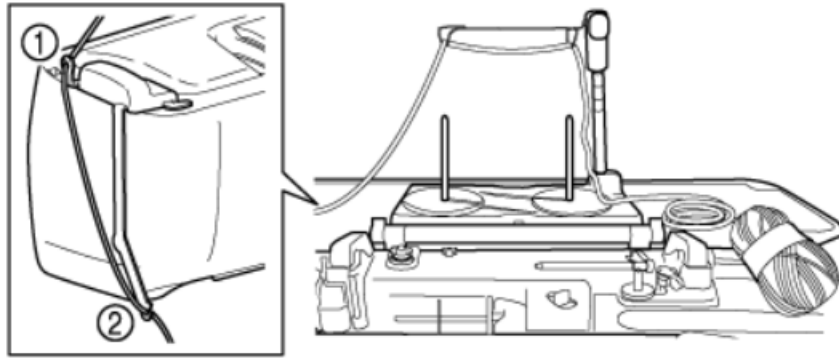

5. Thread the yarn through the couching digital dual feed sole using the thread wire.

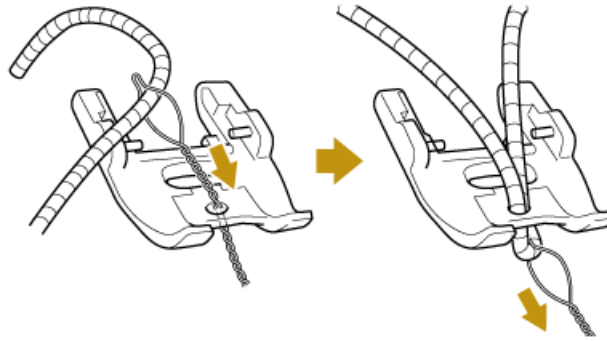

6. Attach the couching sole to the digital dual feed foot.

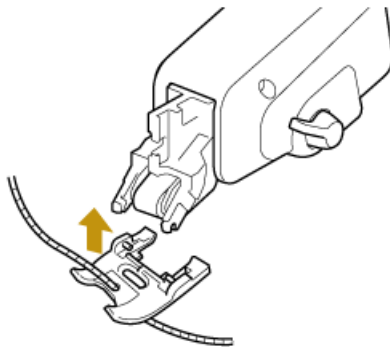

7. From the sewing menu, select a stitch of choice. Note that stitches that are NOT available for use with the Digital Dual Feed Foot will be greyed out.
8. Use the Projector to assist you with previewing your stitch and setting the stitch width.
9. Pull the yarn/cording to the front of the foot and adjust the stitching while visually auditioning them.

10. Some recommended stitches with the DDF Couching include 1-10 Zig Zag Stitch, 2-11-2-16, Q-18-Q-20.

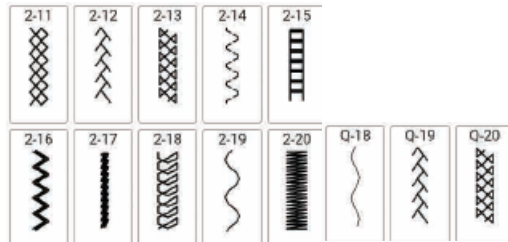

11. Be sure to move the yarn/cording back to under the digital dual feed foot once you have made your selection.
12. Find a seam on the pieced project to embellish and stitch the cording in place

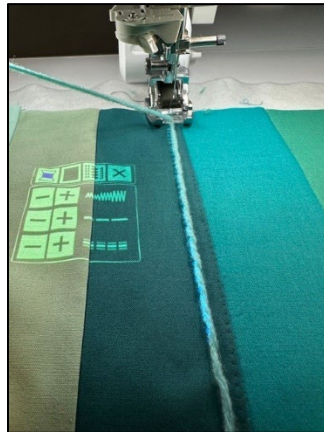

Stitch Tapering Stitches

1. Remove the Digital Dual feed foot and attach the ankle and J foot.
2. From the Sewing Menu, select the T Tab of stitches.
3. These stitches allow you to set angles at the start and end of stitch patterns. This is helpful when sewing projects with defined angles or decorative stitching and attaching applique.
4. Select a Tapering stitch from the Menu:

Radiance 101 Class – Sewing and Quilting Basics Project

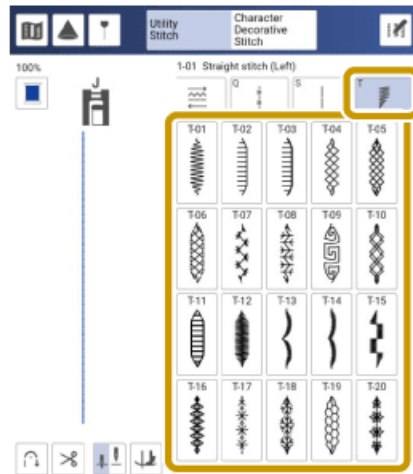

5. Touch the Edit Menu and then touch .
6. Once in the Tapering Menu, you can select the angle degree for the start and end of stitching.
7. Then, you can choose the Ending Style. There are three options
 - a. Using the Reverse Key on the machine to begin the tapering
 - b. Select a specified number of stitch pattern repeats
 - c. Use the End Sewing Sticker to designate the tapering end.
8. For this exercise, you can choose whatever method you like.
9. The sample was done using the repeats of stitch patterns using a variety of stitches in the Tapering Menu.
10. Turn on the Pivot Feature so that the needle ends in the down position.
11. Select another seam line to stitch the tapering stitches along.
12. Stitch out one pattern.
13. Once completed choose another determining the approximate length and stitch that.
14. Continue until the stitch line is completed.
15. Remember that the final piece of fabric will be trimmed and sewn to the inside of the cover, so you may want to allow about an 1" at the top and bottom to showcase the tapering features.



Character and Decorative Stitches

1. Select the Character and Decorative Stitching Menu on the Sewing side.



2. Under Character and Decorative Stitching, there are 10 Decorative Stitch Tabs, 4 Character Tabs and a Memory Pocket. These can all be viewed in the Embroidery Design Guide for the Radiance.

Radiance 101 Class – Sewing and Quilting Basics Project

Display	Category Name
	Wide and Various
	Wide Botanical
	Wide Motifs and Messages
	Narrow and Various
	Narrow Botanical
	Candlewicking
	Large Satin
	Satin
	Cross Stitches
	Combinable Utility
	Alphabet Characters (Gothic Font)
	Alphabet Characters (Handwriting Font)
	Alphabet Characters (Outline Font)
	Cyrillic font
	Pocket (Machine's and external memory) (Retrieving Stitch Patterns)

- From Category 7 and scroll to stitch 7-38.
- Turn on the Projector
- Using the Dual Purpose Stylus, select the option to Select a different stitch pattern.

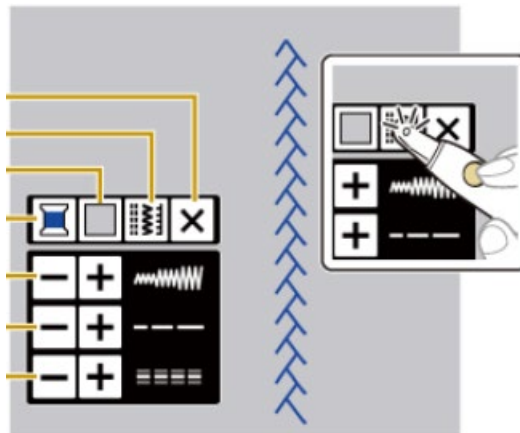

- This allows the opportunity to preview and audition stitches on your fabric.
- Once a stitch is selected, use the stitch edition options to change the stitch length, width, or the l/r shift.
- Align the stitch on your fabric. Be sure to use the recommended N+ foot.
- Once selected, close the projector, and begin stitching along one of the seam lines.



Stitch Stepping

1. You can also create a step effect, also called step stitch patterns.
2. For stitch stepping, first click the Plus icon on the screen to designate that you are wanting to combine stitches together.
3. Select a design and then touch the arrows to move the stitch pattern to the left or right.

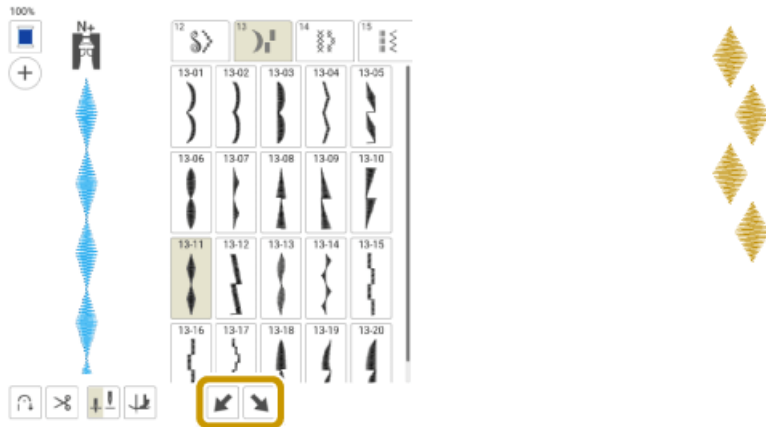

4. Continue adding stitch pattern and adjust the stepping to the left or right.
5. This can be done using the same stitch pattern or combining stitch patterns together.
6. Once you have completed, touch the stitch settings and the pattern repeat key.



7. Save the combined step stitch pattern to Memory pocket to use again.



Twin Needle Sewing

1. With the twin needle, you can sew two parallel lines on the same stitch with two different threads. Both upper threads should be the same thickness and quality
2. Using the “J” foot is recommended with these stitches
3. A twin needle size 2/11 is recommended (and included) for your machine.
4. The Automatic threading button can not be used! You will want to manually thread the needles.
5. Replace your pressure foot and needle to the twin needle.
6. Use the horizontal thread stand and select 2 unique spools of thread.
7. Follow the same threading path for both threads and manually thread the individual needles.
 - a. Note: In the manual, it shows not threading the right-side needle thread under the needle bar thread guide (6).
8. Under the stitch editing menu, touch the option to select twin needle mode.

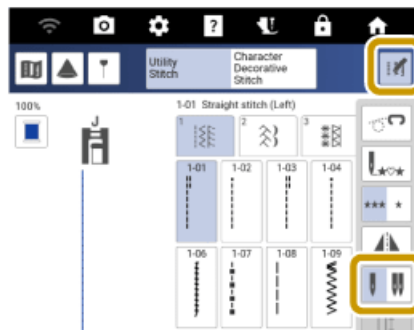

9. With this option selected, only stitch patterns that allow twin needle sewing can be selected.
10. Find another seam on your journal cover and stitch with the stitch pattern of choice showcasing the twin needle sewing.

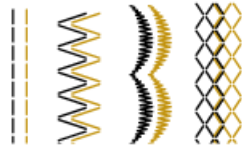

These are just some of the options to help embellish our project. The sky is the limit when it comes to what you could do to add to your project. Add ribbon with the twin needle sewing or couching using different weights and types of yarns/ threads. Use the hand-stitch stitches in the specialty category (S-03 – S-05) to stitch along the seam edges. Try using more decorative stitches from other categories or combine stitches together to create something unique. Add embroidery or fonts to the cover to add a name or design element. Most of all, have fun exploring this side of your machine.

Other options – Embroidery and IQ Designer

As with anything, you could always use Embroidery and IQ Designer to be able to embellish the front of the notebook cover. For this, you could hoop and scan in the pieced cover fabric.

Then, scan the hoop as a background image and then add the decorative stitches in embroidery, using the pattern repeat key. Place multiple lines and stitch them in the hoop.

With IQ Designer, you could again, scan the background and use the line drawing tools to add lines on the seams and apply various motif stitches. Fills could also be added by using the shapes to define the open sections of the stripped piecing and then filled with motif stitches. Bring over to embroidery and stitch out.

These would be fun to create using some of the Design Suite Fills and Motifs.

Quilting with the Compact Digital Dual Feed Foot –

1. The compact digital dual feed foot is a great way to do straight line quilting or stitch-in-the-ditch.
2. For any of the open areas, you could do matchstick or crosshatch quilting patterns.
3. Use a marking pen or chaco liner to mark the lines on your fabric
4. You can also use the Projector and the Grid GLM to assist you with quilting on your fabrics.
5. This foot helps to keep the quilt top, batting and backing (if attached) from slipping when quilting.
6. This is one option for quilting the inner sections of the notebook cover.

Stitch Sync Free Motion Quilting -

1. One of the newest features on the Radiance is the addition of stitch regulation using the Stitch Sync Foot. The stitch regulator allows free-motion quilting and free-motion basting with a set stitch length. The machine detects how the fabric is being moved and adjusts to ensure the set stitch length.

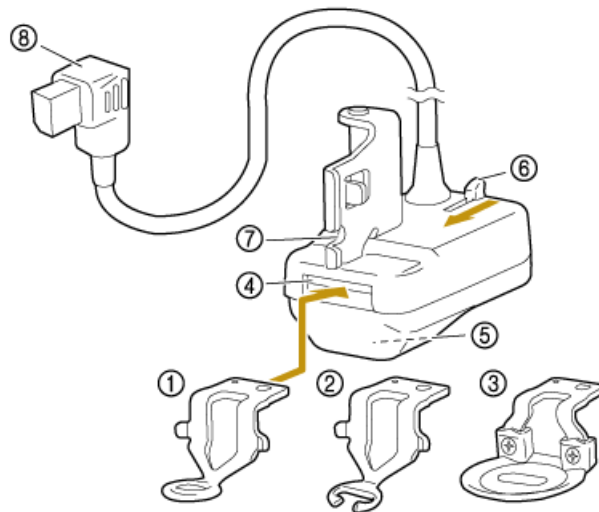

2. Attach the foot, being sure to plug it into the machine.
3. Attach the foot of choice (quilting foot, open toe or echo quilting). These feet are easy to remove and attach using the lever on the right side of the foot.
4. Once the foot is attached, the machine will automatically put the stitch setting into Stitch Sync Mode and a different menu will come on
5. With the stitch regulation, you have the option to choose Intermittent, Continuous or Basting Modes.
6. There are also options to adjust the stitch length, l/r shift and tension. Zigzag patterns are suitable for thread painting.
7. This features also engages the Projector and Needle drop point.

8. A projected line is shown which indicates the position where the sensor can detect the fabric. It must be on the fabric while sewing.
9. There is also a projected square near the foot the indicates the following:
 - a. Green – Ready to sew or sewing
 - b. Flashing Green – Standby in intermittent mode or basting mode
 - c. Red – Not ready to sew
 - d. OFF – If the stitch regulator function is turn off or the projector has been turned off.
 - e. The sensor for the stitch regulator can be found on the bottom side of the foot.

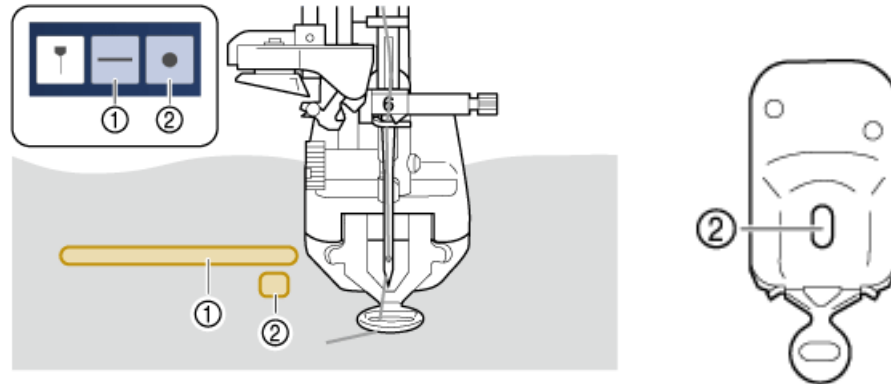

10. Thread the machine with thread of choice using a quilting or ballpoint needle. Refer to the owner's manual for tips on success with using the stitch regulation.
11. Pull the bobbin thread up through the fabric.
12. Lower the presser foot.
13. Use the Foot controller or the Start/Stop button and then move the fabric.
14. Mark a pattern onto the fabric section and use the stitch regulator to stitch that pattern.
15. Once completed, secure the thread tails at the end.
16. NOTE: Free motion quilting is a skill that requires some practice and patience. If new, some successful tips include using motions that you already have muscle memory for like “e” “s” loops etc. Be kind to yourself as you learn.
17. There is a ton of quilting techniques available to help improve your free motion quilting skills.
18. After done quilting the desired sections, remove the stitch regulator and foot.

Finishing the Project -

1. From the Home Screen, select **Sewing**.
2. Under Tab 1 of the Utility Stitches, select **stitch 1-03**.
3. Attach the standard “J” Foot.
4. Trim the quilting piece to 12 ¾” x 23 ½” using a rotary cutter and quilt ruler.
5. Take the two flap pieces and fold in half so they measure 5” X 12 ¾”. Press



6. Lay the quilted pieces down, right sides up. Place flaps on short ends with the folds towards the center and the raw edges aligned.
7. Stitch along short edges only using the edge of the “J” foot as a guide. This will make a 3/8” seam allowance.



8. Lay the lining over the flaps and quilted piece. The lining will be shorter than the quilted piece. This is OK.
9. Stitch along the top and bottom.

Radiance 101 Class – Sewing and Quilting Basics Project



10. Turn the journal cover right side out through the lining first.
11. Now turn the flaps right sides out.
12. Use the pointer creaser to make nice sharp corners and press well.
13. Insert your notebook or journal into the cover.
14. Please note that this project could be adjusted to accommodate various size notebooks.

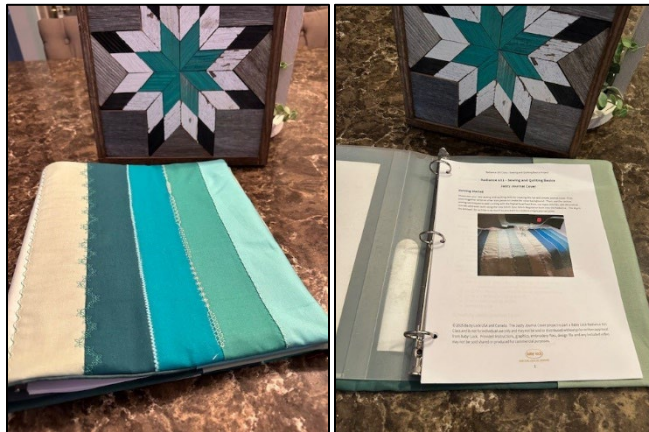

baby lock

FOR THE LOVE OF SEWING