

**DURABOOK**

# Fully Rugged Tablet PC

## R10 User's Manual



**DURABOOK**

# Table of Contents

<b>BEFORE YOU START .....</b>	<b>5</b>
PACKAGE CONTENTS .....	5
PRODUCT OVERVIEW .....	6
<i>Front View</i> .....	6
<i>Back View</i> .....	8
<i>Top View</i> .....	9
<i>Bottom View</i> .....	9
<i>Left View</i> .....	10
<i>Right View</i> .....	10
<i>Status Indicators</i> .....	11
<b>GETTING STARTED .....</b>	<b>12</b>
INSTALLING THE BATTERY .....	12
CHARGING THE BATTERY .....	13
WHEN TO REPLACE THE BATTERY PACK .....	13
REMOVING THE BATTERY .....	13
CONNECTING THE POWER .....	15
<i>Connecting the Adapter</i> .....	15
<i>Using Battery Power</i> .....	16
<i>Configuring the Power Settings</i> .....	17
<b>STARTING YOUR TABLET PC .....</b>	<b>18</b>
TURNING ON YOUR DEVICE .....	18
TURNING OFF YOUR DEVICE .....	18
<b>OPERATING YOUR TABLET PC.....</b>	<b>19</b>
USING THE QUICK MENU .....	19
<i>Quick Menu Overview</i> .....	19
<i>Viewing the Version Information</i> .....	20
<i>Viewing the Battery Charge Cycles</i> .....	20
<i>Configuring the Battery Charging Protection Setting</i> .....	21
<i>Configuring the Programmable Button (P1)</i> .....	22
<i>Configuring the Programmable Button (P2)</i> .....	22
<i>Assigning an Application to the Programmable Buttons</i> .....	23
<i>Configuring the Up/Down Buttons</i> .....	24
<i>Configuring the Copilot Button</i> .....	24
<i>Configuring the P Button</i> .....	25
<i>Accessing the Mobility Center</i> .....	26
<i>Enabling Adaptive Brightness</i> .....	27

<i>Configuring the Touchscreen Settings</i> .....	28
<i>Enabling Cellular/GPS Function (for LTE SKU only)</i> .....	29
USING THE CAMERA .....	30
<i>Opening Camera App</i> .....	30
<i>Taking Photos</i> .....	31
<i>Recording Videos</i> .....	32
<i>Switching Between Modes</i> .....	33
<i>Enable HDR Function</i> .....	33
<i>Setting Photo Timer</i> .....	34
<i>Configuring Camera Settings</i> .....	34
<i>Viewing Photos/Videos</i> .....	36

## **MAKING CONNECTIONS ..... 37**

INSTALLING THE MEMORY CARD.....	37
INSTALLING THE SIM CARD.....	38
CONNECTING THE HEADSET/MICROPHONE.....	39
ATTACHING THE STYLUS HOLDER .....	40
CONNECTING USB DEVICES .....	41
CONNECTING TO EXTERNAL DISPLAYS.....	42
CONNECTING TO WIRELESS DEVICES.....	43
<i>Opening the Quick Settings Menu</i> .....	43
<i>Connecting to a Bluetooth Device</i> .....	44
<i>Connecting to a Wireless Local Area Network</i> .....	46
<i>Connecting to a Wireless Wide Area Network (WWAN)</i> .....	48

## **USING THE BIOS SETUP UTILITY ..... 49**

BIOS SETUP MENU .....	49
<i>Starting the BIOS Setup Utility</i> .....	49
<i>Navigating and Entering Information in BIOS</i> .....	50
BIOS HOMEPAGE .....	51
MAIN MENU .....	52
ADVANCED MENU .....	54
SECURITY MENU .....	58
BOOT MENU .....	59
EXIT MENU .....	60
ONEKEY FLASH MENU .....	61

## **MAINTAINING AND CARING FOR YOUR TABLET PC..... 62**

PROTECTING YOUR TABLET PC .....	62
STORING AND HANDLING YOUR TABLET PC .....	62
<b><i>General Storage and Handling Guidelines</i></b> .....	62
<b><i>Display and Touchscreen Guidelines</i></b> .....	63
<b><i>Battery Pack Guidelines</i></b> .....	64
<i>Battery Charging Recommendations</i> .....	65

CLEANING YOUR TABLET PC .....	65
TRAVELING WITH YOUR TABLET PC .....	66

**TROUBLESHOOTING..... 67**

PRELIMINARY CHECKLIST .....	67
SOLVING COMMON PROBLEMS.....	67
<b>Battery Problems</b> .....	67
<b>BT Wireless Transmission Problems</b> .....	69
DISPLAY PROBLEMS .....	69
HARD DISK PROBLEMS .....	70
OTHER PROBLEMS .....	72

**APPENDIX ..... 74**

COPYRIGHT .....	74
SPECIFICATIONS .....	74
REGULATORY STATEMENT .....	78
IC REGULATIONS .....	78
DECLARATION OF CONFORMITY .....	79
RF EXPOSURE WARNING .....	79
BATTERY DISPOSAL .....	80
USB PD FAST CHARGING.....	80
WARNING EXPLOSION HAZARD.....	80
CYBERSECURITY INFORMATION .....	82
BATTERY STATEMENT .....	82
<i>CLASS 2 LASER PRODUCT</i> .....	83
SAFETY INSTRUCTIONS .....	84
SHOPFLOOR DATE CODE FORMAT DESCRIPTION.....	86

# Before You Start

Congratulations on your purchase of a DURABOOK R10 tablet PC.

This fully rugged, portable tablet PC provides users with maximum mobile computing experience in a wide range of working environments. Before you begin using your tablet PC, read this chapter to familiarize yourself with the main system components.

## Package Contents

If any of the following items are damaged, please contact your retailer.



Tablet PC



AC adapter



Power cord



Stylus and tether

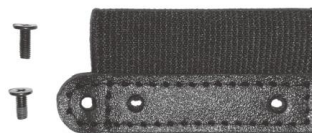

Stylus holder with screws



### NOTE

- The pictures are for reference only. Actual items may vary.
- Declaration of product weight: 1.2kg. The actual weight may vary by configuration.

# Product Overview

## Front View



No.	Item	Description
1	Front camera indicator	Illuminate when the front camera is in use.
2	Front camera	Use for video conferencing.
3	Camera cover	Protect the camera.
4	Ambient light sensor	Detect the current level of visible light in the surrounding environment.
5	P1 and P2 buttons	P1: Press to activate the assigned function. <ul style="list-style-type: none"> <li>Stealth mode</li> <li>Night Vision mode</li> <li>Launch a specific application</li> <li>Disable (no function)</li> </ul>

No.	Item	Description
		P2: Press to activate the assigned function. <ul style="list-style-type: none"> <li>• Launch Windows Camera application</li> <li>• Touch screen mode selection</li> <li>• SAS key</li> <li>• Launch a specific application</li> <li>• Disable (no function)</li> </ul>
6	Copilot button	Press to activate the assigned function. <ul style="list-style-type: none"> <li>• Launch Copilot</li> <li>• Launch a specific application</li> <li>• Disable (no function)</li> </ul>
7	Up and Down buttons	▲: Press to activate the assigned function. <ul style="list-style-type: none"> <li>• Increase the LCD panel brightness level</li> <li>• Increase the volume level</li> <li>• Disable (no function)</li> </ul> Pre-OS Phase: "Enter" Key function  ▼: Press to activate the assigned function. <ul style="list-style-type: none"> <li>• Decrease the LCD panel brightness level</li> <li>• Decrease the volume level</li> <li>• Disable (no function)</li> </ul> Pre-OS Phase: SAS key ( <b>Ctrl + Alt + Del</b> ) function
8	Microphones	Record the surrounding sound.

## Back View

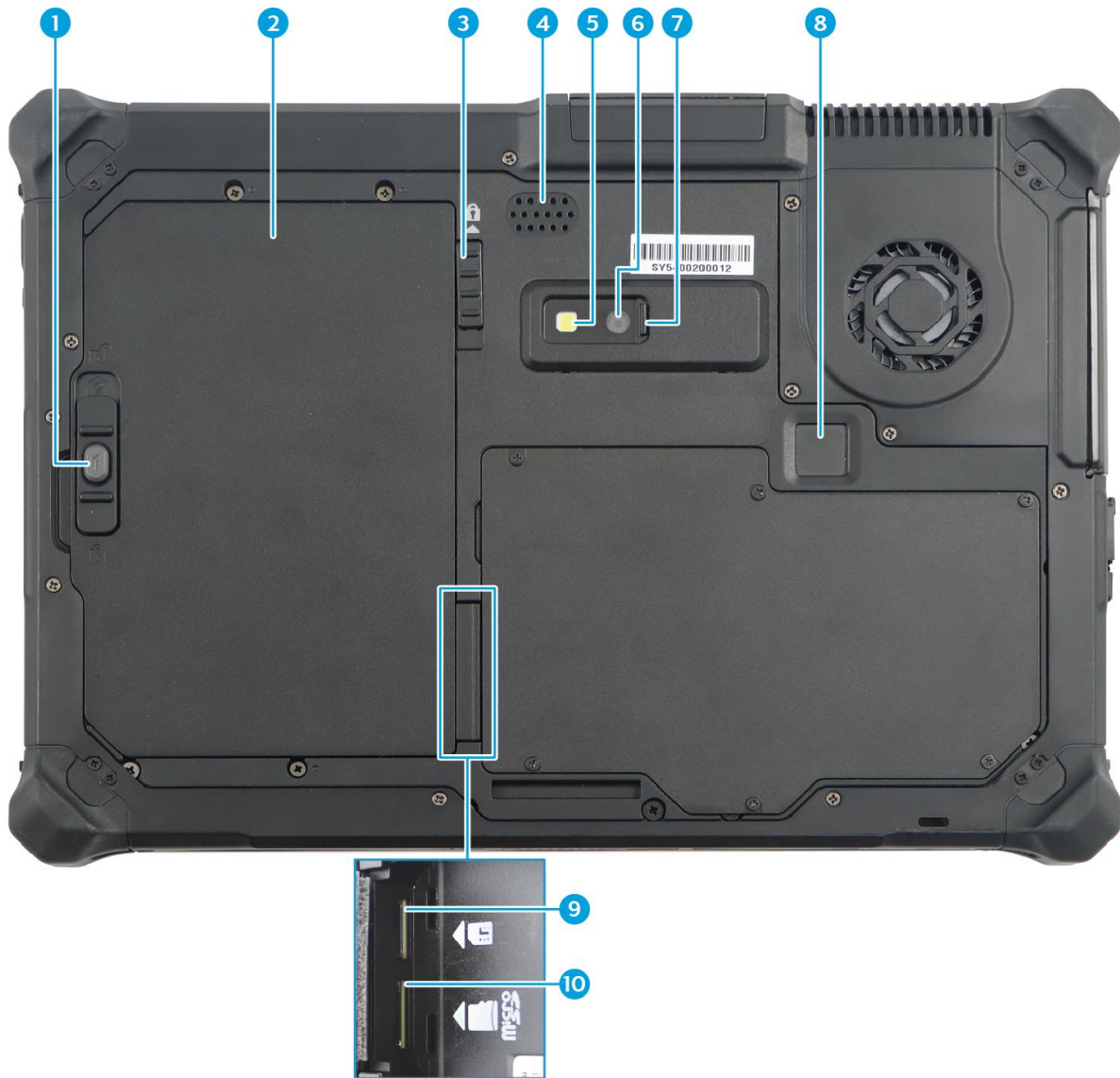

No.	Item	Description
1	Battery latch release button	Press the button and slide it from the locked position to the unlocked position in order to release the battery latch.
2	Battery compartment	Contain the tablet PC's battery.
3	Battery lock switch	Slide to lock/unlock the battery pack.
4	Speaker	Emit sound.
5	Camera LED flash	Provide additional lighting when taking pictures under low light environments.
6	Rear camera (optional)	Use to take pictures.

No.	Item	Description
7	Rear camera cover	Protect the camera.
8	Fingerprint scanner (optional)	Scan fingerprint for biometric identification.
9	Nano SIM card slot	Use to insert a SIM card for WWAN module connection.
10	MicroSD memory card slot	Use to insert a MicroSD card to transfer pictures, music, and data between your tablet PC and flash-compatible devices.

### Top View



No.	Item	Description
1	Barcode scanner (optional)	Scan barcodes. 

### Bottom View



No.	Item	Description
1	RF Pass-thru connector	Use for the external WLAN antenna.
2	connector (optional)	Use for the external GNSS antenna.
3		Use for the external WWAN antenna.
4	Docking connector	Connect the tablet PC to a docking station.

## Left View



No.	Item	Description
1	Audio combo jack	Connect a headset.
2	RJ45 port	Connect an RJ45 peripheral device.
3	Thunderbolt 4 port	Connect a Thunderbolt peripheral device.
4	USB 3.2 Type-A port	Connect a USB 3.2 peripheral device.
5	DC-in jack	Connect a power adapter.

## Right View





No.	Item	Description
1	Mounting slot for stylus holder	Attach the stylus holder with the provided screws for easy access to the stylus.
2	P button	Press to activate the assigned function. <ul style="list-style-type: none"> <li>• Launch Windows Camera Application</li> <li>• Shortcut key for launching specific application</li> <li>• Disable (no function)</li> </ul>
3	Power button	Press to turn your tablet PC on/off or enter/exit the modern standby (advanced sleep) mode. Power button settings can be configured in <b>Settings</b>  > <b>System</b> > <b>Power &amp; battery</b> > <b>Lid, power &amp; sleep button controls</b> .

## Status Indicators

The status indicators on the tablet PC light up when a particular function is active.



Icon	Item	Description
	Power	The LED always lights on (green) when the system is running. When the system is in sleep mode, the LED blinks.
	Battery	Indicates the battery status: <ul style="list-style-type: none"> <li>• Green: Battery capacity is at 95% and above</li> <li>• Orange: Battery charging</li> <li>• Flashing orange: Charging error</li> <li>• Red: Battery capacity is lower than 7%</li> <li>• Off: Battery discharged</li> </ul>
	RF mode	Indicates the RF mode status: <ul style="list-style-type: none"> <li>• Blue: An RF feature (WLAN/Bluetooth/WWAN) is on.</li> <li>• Off: None of RF features (WLAN/Bluetooth/WWAN) are on.</li> </ul>

# Getting Started

This chapter will help you get started using the device.

## Installing the Battery

To install the battery, follow the steps below:

1. Align and insert the battery into the battery compartment.
2. Push completely until the battery locks into place.



3. Slide the battery latch into the lock position to secure the battery.



4. Slide the battery latch into the lock position to secure the battery.



# Charging the Battery

The Lithium-ion battery is not fully charged upon purchase.

To charge the battery, follow the steps below:

1. Install the battery into your tablet PC. Refer to the "Installing the Battery" section.
2. Connect the AC adapter to the DC-in jack on your tablet PC.
3. Connect the AC adapter to the power cord.
4. Plug the power cord into an electrical outlet.

# When to Replace the Battery Pack

The battery performance gradually decreases over time and usage. We recommend you replace your battery pack after 18 to 24 months of usage.

# Removing the Battery

To remove the battery, follow the steps below:

1. Slide the battery lock switch to the unlock position. This will make the system enter S4 mode after 20-30 seconds. Wait until the power LED turns off.
2. Press and hold the battery latch release button to slide the battery latch to the unlock position.



## Getting Started

---

3. Remove the battery from the battery compartment.



# Connecting the Power

You can charge your tablet PC using the AC adapter, PD adapter, or the Lithium-ion battery.

## Connecting the Adapter

Your tablet PC supports both AC adapter and PD adapter. The adapter powers up your tablet PC and charges the battery.

### AC Adapter (Barrel-Type)



1. Connect the AC adapter to the DC-in jack on your tablet PC.
2. Connect the AC adapter to the power cord.
3. Plug the power cord to an electrical outlet.

### PD Adapter (USB-C Type)



1. Connect the PD adapter to the Thunderbolt 4 port of your tablet PC.
2. Plug the PD adapter to an electrical outlet.



#### NOTE

- Ensure that the power output of the PD adapter is at least 65W or above.
- PD adapter is not included in the package.

### Using Battery Power

1. Install the charged battery in the battery compartment. Refer to the "*Installing the Battery*" section.
2. Remove the AC adapter (if plugged in). Your tablet PC will automatically use the battery power.



#### NOTE

- If your tablet PC is connected to an electrical outlet and the battery is installed, it will use power from the electrical outlet.

# Configuring the Power Settings

1. Search for "edit power plan." Then click **Open**.

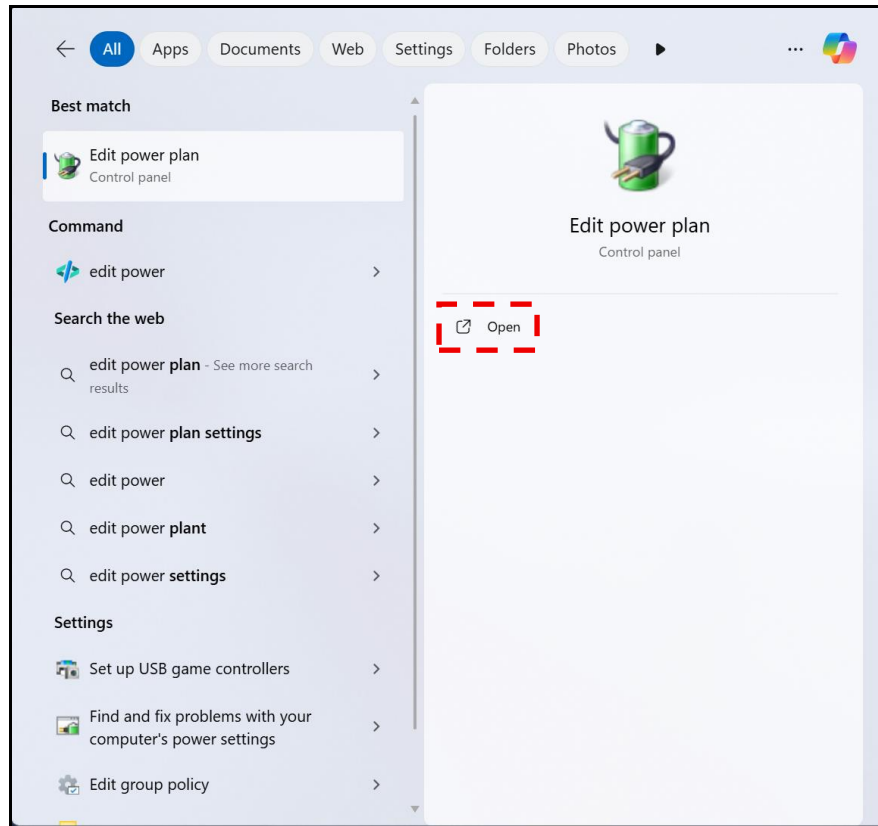

2. Change the desired sleep and display settings. Then click **Save changes**.

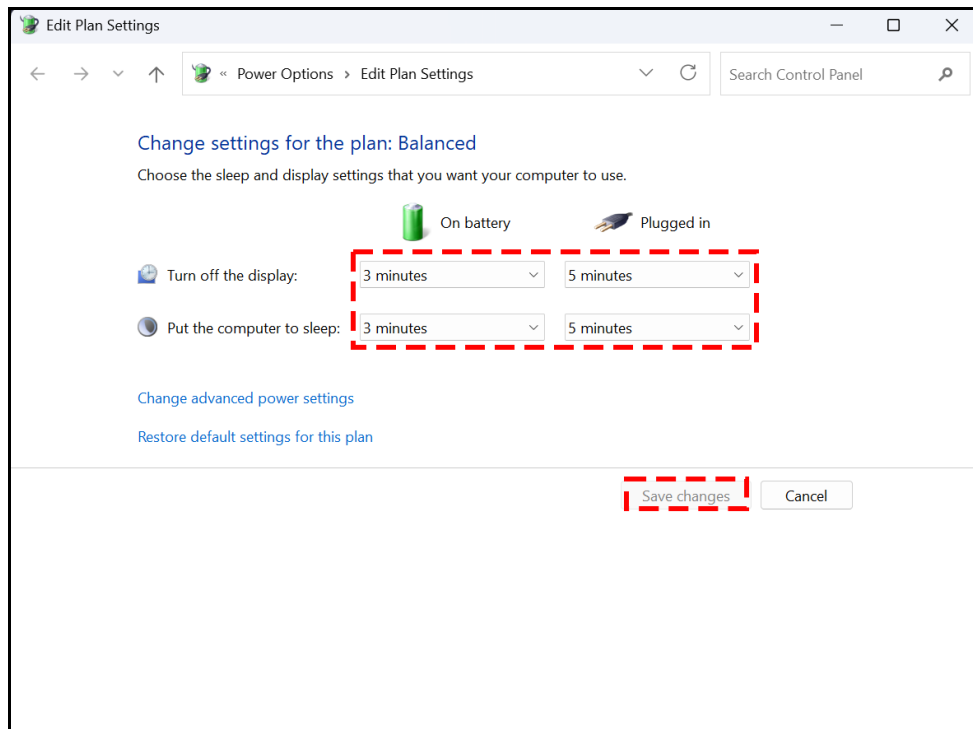



# Starting Your Tablet PC

## Turning On Your Device

Press the  button until the Power LED lights up.

## Turning Off Your Device

It is important to properly shut down your tablet PC to avoid losing unsaved data. To shut down your tablet PC, do the following:

Click  >  > **Shut down**.

Wait for your tablet PC to turn off power completely before removing the power source (if necessary).

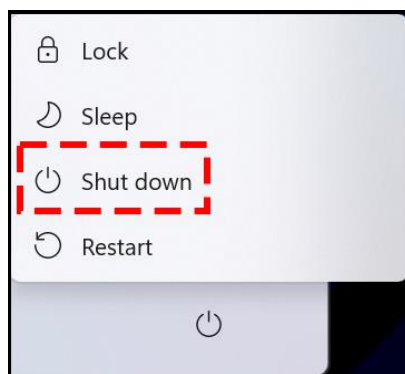

# Operating Your Tablet PC

This chapter will guide you on how to use your Tablet PC.

## Using the Quick Menu

To enter the Quick Menu, tap the caret (^) on the task bar. Then tap the Quick Menu icon (⚙️).

### Quick Menu Overview

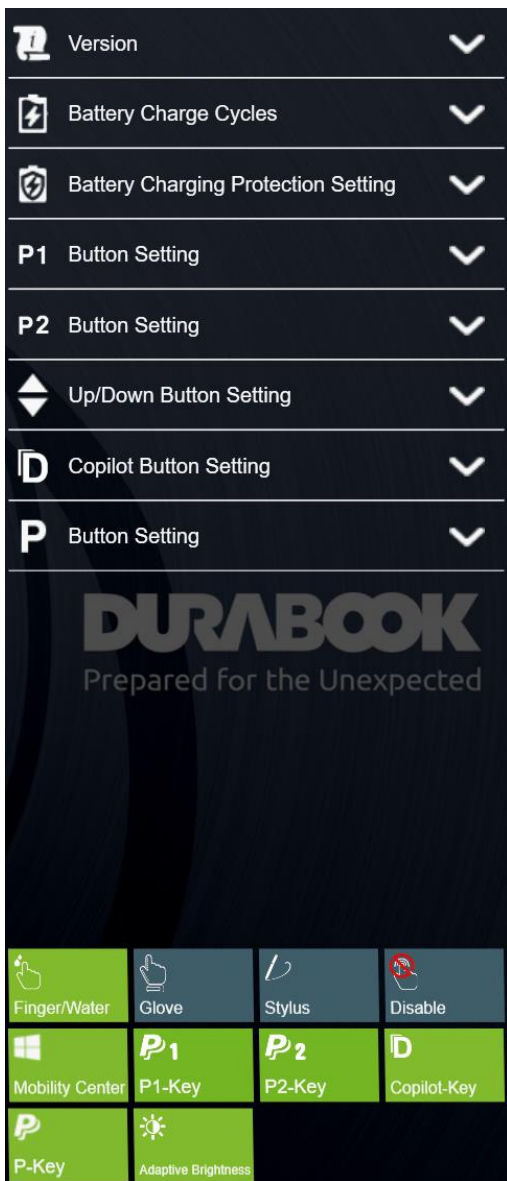

(Wi-Fi SKU)

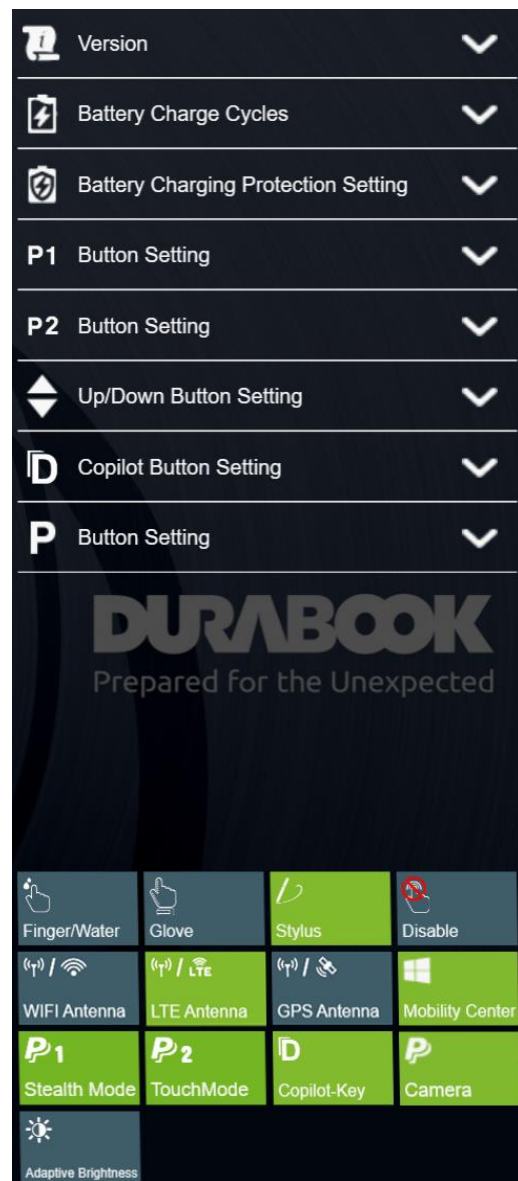

(LTE SKU)



**NOTE**

- Available function tabs vary depending on the device SKU.
- If the tab is green (i.e. ) , the corresponding function is active.

## Viewing the Version Information

In the **Version** section, you can view the BIOS version, EC version, and Quick Menu version.

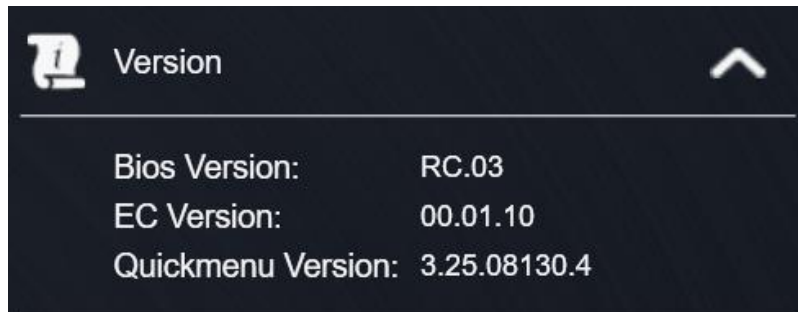

## Viewing the Battery Charge Cycles

In the **Battery Charge Cycles** section, you can view the battery charge cycle and battery status.



# Configuring the Battery Charging Protection

## Setting

In the **Battery Charging Protection Setting** section, you can configure the battery charging protection setting.

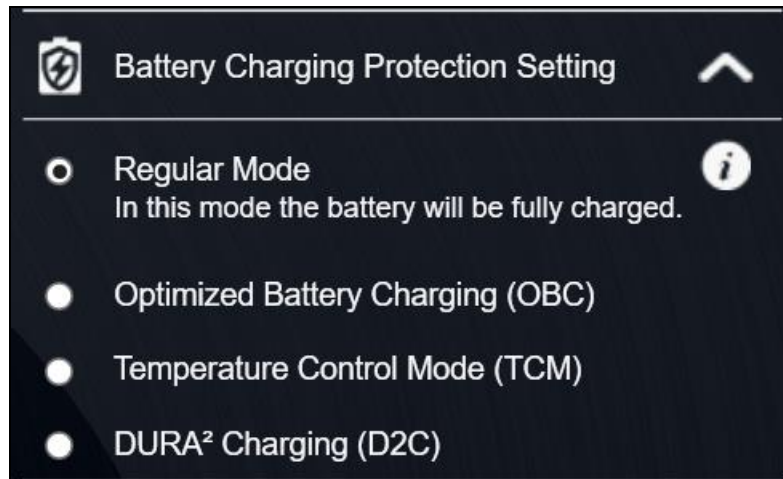

Select one of the available options:

- **Regular Mode:** The battery will be fully charged.
- **Optimized Battery Charging (OBC):** Battery charging will stop at 80% to reduce battery aging.
- **Temperature Control Mode (TCM):** The charging is enhanced based on DURABOOK intelligent algorithm and battery temperature to extend the lifetime of the battery.
- **DURA² Charging (D2C):** The charging is enhanced based on DURABOOK intelligent algorithm and battery temperature to maximize the battery performance and lifespan. The battery will stop charging at 80%.

## Configuring the Programmable Button (P1)

In the **P1 Button Setting** section, you can assign a function to the **P1** button.



Select one of the available options:

- **Stealth Mode:** Turn off the LCD backlight, LEDs, speakers, camera flash, and RF devices.
- **Night Vision Mode:** Adjust the brightness of the LCD under 1.7 nits and turn off the LEDs and camera flash.
- **Launch Application:** Launch a specific application. To assign an application, refer to the "Assigning an Application to the Programmable Buttons" section. The default application is the Quick Menu.
- **Disable:** Disable the P1 button.

## Configuring the Programmable Button (P2)

In the **P2 Button Setting** section, you can assign a function to the **P2** button.

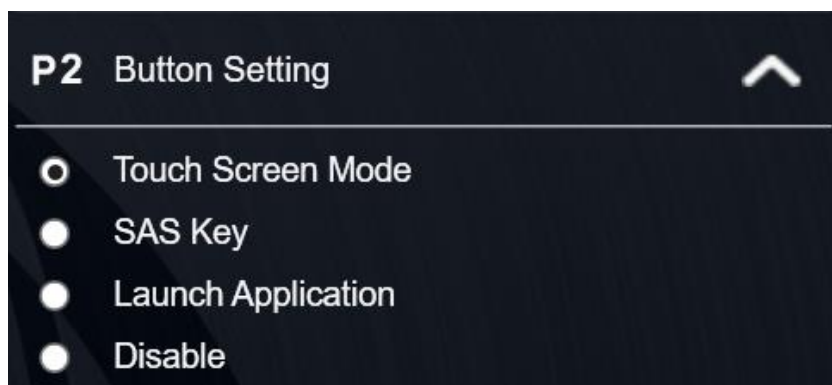

Select one of the available options:

- **Touch Screen Mode:** Toggle the touch screen mode.
- **SAS Key:** Enable the SAS key (**Ctrl + Alt + Del**) function.
- **Launch Application:** Launch a specific application. To assign the application, refer to the "Assigning an Application to the Programmable Buttons" section. The default application is the Quick Menu.
- **Disable:** Disable the P2 button.

# Assigning an Application to the Programmable Buttons

## Buttons

When a programmable button (P1-Key, P2-Key, Copilot-Key, P-Key) setting is set to **Launch Application**, tap on the corresponding tab.



Select the desired application from the pop-up window and click **Open**.

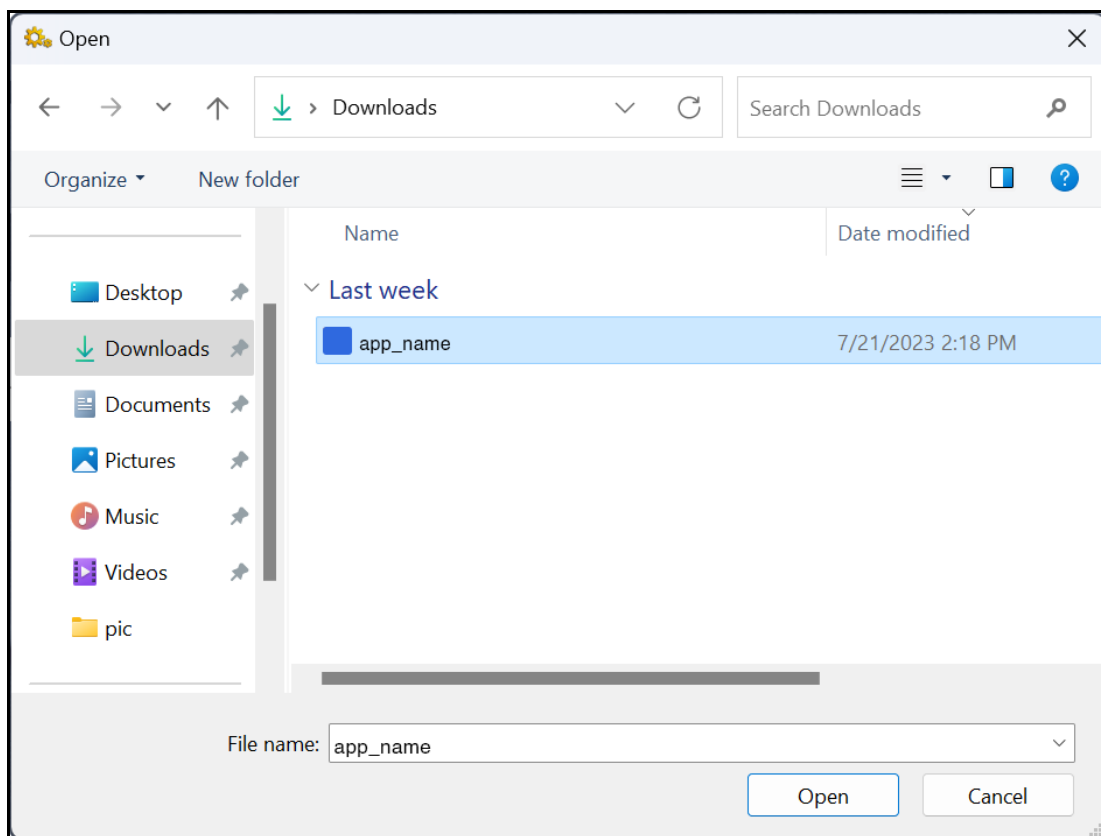

## Configuring the Up/Down Buttons

In the **Up/Down Button Setting** section, you can assign a function to the ▲ and ▼ buttons.

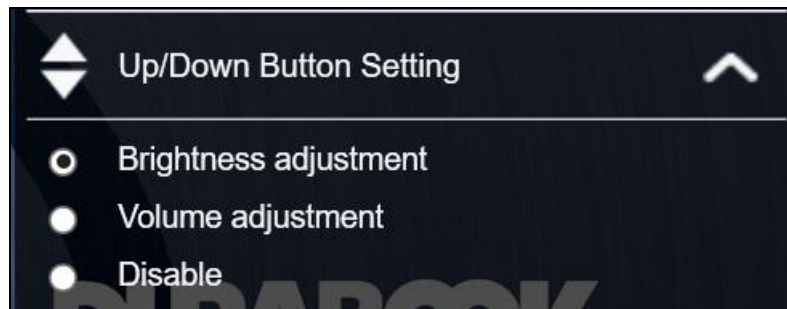

There are three available options:

- **Brightness adjustment:** Adjust the LCD panel brightness level.
- **Volume adjustment:** Adjust the volume level.
- **Disable:** Disable the up/down buttons.

## Configuring the Copilot Button

In the **Copilot Button Setting** section, you can assign a function to the Copilot button.

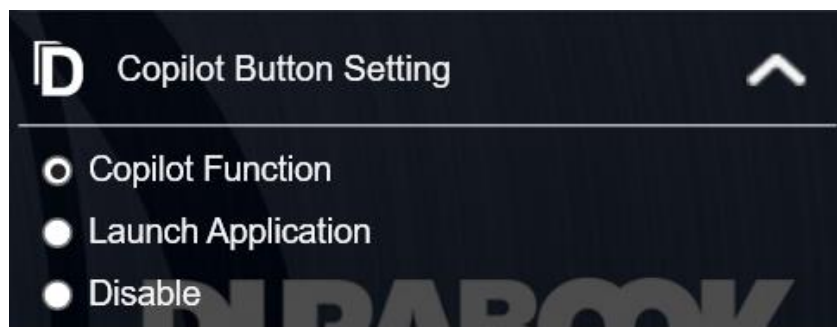

There are three available options:

- **Copilot Function:** Shortcut for launching Copilot in the web browser.
- **Launch Application:** Shortcut for launching a specific application. To assign an application, refer to the "Assigning an Application to the Programmable Buttons" section.
- **Disable:** Disable the Copilot button.

## Configuring the P Button

In the **P Button Setting** section, you can assign a function to the P button.

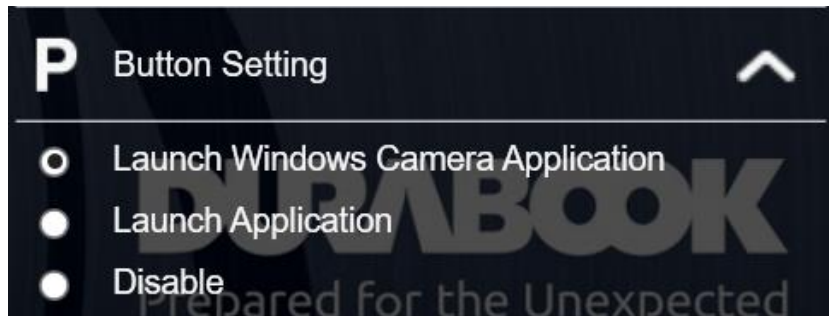

There are three available options:

- **Launch Windows Camera Application:** Shortcut for launching the Camera application.
- **Launch Application:** Shortcut for launching a specific application. To assign an application, refer to the "*Assigning an Application to the Programmable Buttons.*"
- **Disable:** Disable the P button.

## Accessing the Mobility Center

To access the Mobility Center, open the Quick Menu and tap on the **Mobility Center** tab.



Using the Mobility Center, you can adjust or configure the brightness, volume level, battery status, screen orientation, external display, sync, and presentation settings.

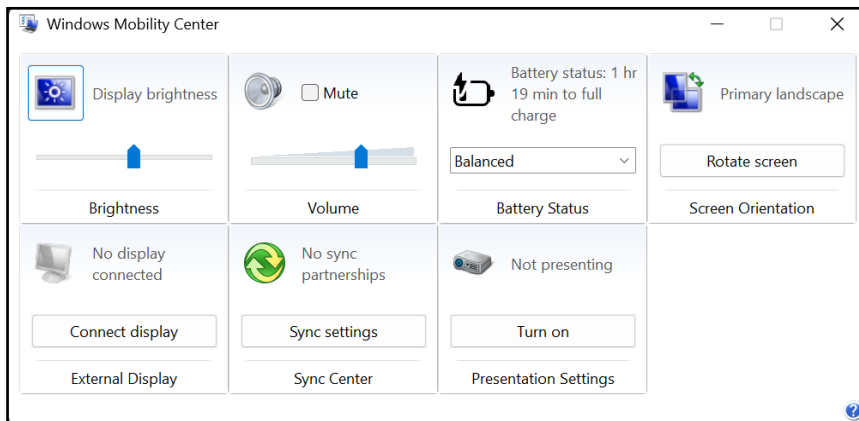

## Enabling Adaptive Brightness

To toggle Adaptive Brightness, open the Quick Menu and tap on the **Adaptive Brightness** tab.



The Adaptive Brightness function adjusts the brightness of your tablet PC's screen according to the light in the surrounding environment. This setting can also be toggled on and off in **Settings** > **System** > **Display** > **Brightness** > **Change brightness automatically when lighting changes**.

## Configuring the Touchscreen Settings

Your tablet PC is equipped with a touchscreen. Using the touchscreen, you can navigate the screen by using touch gestures (any input from your finger, a glove, or a stylus).

### CAUTION!

**To prevent scratches, do not use any sharp object, such as a pen or pencil, on the touchscreen.**



### NOTE

- An optional protective film has been attached to the screen before shipment. You should change the film when it gets worn out.

To configure the touchscreen settings, open the Quick Menu.

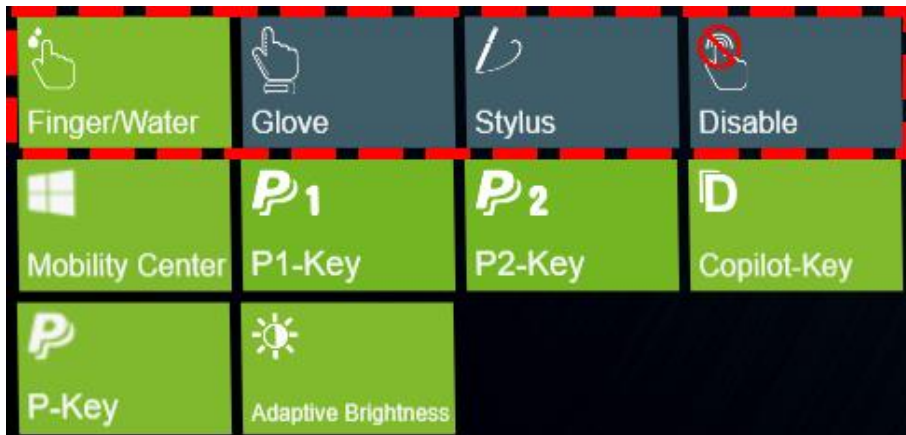

Select one of the available options:

- Select **Finger/Water** if you are using your fingertips.
- Select **Glove** if you are wearing gloves.
- Select **Stylus** if you are using a stylus.
- Select **Disable** if you don't want to use the touch function. When the confirmation message appears, select **Yes** to disable the touch function.



### NOTE

- If the touchscreen mode is set to **Glove** or **Stylus** and the touchscreen is wet (i.e. from a spilled liquid), the touch function will not respond to any input. Make sure to keep the screen dry to ensure proper operation.
- If you assign the **P2** button as **Touch Screen Mode** (refer to page 22), you can easily switch the touchscreen mode by simply pressing the **P2** button.
- If you select "**Disable**", the touch screen function could only be resumed by using mouse, or **P2** button (if it is set to "**Touch Screen Mode**" selection).

## Enabling Cellular/GPS Function (for LTE SKU only)

To enable the cellular/GPS function, open the Quick Menu and tap on the **LTE Antenna** or **GPS Antenna** tab.



- Tap the **LTE Antenna** tab to enable/disable the mobile network function.
- Tap the **GPS Antenna** tab to enable/disable GPS functionality and identify the location using the mobile network.



### NOTE

- If the tab is green, the corresponding function is active.

# Using the Camera

Using the Camera application, you can use this tablet PC to take photos or videos.

## Opening Camera App

To access the Camera application, search for “camera” and tap **Open**.

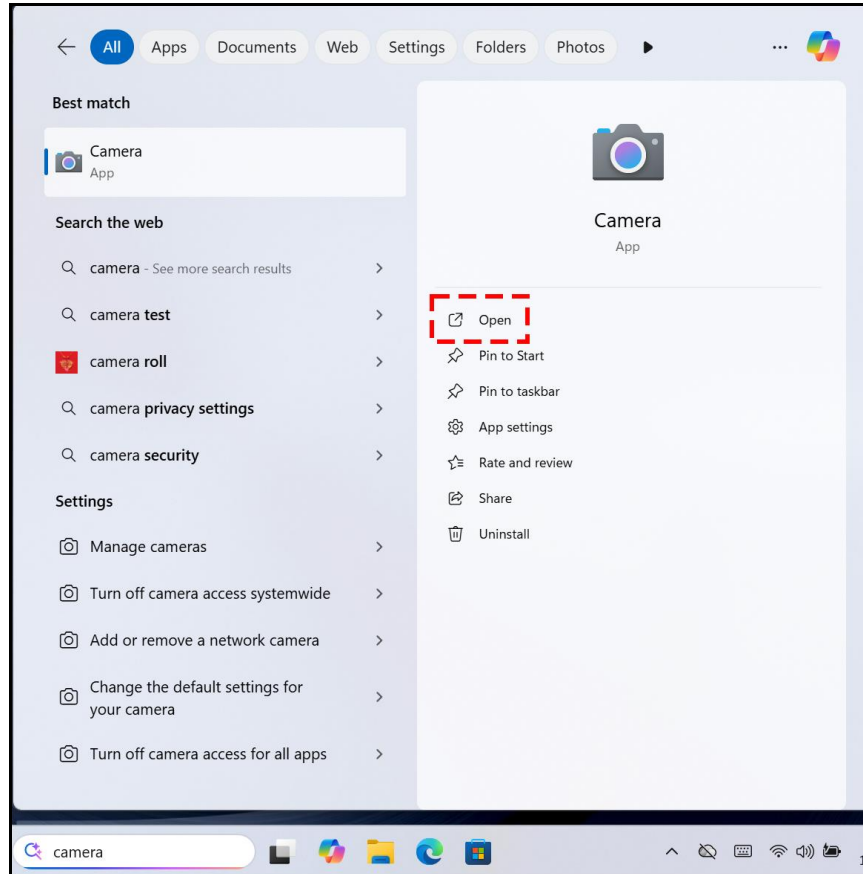

## Taking Photos

Tap  to capture a photo.

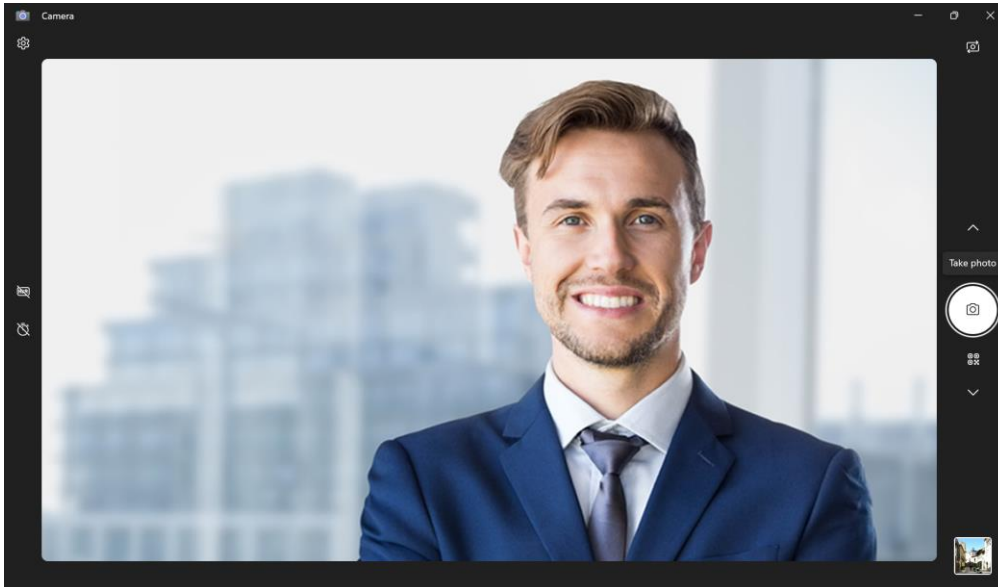

### NOTE



- To switch between the front and rear cameras, tap .

## Recording Videos

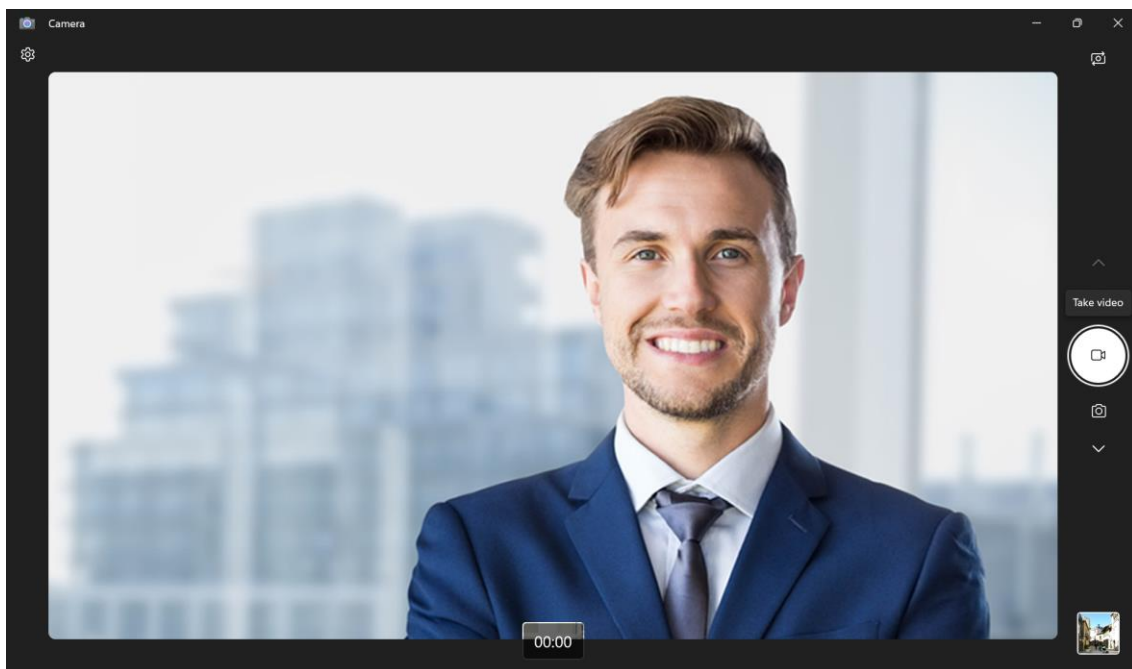
1. Tap  to switch to Video mode.



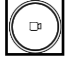

 **NOTE**

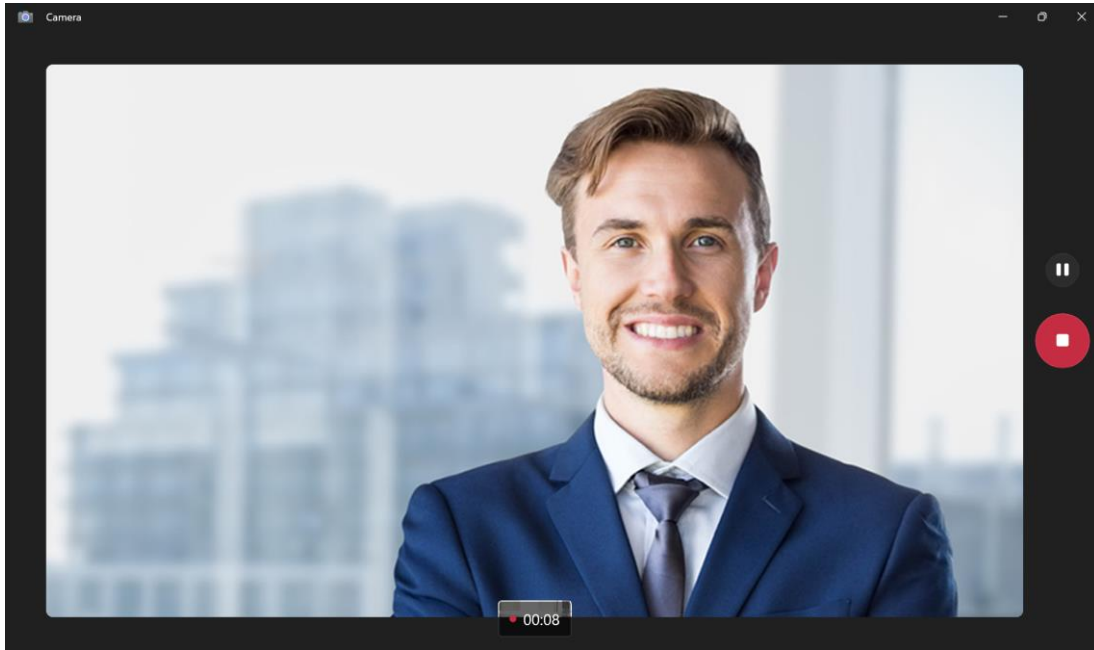

- You can also toggle / to switch between modes.
2. Tap  to start recording a video.  
The recording time appears on the bottom of the screen.



3. During the video recording, you can do the following:



- Tap  to pause the recording. To resume, tap .
- Tap  to stop recording the video.

## Switching Between Modes

Tap on your preferred shooting mode. If the mode is not visible, tap / to see more shooting modes:

- : Record a video.
- : Take a photo.
- : Scan a barcode (if supported).





## Enable HDR Function

Tap  to enable HDR function.

- To disable this function, simply tap .

## Setting Photo Timer

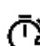
Tap  to toggle the desired time delay.

-  : Self-timer is off
-  : 2-second self-timer
-  : 5-second self-timer
-  : 10-second self-timer

## Configuring Camera Settings

1. Tap  to enter the Settings menu.

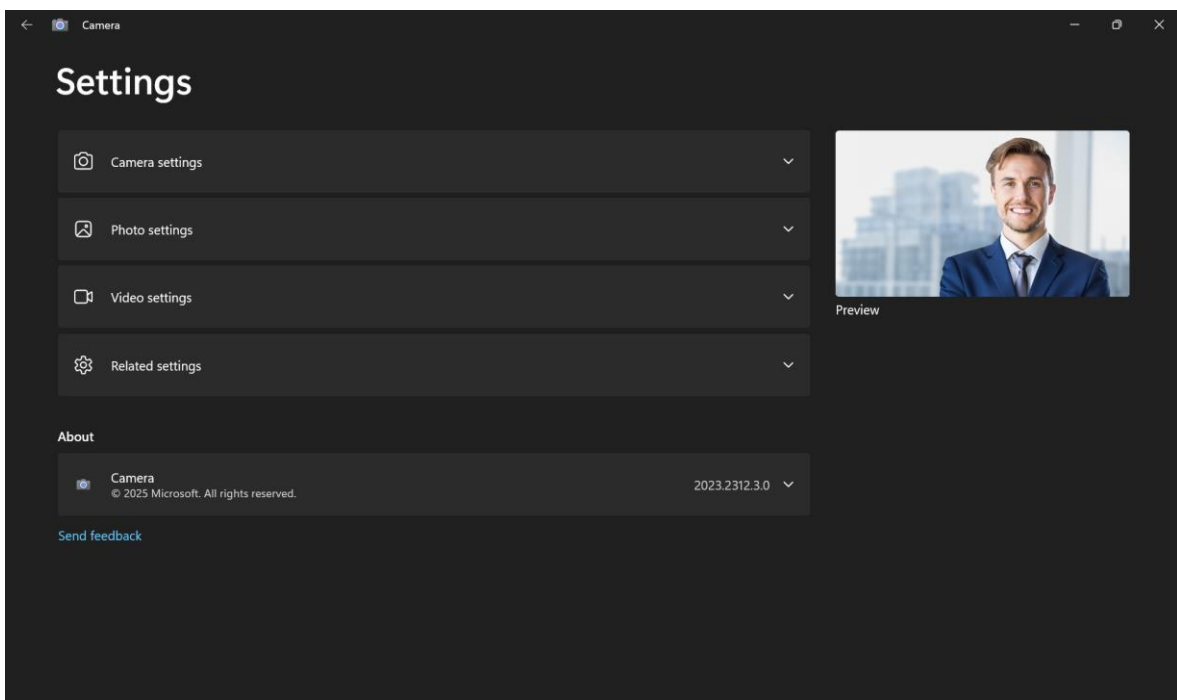

2. Select the desired menu option and setting.

Menu Option	Description
<b>Camera settings</b>	
Show advanced controls for photos and videos	Enable or disable to show advanced controls for photos and videos.
Framing grid	Hide the framing grid lines or select the framing grid type.
Default settings	Select between custom in-app settings and system settings. These settings apply to the Camera app at the start of each session.

Open camera system settings/Open audio system settings	Open Windows <b>Settings</b> for configuring camera or adjusting audio respectively.
<b>Photo settings</b>	
Photo quality	Select the photo resolution and aspect ratio.
Time lapse	Enable or disable taking photos continuously until the camera button is pressed again.
<b>Videos settings</b>	
Video quality	Set the video resolution, aspect ratio, and frame rate.
Flicker reduction	Select the suitable frequency rate (50Hz or 60Hz) to reduce the flicker effect when recording video under fluorescent light.
<b>Related settings</b>	
Choose whether camera can use location info, or change privacy settings. Choose whether to try out experimental features.	
<i>About</i>	
Camera	Check the camera version and read the related regulatory information.
Send feedback	Send feedback about the Camera app.
Help	Access a user guide on how to use the Camera app.

## Viewing Photos/Videos

After taking a photo or recording a video, tap the thumbnail in the bottom-right corner to view the most recent photo or video taken.

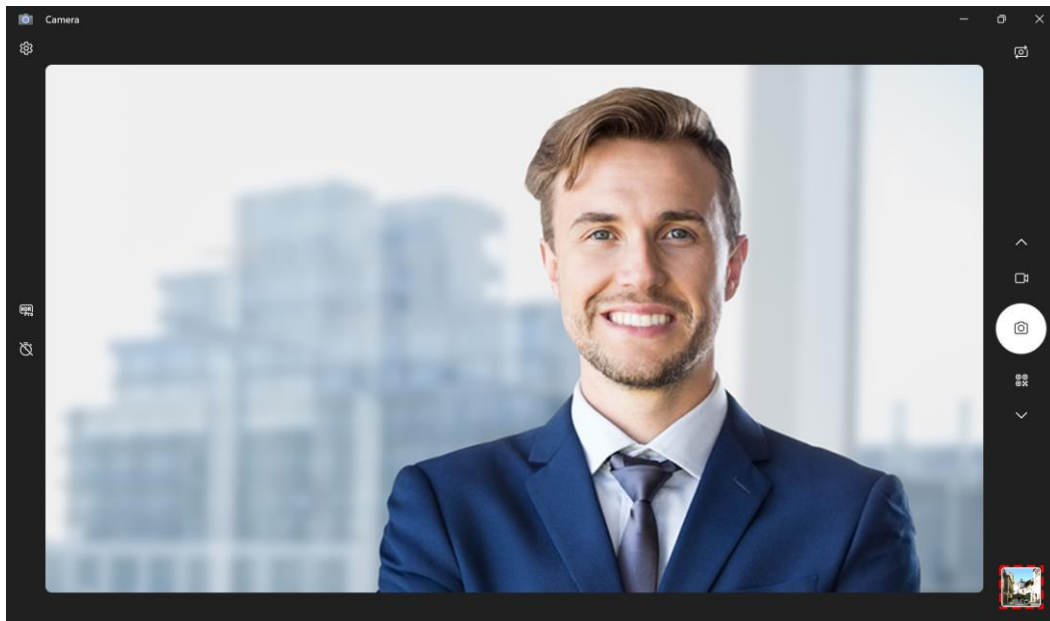

Swipe right to see other photos or videos in your collection.

# Making Connections

This chapter will guide you on installing peripheral devices to maximize the use of your tablet PC.

## Installing the Memory Card

Your tablet PC supports different types of memory cards to provide faster data transfer.

Supported types: MicroSDHC, MicroSDXC

1. Remove the battery pack. Refer to the "*Removing the Battery*" section.
2. Pull open the I/O port cover on the left side of the tablet PC.



3. Push a valid memory card into the memory card slot until it clicks into place.



# Installing the SIM Card

You can use a SIM card for wireless internet access.



## NOTE

- Check the availability of service and data plan rates with your network service provider.
1. Remove the battery pack. Refer to the "Removing the Battery" section.
  2. Pull open the I/O port cover on the left side of the tablet PC.



3. Push a valid SIM card into the SIM card slot until it clicks into place.



# Connecting the Headset/Microphone

Your tablet PC is equipped with an audio combo jack that enables you to use the headset or microphone.

- ❖ To connect a headset, pull open the I/O port cover on the left side of the tablet PC. Plug the stereo headphone cable into the audio combo jack.

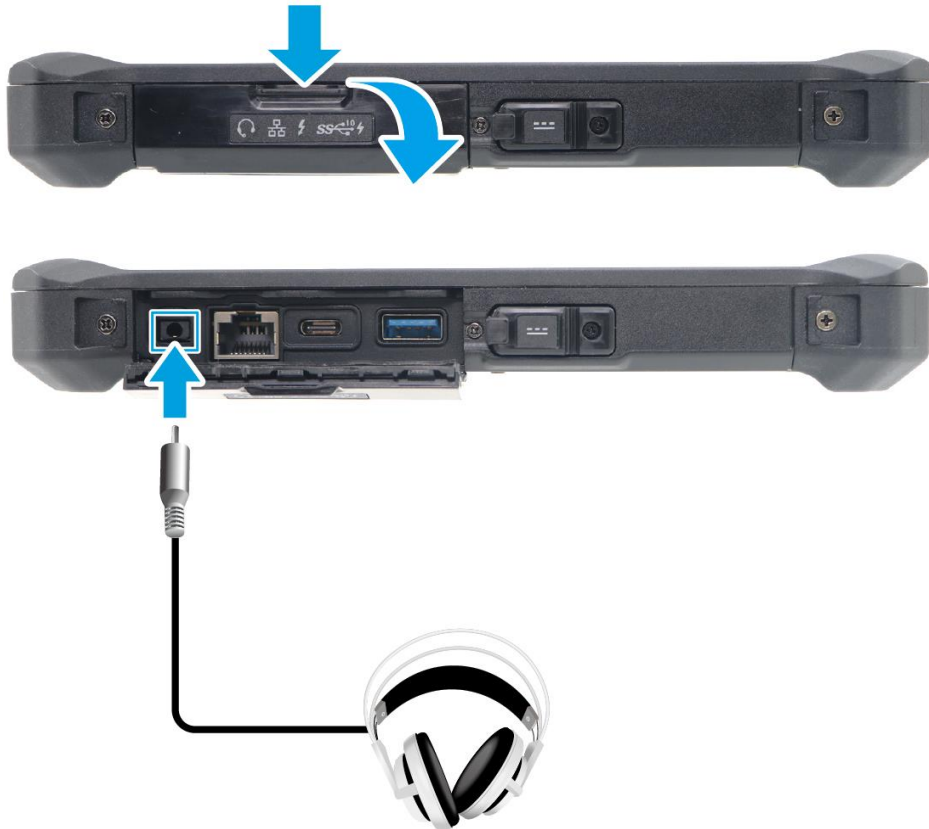

- ❖ To connect to a microphone, pull open the I/O port and plug the microphone cable into the audio combo jack.



## NOTE

- The headset and microphone are not included in the package.

# Attaching the Stylus Holder

Your tablet PC is equipped with a stylus. For an easy access to the stylus, install the stylus holder to the side of the device.

To attach the stylus holder:

1. Remove the 2 screws from the right side of the tablet PC.

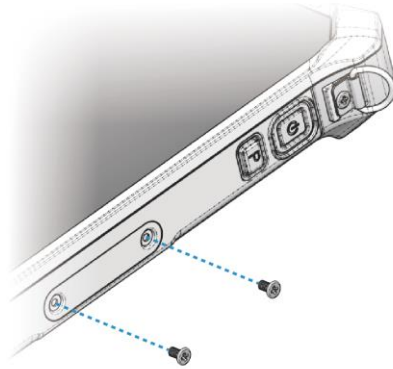

2. Align and secure the stylus holder to the tablet PC with the supplied screws.

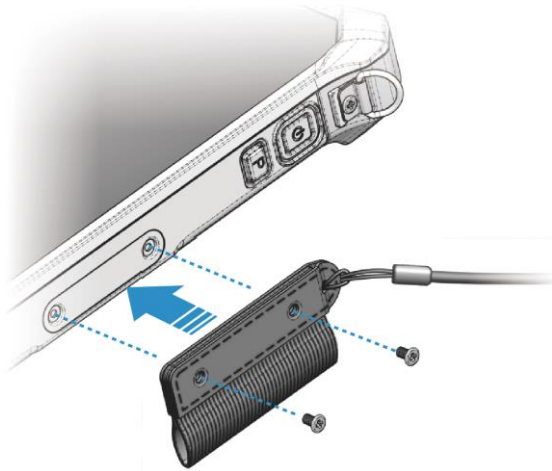

3. Insert the stylus to the stylus holder.

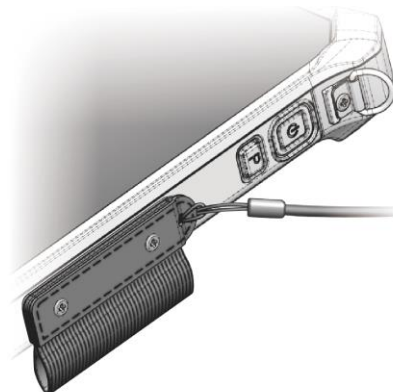

# Connecting USB Devices

You can connect your tablet PC to other USB devices, such as a mouse, keyboard, digital camera, printer, or an external hard disk drive.

1. Pull open the I/O port cover on the left side of the tablet PC.



2. Connect one end of the USB cable to the USB port of your device.

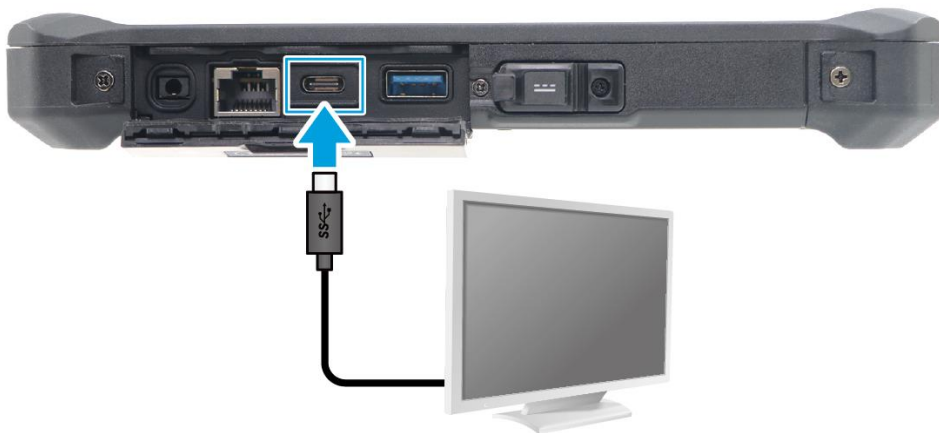

3. Connect the other end of the cable to the USB device (if necessary).



## NOTE

- The USB cable is not included in the package. It is sold separately or it may come with your USB device.

# Connecting to External Displays

You can connect an additional display to your tablet PC by using the USB Type-C cable.

1. Pull open the I/O port cover on the left side of the tablet PC.



2. Connect one end of the USB Type-C cable to the USB Type-C port of your device.

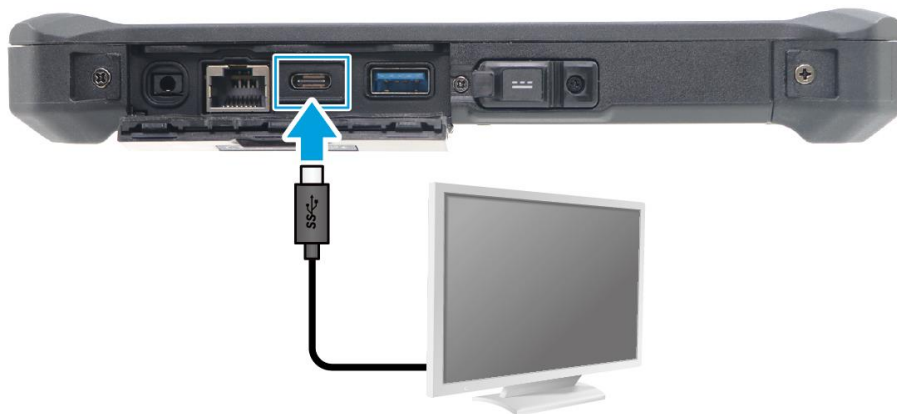

3. Connect the other end of the cable to the external display.



## **NOTE**

- The USB Type-C cable is not included in the package.

# Connecting to Wireless Devices

Your tablet PC can connect to and communicate with other Bluetooth-enabled devices.

## Opening the Quick Settings Menu

To open the Quick Settings menu, tap the status icons (wireless/cellular connection, volume level/mute, and battery) set in the lower-right corner of the screen.

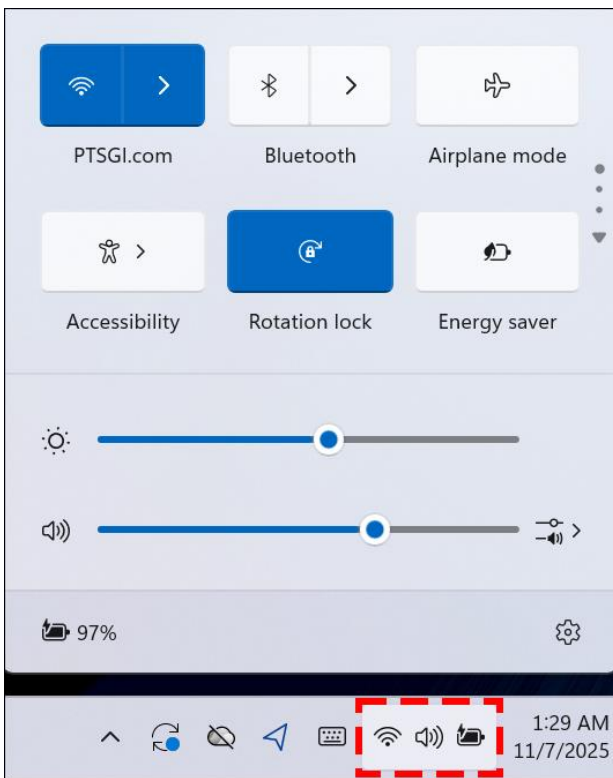

(Wi-Fi SKU)

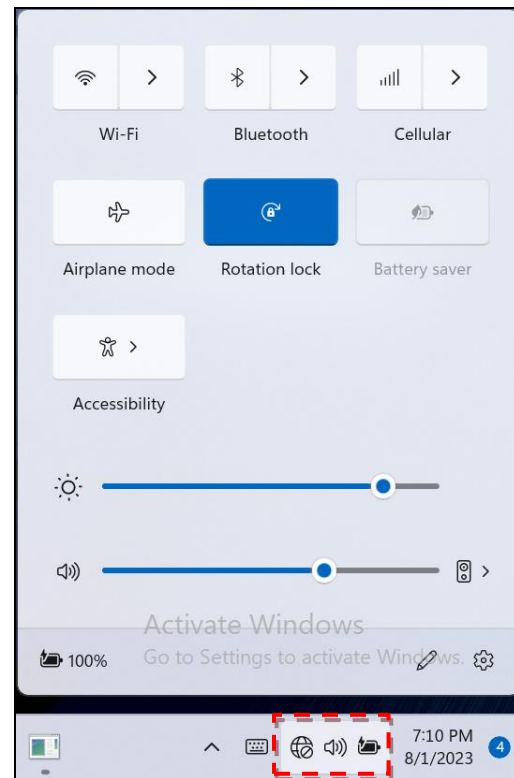

(LTE SKU)

## Connecting to a Bluetooth Device

Your tablet PC can connect and communicate with other Bluetooth-enabled devices.

To add a device, follow the steps below:

1. Open the Quick Settings menu. Then tap on the Bluetooth icon to enable the function.

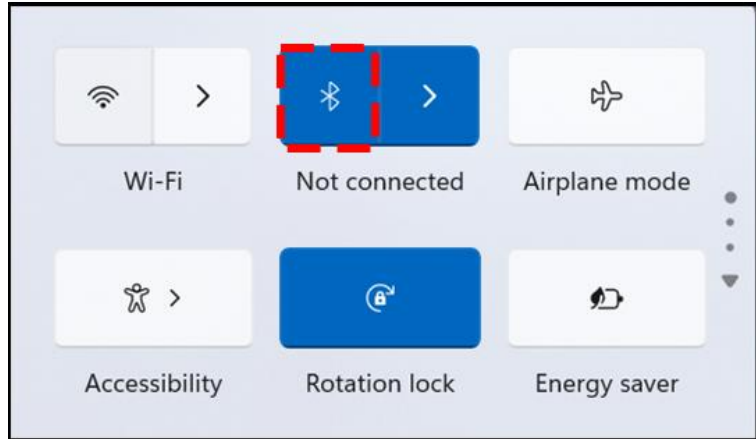

2. Tap the arrow icon (>) next to the Bluetooth icon.
3. Select the device you want to connect. Then, follow the on-screen instructions to pair the devices.



**NOTE**

- The pairing method varies depending on the type of device you are pairing. You may be prompted to enter the pairing code, confirm the pairing code, or the device will pair automatically. For example,

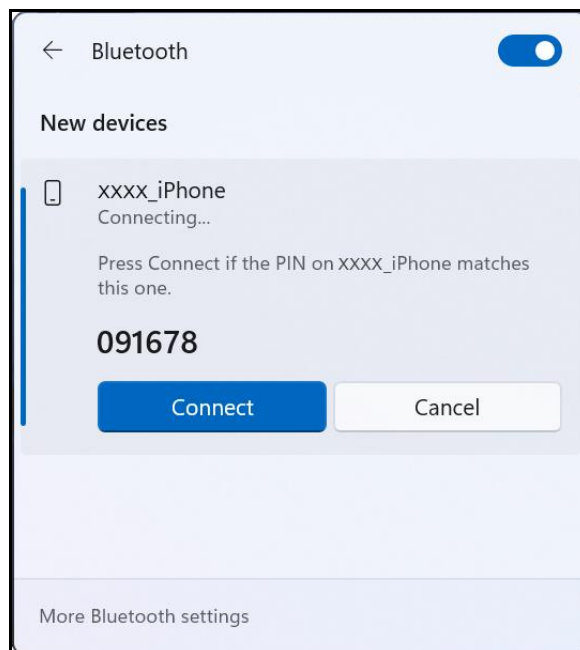

When the pairing process is complete, the connection status will show "Connected".

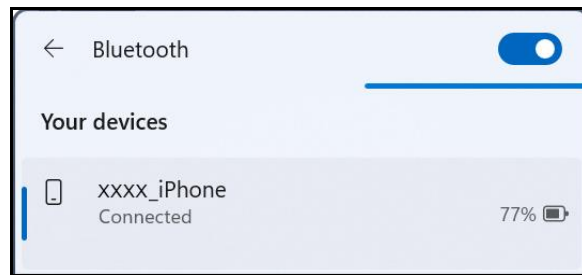

### NOTE

- If the device you want to pair does not appear on the screen, please check that it is turned on and discoverable.
- Most Bluetooth-enabled devices need to be paired with your tablet PC. The PIN you enter on the tablet PC must be the same PIN to be entered on the other Bluetooth device.
- Once the device has been paired with your tablet PC, connecting to the same device again will no longer require you to enter the PIN.
- To disconnect from the Bluetooth-enabled device, select the device in the Bluetooth menu (**Settings > Bluetooth & devices**), tap the three horizontal dots (...), and tap **Remove device**.

## Connecting to a Wireless Local Area Network

Your tablet PC comes with a WLAN module. A wireless network can be added either when the network is detected or by manually entering the settings information.

To connect, follow the steps below:

1. Open the Quick Settings menu (refer to page 43). Then tap **Wi-Fi** to enable the function.

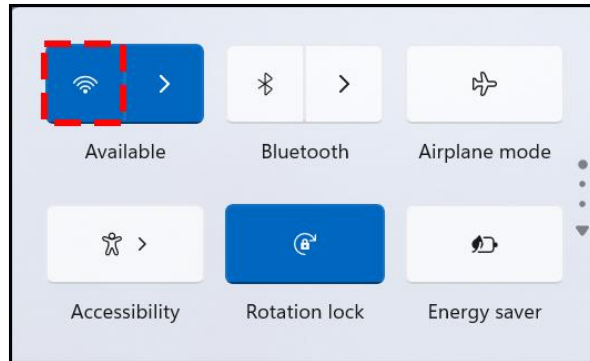

2. Tap the arrow icon (>) next to the Wi-Fi icon.
3. Tap the desired wireless network.

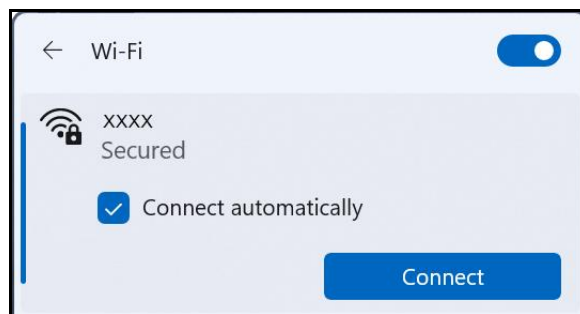

4. Tap **Connect**.  
Some networks require a network security key or a password.



Check the **Connect automatically** box to automatically connect to the desired network when it is available.

5. Enter the network security key.



6. Tap **Next**. After the connection is established, you can see the wireless icon (  ) on the taskbar.



**NOTE**

- Wi-Fi access requires service from a wireless service provider. Contact your service provider for more information.
- Actual wireless connectivity will depend on the system configuration. Please contact your dealer for more information.
- To disconnect from the wireless network, select the network in the wireless network list and tap **Disconnect**.

## Connecting to a Wireless Wide Area Network (WWAN)

The **WWAN** function allows your tablet PC to connect to the Internet using mobile or cellular data networks.

To connect, follow the steps below:

1. Insert a valid SIM card into the SIM card slot.

2. Open the Quick Settings menu. Then tap **Cellular** to enable the function.

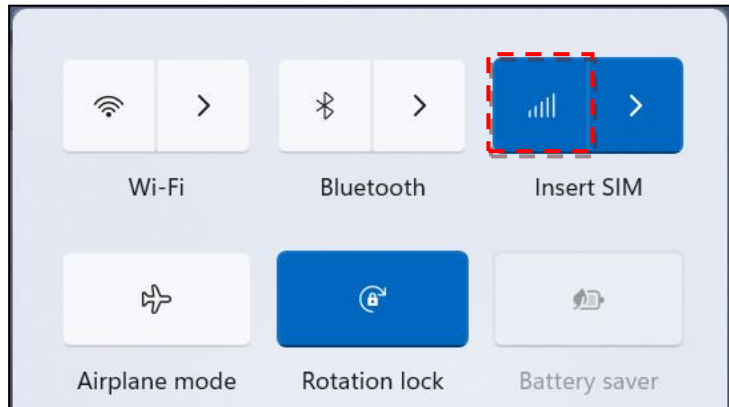

3. Tap the arrow (>) next to the **Cellular** icon.

4. Select the mobile network carrier to establish the connection.



### TIP

Check the **Let Windows keep me connected** box to allow the system to automatically connect to this mobile data network.

# Using the BIOS Setup Utility

Your tablet PC has a BIOS setup utility which allows you to configure important system settings, including settings for various optional functions on the tablet PC. This chapter explains how to use the BIOS setup utility.

## BIOS Setup Menu

The BIOS setup utility allows you to configure your tablet PC's basic settings. When you turn your tablet PC on, the system reads this information to initialize the hardware so that it can operate correctly. Use the BIOS setup utility to change your tablet start-up configuration. For example, you can change the system's security and power management routines.

## Starting the BIOS Setup Utility

You can only enter the BIOS setup utility as the tablet PC is booting, i.e., between the time you turn on the tablet PC and before the Windows interface appears.

If your tablet PC is already on, shut down your tablet PC completely (power off) and restart it and then perform one of the following steps to enter the BIOS homepage:

- When the DURABOOK logo appears, tap **FrontPg** on the upper right corner of the screen.
- Press the **Esc** button on the keyboard.

From the BIOS homepage, select **Setup Utility**.



### NOTE

- If you want to use a keyboard, you will have to connect your device with an external keyboard first before starting the BIOS setup utility.



## Navigating and Entering Information in BIOS

Use the following buttons, found at the bottom of the BIOS screen, to move between fields and enter information:

Keyboard	Description
<b>F1</b>	Help
<b>Esc</b>	Exit
↑ ↓	Select Item
← →	Select Item
<b>F5 / F6</b>	Change Values
<b>Enter / Double-click</b>	Select Sub-menu
<b>F9</b>	Setup Defaults
<b>F10</b>	Save & Exit
<b>F3</b>	Search

Users are allowed to enter new values to replace the default settings in certain fields. The rest of the fields are specified by system default parameters and cannot be modified by users. Reverse the attribute of the main options and press the **Enter** button to enter into the submenu. Press the **Esc** button to return to the previous configuration page without saving BIOS settings. To display the Help screen at any time, simply press the **F1** button.

# BIOS Homepage

From the BIOS homepage, you can choose how you want your tablet PC to boot up and change related settings.



Item	Description
Continue	Select this option to continue to booting process.
Boot Manager	Select this option to enter the Boot Manager.
Device Management	Select this option to enter the Device Manager.
Boot From File	Select this option to boot the system from a file or device.
Administer Secure Boot	Select this option to go to Administer Secure Boot.
Setup Utility	Select this option to go to Setup Utility.

# Main Menu

The Main menu displays the device’s system overview information, including the system date and time.

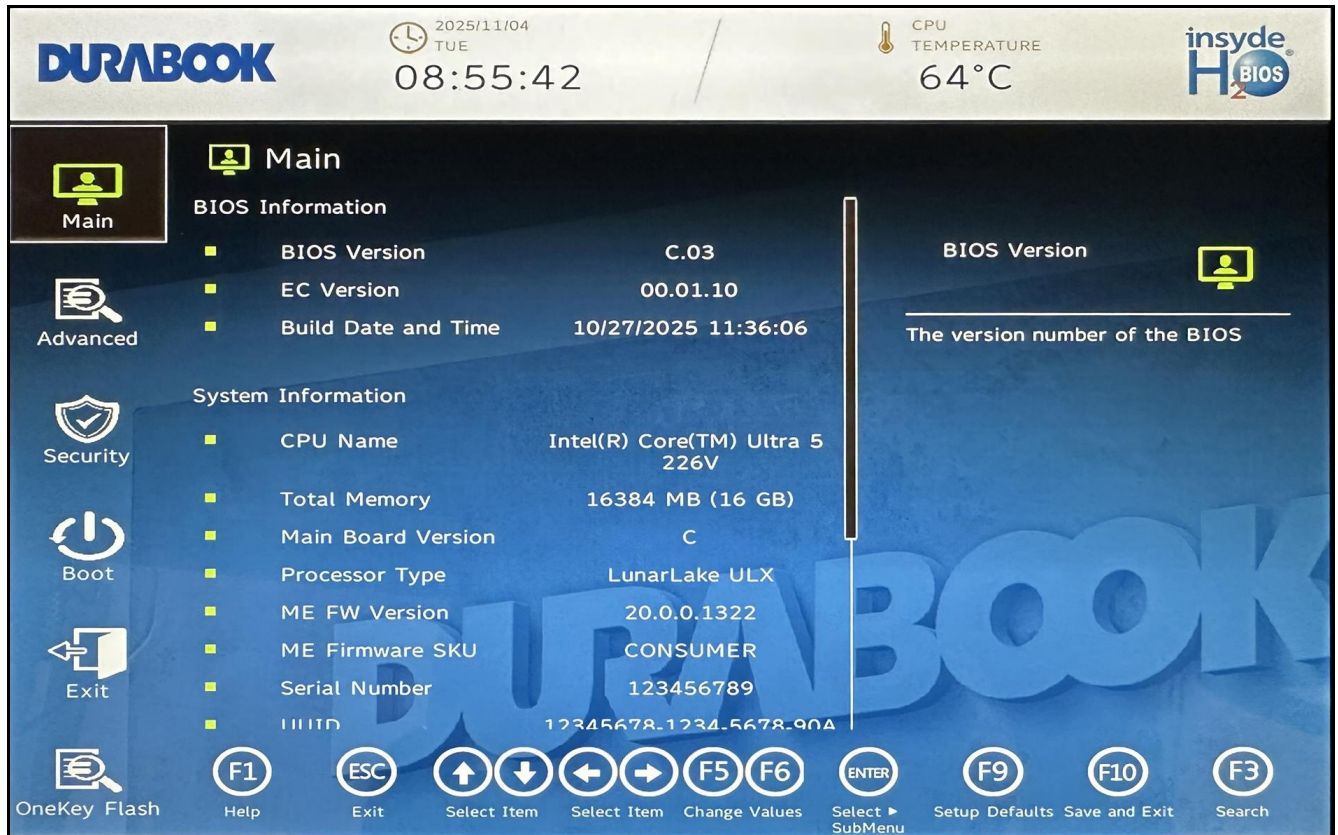

Item	Description
<b>BIOS Information</b>	
BIOS Version	The version number of the BIOS.
EC Version	The version number of the Embedded Controller.
Build Date and Time	Build date and time.
<b>System Information</b>	
CPU Name	String identifying the CPU.
Total Memory	Amount of RAM installed in the system.
Main Board Version	Main board version.
Processor Type	String identifying the CPU.
ME FW Version	ME FW version.
ME Firmware SKU	The SKU number of the tablet.

## Using the BIOS Setup Utility

Serial Number	The unique serial number of the tablet.
UUID	The unique UUID assigned to the system.
PD0 Version	PD0 version.
<b><i>Other</i></b>	
System Date	Set the system date.
System Time	Set the system time.

# Advanced Menu

The Advanced menu allows you to configure specific system settings.

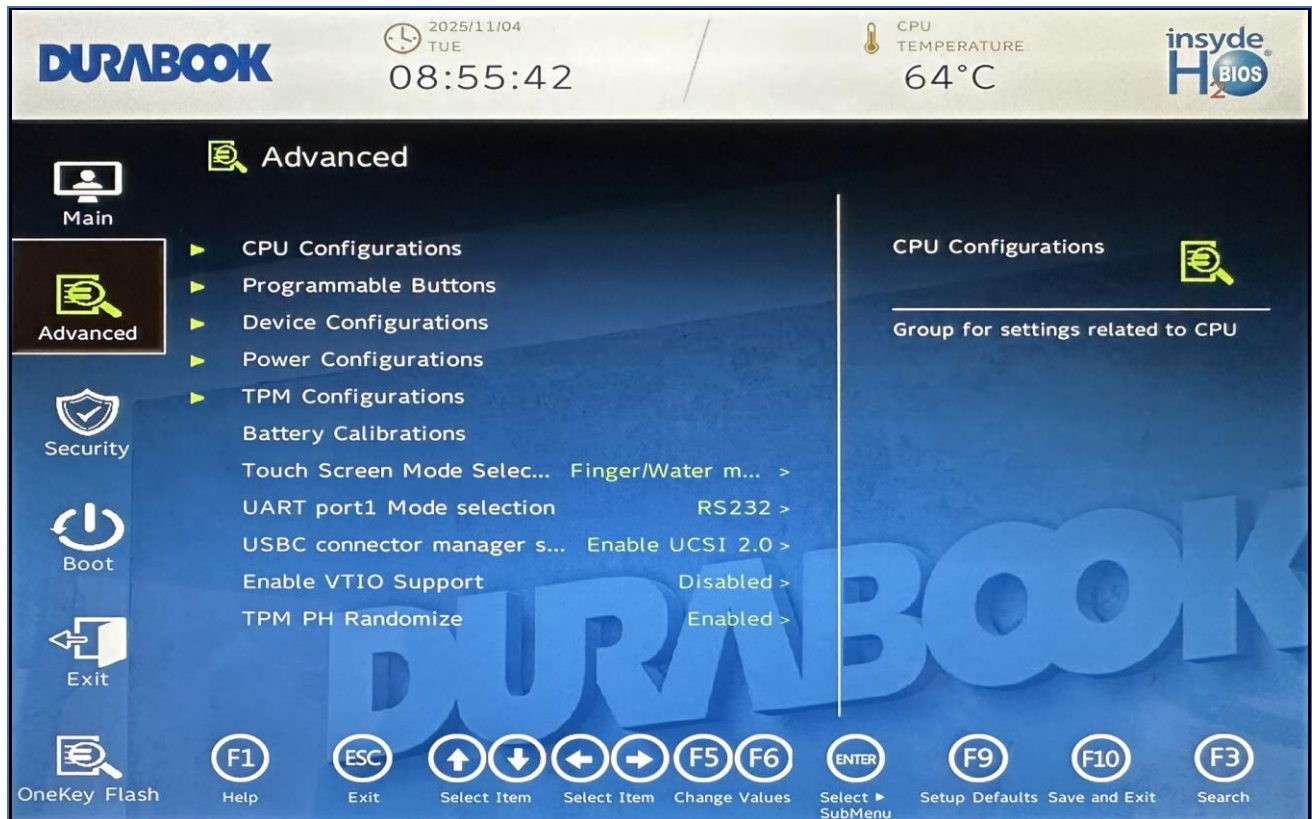

Item	Description
<b>CPU Configurations</b>	
CPU Name	Brand String of the Performance Processor.
CPU Speed	Base Frequency of the Performance Processor.
VMX	VMS Supported or Not.
SMX/TXT	SMX/TXT Supported or Not.
Intel (VMX) Virtualization Technology	When enabled, a VMM can utilize the additional hardware capabilities provided by Vanderpool Technology.
Intel Trusted Execution Technology	Enables utilization of additional hardware capabilities provided by Intel Trusted Execution Technology. Changes require a full power cycle to take effect.
<b>Programmable Buttons</b>	
Volume Up/Down Buttons	Assign a function to the Volume Up and Volume Down buttons. Options:

Item	Description
	<ul style="list-style-type: none"> <li>• Disable</li> <li>• Brightness Up/Down</li> <li>• Volume Up/Down</li> </ul>
P1 Button Settings	Assign a function to the P1 button. Options: <ul style="list-style-type: none"> <li>• Disable</li> <li>• Stealth Mode</li> <li>• Night Vision Mode</li> <li>• Programmable function</li> </ul>
P2 Button Settings	Assign a function to the P2 button. Options: <ul style="list-style-type: none"> <li>• Disable</li> <li>• Touch Screen Mode</li> <li>• SAS Key</li> <li>• Programmable function</li> </ul>
Copilot Function Settings	Assign a function to the Copilot button. Options: <ul style="list-style-type: none"> <li>• Disable</li> <li>• Copilot function</li> <li>• Programmable function</li> </ul>
P Button Settings	Assign a function to the P button. Options: <ul style="list-style-type: none"> <li>• Disable</li> <li>• Barcode</li> <li>• Camera Trigger</li> <li>• Programmable function</li> </ul>
<b>Device Configurations</b>	
USB Type A	Enable/disable the USB type A port on the right side.
Type C	Enable/disable Type C.
LAN Controller	Enable/disable LAN.
SD Card Reader	Enable/disable the SD card reader device.
TPM Availability	When hidden, does not expose TPM to OS. Warning: If Supervisor/User password is verified with TPM, changing this option will automatically disable the password.

## Using the BIOS Setup Utility

Item	Description
HD Audio	Control detection of the HD-audio device. <ul style="list-style-type: none"> <li>• <b>Disabled:</b> HDA will be unconditionally disabled.</li> <li>• <b>Enabled:</b> HDA will be unconditionally enabled.</li> </ul>
Internal Microphone	Enable/disable the internal microphone.
Internal Speaker	Enable/disable the internal speaker.
Touch Screen	Enable/disable the touch screen device.
Front Camera	Enable/disable the front camera device.
Rear Camera	Enable/disable the rear camera device.
WLAN	Enable/disable the WLAN device.
Bluetooth	Enable/disable the Bluetooth controller.
<b>Power Configurations</b>	
Wake On RTC from S4/S5	Enable/disable the function of waking this system from S4/S5.
Resume on AC Power	Enable/disable the function of waking this system from standby or hibernation when the lost AC power returns.
USB always on charging	Enable/disable the function of USB always on charging.
Battery Charging Protection	<ul style="list-style-type: none"> <li>• <b>Regular:</b> The battery will be fully charged.</li> <li>• <b>Optimized Battery Charging (OBC):</b> Battery charging will stop at 80% to reduce battery aging.</li> <li>• <b>Temperature Control Management (TCM):</b> To extend the lifetime of the battery, charging is enhanced based on DURABOOK intelligent algorithm and battery temperature.</li> <li>• <b>DURA<sup>2</sup> Charging (D2C):</b> To maximize battery performance and lifespan, charging is enhanced based on DURABOOK intelligent algorithm and battery temperature. Battery charging will stop at 80%.</li> </ul>
<b>TPM Configurations</b>	
Refer to the "Security Menu" section.	
Battery Calibrations	Perform the battery calibration.
Touch Screen Mode select	Select the touchscreen mode.

<b>Item</b>	<b>Description</b>
UART Port1 Mode Selection	Set the UART port mode between RS232, RS422, or RS485. Available options vary depending on SKU.
USBC connector manager selection	Disable or set the setting to UCSI or UCMC device in ACPI support based on configuration.
Enable VTIO Support	Enable/disable VTIO support.
TPM PH Randomize	TPM PH Randomize.

# Security Menu

The Security menu allows you to set or change the Administrator and User passwords.



Item	Description
<b>Current TPM Device</b>	
TrEE Protocol Version	TrEE Protocol Version: 1.0 or 1.1
TPM Availability	When hidden, don't expose TPM to OS. If Supervisor/User password is verified with TPM, changing this option will automatically disable the password.
TPM Operation	Select one of the supported operations to change TPM2 state.
Clear TPM	Removes all TPM context associated with a specific Owner.
Supervisor Password	Install or change the password.

# Boot Menu

The Boot menu allows you to configure the boot settings and boot sequence.



Item	Description
Numlock	Selects Power-on state for Numlock.
Network Stack	Network Stack Support: Windows 8 BitLocker Unlock UEFI IP4/IPv6 PXE/HTTP Legacy PXE OPROM.
PXE Boot Capability	Set the display mode for Option ROM.

# Exit Menu

The Exit menu allows you to save/discard the changes and restore the default values for all setup options before leaving the BIOS Setup Menu.



Item	Description
Exit Saving Changes	Exit system setup and save your changes.
Save Change Without Exit	Save your changes without exiting system setup.
Exit Discarding Changes	Exit system setup and discard your changes.
Load Optimal Defaults	Load optimal default settings.
Save Custom Defaults	Save custom default settings.
Discard Changes	Discard your changes without exiting system setup.

# OneKey Flash Menu

The OneKey Flash menu allows you to configure Flash settings.



Item	Description
<b>[Easy Flash Mode]</b>	
Execute OneKey Flash	Immediately execute the OneKey Flash process.
Easy Flash HotKey	Enable/disable used HotKey to execute OneKey Flash while BIOS post phase.
Select File	Select a file from which to execute OneKey Flash.
<b>[Advance Flash Mode]</b>	
Execute OneKey Flash	Immediately execute the OneKey Flash process.
Select File and Immediate Execute	Enable/disable used OneKey Flash process immediately after selecting a file.
Advance Flash HotKey	Enable/disable used Advance Flash HotKey to execute OneKey Flash while BIOS POST phase.

# Maintaining and Caring for Your Tablet PC

Taking care of your tablet PC will reduce the risk of damage to your device and ensure that it operates properly.

To help you maintain the quality and function of your tablet PC, this chapter provides guidelines on how to protect, store, clean, and travel with your device.

## Protecting Your Tablet PC

To safeguard the integrity of the data stored on your tablet PC as well as the device, follow these precautions:

- Install an anti-virus program to monitor potential viruses that could damage your files.
- Use a Kensington cable lock to protect your tablet PC against theft. Cable locks are available for purchase from online retailers and in most stores that sell computers.
- To use the lock, loop the lock cable around a stationary object such as a table. Then, insert the lock into the Kensington lock hole and turn the key to secure the lock. Store the key in a safe place.

## Storing and Handling Your Tablet PC

### General Storage and Handling Guidelines

- Use your tablet PC at the recommended temperature—between 0°C (32°F) and 55°C (131°F)—to ensure optimal performance (Actual operating temperature depends on product specifications.)
- Avoid placing your tablet PC in a location subject to high humidity, extreme temperatures, mechanical vibrations, direct sunlight, or heavy dust. Using your device in extreme environments for long periods of time can result in product deterioration and a shortened product life.
- Do not place heavy objects on top of the tablet PC, as this may damage the display.
- Do not operate in an environment with metallic dust.

- Store and use your tablet PC on a flat and steady surface. Do not stand the tablet PC on its side or store it in an upside-down position. The impact from dropping or an object hitting the device may cause damage.
- Do not cover or block any ventilation openings on the Tablet PC. For example, do not place the Tablet PC on a bed, sofa, rug, or other similar surface. Overheating may occur, which could result in damage to your tablet PC.
- Keep your tablet PC away from that are vulnerable to damage from heat, as the device can become very hot during operation.
- Keep your tablet PC at least 13 cm (5 inches) away from electrical appliances that can generate a strong magnetic field such as a TV, refrigerator, motor, or a large audio speaker.
- Avoid moving your tablet PC abruptly from a cold to a warm place. A temperature difference of more than 10°C (18°F) may cause condensation inside the unit, which may damage storage media.

## Display and Touchscreen Guidelines

- Use your finger or the included stylus on the touchscreen surface. Using a sharp or metallic object, such as a pen or pencil, may scratch and damage the display, thereby causing errors.
- Use a soft cloth to remove dirt on the display. The touchscreen surface has a special protective coating that prevents dirt from sticking to it. Not using a soft cloth may cause damage to the special protective coating on the touchscreen surface.
- Turn off the Tablet PC power when cleaning the display. Cleaning the display with the power on may cause improper operation.
- Do not use excessive force on the display. Avoid placing objects on top of the display as this may cause the glass to break, thereby damaging the device.
- Expect a slower response time when using the touchscreen at lower temperatures (less than 5°C (41°F)). A normal response time may be restored upon returning to room temperature.
- Refer to Windows online support for instructions on recalibrating the touchscreen display when there is noticeable problem with the touchscreen function (e.g., improper display resolution or unresponsive touchscreen).
- LCD image sticking occurs when a fixed pattern is displayed on the screen for a prolonged period of time. You can avoid the problem by limiting the amount of static content on the display. It is recommended that you either use a screen saver or turn off the display when it is not in use.
- To maximize the life of the backlight display, allow the backlight to automatically turn off as a result of power management.

### Battery Pack Guidelines

- Do not expose the battery to temperatures below 0°C (32°F) or above 45°C (113°F). This may adversely affect the battery pack.
- While the battery may not provide 100% capacity at temperature extremes, its capacity is restored when the battery temperature returns to a normal range, around 20°C (68°F).
- Your battery will last longer during the day if it is used, charged and stored between 50°F and 86°F (10°C and 30°C).
- Charge the battery nightly where the temperature will remain around 68°F (20°C). Your battery may not last as long through the day if you charge it at higher or lower temperatures.
- Allow unrestricted airflow while the device is connected to external power. Make sure that the fan inlet and outlet are unobstructed.
- Avoid exposure to extreme temperatures for long periods as this can shorten battery charge life or damage the battery.
- If your battery is charged in a cold (less than 5°C (41°F)) or very warm (greater than 45°C (113°F)) environment, it is possible that the Battery LED will indicate that the charge has stopped. However, this does not necessarily mean that your battery is fully charged.
- Read and follow all battery precautions in the Safety section.
- Use only batteries of the same kind as replacements.
- Turn the power off before removing or replacing batteries.
- To avoid malfunction of the tablet PC and losing any unsaved data, do not install or remove the battery pack while the device is in sleep mode.
- Avoid touching the contacts of the battery while installing or removing the battery. Hold the battery by the sides instead to prevent the malfunction of the system.
- Do not tamper with the batteries.
- Keep batteries away from children.
- Before storing your battery, read and follow the recommendations in the Battery Tips section.
- Dispose of used batteries according to local regulations.
- Recycle if at all possible.

## Battery Charging Recommendations

The battery is a consumable item that will eventually wear out and need replacement.



### NOTE

- If the battery pack has deteriorated, replace it with a new one.

The lifespan of the battery depends upon its usage. To prolong battery life, follow the recommendations below:

- Keep the number of charges and discharges to a minimum. It is best to charge the device no more than once a day and only when the charge drops to 10% or lower.
- Monitor the temperature inside the battery to prevent it from becoming too high. Charge your device indoors in an open area where the temperature is between 50°F and 86°F (10°C and 30°C).

To further enhance battery charging and prolong battery life, we advise charging the battery nightly, where the temperature will remain around 68°F (20°C).

Charging the battery while the system is fully running will take longer. We recommend charging the battery when the system is in hibernation or sleep mode to increase the charging speed.

## Cleaning Your Tablet PC

### Cleaning the Outside Case

- Disconnect external power and turn off the device.
- Remove the battery.
- Add a small amount of water to a soft cloth and clean the device case. Do not use paper products because they can scratch the surface.
- Wipe off any excess liquid with a soft cloth.
- Reinstall the battery.

**CAUTION:** Aerosols, solvents, or strong detergents are not recommended cleaning solutions and may void your warranty. For system decontamination recommendations, contact your support representative.

### Cleaning the Display

Use a soft, dry cloth. In some cases, you can use a small amount of water to remove streaks or smears. For difficult display cleaning tasks, use a 70/30 mixture of isopropyl alcohol and water. Do not use paper products because they can scratch the screen.

### **Cleaning the External Power Connector**

The external power connector may sometimes be exposed to moisture and/or contamination, causing an unreliable connection to the external power source. Clean the connector with a cotton swab dipped in electronics-grade isopropyl alcohol.

### **Cleaning the RJ45 / USB Connectors**

If the connector pins get dirty, clean the connector with a cotton swab dipped in electronics-grade isopropyl alcohol.

## **Traveling With Your Tablet PC**

Before traveling with your tablet PC, follow these precautions:

- Back up the data on your hard drive to a flash drive or other storage device. As an added precaution, bring an extra copy of your important data.
- Make sure that the battery pack is fully charged.
- Ensure that your tablet PC is turned off.
- Confirm that all the connector covers are closed completely to ensure the device's waterproof integrity.
- Disconnect the AC adapter from your tablet PC and take it with you. Use the AC adapter to power the device and charge the battery.
- Hand-carry your tablets PC onto an airplane, train, or bus. Do not check it in as luggage.
- If you need to leave your tablet PC in a car, store it in the trunk to avoid exposing it to excessive heat.
- When going through airport security, do not carry your tablet PC through the magnetic detector (the device you walk through) or expose it to a magnetic wand (the handheld device used by security personnel). It is recommended that you send the tablet PC and any flash drives through the X-ray machine (the device where you set your bags).
- If you plan to travel abroad with your tablet PC, consult your dealer for the appropriate AC power cord for use in your country of destination.

# Troubleshooting

This chapter advises you on what actions to take when solving common computer problems that may be caused by issues with hardware or software.

## Preliminary Checklist

Here are the initial steps you should follow before taking further actions when encountering any problem:

1. Try to identify and isolate which part of the tablet PC is causing the problem.
2. Make sure that you turn on all peripheral devices before turning on the tablet PC.
3. If you are having trouble with an external device, make sure that the cable connections are correct and secure.
4. Make sure that the configuration information is properly set in the BIOS Setup program.
5. Ensure that all the device drivers are correctly installed.
6. Make note of your observations. Are there any messages on the screen? Do any indicators light up? Do you hear any beeps? Detailed descriptions are useful to the service personnel when you need to consult someone for assistance.
7. If any problems persist after you follow the instructions in this chapter, contact an authorized dealer for help.

## Solving Common Problems

### Battery Problems

#### The battery does not charge

- To prevent possible damage to the battery, the device does not allow the battery to charge if the internal temperature of the battery gets too low (< 5°C (41°F)) or too high (> 50°C (122°F)). If possible, charge the battery in a location with a moderate temperature of around 20°C (68°F).
- If possible, turn off the device while the battery is charging.
- If the battery is new or has been stored for a week or more, follow this procedure:
  1. Make sure the device is turned off.
  2. Remove the battery.
  3. Connect the AC adapter to the device and an AC wall outlet, and then turn on the device by pressing the **Power** button.
  4. Let the device complete the boot process. Then reinstall the battery.

## Troubleshooting

---

- Allow the system to remain idle for one hour with the AC adapter connected to the device.
- The Battery Power LED lights when the battery starts charging.
- If the battery still fails to start charging after an hour, remove the battery, wait several seconds, and then install it again.
- If the battery does not begin charging within several minutes, return the unit for service.

### **The batteries take much longer than seven hours to charge.**

- Under moderate temperatures, about 20°C (68°F), the device's battery takes approximately 4 to 5 hours to completely charge.
- As the battery temperature approaches the ends of its temperature range (5°C (41°F) to 50°C (122°F)), it may take longer to charge the battery.

### **The batteries don't last very long.**

- Calibrate the battery. If your battery is new or has not been used for several weeks, calibrating the battery accurately sets the gas gauge.
- As your battery ages, its maximum capacity naturally decreases and even the best maintained batteries eventually need to be retired. Consider replacing the battery if you are not getting the usage you need from it.
- To meet ENERGY STAR® requirements, Wake on LAN is enabled by default. If running on battery power, this may decrease battery run-time. To change Wake on LAN settings, go to **Device Manager > Network adapters**. Select the LAN device. Open the device **Properties** and select **Power Management**. Disable the Wake on LAN setting by unchecking **Allow this device to wake the computer**.

### **The gas gauge isn't full after charging the battery.**

- This may indicate that the charging process terminated prematurely.

### **The gas gauge reads "full," but the charging LED is still lit.**

- If you charge your battery daily, rely on the gas gauge reading to determine battery capacity. The charging process may continue even if the gas gauge reads full. External power can be removed because the battery is virtually full.

### **My battery seems to have less and less capacity.**

- If your battery is new, or if you are using it for the first time, you will need to calibrate it prior to using it. You can do so by going to **BIOS > Setup Utility > Advanced > Battery Calibrations** (refer to pages 54 to 57).
- As your battery ages, the maximum capacity that it can hold naturally decreases and even the best maintained batteries eventually need to be

retired. Consider replacing the battery if you are not getting the usage you need from it.

## BT Wireless Transmission Problems

### **I cannot connect to another device with BT wireless technology.**

- Ensure that you have activated BT feature on both devices.
- Make sure that the distance between the two devices is within the acceptable limit and that there are no walls or other obstructions between them.
- Confirm that the other device is not in "Hidden" mode.
- Verify that devices are compatible.

## Display Problems



### **The display performance is slow.**

- The temperature may be too cold. Move the device to a warmer operating environment.

### **The underlined, inverse, and hypertext characters are difficult to read on the screen.**

- Long press (or right-click if you are using a mouse) on the desktop and select **Personalize** to change the color and style of the Windows interface.

### **I changed my display resolution, but I don't see any differences on the screen.**

- Select  >  > **Restart**.

### **Nothing happens when I try to use the stylus on my touch screen.**

- If you cannot select objects accurately with the stylus, you may need to calibrate the touch screen.

### **The touch screen doesn't respond after a suspend.**

- The touch screen needs a few seconds to work after a suspend. Wait a moment and try again.

# Hard Disk Problems

## The hard disk will not spin up so the device can't boot up.

- This occurs if the unit is exposed to extreme low temperatures. This is not a hardware failure associated with the hard disk. The integrated hard disk drive heater will warm the drive to a safe operating temperature.

## The device does not startup properly.

- Make sure you remove any USB drives from the unit before you start it.
- Connect the AC adapter to charge the battery if it is not charged.
- If the battery does not begin charging, perform the following:
  1. Remove the battery.
  2. Connect the AC adapter.
  3. Turn on the device by pressing the  button.
  4. Reinstall the battery. The Battery LED is a steady blue while the battery is charging.

## Hard disk recovery process in Windows 11

1. Select **Start**  > **Settings**  > **System** > **Recovery**.

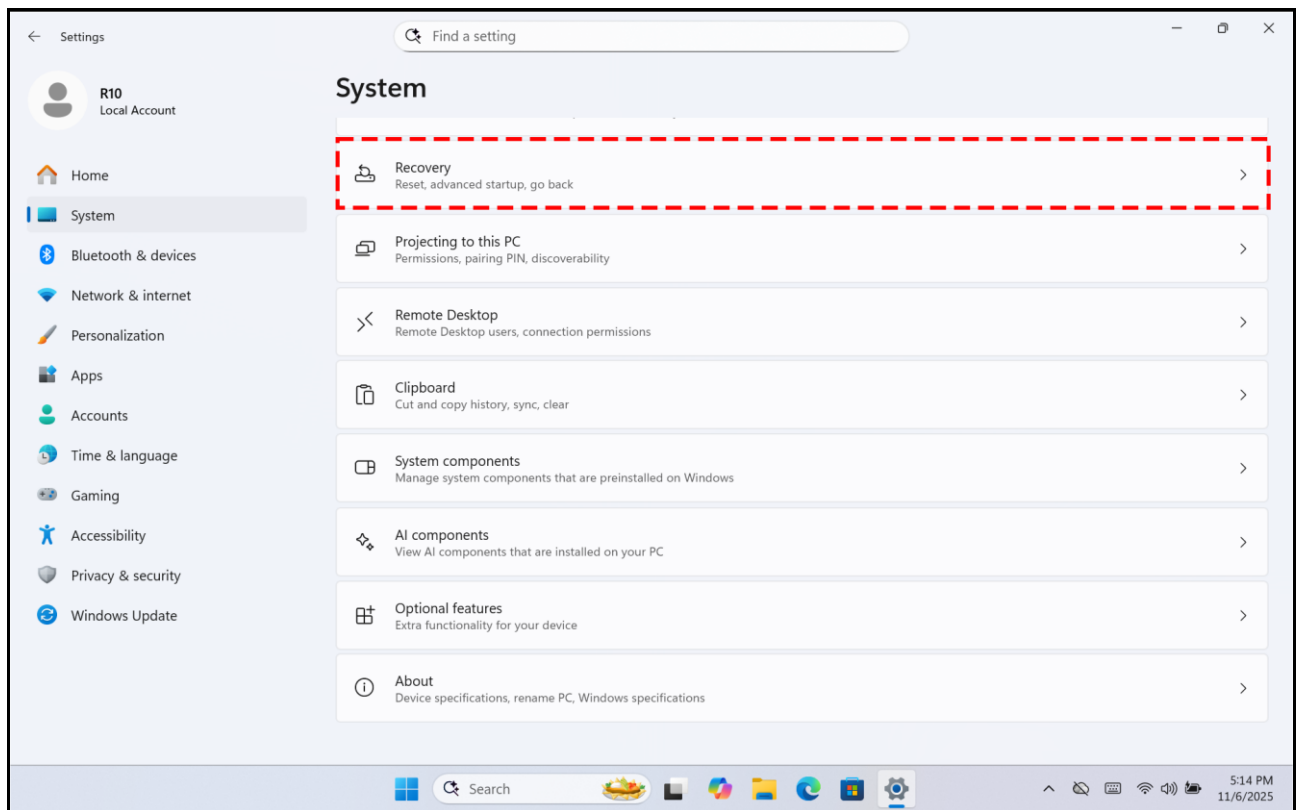

2. Select any of the recovery methods that suits the best to solve the problem with your device.

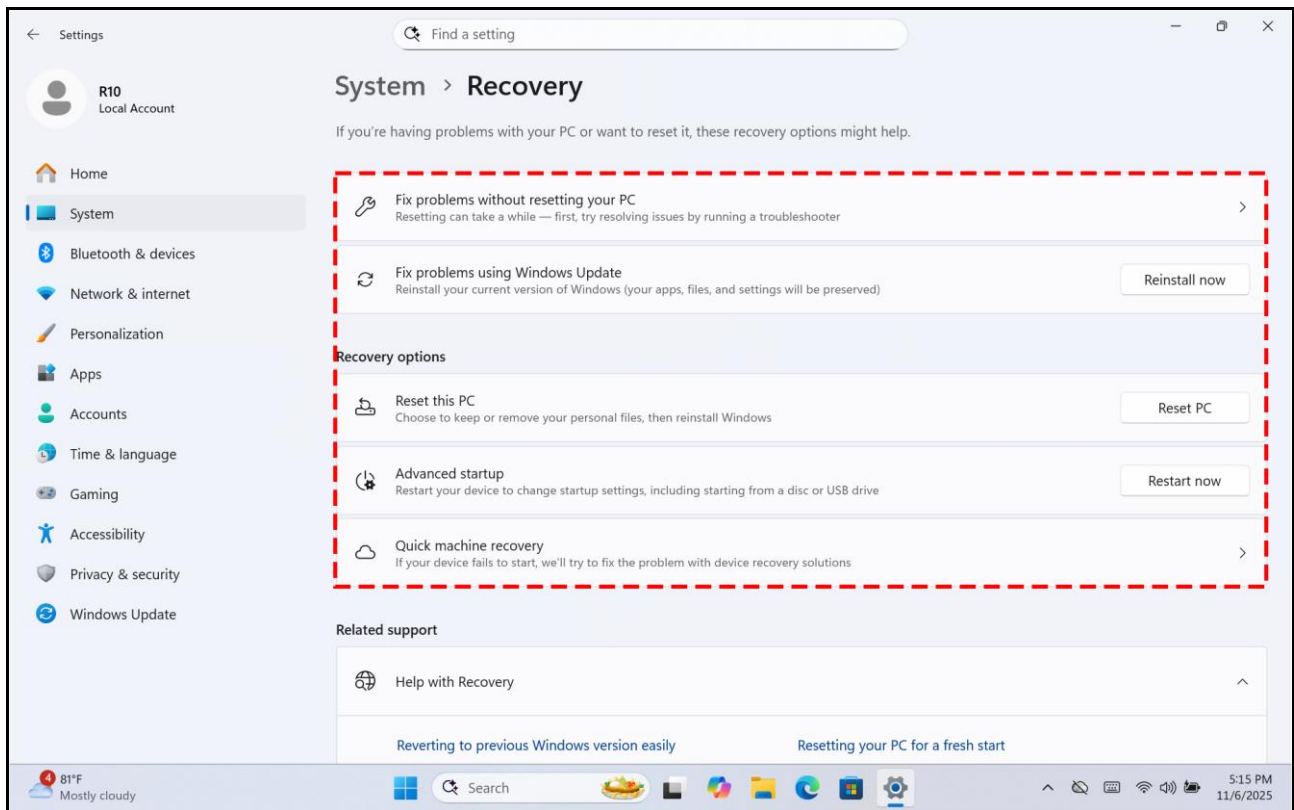

- **Fix problems without resetting your PC:** Select this option to run a troubleshooter. Make sure your device is connected to the network.

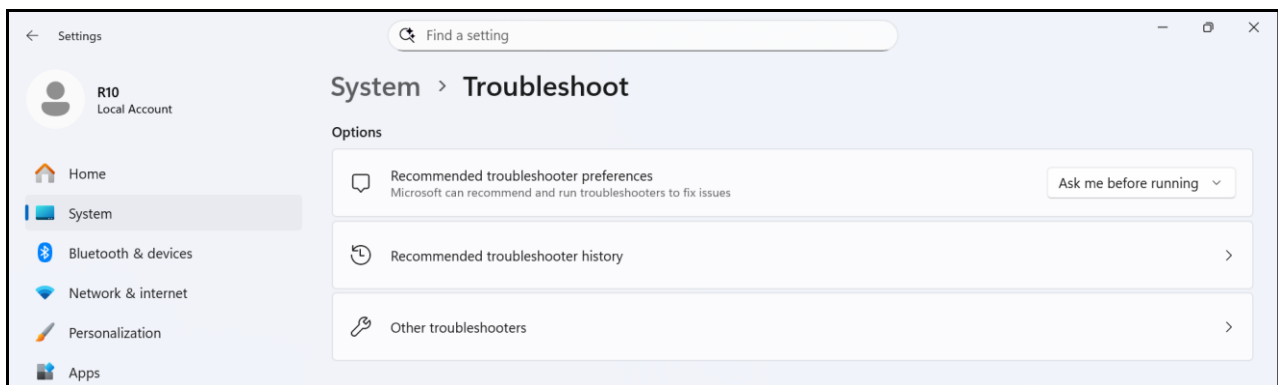

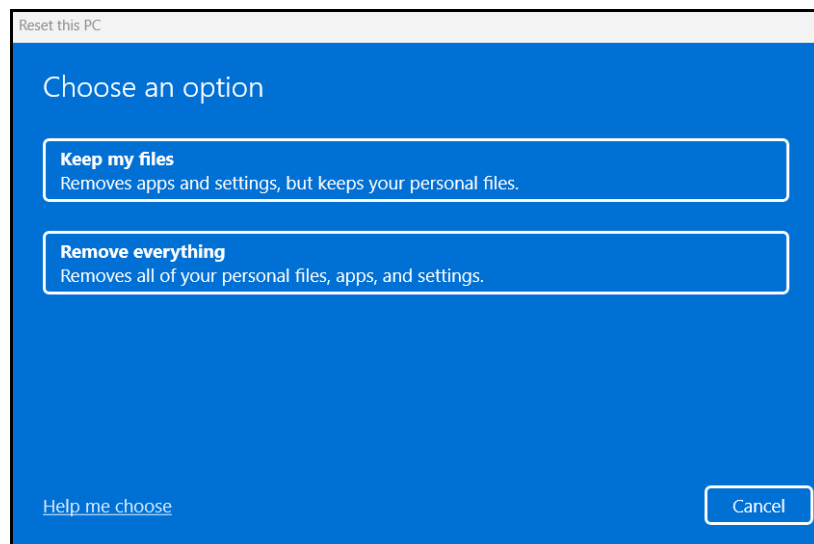

- **Reset this PC:** Select this option to reinstall the Windows 11 operating system. To reset your tablet PC, tap **Reset PC**. You are then prompted to keep or remove your personal files. Select either of the options and follow the on-screen instructions to complete the resetting procedure.





- **Advanced startup:** Select this option to restart your tablet PC with advanced startup features, such as automated startup repair, uninstall recently installed updates, use a restore point to restore your tablet PC, change settings in your tablet PC's UEFI firmware, recover Windows from the system image file, and more. Follow the on-screen instructions to repair the system.

## Other Problems

### The device won't turn on.

- Make sure a fully charged battery is properly installed.
- Connect external power to charge the battery if it is not charged.
- If you are using the AC adapter, check the electrical outlet you are using to make sure it is working properly.
- If the device does not turn on, reset the device by holding down the  button for at least ten seconds, release it, and then press the  button again.

### The device won't turn off.

1. Select  >  > **Shut down**.
2. If that does not work, press **Ctrl + Alt + Del** and then select **Task Manager**.
3. If any programs are open, use the arrow keys to highlight each one and select **End task**. Repeat until all programs are closed.
4. If that still does not work, press and hold the  button for approximately ten seconds and then release it.

**The device doesn't make any sounds, even during boot-up.**

- You may have enabled Stealth Mode. Disable Stealth Mode.

# Appendix

## Copyright

Copyright© 2026. All rights reserved.

No part of this user manual may be transmitted, stored in a retrieval system, or translated into any language or computer language, in any form or by any means, without the prior written permission of the manufacturer. Information is subject to change without prior notice.

## Specifications

Durability	<ul style="list-style-type: none"> <li>• MIL-STD-810H certified (Drop, Shock, Vibration, Rain, Dust, Altitude, Freeze/Thaw, High/Low Temperature, Temperature Shock, Humidity, Explosive Atmosphere, Salt Fog)</li> <li>• MIL-STD-461G certified (Conduction, Radiation, Conducted Susceptibility, Radiated Susceptibility)</li> <li>• Optional ANSI/UL 121201, Class I, Division 2</li> <li>• 6' drop 26 faces</li> <li>• IP 66 certified</li> <li>• Magnesium alloy chassis</li> <li>• Port covers</li> <li>• Sunlight readable display</li> <li>• Optional swappable battery technology</li> </ul>
Operating System	Windows® 11 Pro 64-bit
Processors	<ul style="list-style-type: none"> <li>• Intel® Core™ Ultra 7 268V vPro (32GB RAM, 12MB Cache, up to 5.0 GHz, 8 cores, 8 threads, with Intel® AI Boost NPU up to 48 TOPS)</li> <li>• Intel® Core™ Ultra 7 266V vPro (16GB RAM, 12MB Cache, up to 5.0 GHz, 8 cores, 8 threads, with Intel® AI Boost NPU up to 48 TOPS)</li> <li>• Intel® Core™ Ultra 7 258V (32GB RAM, 12MB Cache, up to 4.8 GHz, 8 cores, 8 threads, with Intel® AI Boost NPU up to 48 TOPS)</li> <li>• Intel® Core™ Ultra 7 256V (16GB RAM, 12MB Cache, up to 4.8 GHz, 8 cores, 8 threads, with Intel® AI Boost NPU up to 48 TOPS)</li> <li>• Intel® Core™ Ultra 5 238V vPro (32GB RAM, 8MB Cache, up to 4.7 GHz, 8 cores, 8 threads, with Intel® AI Boost NPU up to 40 TOPS)</li> <li>• Intel® Core™ Ultra 5 236V vPro (16GB RAM, 8MB</li> </ul>

	<p>Cache, up to 4.7 GHz, 8 cores, 8 threads, with Intel® AI Boost NPU up to 40 TOPS)</p> <ul style="list-style-type: none"> <li>• Intel® Core™ Ultra 5 228V (32GB RAM, 8MB Cache, up to 4.5 GHz, 8 cores, 8 threads, with Intel® AI Boost NPU up to 40 TOPS)</li> <li>• Intel® Core™ Ultra 5 226V (16GB RAM, 8MB Cache, up to 4.5 GHz, 8 cores, 8 threads, with Intel® AI Boost NPU up to 40 TOPS)</li> </ul>
Graphics	<p>Intel® Arc™ 140V GPU (for Intel® Core™ Ultra 7 GPU) Intel® Arc™ 130V GPU (for Intel® Core™ Ultra 5 GPU)</p>
Memory	16GB up to 32GB on Package (LPDDR5x)
Storage	<p>256GB NVMe PCIe SSD</p> <ul style="list-style-type: none"> <li>• Optional 512GB/1TB/2TB NVMe PCIe SSD</li> <li>• Optional OPAL 2.0 SSD</li> </ul>
Display	<p>10.1" TFT LCD WUXGA (1920 x 1200)</p> <ul style="list-style-type: none"> <li>• 1000 nits DynaVue® sunlight readable display with capacitive multi-touch screen</li> <li>• Optional with digitizer</li> <li>• User selectable touch mode for Finger/Water, Glove, or Stylus programmable function</li> <li>• Support Microsoft Pen Protocol (MPP) 1.51 active pen function</li> </ul>
Audio	<ul style="list-style-type: none"> <li>• Integrated microphone x 2</li> <li>• Intel® High Definition Audio Compliant</li> <li>• Integrated speaker x 1</li> <li>• Keyboard volume and mute controls</li> </ul>
Camera	<ul style="list-style-type: none"> <li>• Integrated 5.0 MP IR camera for Windows Hello with dynamic shutter design</li> <li>• Integrated 11.0 MP rear auto-focus camera with flash and dynamic shutter design</li> </ul>
Keyboard & Input	7 buttons (4 user-definable keys)
Communications	<ul style="list-style-type: none"> <li>• Integrated 10/100/1000 Ethernet</li> <li>• Intel® Wi-Fi 7 BE201 (802.11 be)</li> <li>• Bluetooth® V5.4</li> <li>• Optional dedicated GPS module (UBLOX-NEO-M9N)<sup>1</sup></li> <li>• Optional 4G LTE multi-carrier mobile broadband with integrated GPS<sup>1</sup></li> <li>• Optional 5G with integrated GPS<sup>1</sup></li> <li>• Optional RF antenna pass-through for GPS, WWAN, and WLAN</li> </ul>

## Appendix

Security	<ul style="list-style-type: none"> <li>• Intel® vPro® Technology (per CPU options)</li> <li>• Secured-core PC</li> <li>• TPM 2.0</li> <li>• NIST BIOS compliant</li> <li>• IR Camera (Support Windows Hello)</li> <li>• Stealth mode</li> <li>• Kensington lock</li> <li>• Night vision mode</li> <li>• Optional fingerprint scanner<sup>2</sup></li> <li>• Optional smart card reader<sup>4</sup></li> <li>• Optional LF/HF-RFID (NFC) reader<sup>4</sup></li> <li>• Optional UHF-RFID (NFC) reader<sup>2, 4</sup></li> </ul>
I/O Interfaces	<ul style="list-style-type: none"> <li>• Thunderbolt 4 (type C) x 1</li> <li>• USB 3.2 Gen2 (type A) x 1</li> <li>• Audio in/out (combo jack) x 1</li> <li>• microSD card (microSDXC) x 1</li> <li>• 10/100/1000 Ethernet (RJ45) x 1</li> <li>• Docking connector (20-pin Pogo) x 1</li> <li>• Dual SIM (Nano SIM &amp; eSIM) x 1</li> <li>• Audio in/out (combo jack) x 1</li> <li>• DC-in jack x 1</li> <li>• Optional USB 3.2 Gen2 (type C) x 1<sup>5</sup></li> <li>• Optional 2nd USB 3.2 Gen1 (type A) x 1<sup>5</sup></li> <li>• Optional USB 2.0 (type A) x 1<sup>5</sup></li> <li>• Optional serial port (RS232, 422 and 485: D-sub, 9-pin) x 1<sup>3</sup></li> <li>• Optional 1D/2D barcode reader x 1<sup>3</sup></li> <li>• Optional 2nd 10/100/1000 Ethernet (RJ45) x 1<sup>3</sup></li> <li>• Optional smart card reader x 1<sup>4</sup></li> <li>• Optional RF antenna pass-through for GPS, WWAN and WLAN</li> </ul>
Expansion Slot	<ul style="list-style-type: none"> <li>• Optional magnetic stripe reader</li> <li>• Optional smart card reader<sup>4</sup></li> <li>• Optional smart card reader with LF/HF-RFID (NFC)<sup>4</sup></li> <li>• Optional LF/HF-RFID (NFC) reader<sup>4</sup></li> <li>• Optional UHF-RFID (NFC) reader<sup>2, 4</sup></li> </ul>
Power	<p>AC adapter: 100-240V, 50Hz-60Hz, 65W</p> <p>Main battery: Li-Ion, 11.4V, 4400mAh, 8.5 hours<sup>5</sup></p> <ul style="list-style-type: none"> <li>• Optional hi-cap battery Li-Ion 11.4V, 8700mAh, 17 hours<sup>5</sup></li> <li>• Optional bridge battery: 1 minute swap time<sup>6</sup></li> </ul>
Environment	<ul style="list-style-type: none"> <li>• Temperature</li> </ul> <p>Operating: -29°C ~ 63°C/-20°F ~ 145°F</p> <p>Storage: -51°C ~ 71°C/-60°F ~ 160°F</p>

	<ul style="list-style-type: none"> <li>• Humidity: 5% ~ 95%</li> </ul>
Dimension & Weight	<ul style="list-style-type: none"> <li>• 265 mm (L) x 189.5 mm (W) x 21.2 mm (H)</li> <li>• 1.2 kg</li> </ul>
Warranty	3-year limited warranty standard

**NOTE**

- Specifications are subject to change without any prior notice.
- <sup>1</sup> Dedicated GPS, 4G LTE and 5G are mutually exclusive options.
  - <sup>2</sup> Fingerprint scanner and UHF-RFID (NFC) are mutually exclusive options.
  - <sup>3</sup> Mutually exclusive options.
  - <sup>4</sup> Mutually exclusive options.
  - <sup>5</sup> Tested using the MobileMark 2014 battery life benchmark. Results may vary under different situations including hardware configuration, software, operating conditions, power management settings and other factors.
  - <sup>6</sup> The system will stay operating within 60 seconds when user swaps the battery.

# Regulatory Statement

## Federal Communications Commission Statement

This equipment has been tested and found to comply with the limits for a Class B digital device, pursuant to part 15 of the FCC Rules. These limits are designed to provide reasonable protection against harmful interference in a residential installation. This equipment generates, uses, and can radiate radio frequency energy and, if not installed and used in accordance with the instructions, may cause harmful interference to radio communications. However, there is no guarantee that interference will not occur in a particular installation. If this equipment does cause harmful interference to radio or television reception, which can be determined by turning the equipment off and on, the user is encouraged to try to correct the interference by one or more of the following measures:

- Reorient or relocate the receiving antenna.
- Increase the separation between the equipment and receiver.
- Connect the equipment into an outlet on a circuit different from that to which the receiver is connected.
- Consult the dealer or an experienced radio/TV technician for help.

## IC Regulations

This device complies with Industry Canada's licence-exempt RSSs. Operation is subject to the following two conditions: (1) This device may not cause interference; and (2) This device must accept any interference, including interference that may cause undesired operation of the device.

Le présent appareil est conforme aux CNR d'Industrie Canada applicables aux appareils radio exempts de licence. L'exploitation est autorisée aux deux conditions suivantes: (1) l'appareil ne doit pas produire de brouillage, et (2) l'utilisateur de l'appareil doit accepter tout brouillage radioélectrique subi, même si le brouillage est susceptible d'en compromettre le fonctionnement.

**This Class B digital apparatus complies with Canadian ICES-003.**

**Cet appareil numérique de la classe B est conforme à la norme NMB-003 du Canada.**

# Declaration of Conformity

This device complies with part 15 of the FCC rules. Operation is subject to the following conditions:

- This device may not cause harmful interference.
- This device must accept any interference received, including interference that may cause undesired operation.

## RF Exposure Warning

This equipment must be installed and operated in accordance with provided instructions and must not be co-located or operating in conjunction with any other antenna or transmitter. End-users and installers must be provided with antenna installation instructions and transmitter operating conditions for satisfying RF exposure compliance.

The SAR limit set by the FCC is 1.6W/kg.

This device is operation in 5.15 – 5.25GHz frequency range, then restricted in indoor use only, Outdoor operations in the 5150~5250MHz is prohibit.

This device is slave equipment, the device is not radar detection and not ad-hoc operation in the DFS band.

Note: Do not disassemble the bumper. Otherwise, the antenna may be damaged, resulting in poor reception.

## FCC RF Radiation Exposure Statement:

### Portable Device

- This device and its antenna must not be co-located or operating in conjunction with any other antenna or transmitter.
- This device complies with FCC radiation exposure limits set forth for an uncontrolled environment.
- This equipment complies with FCC RF radiation exposure limits set forth for an uncontrolled environment for body-worn configuration in direct contact to the phantom.

### RF Exposure Information (SAR)

- This device meets the government's requirements for exposure to radio waves. This device is designed and manufactured not to exceed the emission limits for exposure to radio frequency (RF) energy set by the Federal Communications Commission of the U.S. Government.
- The exposure standard for wireless devices employing a unit of measurement is known as the Specific Absorption Rate, or SAR. The SAR limit set by the FCC is 1.6W/kg.
- The FCC has granted an Equipment Authorization for this device with all reported SAR levels evaluated as in compliance with the FCC RF exposure guidelines.
- SAR information on this device is on file with the FCC and can be found under the Display Grant section of [www.fcc.gov/oet/ea/fccid](http://www.fcc.gov/oet/ea/fccid) after searching on FCC ID: FKGR1001 (WLAN), FKGW01R10 (WWAN)

**Operation of transmitters in the 5.925-7.125 GHz band is prohibited for control of or communications with unmanned aircraft systems.**

## Battery Disposal

THIS PRODUCT CONTAINS A LITHIUM-ION OR NICKEL-METAL HYDRIDE BATTERY. IT MUST BE DISPOSED OF PROPERLY. CONTACT LOCAL ENVIRONMENTAL AGENCIES FOR INFORMATION ON RECYCLING AND DISPOSAL PLANS IN YOUR AREA.

## USB PD Fast Charging

The power delivered by the charger must be between min 15 Watts required by the radio equipment, and max 65 Watts in order to achieve the maximum charging speed.

## WARNING EXPLOSION HAZARD

**Class I, Division 2, Groups A, B, C, D, T Code T5**

**Class I, Zone 2, Groups IIC, T5**

**WARNING - EXPLOSION HAZARD - SUBSTITUTION OF COMPONENTS MAY IMPAIR SUITABILITY FOR CLASS I, DIVISION 2.**

**AVERTISSEMENT - RISQUE D'EXPLOSION – LA SUBSTITUTION DE COMPOSANTS PEUT RENDRE CE MATERIEL INACCEPTABLE POUR LES EMBLEMES DE CLASSE I, DIVISION 2.**

**WARNING: TO PREVENT IGNITION OF A HAZARDOUS ATMOSPHERE, BATTERIES MUST ONLY BE CHARGED IN AN AREA KNOWN TO BE NON HAZARDOUS.**

**AVERTISSEMENT- RISQUE D'EXPLOSION - AFIN D'EVITER TOUT RISQUE D'EXPLOSION, S'ASSURER QUE L'EMPLACEMENT EST DESIGNÉ NON DANGEREUX AVANT DE CHANGER LA BATTERIE.**

**WARNING - EXPLOSION HAZARD - DO NOT CONNECT OR DISCONNECT WHILE CIRCUIT IS LIVE UNLESS AREA IS KNOWN TO BE NON-HAZARDOUS.**

**AVERTISSEMENT - RISQUE D'EXPLOSION. NE PAS BRANCHER OU DÉBRANCHER TANT QUE LE CIRCUIT EST SOUS TENSION, À MOINS QU'IL NE S'AGISSE D'UN EMBLEMES NON DANGEREUX.**

Battery: Homray Technology Inc., P/N: R10-M, R10-H

#### **ANNEX IV**

##### **Symbol for the marking of electrical and electronic equipment**

The symbol indicating separate collection for electrical and electronic equipment consists of the crossed-out wheeled bin, as shown below. The symbol must be printed visibly, legibly and indelibly.



##### **CAUTION FOR ADAPTER**

THE TABLET PC IS FOR USE WITH DEDICATED AC ADAPTER.

##### **AVERTISSEMENT CONCERNANT L'ADAPTATEUR**

LA TABLETTE DOIT ÊTRE UTILISÉE AVEC UN ADAPTATEUR SECTEUR CA DÉDIÉ.

##### **BATTERY SAFETY**

DANGER OF EXPLOSION IF BATTERY IS INCORRECTLY REPLACED.

## Appendix

---

REPLACE ONLY WITH THE SAME OR EQUIVALENT TYPE RECOMMENDED BY THE MANUFACTURER. DISPOSE OF USED BATTERIES ACCORDING TO THE MANUFACTURER'S INSTRUCTIONS.

### SÉCURITÉ DES PILES

DANGER D'EXPLOSION SI LA PILE EST MAL REMPLACÉE.

REPLACEZ LA PILE UNIQUEMENT PAR UNE AUTRE DU MÊME TYPE, OU D'UN TYPE ÉQUIVALENT CONSEILLÉ PAR LE FABRICANT. REJETEZ LES PILES USÉES CONFORMÉMENT AUX INSTRUCTIONS DU FABRICANT.

### CAUTION FOR RJ45

The RJ45 jack is not used for telephone line connection.

### AVERTISSEMENT POUR RJ45

N'utilisez pas la prise RJ45 pour une connexion à la ligne téléphonique.

# Cybersecurity Information

## 1. Security Update Period

The Tablet PC has a software and hardware support period of 5 years. Detailed information can be obtained from

<https://www.durabook.com/en/support/security-advisory/>

## 2. Report on Security Issue

To report any vulnerability found with the Tablet PC, user can submit the report through our vulnerability reporting page at

<https://www.durabook.com/en/support/security-advisory/>

# Battery Statement

## ⚠ WARNING

- **INGESTION HAZARD** : This product contains a button cell or coin battery.
- **DEATH** or serious injury can occur if ingested.
- A swallowed button cell or coin battery can cause **Internal Chemical Burns** in as little as **2 hours**.
- **KEEP** new and used batteries **OUT OF REACH of CHILDREN**.
- **Seek immediate medical attention** if a battery is suspected to be swallowed or inserted inside any part of the body.
- non-replaceable batteries (type: CR2032, DC 3V)



1. Remove and immediately recycle or dispose of used batteries according to local regulations and keep away from children. Do NOT dispose of batteries in household trash or incinerate.
2. Even used batteries may cause severe injury or death.
3. Call a local poison control center for treatment information.
4. The compatible battery type CR2032.
5. The nominal battery voltage DC 3V.
6. Non-rechargeable batteries are not to be recharged.
7. Do not force discharge, recharge, disassemble, heat above 60°C or incinerate. Doing so may result in injury due to venting, leakage or explosion resulting in chemical burns.
8. This product contains a non-replaceable button cell or coin battery.
9. Consult an authorized service center or authorized retailers for product service or assistance on proper disassembly or assembly of the product.

## CLASS 2 LASER PRODUCT

### IEC 60825-1:2014

**Caution:** Use of controls or adjustments or performance of procedures other than those specified herein may result in hazardous radiation exposure.

**Wavelength:** 650nm

**Beam divergence:** horizontal: 41°, vertical: 26.5°

**Pulse duration and repetition rate:** 16.8mSec

**Maximum power or energy output:** 1mW

**Attention:** L'utilisation des commandes ou réglages ou l'exécution des procédures autres que celles spécifiées dans les présentes exigences peuvent être la cause d'une exposition à un rayonnement dangereux.

**La longueur d'onde:** 650nm

**La divergence du faisceau:** horizontal: 41°, vertical: 26.5°

**La durée et fréquence de répétition des impulsions:**  
16.8mSec

**L'émission maximale de puissance ou d'énergie:** 1mW



**Illustrate for Party site number 573139:**

**Party site number means that** the Factory which manufactured this Fully-Rugged Tablet PC, R10

**Factory Information:**

**Factory Name:** TWINHEAD INTERNATIONAL CORP

**Factory Address:**

31 HUAXI RD  
DALIAO DISTRICT  
KAOHSIUNG 831 TW

## Safety Instructions

These safety instructions should always be observed to ensure safe operation when handling the device.

- Do not place this device on an unstable table or surface. The device may fall, causing serious damage to its housing and components.
- Do not cover the device or block the air ventilation holes of the device with any other objects.
- Do not use any sharp object to tap on the display screen.
- Do not expose the device to direct sunlight and dusty environments.
- Keep the device away from excessive heat and humidity.
- Keep liquids away from the device.
- Keep the device away from any magnetic emitting devices as this may affect the quality of the wireless signal reception.
- When using an AC adapter:
  - ✓ Place this device in a location that is close enough to an electrical outlet to accommodate the length of the power cord and in order to turn off the power conveniently.

- 
- ✓ Operate this device only with the type of power source indicated on the device marking label.
  - ✓ Disconnect the AC adapter from the electrical outlet if the device is not being used for an extended period of time.
  - When cleaning the device,
    - ✓ Be sure to turn off the device properly and unplug the AC adapter before cleaning.
    - ✓ Wipe the device with a clean, dry cloth.
    - ✓ Do not use abrasive cleaners to clean the device.
  - Do not attempt to disassemble or repair this device. Doing so will void the warranty.
  - For hotspots, users can easily avoid touching the device by changing the way the device is held.
  - For battery pack:
    - ✓ Replacement of a battery with an incorrect type that can defeat a safeguard.
    - ✓ Disposal of a battery into fire or a hot oven, or mechanically crushing or cutting of a battery, that can result in an explosion.
    - ✓ Leaving a battery in an extremely high temperature surrounding environment that can result in an explosion or the leakage of flammable liquid or gas.
    - ✓ A battery subjected to extremely low air pressure that may result in an explosion or the leakage of flammable liquid or gas.
  - The equipment power supply cord shall be connected to a socket-outlet with earthing connection.

# ShopFloor Date Code Format Description

Format	Type	Year (unit digit)	Week	Origin	Year (tens digit)	Serial number
Example	SY	0	17	0	1	12345
Date Code	2	1	2	1	1	5
Total code numbers	12					

## Definition of the Date Code

### First Date Code: Type

SY ... System (complete machine)

### Second Date Code: Year (unit digit)

Last digit of the calendar year. Example: 2010 "0", 2015 "5"

### Third Date Code: Week

Week of the calendar year. Example: January 1 "1", January 8 "2"

### Fourth Date Code: Origin

0 ... Main Factory (Twinhead International Corp.)

### Fifth Date Code: Year (tens digit)

Tens digit of the calendar year. Example: 2010 "1", 2023 "2"

### Sixth Date Code: Serial number

Unique 5-character sequence number assigned to the batch.

