

S7021

**2010-2015 CAMARO 3.6L V6 AXLE BACK
3", MUFFLER DELETE**

MBRP®

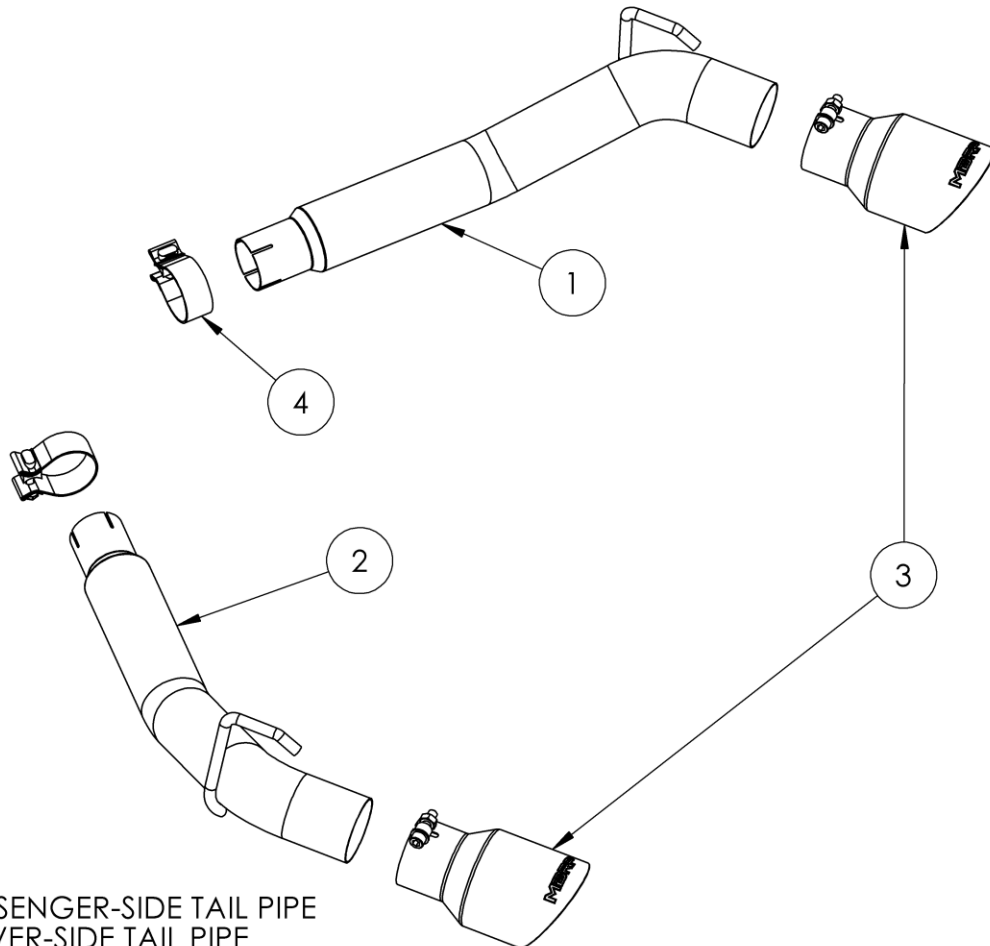

1. PASSENGER-SIDE TAIL PIPE
2. DRIVER-SIDE TAIL PIPE
3. EXHAUST TIP (2 PCS)
4. 2.25" CLAMP (2 PCS)

Refer to this LOT NUMBER when contacting customer service: _____

PLEASE READ BEFORE STARTING INSTALLATION

While MBRP has made every effort to ensure that all components of this system are of superior quality and properly packaged, it is the installer's responsibility to ensure the following before removal of the factory exhaust:

- that ALL components shown above are present.
- that ALL mating components fit together.
- that there are no damaged components.
- that the system you have purchased is appropriate for your vehicle year, model and configuration.
- that the system will not interfere with any modifications previously installed or planned.
- that you have read and understand these instructions.

If you have any questions or are uncertain about any aspect of the installation of this system to your vehicle please contact your dealer before commencing installation.

Removal of Stock System:



Figure 1



Figure 2



Figure 3



Figure 4



Figure 5

1. Apply a penetrating lubricant liberally to rear muffler hangers and rubber isolators.

2. On each side, carefully cut the factory exhaust directly in front of the last bend as it goes into the muffler. Approximately 1.25" in front of the muffler weld seam. This should leave a little over 2" of straight pipe.

Refer to Figures 1 and 2.

3. Remove the factory muffler hangers from the rubber isolators and remove the factory mufflers.

4. Remove the factory rubber isolators from the vehicle but keep them for installation.

Installation of MBRP Inc. Performance Exhaust:

1. Place a **2.25" Clamp** over the end of the **Passenger-Side Tail Pipe** and install onto the cut passenger-side factory pipe.

Refer to Figure 3.

2. Place the outside lower hole of the factory rubber isolator onto the **Passenger-Side Tail Pipe** hanger, then onto the vehicle hangers.

Refer to Figure 4.

3. Loosely install the **Exhaust Tip** onto the **Passenger-Side Tail Pipe** to guide alignment and spacing with the rear fascia.

Refer to Figure 5.

4. Repeat steps 1-3 for the driver-side.

5. Align the edge of each band clamp with the edge of the joint it is connecting. Tighten all hardware and clamps, starting at the front and working rearward to secure the system. Check along the full length of the exhaust system to ensure there is adequate clearance for fuel lines, vent lines, brake lines, frame, bodywork, suspension, and any wiring, etc. If there is any interference detected, relocate or adjust to provide adequate clearance. Ensure all clamp connections are secure and components are unable to rotate or slide. Band clamps require approximately 45 lb-ft (60 N-m) of torque. Verify clearances, system security and band clamp torque after 30-60 miles (50-100 km) of driving.



Congratulations! You are ready to begin experiencing the improved power, sound and driving experience of your **MBRP Inc.** performance exhaust system. We know you will enjoy your purchase.