

INJ30AT

Hardened Gigabit PoE Injector



Overview

EtherWAN's INJ30AT is a compact hardened DIN-rail mounted PoE injector. Providing up to 30W power output, the INJ30AT provides the solution required to integrate remote PoE devices such as IP cameras and other network devices into non-PoE networks for reliable operation even in harsh environments.

EtherWAN — "When Connectivity is Crucial."

Highlights

+ High-Power PoE (Power over Ethernet)

- Provides PoE functionality to a non-PoE network
- Up to 30W output for various security applications such as PTZ cameras
- Backward compatible with 802.3af devices

+ Hardened-Grade for Non-Ventilated & Harsh Environments

- Wide operating temperature range -40 to 75°C (-40 to 167°F)
- Fanless operation
- High impact, thermal shock, and electrical noise resistance

+ Support

- Complimentary Technical Support
- In-person training and free online training courses available
- Limited Lifetime Warranty

Specifications

+ Interface

Ethernet

1 x 10/100/1000BASE-T(X), connection to network

1 x 10/100/1000BASE-T(X), PoE connection to device

LED Indicators

Power detected: Power 1, Power 2

PoE: On (Active), Off (Idle)

+ Technology

Standards

IEEE 802.3 10BASE-T

IEEE 802.3u 100BASE-TX/100BASE-FX

IEEE 802.3ab 1000BASE-T

IEEE 802.3af PoE

IEEE 802.3at PoE+

+ Power

Input

24-56VDC Redundant (Terminal block)

Power Consumption

1W max @ 48VDC, without PoE

PoE Power Output

30W @ 56VDC input

Protection

Reverse Polarity Protection

Current Overload Protection

+ Physical

Casing Material

Aluminum

IP Rating

IP30

Dimensions

1.26" x 3.21" x 4.07"(W x D x H)

32 x 81.5 x 103.5mm

Weight

1.5lbs (0.68kg)

Installation Type

DIN-rail or wall mounting

+ Environmental

Operating Temp.

-40 to 167°F (-40 to 75°C)

Storage Temp.

-49 to 185°F (-40 to 85°C)

Relative Humidity

5% to 95% (non-condensing)

MTBF

>500,000 hours@50°C

+ Regulatory

ISO

Manufactured in ISO-9001 facility

EMI

FCC Part 15B Class A

EN 55032

EN 55024

EMS

EN 61000-4-2 (ESD)

EN 61000-4-4 (Burst)

EN 61000-4-5 (Surge)

Safety

UL 60950-1

Vibration

IEC 60068-2-6

Shock

IEC 60068-2-27

Free Fall

EN 60068-2-32

+ Warranty

Length

Limited Lifetime

Details

www.etherwan.com/support/warranty-policy

+ What's Included

Device

Injector

Installation

Mounting brackets, screws, 4-pin terminal block

Documentation

Quick install guide

Dimensions

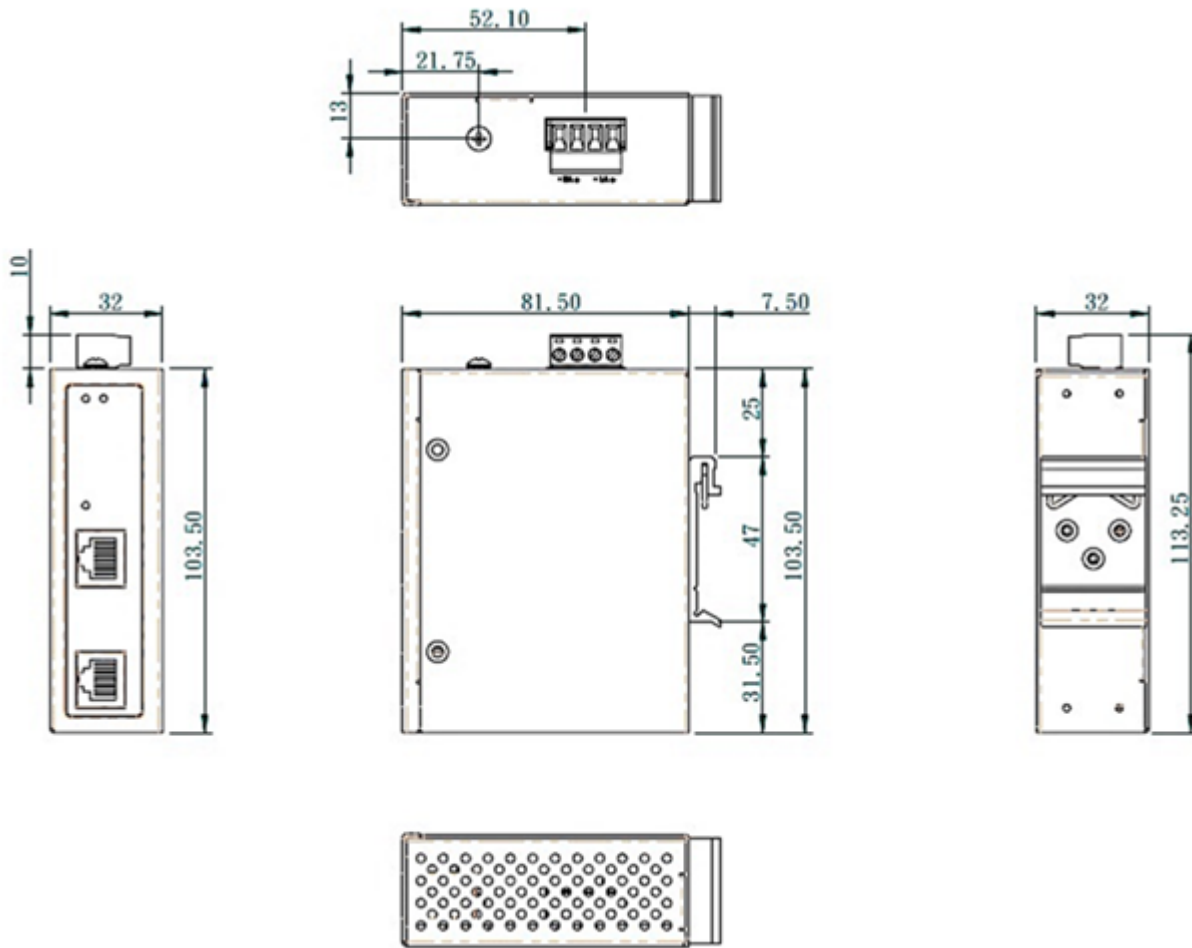

Ordering Info

+ Model

INJ30AT 10/100/1000BASE-T PoE Injector, 30W 802.3at

+ Accessories

DIN-Rail Power Supplies www.etherwan.com/products/din-rail-power-supply



© EtherWAN Systems, Inc. All rights reserved. 20241206

EtherWAN is constantly developing and improving products. Specifications are subject to change without notice and without incurring any obligation.