

SMP3CTX220

Power Supply/Charger

Altronix SMP3CTX220 power supply/charger converts a 115VAC, 50/60Hz or 230VAC (working range 198VAC - 256VAC), 50/60Hz input into a single 12VDC or 24VDC selectable output with a total of 2.5A max.

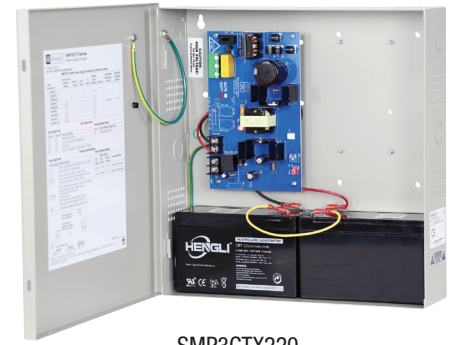

SMP3CTX220

Specifications

Input

Voltage 115VAC, 50/60Hz or
230VAC (working range 198VAC - 256VAC),
50/60Hz

Output

Voltage 12VDC or 24VDC selectable
Current 2.5A continuous supply current
Other Short circuit and thermal overload protection
Filtered and regulated

Battery Charging

Capacity Two (2) 12VDC/7AH within enclosure
Type Sealed lead acid or gel type
Failover Upon AC loss, instantaneous
Batteries are sold separately

Indicators (LED)

Input Input voltage is present
DC Output Powered

Agency Listings

CE European Conformity

Physical and Environmental

Dimensions (H x W x D)

Enclosure:
13.5" x 13" x 3.25" (342.9mm x 330.2mm x 82.6mm)

Shipping:
15" x 13.875" x 4.75" (381mm x 352.4mm x 120.6mm)

Enclosure accommodates up to two (2) 12VDC/7AH batteries

Weight (approx.)

Product Weight: 7.1 lb. (3.22 kg)
Shipping Weight: 8.0 lb. (3.63 kg)

Temperature

Operating: 0°C to 49°C (32°F to 120°F)
Storage: -20°C to 70°C (-4°F to 158°F)

Relative Humidity 85% +/- 5%

BTU/Hr. (approx.):

12VDC: 15 BTU/Hr.
24VDC: 31 BTU/Hr.

Lifetime Warranty

Dimensions and Drawing

Dimensions (H x W x D approximate)

13.5" x 13" x 3.25" (342.9mm x 330.2mm x 82.55mm)

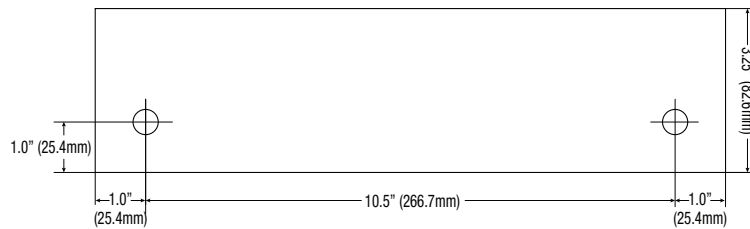
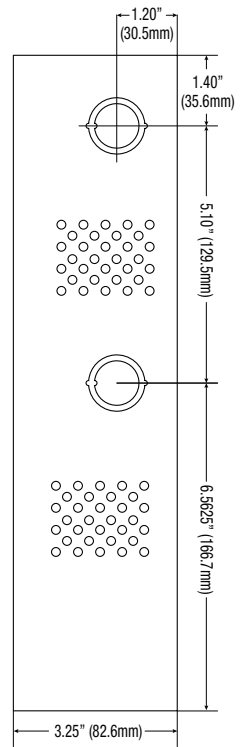
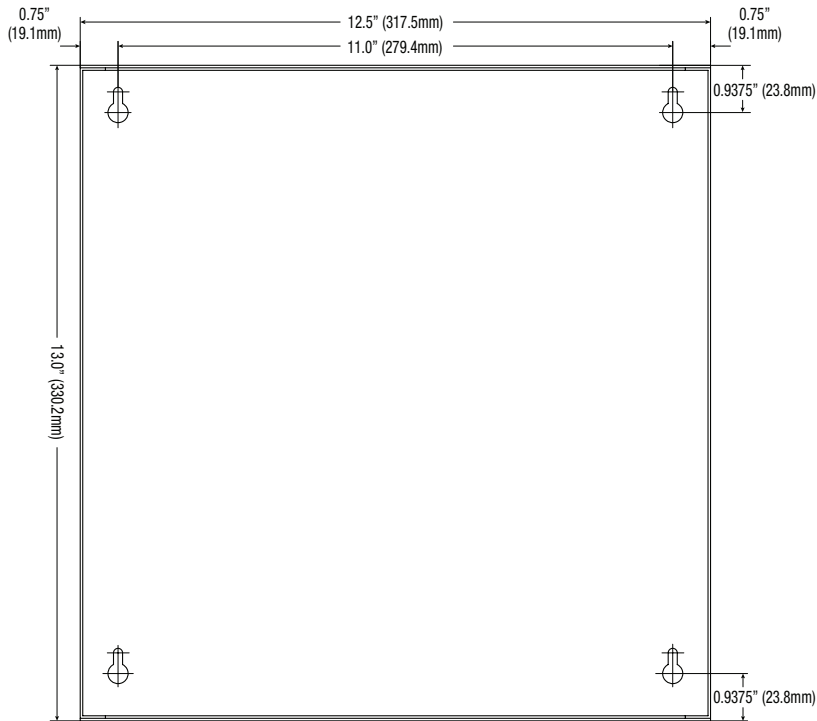
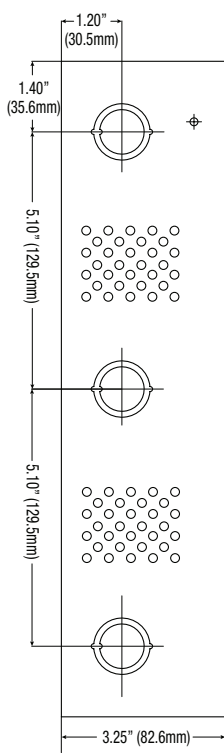
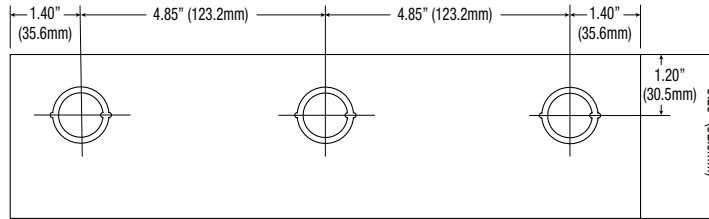

Lifetime Warranty

Altronix Corporation | 140 58th St | Brooklyn, NY 11220 USA

phone: +1 718.567.8181 | fax: +1 718.567.9056 | email: info@altronix.com | www.altronix.com