





BANISH

 banishsuppressors.com

 877.904.5292

 info@banishsuppressors.com

BANISH 46-V2

OWNER'S MANUAL



BANISH Suppressors has always had one overriding goal in mind - to make the most user-friendly suppressor on the market. And what is more user-friendly than being multi-caliber? At BANISH Suppressors, we are proud of what we've accomplished, and we want to share with you what makes a BANISH Suppressor stand out from the crowd.

Our unique WhisperTech™ tube is where the BANISH multi-caliber system starts, with a lightweight titanium alloy tube. BANISH Suppressors are light-weight and tough enough for a lifetime of service. The internal baffles handle the gas in such a way that the suppressor significantly reduces recoil as well as sound.



WARNING

To provide for your safety and the effective use of this silencer, it is important that the owner and any user of the silencer read this entire manual and strictly follow the warnings and instructions within. This silencer should be used only by those who are well-versed in the safe operation of firearms.

Failure to follow installation and maintenance instructions in this manual may result in serious personal injury and damage to the firearm.

Suppressed firearms make less noise than unsuppressed firearms and it is easy to forget that they are still capable of causing bodily injury and property damage. Remember, a suppressed firearm should be treated with the same safety and caution as an unsuppressed firearm. Before installing the silencer, be sure that the firearm is unloaded and the action is opened and visibly clear of any ammunition. If you are at all unsure as to the proper procedures to ensure that your firearm is unloaded, please consult your firearm user's manual/instructions and/or contact a properly licensed dealer or the manufacturer of your firearm.

Firearm silencers are user-attached firearm muzzle devices, and as such are subject to improper attachment issues unless the procedures outlined in this manual are followed precisely.

Check the fit between your barrel and silencer before firing! The thread mount must be fully shouldered on the barrel. For direct thread silencers, there should be no visible gap between the barrel shoulder and the face of the silencer thread mount (crush washer from muzzle brake must be removed).

For quick detach suppressors, the muzzle brake must be seated to the shoulder of the firearm and timed properly using the shim kits provided.

If there is any gap DO NOT fire the host with the silencer attached. Poor accuracy and product damage may result if the silencer is not seated against thread shoulder.

Silencers must be free of obstructions such as mud, dirt, etc. DO NOT attempt to shoot through an obstructed silencer.

The silencer is designed to suppress the initial muzzle blast and subsequent projectile de-corking pressure. The silencer doesn't contact or otherwise interact with the bullet, allowing the projectile to travel at its default speed.

A sonic crack may be produced by the projectile as it breaks the sound barrier. This is solely a function of the projectile breaking the sound barrier and is not related to product performance.

To ensure your silencer remains secure while firing, it is of the utmost importance that you frequently verify the silencer is securely tightened onto the barrel. We recommend checking the security of the attachment after 5 discharges of the firearm and every 30 discharges thereafter.

Before removing the silencer from the host firearm, be sure that the firearm is unloaded, and the action is opened so that it is visibly clear of any ammunition. When removing the silencer, use extreme caution as it may be hot to the touch after firing. Use a Devour™ suppressor cover (sold separately) or gloves to avoid burns or other injuries.

Once the silencer is removed from the host firearm, BANISH recommends using a thread protector or other muzzle device to protect the muzzle threads and crown during storage or transport.

All Banish suppressors have been designed for unmatched sound suppression. Testing shows that the Banish 46-V2 has an average, at ear, sound reduction of 30db.

Like all Banish suppressors, the Banish 46-V2 is made from a strong, Titanium alloy for unmatched durability, at an extremely light weight.

The Banish 46-V2 comes as an 8-inch suppressor holding twelve baffles.

Perfect for the range, but also a plus for in-the-field while hunting, the Banish 46-V2 will significantly reduce the report and recoil of large-caliber rifles and pistol calibers.



SPECS

LENGTH: 8" | **DIAMETER:** 1.59" | **WEIGHT:** 15.3 oz | **MATERIAL:** TITANIUM w/ STAINLESS
STEEL BLAST BAFFLE | **THREAD PITCH:** 5/8x24 | **CALIBER:** .460 |
CALIBER RANGE: 5.56 - .460 | **COLOR:** Black | **FINISH:** CERAKOTE | **FULLY AUTO RATED:** LIMITED
SOUND REDUCTION: 30 DB | **MOUNT STYLE:** INDUSTRY STANDARD HUB
LIFETIME WARRANTY: YES | **SELF-SERVICE:** YES | **NUMBER OF BAFFLES:** 12

INSTALLATION OF MOUNT INTO SUPPRESSOR

Prior to mounting the suppressor to the firearm you must first thread and tighten the mount (shipped with the suppressor) into the suppressor. Carefully thread the mount into the suppressor and tighten to 50–60 in-lbs.

If you purchased a Nielson Device mounting interface for your suppressor this will need to be assembled into the suppressor mount as well. Insert the piston (with spring over it) into the mount and lock it down with the piston cap.

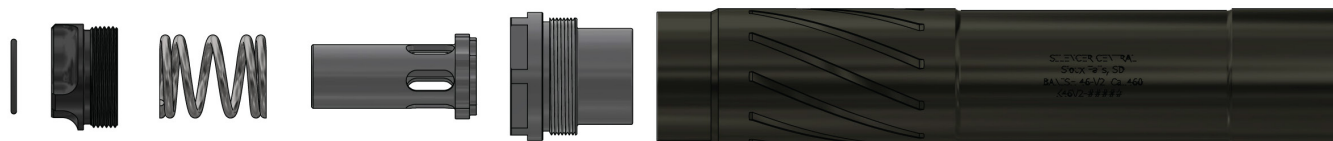

INSTALLATION OF SUPPRESSOR DIRECT THREAD AND NIELSON DEVICE

Always ensure the firearm is unloaded when attaching or removing suppressor. After confirming that your firearm is unloaded, place the threaded end of the BANISH 46 in line with the threads of the barrel.

Ensure the threads on the barrel and suppressor are clean and undamaged, screw the suppressor onto the barrel threads until the suppressor firmly seats against shoulder.

Take special care to avoid cross-threading as damage to the suppressor and barrel threads will result, as well as misalignment of the suppressor with the bore of the firearm.

This may result in a potential baffle strike that could cause serious personal injury and damage to both the firearm and suppressor. Since direct thread mounted suppressors can loosen or unscrew during firing, it is extremely important that the operator frequently checks that the silencer remains securely threaded to the barrel.

Please note, the suppressor will be very hot during and after firing. Wait until the suppressor cools or use a Silencer Central™ suppressor cover to retighten.

Hand tighten suppressor only. Ready for use.



INSTALLATION OF MUZZLE BRAKE AND SUPPRESSOR

Always ensure the firearm is unloaded when attaching or removing a muzzle brake or a suppressor. After confirming that your firearm is unloaded, remove any preceding muzzle device and crush washer.

Watch our online tutorial on how to install a muzzle brake and shim kit at www.YouTube.com/SilencerCentral. Items included will be the actual muzzle brake and necessary shim kit. You will need to use Red Loctite (not included).

1. Make sure to clean the threads of your barrel prior to installation of the muzzle brake.
2. Attach the new muzzle brake onto the barrel all the way by hand without using shims until it shoulders tight to the barrel.
3. Unscrew the muzzle brake so that the center point (engraved BANISH) is perpendicular to the plane of the barrel in the 12 o'clock position. The 12 o'clock position will be the final orientation of the muzzle brake with BANISH logo facing directly upward.
Note: when you back the muzzle brake off of the shoulder it should be less than a full 360-degree rotation of the muzzle brake.
4. Once the brake is placed at the 12 o'clock position, unscrew one additional quarter turn to the 9 o'clock position. This will allow tightening the muzzle brake into the correct position.
5. The space between the brake and the shoulder of the barrel located at the rear of the threads will be where the shims will sit. Select the shims with varying thickness that will fit snugly in this space. This will be different on every firearm and may require some trial and error. Use as few shims as possible to fill the void is the best practice. Start with the thickest shim and find the best combination that allows for the tightest fit within the space between the muzzle brake and barrel shoulder. Save excess shims for later use.
6. Once you have found the combination resulting in the tightest fit, remove the brake completely from the barrel and place that combination of shims over the threads of the barrel against the shoulder. Then screw the brake onto the threads of the barrel by hand. If this process has been completed correctly the brake should return to the BANISH logo resting at the 9 o'clock position.
7. Using a crescent wrench or $\frac{3}{4}$ " wrench tighten the muzzle brake $\frac{1}{4}$ turn to allow for the muzzle brake to sit at the 12 o'clock position.
8. Once the practice timing is perfect in the 12 o'clock position, remove the muzzle brake completely from the barrel and apply Red Loctite or Rocksett. Once applied, repeat steps 6&7 to set the muzzle brake in place.
9. You are now ready to install your BANISH 46-V2 Suppressor. Line up your BANISH 46-V2 suppressor with the muzzle brake and screw it on hand tight.



DISASSEMBLY AND CLEANING

It is recommended that the suppressor be cleaned every 50 - 100 rounds fired. The use of solid lead or plated lead bullets is not recommended.

To disassemble make sure the firearm is unloaded and remove from host firearm.

Using the provided tool key and T-45 torx wrench, remove the end cap of the suppressor. For best results, we recommend permanently attaching the T-45 torx wrench and the tool key together. This can be done with “JB Weld” or similar product found at any local hardware store.

Remove the front module from the main tube.

The end cap of the suppressor that threads onto the barrel is not intended to be removed from the main tube of the suppressor.

Using your solvent of choice, spray the inside of the suppressor and let sit for 24 hours.

Push baffles out of the tube with our Baffle Removal Tool (sold separately) or a wooden dowel.

The suppressor has 12 baffles, one accuracy baffle and eleven baffles. Care must be taken when reassembling.

Use a stiff bristle brush (brass or nylon) with solvent / carbon killer of choice to clean the baffles and inside the tube.

Make sure all parts are clean and solvent has been removed.

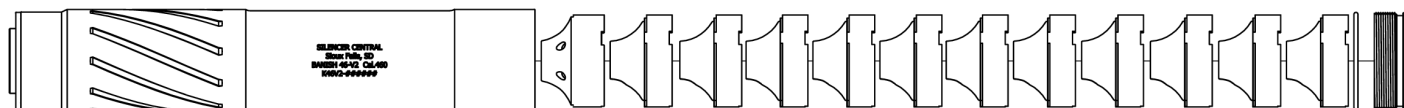

ASSEMBLY

Using a flat surface, stack eleven matching baffles on top of each other. Make sure the indexing tabs are aligned and fully engaged in each corresponding baffle.

Stack accuracy baffle on top of the eleven baffles. Make sure the index tab from the baffles is fully engaged in the accuracy baffle.

Slide the tube over the baffle stack. Keeping the tube in the upright position, with one hand, slide the centerline of the tube to the edge of the table. While holding the tube with one hand, use one finger on the other hand to push the baffles up the tube.

Flip the assembly over so the open end is up. Apply anti-seize to the threads before installing the end cap.

Care must be taken during assembly to ensure the indexing tab on the baffles are aligned with each corresponding baffle before tightening end cap.

Lightly tighten the end cap, when the baffles are properly aligned only the 45-degree bevel on the end cap will be exposed (approximately $1/32$ "). If more than $1/32$ " is exposed the tabs on the baffles are not properly aligned.

Finish tightening end cap to 40 in-lbs.

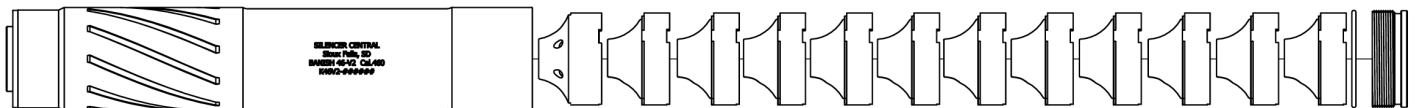



BANISH

LIFETIME WARRANTY

We provide a lifetime warranty against all manufacturing defects and damages caused by the normal use of our products. We will repair or replace free of charge any suppressor manufactured by, or at the direction of, BANISH Suppressors. The product is sold "as is" with no further implied contractual rights or warranties beyond those expressly stated herein.

The lifetime warranty does not apply to certain conditions or acts. It is at the sole discretion and determination of BANISH Suppressors if a defect or condition is covered by this warranty. Conditions not covered include, but are not limited to: modifications, abuse, neglect, use of defective ammunition, use of improperly sized ammunition, and criminal conduct. BANISH Suppressors assumes no liability for damages or bodily injury caused by such acts or omissions as previously described. Abuse and neglect are defined as usage outside of the reasonable scope for which the product is intended, thus contributing to the accelerated and unreasonable premature wear of the suppressor itself.

If a repair is required, the owner must contact our Customer Service Department. Our customer service representative will arrange for return of the suppressor at manufacturer's shipping expense. PLEASE DO NOT SHIP THE SUPPRESSOR FOR REPAIR WITHOUT FIRST CONTACTING CUSTOMER SERVICE AND DO NOT SHIP IN ANY EVENT WITHOUT A COPY OF THE APPROVED BATFE FORM.

When you ship the suppressor back to the manufacturer, please include a detailed statement concerning the type of defect or malfunction encountered, describe the ammunition used and type of host weapon the product was used on or attached to.

If for any reason your suppressor is not eligible for repair or replacement, you may purchase a replacement suppressor for 50% off the MSRP for a same or similar suppressor.

Please contact our Customer Service Department at 888-781-8778 for further details and requirements.

RETURN SHIPPING

The cost of shipping for any items returned to Silencer Central is the responsibility of the customer, with the exception of warranty claim returns. Return shipping to Silencer Central for warranty claims and/or repairs are covered by Silencer Central as long as Customer Service is contacted in advance and a warranty claim form is completed by the customer.