



## // In memory of Dieter Juergens (1920-2014)



A dear friend to Deep South, his technical expertise and dedication brought founder Camile Landry's vision of the VersaCrane line to life. Dieter had many accomplishments before partnering with Deep South: Chairman of ISO (International Organization for Standardization) for Crane Standards, Chairman of SAE for Crane Standards, Director of Engineering at American Hoist, and later, Director of Engineering at P&H. The Deep South family is grateful for his hard work and for decades of friendship.

## // Our Projects Begin With Safety

Even before our team members set foot on a worksite, our personnel have evaluated the entire project with safety in mind, so that every step of each individual task is performed with caution and diligence. From the protective equipment our employees wear on the outside to the mental focus they display on the inside, safety is at the forefront of every job.

**Since 1968**, Deep South Crane & Rigging has remained at the forefront of innovation, providing our customers unique solutions to complex challenges. As an international, full-service company, we combine the right tools with the right talent to offer a range of services, from bare crane rentals to turnkey heavy lift and heavy transport solutions. Family owned and operated since our inception, Deep South continues to put a premium on personal service and—above all—safety. We have come a long way since 1968, but the way we see it, we are just getting started.

## INDUSTRIES SERVED



### PETROCHEMICAL

Capital Projects  
Maintenance  
Turnarounds  
Emergencies

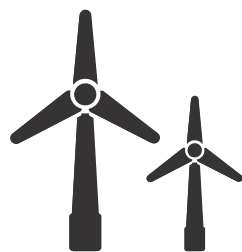

### POWER GENERATION

Coal Fired  
Combined Cycle  
Peaking  
Substations  
Wind

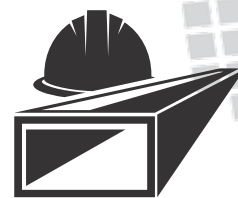

### HEAVY INDUSTRIAL

Mining  
Steel  
Minerals  
Heavy Fabrication/  
Manufacturing

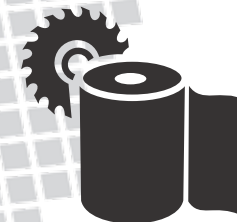

### PAPER

Forest Products  
Paper/Pulp  
Chip Mills  
Sawmills  
Engineered  
Wood Products

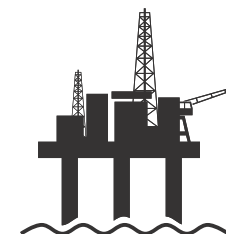

### OIL/GAS E&P

Offshore  
Gas Processing  
Compression  
Rig Support



### COMMERCIAL CONSTRUCTION

Site Support



### CIVIL CONSTRUCTION

Site Support  
Bridge Construction  
Rapid Bridge  
Replacement



# A Legacy of Lifting

PROVIDING WORLD CLASS SERVICE FOR NEARLY 50 YEARS

In 1968, Deep South Crane & Rigging opened as a family owned and operated industrial electrical contractor. Rough terrain cranes were a necessity for most projects at the time, and the company responded to the need by offering to rent this type of machinery to its clients. Soon after, Deep South began exclusively renting equipment to customers. With the growing demand for larger capacity cranes, Deep South fully committed to the heavy lift and heavy haul business by purchasing additional equipment as well as investing in their first 300-ton lattice boom crane and hydraulic transporters.

By the late 1980s, things were looking up. The demand for cranes exceeding 1,000-ton capacity began to increase; however, Deep South discovered that most high capacity cranes manufactured in the United States could not handle the job at hand. Company representatives sought equipment across the Atlantic, but European cranes were too heavy and did not meet U.S. DOT's highway transportation restrictions.

Determined to find a solution, Deep South called upon its years of expertise and intricate knowledge of the crane and rigging industry and set out to engineer and manufacture its own crane. History was made in 1993 when Deep South's VersaCrane™ was unveiled. Specifically designed to work in petrochemical facilities and other areas with restricted space, this technological marvel stands as a true innovation in the crane and rigging world.

Today, Deep South is an international operation with sales offices and teams located strategically across both North and South America to provide world-class service to clients no matter their location.







**TheRightTools**

**TheRightTalent**





*The upper and lower sections of this vessel, weighing 85 tons and 102 tons, respectively, were transported from the port to the refinery using Goldhofer Dual Lane trailers. They were then lifted and set, in combination with their supporting structures, using the 660-ton Demag CC2800-1 and the 500-ton Liebherr LTM 1400-7.1.*

# TheRight**Tools**



**WITH NEARLY FIVE DECADES OF  
EXPERIENCE, WE KNOW OUR  
CUSTOMERS WANT OPTIONS.**

Deep South offers you the exact  
services you need to ensure your project  
is completed on time, on budget, and in  
the safest manner possible – even in  
the most challenging situations.

**Specialty Lifting & Transport Solutions**

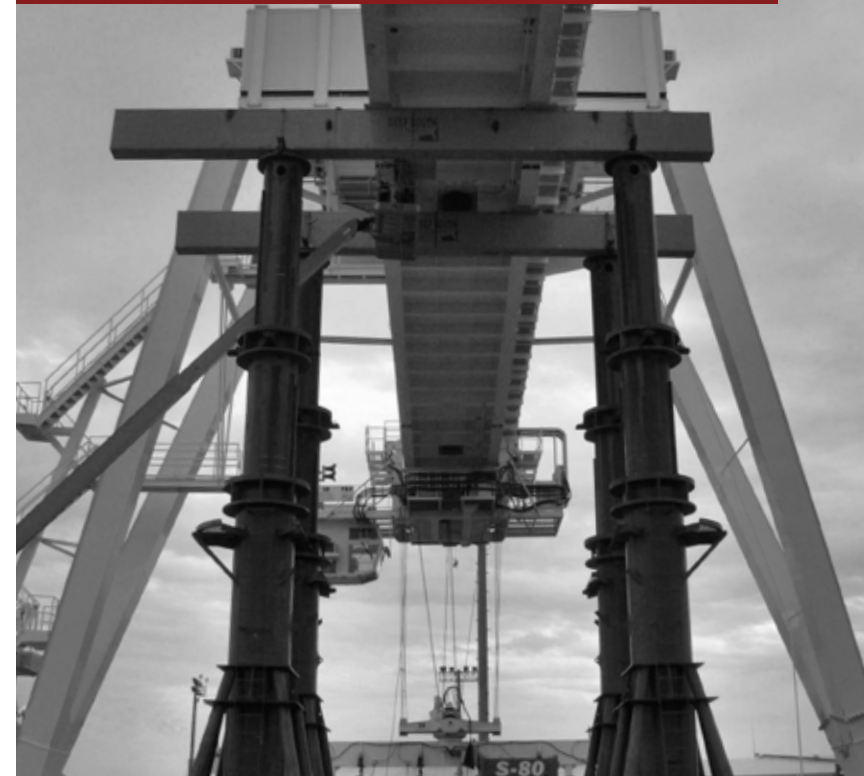

**Turnkey Solutions**



**Rigging Services**



**Transport Services**



**Lifting Services**



**Engineered Solutions**



# TurnkeySolutions

## From Fab To Slab

More and more customers are realizing the benefit of using Deep South Crane & Rigging for turnkey projects such as new construction, large expansions, and turnarounds. Using our skilled team, extensive resources, and ability to customize solutions, we can meet the challenges of any project from start to finish.

*Deep South has transported and set some of the largest shop-fabricated vessels in the world. Pictured here is a 730-ton vacuum tower that was set by the 2,500-ton VersaCrane TC-36000 using 360' of main boom and 1,881 kips of super-lift counterweight.*





# 1 Logistics Planning

Feasibility Studies

Route Surveys

Regulatory Interactions

Method Selection

Challenge Evaluation

onsite  
road  
barge  
rail  
ocean

clearances  
weights  
access  
permits

# 2 Site Planning

Safety Execution Planning

Access/Egress Analysis

Obstruction Remediation or Avoidance

Lifting & Setting Method Selection & Analysis

Handling and Staging from Transport

## From Start to Finish We've Got You Covered

# 3 Execution

Planning & Engineering

marine transport  
handling  
lift planning & engineered lift plans  
rigging engineering

Transport to Site

rail  
ocean  
- ocean vessel  
- barge  
road  
- over the road equipment  
- dual lane transport systems  
- towed hydraulic modular transporters  
- self-propelled modular transporters

Erect at Site

all-terrain cranes  
crawler cranes  
rough terrain cranes  
pedestal heavy lift cranes  
specialized lifting devices and methods

Specialty & Custom Methods & Devices

levee crossing bridge systems  
bridge jumpers  
lift towers  
strand jacks  
hydraulic gantry systems  
hydraulic skid systems  
hydraulic jacking systems  
spreader beams  
lift beams



# TurnkeySolutions

by the  
numbers

We know in the real world that most jobs rarely go exactly as planned. That's why overcoming obstacles and major scope of work changes do not faze us. From challenges presented by the Army Corps of Engineers for levee crossings to ultra-low site-allowable ground bearing pressures, we've seen it all and always deliver.

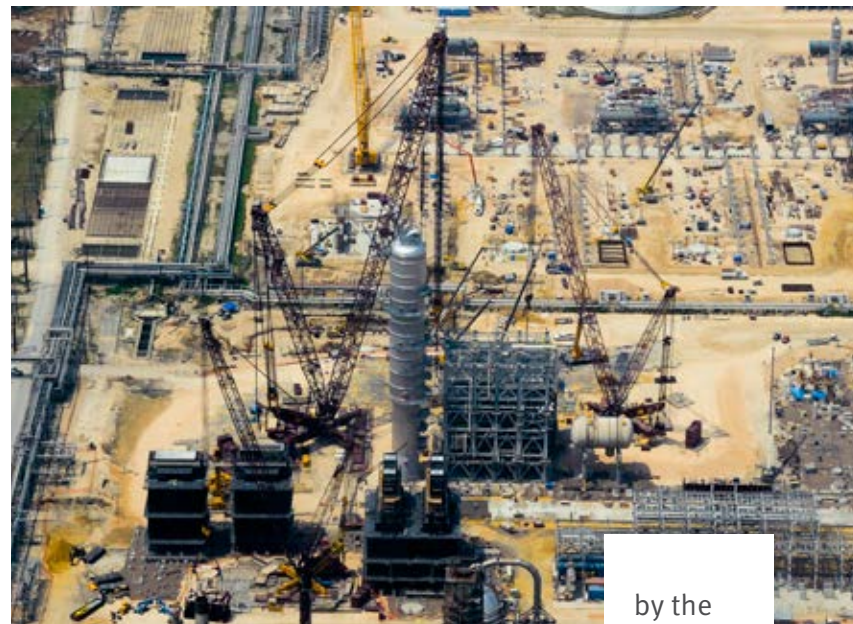

by the  
numbers

**286,000** Man Hours | **300+** Lifts  
Total Weight Lifted = **100,000T** | Largest Lift = **1,200T**

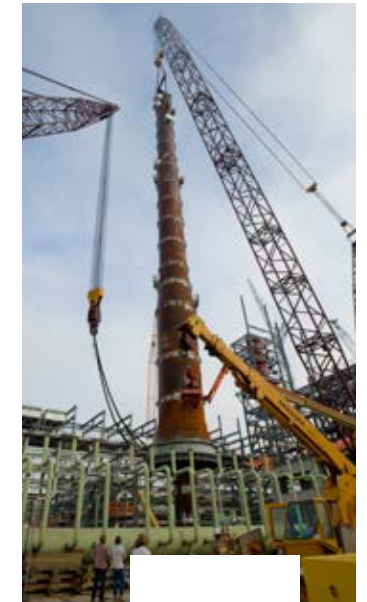

by the  
numbers

**375,000** Man Hours | **200+** Lifts  
**50+** Barge Loads over Custom-built Bridge | Largest Lift = **890T**





# LiftingServices

## Your One Stop Shop For Lifting Services

When it comes to cranes, Deep South has the capacity to complete even the most complex projects. Whether you need a basic rough terrain crane or a state-of-the-art heavy lift crane, we've got you covered with a comprehensive fleet. We are committed to providing our customers with the latest technology available and continuously acquire new equipment.

### CRANES FROM 2.5T – 2,500T

VersaCranes	750T - 2,500T
Crawler cranes	275T - 1,760T
Lattice boom truck cranes	140T - 440T
Hydraulic truck cranes	50T - 1,320T
Rough terrain cranes	2.5T - 160T

*In addition to maintained and operated rentals, cranes from 2.5T – 160T are available for bare rental.*





# SheerStrength

The VersaCrane line provides the versatility and strength to meet any challenge.

In the 1990s, Deep South fully committed to the heavy lift industry by designing its own fleet of heavy lift cranes known as VersaCrane. Ranging from 750T - 2,500T and standing at more than 600 feet tall, these patented cranes are a true marvel in the industry. Our team of engineers and certified craftsmen continually evaluate and improve these cranes to ensure safe operation. To further ensure safety, highly-skilled employees are trained by Deep South to operate these specialized machines.

**In a tight spot?** The brilliance of the VersaCrane fleet is its ability to maintain high capacity while fitting in confined spaces and maintaining industry-leading low ground bearing pressures. Our intricate knowledge of these cranes allows us to make job-specific crane modifications based on the needs of the job. And our ability to relocate assembled VersaCranes via SPMTs saves time and money.



## VERSACRANE™

2500T

VERSACRANE TC-36000

1000T

VERSACRANE TC-12000

1800T

VERSACRANE TC-28000

1000T

VERSACRANE CC-12000

1500T

VERSACRANE TC-24000

750T

VERSACRANE CC-9600



Deep South set a 465-ton regenerator using the 2,500-ton VersaCrane TC-36000 with a 290' radius and 450' main boom.



A red semi-truck is pulling a long trailer carrying a large white cylindrical vessel across a cable-stayed bridge. The bridge has tall white pylons and numerous yellow stay cables. The sky is blue with some clouds.

# TransportServices

## World Class Transportation Services From The Routine to The Extreme

Deep South prides itself as having one of the most advanced heavy haul fleets available. In addition to self-propelled transporters, Deep South has specialized over-the-road transport equipment capable of completing any task at hand. From route planning to permitting to coordinating subcontractors and governmental agencies, our knowledgeable crews ensure loads are in compliance with all state and federal highway regulations.

We've utilized hydraulic transport trailers since 1981, and with more than 400 lines of specialized transporters including self-propelled and towed arrangements, we can provide a solution for any of your heavy transport needs.

*Deep South loaded, secured, and transported four pressure vessels from a fabrication shop to a petrochemical facility using a combination of Scheuerle SPMTs, a 500-ton hydraulic gantry, and Goldhofer Dual Lane trailers. The largest of the four vessels weighed approximately 400 tons and measured 145' long and 16' in diameter.*





by the  
numbers

**270ft Long | 19ft Tall | 20ft Wide | Gross Weight 681,000 lbs. | Traveled 300 Miles**



## Transport Services

Our fleet of specialized transporters includes self-propelled, towed arrangements, and specialized multi-axle over-the-road combinations by Scheuerle, Cometto, Nicolas, and Goldhofer.

In addition, we have specialized lowboys, stretch trailers, flat trailers, squat beams and stands, bolsters, marine securing services, and ballasting capabilities.



# Specialty Lifting & Transport Solutions

**For unique project requirements, Deep South can design, build, and test specialized lifting and transport devices and equipment.**

We've faced extreme challenges during our nearly 50 years of hauling and lifting heavy vessels. We tackle these challenges through our creative engineering and extensive fabrication capabilities. Quality is assured through many methods including finite element analysis, computer modeling and analysis, non-destructive testing, proof loading, and pull-testing.

Solutions to tough project challenges include:

- Levee crossing bridge systems (capacity >1,000T)
- Bridge jumpers through 100' span
- Hydraulic jacking, skidding, and gantry systems
- Lift towers and strand jacks
- Low-profile, inverted saddle systems (for minimizing transport height)
- Hydraulic adjustable spreader bars and lift beams





# RiggingServices

## All the tools to accommodate your rigging needs

Through the years, Deep South has acquired an extensive inventory of well-maintained rigging hardware to accommodate the ever-changing needs of our customer base.

All rigging hardware is certified and maintained by qualified personnel. We have invested in a test bed facility that allows our team to proof test and certify our rigging hardware and specialty lift devices. We utilize the state-of-the-art RFID Infochip system, which allows us to tag components and easily provide valuable information to employees on the type, capacity, and certification of each component.

- Our inventory of rigging includes:
- Numerous spreader bars and lift beams up to 1600T capacity
  - Over 3,000 slings of various construction and lengths
  - Shackles through 600T

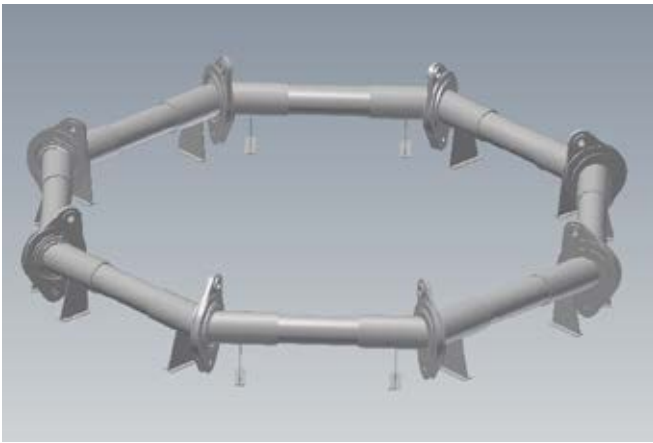

Deep South designed and manufactured a 930-ton capacity octagon spreader bar using Autodesk Inventor Professional and RISA 3D Structural. It was first used to lift an 800,000-pound regenerator head that required vertical pull on the lifting lugs.



At a South American refinery, Deep South used its 2,500-ton VersaCrane TC-36000 and 750-ton VersaCrane CC-9600 to erect a new FCCU regenerator vessel weighing 797 tons.





# Engineered Solutions & Fabrication Facilities

## What it takes to get the job done

Deep South can design and manufacture virtually everything needed for a project, from custom rigging to heavy lift tools. Our talented team of certified engineers and experienced craftsmen partner to design, fabricate, and test virtually anything required for a project. With these capabilities, we respond to our clients' needs and provide faster service and shorter turnaround time, saving our clients time and money.

Our skilled staff will take an engineered approach to solving project challenges, even under extreme conditions. When it comes to our business, we believe if it can be done, Deep South has the experience and the resources to do it best.

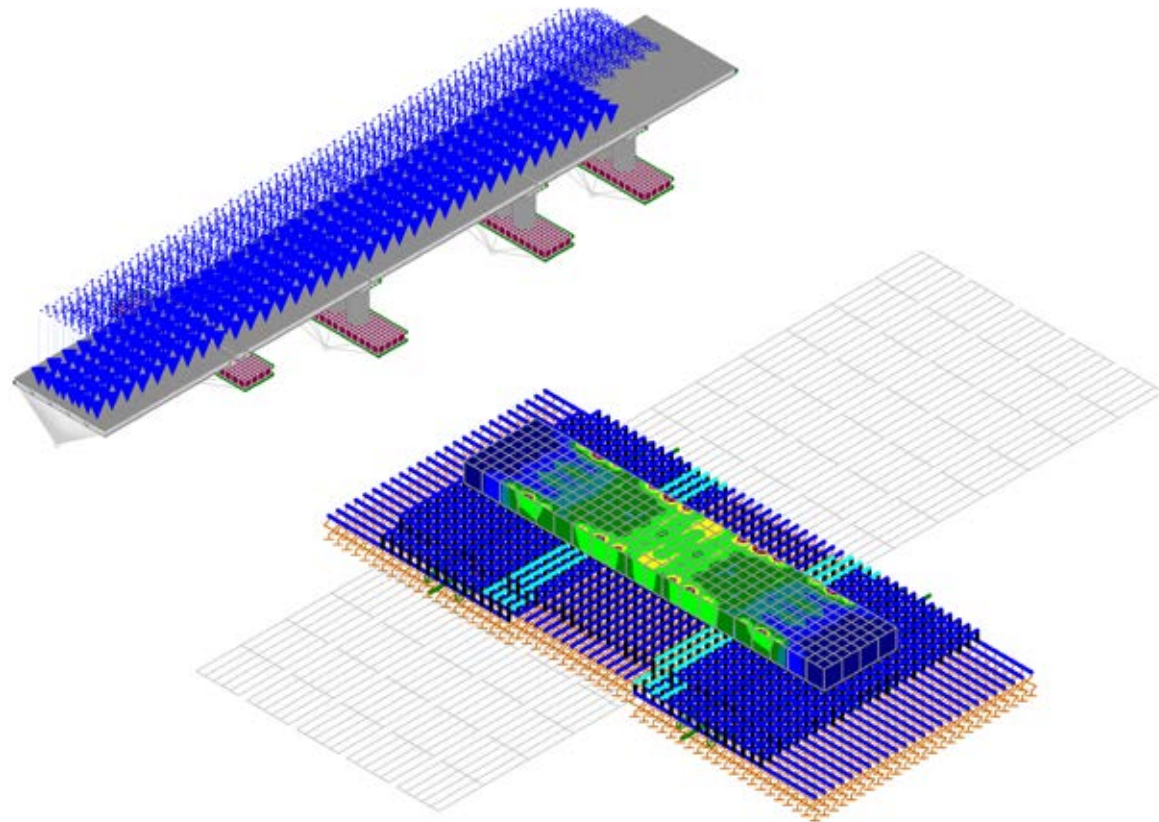

Using a 3D structural analysis program, Deep South designed a heavy haul bridge in short order due to permitting issues for loads over 612 tons. The bridge was 190 feet long and had a maximum clear span of 50 feet. The largest load over the bridge weighed 1,117.5 tons. Shown here are the mat foundation analysis and steel distribution ramp stresses used during the design process.



Deep South has over 100,000 square feet of fabrication facilities that include the necessary equipment required to fabricate specialty items. Every piece of structural steel used is stamped with a serial number so that each piece can be fully traced from the mill, through welding and inspection procedures, and all the way to the completed component. Pictured here is the CNC oxy/fuel plasma-cutting machine.





TheRight**Talent**





People are our most valuable asset, and their **safety** takes precedence over everything.

## A **Team** with Depth

Through nearly five decades, we have built a legacy of dedicated team members. From our experienced engineers and project managers to our skilled craftsmen, riggers, and crane operators, our diligent pursuit of safety and innovation has provided our clients a path to on-time and successful projects. It is this expertise, coupled with an array of specialized equipment, that helps us rise to the challenge while providing the absolute best in safety, service, and solutions.

Down the street or around the globe, our clients understand the value of a partner that can provide exceptional success on every project, with the right tools, the right talent—from start to finish.







## Our Road Map to Safety

**Our safety department** carved out a safety “road map” to help define our safety journey many years ago. This master safety plan starts at the top with safety-focused management and is carried through the organization by means of written standards, excellent planning, thorough training, and clear communication.

Employee training is fundamental to our safety focus. We ensure that each employee has the necessary skills and experience to meet the requirements of the task at hand. In addition, we strive for continuous improvement in our procedures and practices and for the continued education of all employees through ongoing training efforts. Training includes both task-specific and safety training, done in classroom-style meetings, via computer-based platforms, and in on-the-job settings starting with apprenticeship programs.

We take our work and safety program seriously, and we make every effort to ensure the safety of our employees and those around us.

// Constant evaluation of this safety road map is how we believe we can stay focused on the end goal: returning our team members and everyone else on a job site safely back to the most important place of all—their home.





[deepsouthcrane.com](http://deepsouthcrane.com)