

DMT3 Deck Mount Traditional Triple Dome Skylight

| Traditional Triple Dome Options | | | | |
|---|----------|--|--|--------------------|
| Size - Width x Length (using Inside Curb Dimensions) | Quantity | Dome Material* | Dome Description and Designation | |
| | | LuxGuard 0.118 PC over 0.118 PC over 0.118 PC | Clear Smooth/Clear Smooth/White Prismatic (P1C2) | Max size 50x115 |
| | | | Clear Smooth/Clear Smooth/Clear Smooth (P1P1) | Max size 68x116 |
| | | 0.118 PC over 0.118 PC over 0.118 Acrylic | Clear Smooth/Clear Smooth/Satin Ice (P1H1) | Max size 94x91 |
| | | Infrared Blocking Acrylic 0.118 Acrylic over 0.118 Acrylic over 0.118 Acrylic | Satin Sky 2 / Clear Acrylic / Clear Acrylic (E2A1) | Max size 68x116 |
| | | | Satin Sky 2 / Clear Acrylic / Satin Ice (E2H1) | Max size 68x94 |

*Note: Dome Material thickness is sheet material's thickness prior to the manufacturing process.

| Frame Finish Options | |
|--------------------------------------|---|
| <input type="checkbox"/> Mill Finish | <input type="checkbox"/> Neutral Gray Powder Coat |

| Standard Curb Heights | | |
|-----------------------------|------------------------------|------------------------------|
| <input type="checkbox"/> 9" | <input type="checkbox"/> 12" | <input type="checkbox"/> 16" |

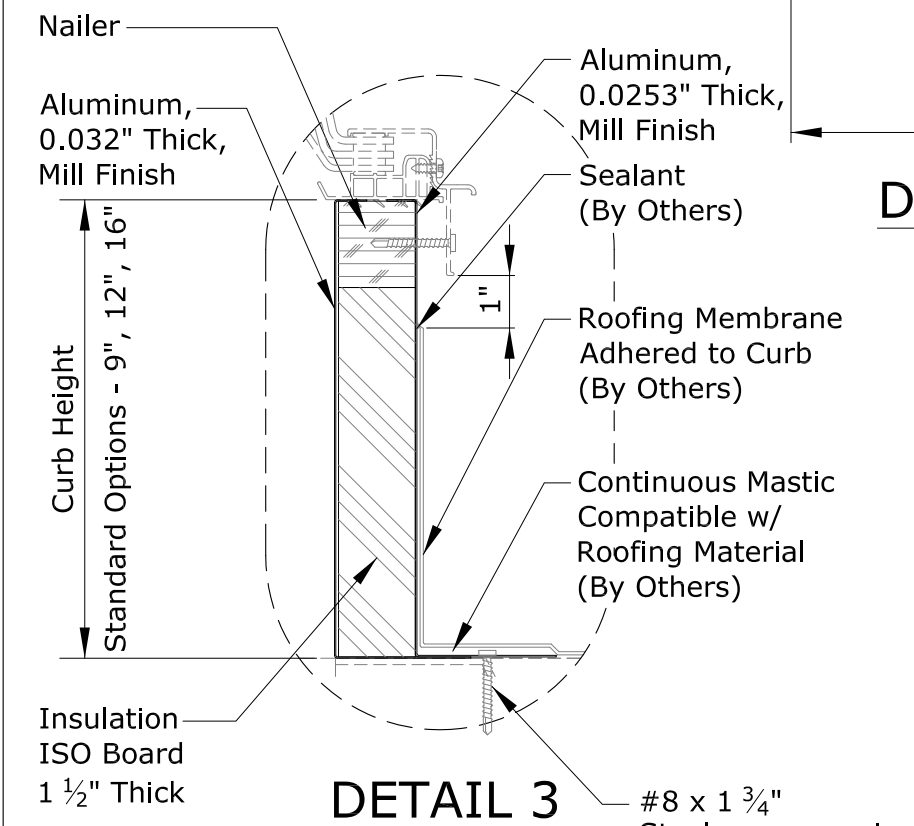

DETAIL 1

DETAIL 2

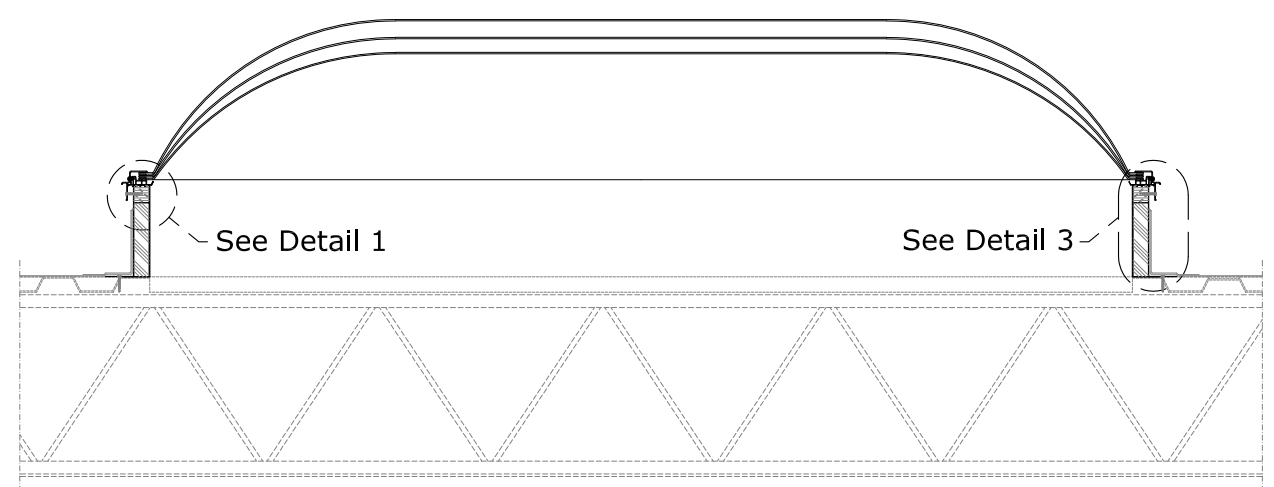

SECTION A-A

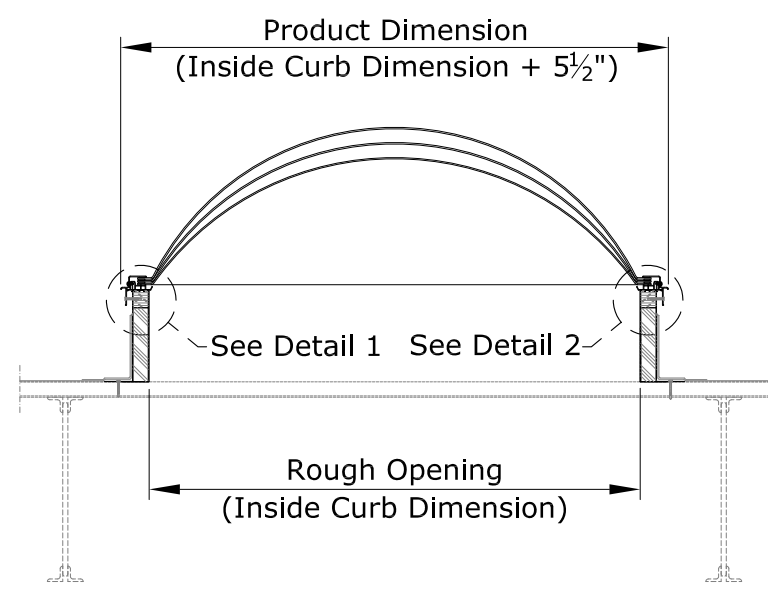

SECTION B-B

GENERAL NOTES

1. This drawing emphasizes the VELUX DMT3 Deck Mount Traditional Dynamic Double Dome Skylight. It illustrates a general arrangement layout (plus recommendations) for a VELUX DMT3 installation in a 0-60 degree roof pitch application. VELUX DMT3 skylights are shipped on VELUX curb designs.
2. The architectural/structural design and specifications for the inclusion of a commercial skylight, such as the VELUX DMT3 in any roofing/ceiling application is determined and provided by others. The design criteria includes, but is not limited to design loads, structural configurations, structural framing member sizes and material, architectural finishes and integration with the roofing/ceiling systems of the building. VELUX recommends compliance by all designers and installers with all local and industry specific building codes and guidelines. VELUX assumes no responsibility or liability in the design, construction and performance of a building structure by others.
3. The fasteners securing the curb to the rough opening are provided by others. VELUX recommends #8 x 1-3/4" steel non-corrosive fasteners. The fasteners should be placed in the center of the curb flange 4" from each corner and 12" on center for the length and width of the deck mounted skylight.

This drawing is an instrument of service and is provided for informational use only.



Sky-Global Product Management

VELUX
1418 Evans Pond Road
Greenwood, SC 29649
1-800-88-VELUX
www.VELUXUSA.com

DMT3 Deck Mount Traditional Triple Dome Skylight