

DMD5 Deck Mount Dynamic Dome + Security Bars w/ Lumira Skylight

| Dynamic Dome with Lumira Options | | | | |
|--|----------|---|----------------------------------|--------------------------------------|
| Size - Width x Length (using Inside Curb Dimensions) | Quantity | Dome Material* | Dome Description and Designation | |
| | | LuxGuard 0.118" Polycarbonate over 10mm Lumira | Clear smooth over 10mm Lumira | Max size 6012 Max Size 7272 |
| | | Infrared Blocking Acrylic 0.118" Acrylic over 10mm Lumira | Satin Sky 2 over 10mm Lumira | Max size 6012 Max Size 7272 |

*Note: Dome Material thickness is sheet material's thickness prior to the manufacturing process.

Frame Finish Options

☐ Mill Finish ☐ Neutral Gray Powder Coat

Standard Curb Heights

☐ 9" ☐ 12" ☐ 16"

| DMD5 Dimensions (inches) | | |
|--------------------------|-----------------------------|-------------------|
| Size | Rough Opening (Inside Curb) | Product Dimension |
| 2412 | 24 x 120 | 29 1/2 x 125 1/2 |
| 2448 | 24 x 48 | 29 1/2 x 53 1/2 |
| 2496 | 24 x 96 | 29 1/2 x 101 1/2 |
| 3012 | 30 x 120 | 35 1/2 x 125 1/2 |
| 3612 | 36 x 120 | 41 1/2 x 125 1/2 |
| 3636 | 36 x 36 | 41 1/2 x 41 1/2 |
| 3660 | 36 x 60 | 41 1/2 x 65 1/2 |
| 3672 | 36 x 72 | 41 1/2 x 77 1/2 |
| 3696 | 36 x 96 | 41 1/2 x 101 1/2 |
| 4783 | 47 x 83 | 52 1/2 x 88 1/2 |
| 4812 | 48 x 120 | 53 1/2 x 125 1/2 |
| 4848 | 48 x 48 | 53 1/2 x 53 1/2 |
| 4860 | 48 x 60 | 53 1/2 x 65 1/2 |
| 4872 | 48 x 72 | 53 1/2 x 77 1/2 |
| 4896 | 48 x 96 | 53 1/2 x 101 1/2 |
| 5060 | 59 1/2 x 71 1/2 | 65 x 77 |
| 6012 | 60 x 120 | 65 1/2 x 125 1/2 |
| 6060 | 60 x 60 | 65 1/2 x 65 1/2 |
| 6072 | 60 x 72 | 65 1/2 x 77 1/2 |
| 6096 | 60 x 96 | 65 1/2 x 101 1/2 |
| 7272 | 72 x 72 | 77 1/2 x 77 1/2 |

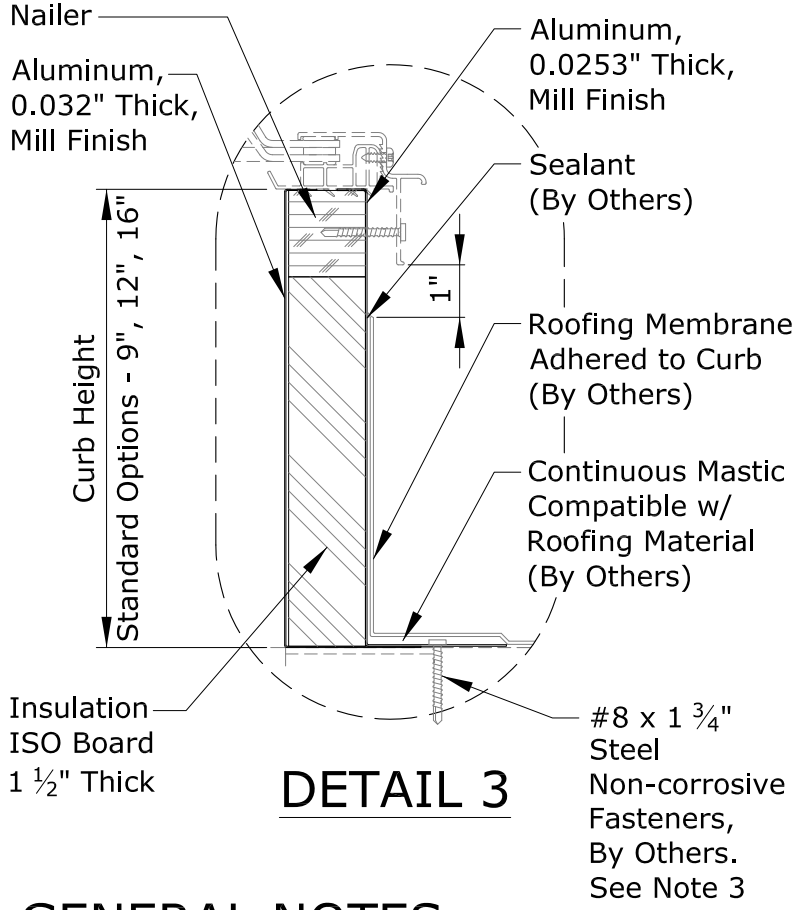

DETAIL 1

DETAIL 2

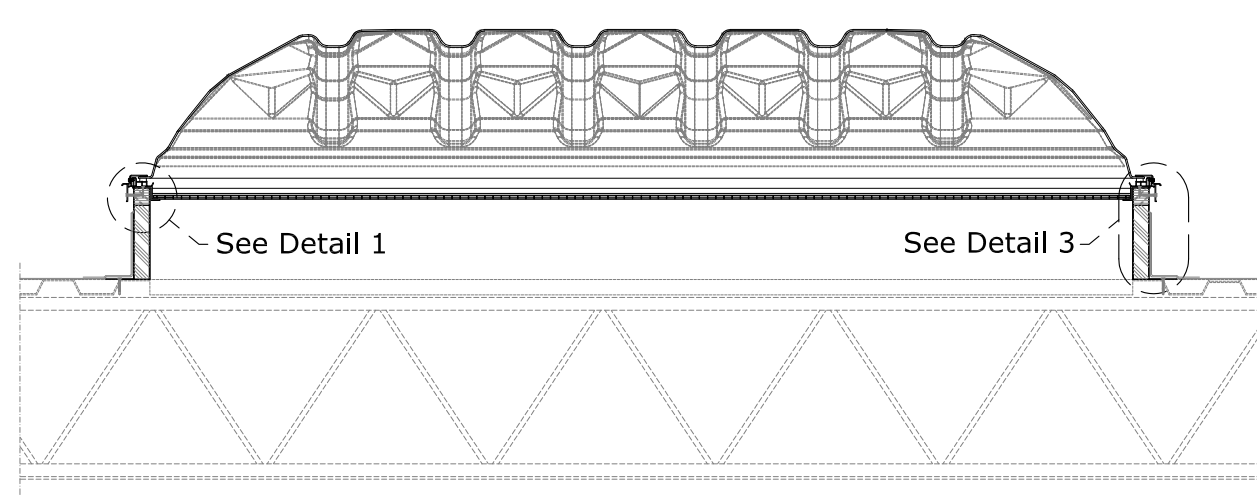

SECTION A-A

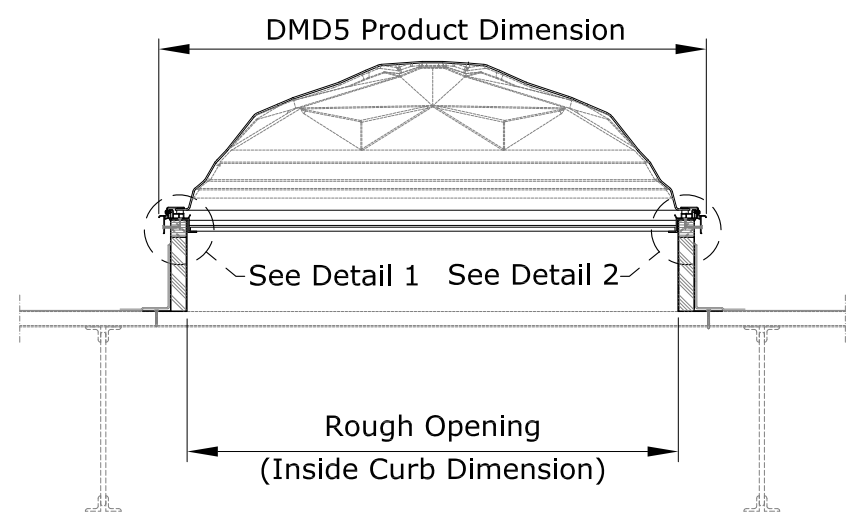

SECTION B-B

GENERAL NOTES

1. This drawing emphasizes the VELUX DMD5 Deck Mount Dynamic Dome+Security Bars w/ Lumira Skylight. It illustrates a general arrangement layout (plus recommendations) for a VELUX DMD5 installation in a 0-60 degree roof pitch application. VELUX DMD5 skylights are shipped on VELUX curb designs.
2. The architectural/structural design and specifications for the inclusion of a commercial skylight, such as the VELUX DMD5 in any roofing/ceiling application is determined and provided by others. The design criteria includes, but is not limited to design loads, structural configurations, structural framing member sizes and material, architectural finishes and integration with the roofing/ceiling systems of the building. VELUX recommends compliance by all designers and installers with all local and industry specific building codes and guidelines. VELUX assumes no responsibility or liability in the design, construction and performance of a building structure by others.
3. The fasteners securing the curb to the rough opening are provided by others. VELUX recommends #8 x 1-3/4" steel non-corrosive fasteners. The fasteners should be placed in the center of the curb flange 4" from each corner and 12" on center for the length and width of the deck mounted skylight.

This drawing is an instrument of service and is provided for informational use only.



Sky-Global Product Management

VELUX
1418 Evans Pond Road
Greenwood, SC 29649
1-800-88-VELUX
www.VELUXUSA.com

DMD5 Deck Mount Dynamic Dome + Security Bars w/ Lumira Skylight