

## DMD3 Deck Mount Dynamic Triple Dome Skylight

Dynamic Triple Dome Options				
Size - Width x Length (using Inside Curb Dimensions)	Quantity	Dome Material*	Dome Description and Designation	
		LuxGuard 0.118 PC over 0.118 PC over 0.118 PC	Clear Smooth/Clear Smooth/White Prismatic (P1C2) Clear Smooth/Clear Smooth/Clear Smooth (P1P1)	Max size 6012 & 7272
		0.118 PC over 0.118 PC over 0.118 Acrylic	Clear Smooth/Clear Smooth/Satin Ice (P1H1)	Max size 6096 & 7272
		Infrared Blocking Acrylic 0.118 Acrylic over 0.118 Acrylic over 0.118 Acrylic	Satin Sky 2 / Clear Acrylic / Clear Acrylic (P1A1)	Max size 6012 & 7272
			Satin Sky 2 / Clear Acrylic / Satin Ice (P1H1)	Max size 6096 & 7272

\*Note: Dome Material thickness is sheet material's thickness prior to the manufacturing process.

Frame Finish Options	
<input type="checkbox"/> Mill Finish	<input type="checkbox"/> Neutral Gray Powder Coat

Standard Curb Heights		
<input type="checkbox"/> 9"	<input type="checkbox"/> 12"	<input type="checkbox"/> 16"

DMD3 Dimensions (inches)		
Size	Rough Opening (Inside Curb)	Product Dimension
2412	24 x 120	29 1/2 x 125 1/2
2448	24 x 48	29 1/2 x 53 1/2
2496	24 x 96	29 1/2 x 101 1/2
3012	30 x 120	35 1/2 x 125 1/2
3612	36 x 120	41 1/2 x 125 1/2
3636	36 x 36	41 1/2 x 41 1/2
3660	36 x 60	41 1/2 x 65 1/2
3672	36 x 72	41 1/2 x 77 1/2
3696	36 x 96	41 1/2 x 101 1/2
4783	47 x 83	52 1/2 x 88 1/2
4812	48 x 120	53 1/2 x 125 1/2
4848	48 x 48	53 1/2 x 53 1/2
4860	48 x 60	53 1/2 x 65 1/2
4872	48 x 72	53 1/2 x 77 1/2
4896	48 x 96	53 1/2 x 101 1/2
5060	59 1/2 x 71 1/2	65 x 77
6012	60 x 120	65 1/2 x 125 1/2
6060	60 x 60	65 1/2 x 65 1/2
6072	60 x 72	65 1/2 x 77 1/2
6096	60 x 96	65 1/2 x 101 1/2
7272	72 x 72	77 1/2 x 77 1/2

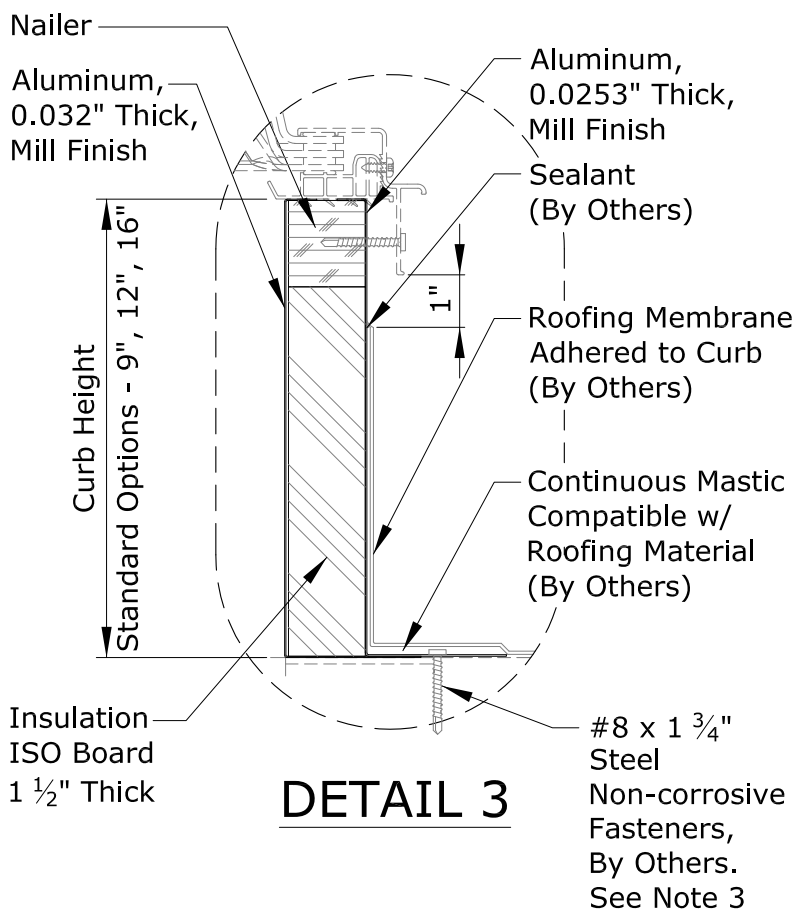

DETAIL 1

DETAIL 2

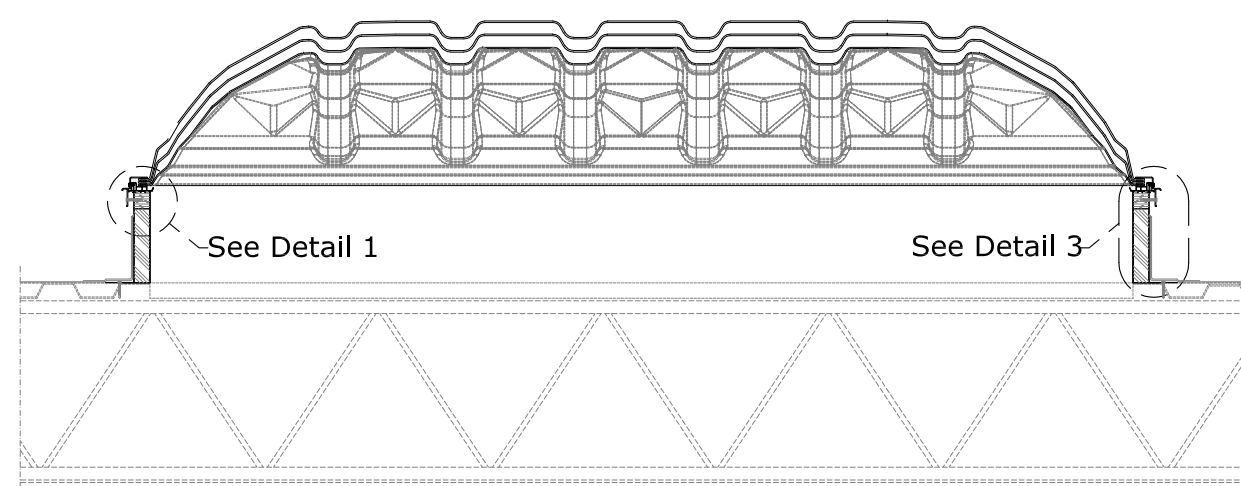

SECTION A-A

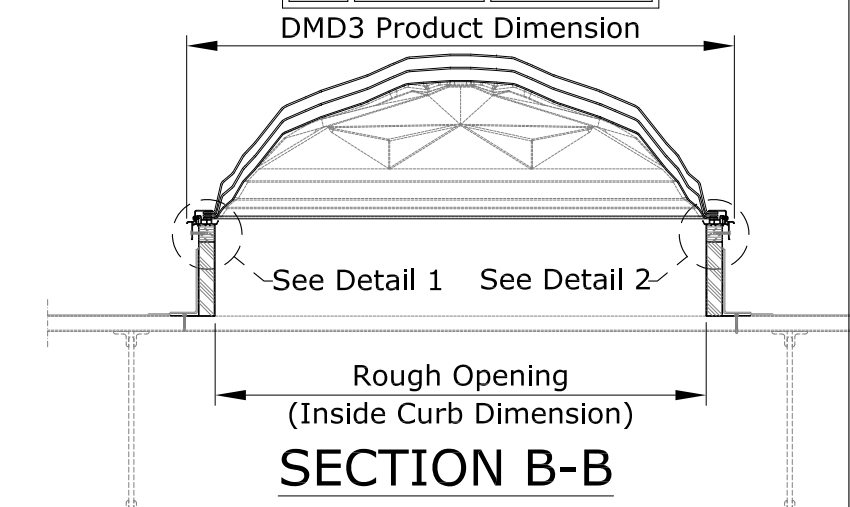

SECTION B-B

## GENERAL NOTES

1. This drawing emphasizes the VELUX DMD3 Deck Mount Dynamic Triple Dome Skylight. It illustrates a general arrangement layout (plus recommendations) for a VELUX DMD3 installation in a 0-60 degree roof pitch application. VELUX DMD3 skylights are shipped on VELUX curb designs.
2. The architectural/structural design and specifications for the inclusion of a commercial skylight, such as the VELUX DMD3 in any roofing/ceiling application is determined and provided by others. The design criteria includes, but is not limited to design loads, structural configurations, structural framing member sizes and material, architectural finishes and integration with the roofing/ceiling systems of the building. VELUX recommends compliance by all designers and installers with all local and industry specific building codes and guidelines. VELUX assumes no responsibility or liability in the design, construction and performance of a building structure by others.
3. The fasteners securing the curb to the rough opening are provided by others. VELUX recommends #8 x 1-3/4" steel non-corrosive fasteners. The fasteners should be placed in the center of the curb flange 4" from each corner and 12" on center for the length and width of the deck mounted skylight.

This drawing is an instrument of service and is provided for informational use only.



VELUX  
1418 Evans Pond Road  
Greenwood, SC 29649  
1-800-88-VELUX  
www.VELUXUSA.com

## DMD3 Deck Mount Dynamic Triple Dome Skylight