

DMD2 Deck Mount Dynamic Double Dome Skylight

Dynamic Double Dome Options				
Size - Width x Length (using Inside Curb Dimensions)	Quantity	Dome Material*	Dome Description and Designation	
		IMA 0.150 100% IMA over 0.118 50% IMA	Clear Smooth / Prismatic White (S1N2)	Max size 6012
		LuxGuard Plus 0.150 PC over 0.118 PC	Clear / White Smooth (X1P2)	Max size 6096
		LuxGuard 0.118 PC over 0.118 PC Or 0.118 Acrylic	Clear PC / White Prismatic PC (P1C2) Clear PC / White Smooth PC (P1P2) Clear PC / Clear Smooth PC (P1P1) Clear PC / Satin Ice Acrylic (P1H1)	Max size 6012 Max size 6096 Max size 7272
		Infrared Blocking Acrylic 0.118 over 0.118 Acrylic	Satin Sky 2 / Clear Smooth (E2A1) Satin Sky 2 / White Smooth (E2A2)	Max size 6012 Max size 7272

*Note: Dome Material thickness is sheet material's thickness prior to the manufacturing process.

Frame Finish Options

☐ Mill Finish

☐ Neutral Gray Powder Coat

Standard Curb Heights

☐ 9"

☐ 12"

☐ 16"

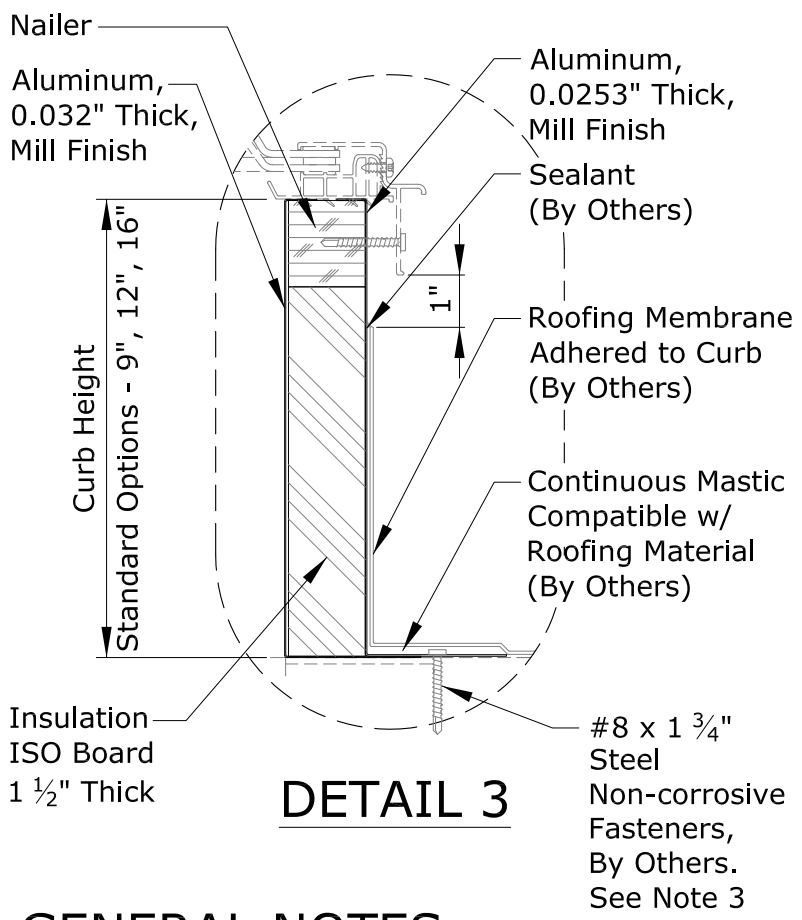

DETAIL 1

DETAIL 2

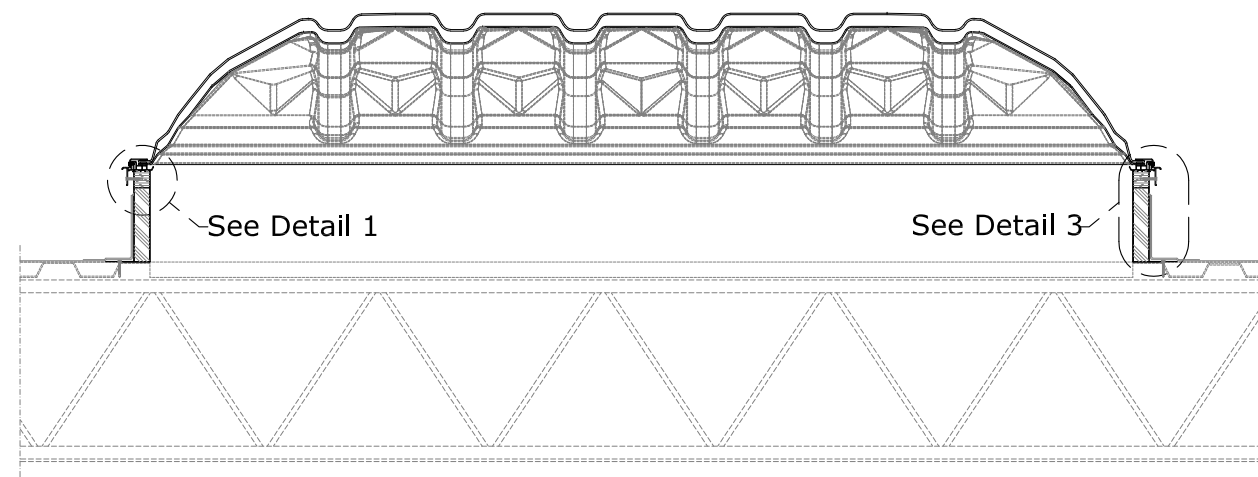

SECTION A-A

DMD2 Dimensions (inches)		
Size	Rough Opening (Inside Curb)	Product Dimension
2412	24 x 120	29 1/2 x 125 1/2
2448	24 x 48	29 1/2 x 53 1/2
2496	24 x 96	29 1/2 x 101 1/2
3012	30 x 120	35 1/2 x 125 1/2
3612	36 x 120	41 1/2 x 125 1/2
3636	36 x 36	41 1/2 x 41 1/2
3660	36 x 60	41 1/2 x 65 1/2
3672	36 x 72	41 1/2 x 77 1/2
3696	36 x 96	41 1/2 x 101 1/2
4783	47 x 83	52 1/2 x 88 1/2
4812	48 x 120	53 1/2 x 125 1/2
4848	48 x 48	53 1/2 x 53 1/2
4860	48 x 60	53 1/2 x 65 1/2
4872	48 x 72	53 1/2 x 77 1/2
4896	48 x 96	53 1/2 x 101 1/2
5060	59 1/2 x 71 1/2	65 x 77
6012	60 x 120	65 1/2 x 125 1/2
6060	60 x 60	65 1/2 x 65 1/2
6072	60 x 72	65 1/2 x 77 1/2
6096	60 x 96	65 1/2 x 101 1/2
7272	72 x 72	77 1/2 x 77 1/2

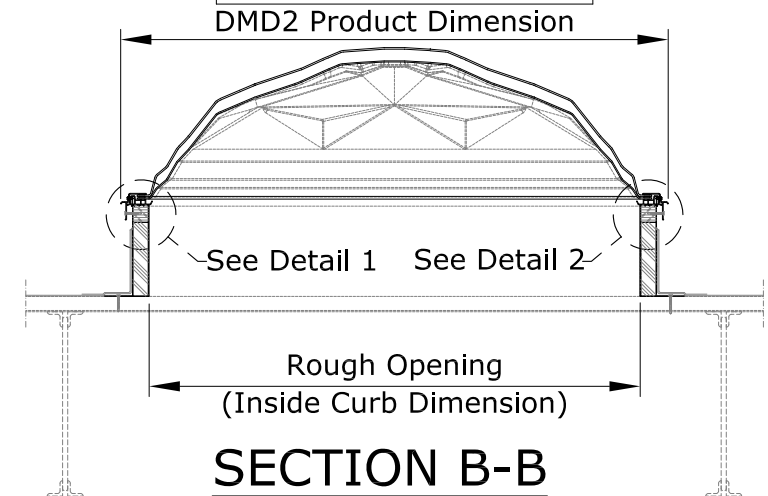

SECTION B-B

GENERAL NOTES

1. This drawing emphasizes the VELUX DMD2 Deck Mount Dynamic Double Dome Skylight. It illustrates a general arrangement layout (plus recommendations) for a VELUX DMD2 installation in a 0-60 degree roof pitch application. VELUX DMD2 skylights are shipped on VELUX curb designs.
2. The architectural/structural design and specifications for the inclusion of a commercial skylight, such as the VELUX DMD2 in any roofing/ceiling application is determined and provided by others. The design criteria includes, but is not limited to design loads, structural configurations, structural framing member sizes and material, architectural finishes and integration with the roofing/ceiling systems of the building. VELUX recommends compliance by all designers and installers with all local and industry specific building codes and guidelines. VELUX assumes no responsibility or liability in the design, construction and performance of a building structure by others.
3. The fasteners securing the curb to the rough opening are provided by others. VELUX recommends #8 x 1-3/4" steel non-corrosive fasteners. The fasteners should be placed in the center of the curb flange 4" from each corner and 12" on center for the length and width of the deck mounted skylight.

This drawing is an instrument of service and is provided for informational use only.



Sky-Global Product Management

VELUX
1418 Evans Pond Road
Greenwood, SC 29649
1-800-88-VELUX
www.VELUXUSA.com

DMD2 Deck Mount Dynamic Double Dome Skylight