

Instructions for Adjusting AR Gymatic Unloader Valves

Please follow these easy steps to adjust the pressure:

- Step 1: Remove black cap (pos. #1) from knob.
 - Step 2: Loosen bolt (pos. #2) with 6mm hex wrench.
 - Step 3: Loosen nut (pos. #3) to top of (pos. #2) bolt.
 - Step 4: Turn the black knob (pos. #4) clockwise until it stops.
 - Step 5: Start pump, watch pressure gauge and turn (pos. #2) bolt until recommended/rated pressure is obtained.
 - Step 6: Release trigger and make sure there is minimal spike (300-400 psi) (Repeat this step two or three times)
 - Step 7: Spin (pos. #3) nut down. While holder (pos. #2) bolt in place with hex wrench, use special tool (AR1560590) Or extended 13mm socket wrench to hand tighten (pos. #3) nut against (pos. #4) black knob.
 - Step 8: Replace (pos. #1) black cap.
- NOTE: Now pressure can be decreased by turning black knob (pos. #4) counterclockwise, but the pressure cannot be increased to a rating higher than what max is set at by technician.

Mounting Bolt Torque Specifications

Inlet	354 in/lbs	30 ft/lbs
Discharge	221 in/lbs	19 ft/lbs

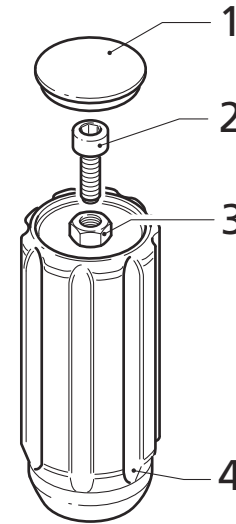

AR1560590

Nut holder for adjusting Gymatic Unloader