



ARCHITECTURAL
IRON DESIGNS, INC.

authorized dealer of

CABLE·RAIL®
by feeney®

Cable Assemblies for Metal and Wood Applications

Each assembly includes the selected length of type 316 stainless steel cable with a Threaded Terminal fitting pre-attached to one end, one stainless steel Quick-Connect®SS fitting, two nylon flat washers, and one stainless steel Snug-Grip® washer-nut.

Select a preferred end cap style to cover, protect, and finish each end. End caps sold separately; see accessories section.



Cable assembly packages

1/8" Standard Assemblies

- Our most popular and cost effective cable option
- Perfect for all residential and light commercial projects
- Can be installed on wood or metal frames

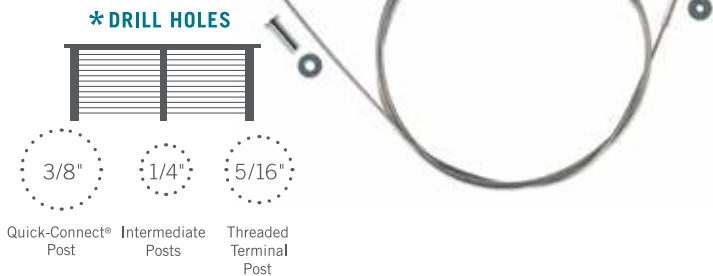

metal posts

ASSEMBLY LENGTHS	MODEL*
5'	6205-pkg
10'	6210-pkg
15'	6215-pkg
20'	6220-pkg
25'	6225-pkg
30'	6230-pkg
35'	6235-pkg
40'	6240-pkg
45'	6245-pkg
50'	6250-pkg
55'	6255-pkg
60'	6260-pkg
65'	6265-pkg
70'	6270-pkg

*With 4 1/4" terminal for metal posts

wood posts

ASSEMBLY LENGTHS	MODEL*
5'	6305-pkg
10'	6310-pkg
15'	6315-pkg
20'	6320-pkg
25'	6325-pkg
30'	6330-pkg
35'	6335-pkg
40'	6340-pkg
45'	6345-pkg
50'	6350-pkg
55'	6355-pkg
60'	6360-pkg
65'	6365-pkg
70'	6370-pkg

*With 7 1/2" terminal for wood posts

3/16" Standard Assemblies

- Extra durable option for commercial and residential settings
- Can be installed on wood or metal frames

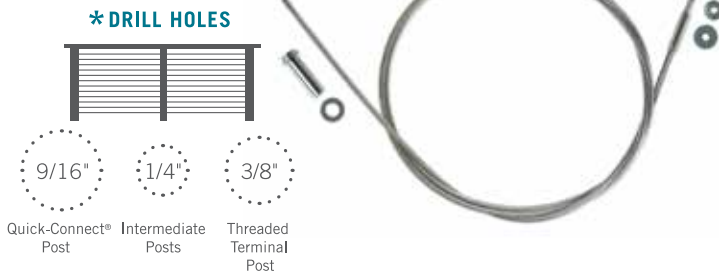

ASSEMBLY LENGTHS	MODEL*
5'	6705-pkg
10'	6710-pkg
15'	6715-pkg
20'	6720-pkg
25'	6725-pkg
30'	6730-pkg
35'	6735-pkg
40'	6740-pkg
45'	6745-pkg
50'	6750-pkg
55'	6755-pkg
60'	6760-pkg
65'	6765-pkg
70'	6770-pkg

*With 4 1/4" terminal for metal posts

ASSEMBLY LENGTHS	MODEL*
5'	6805-pkg
10'	6810-pkg
15'	6815-pkg
20'	6820-pkg
25'	6825-pkg
30'	6830-pkg
35'	6835-pkg
40'	6840-pkg
45'	6845-pkg
50'	6850-pkg
55'	6855-pkg
60'	6860-pkg
65'	6865-pkg
70'	6870-pkg

*With 7 1/2" terminal for wood posts

1/4" Standard Assemblies

- Largest, most durable option for high-traffic, high-wear commercial locations
- Also for railing designs where the "look" of a larger cable is desired
- Recommended for metal railing frames only

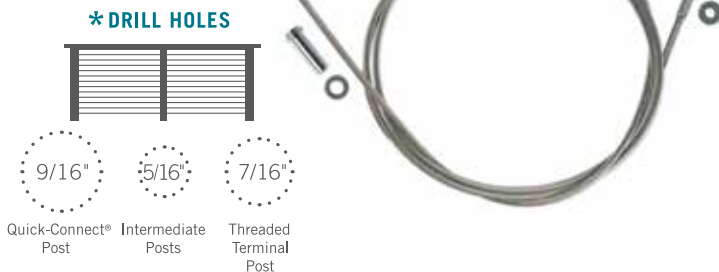

ASSEMBLY LENGTHS	MODEL*
5'	6905-pkg
10'	6910-pkg
15'	6915-pkg
20'	6920-pkg
25'	6925-pkg
30'	6930-pkg
35'	6935-pkg
40'	6940-pkg
45'	6945-pkg
50'	6950-pkg
55'	6955-pkg
60'	6960-pkg
65'	6965-pkg
70'	6970-pkg

*With 4 1/4" terminal for metal posts



CableRail Assemblies are designed to be used on your own wood or metal frames in either interior or exterior settings.

Cable accessories for metal and wood applications

STAINLESS PROTECTOR SLEEVES (wood posts only)

For protecting corner and stairway transition posts from cable abrasion. Sold 10 per package

3210-pkg 1/4"OD x 7/8"long,
(fits 1/4" diameter drill holes)



STAINLESS BEVELED WASHERS

For providing a flat bearing surface when attaching fittings at angled stair terminations.



For 1/8" Cable

Sold 4 per package.

3799-pkg For 1/8" Threaded Terminal (3/4"OD x 9/32"ID)

3792-pkg For 1/8" Quick-Connect®SS (3/4"OD x 3/8"ID)

For 3/16" Cable

Sold 4 per package.

3799-pkg For 3/16" Threaded Terminal (3/4"OD x 9/32"ID)

Sold Individually

3798 For 3/16" Quick-Connect®SS (3/4" OD x 9/16" ID)

For 1/4" Cable

Sold 4 per package.

3792-pkg For 1/4" Threaded Terminal (3/4"OD x 3/8"ID)

Sold Individually

3798 For 1/4" Quick-Connect®SS (3/4" OD x 9/16" ID)

RUBBER GROMMET FOR 1/8" CABLE

For eliminating direct contact of dissimilar metals to minimize electrolysis when attaching cables and fittings to metal posts in areas with salt air or similar harsh elements



For 1/8" Cable

3213 1/4" OD x 3/16" groove, 7/16" flange

ISOLATION BUSHINGS

For eliminating direct contact of dissimilar metals to minimize electrolysis when attaching cables and fittings to metal posts in areas with salt air or similar harsh elements.



Part #	Used On	Size	Hole Ø
For 1/8" Cable			
1100	1/8" Quick-Connect®SS	3/8" ID x 15/32" OD, 11/16" flange	15/32"
1101	1/8" Cable	3/16" ID x 1/4" OD, 3/8" flange	1/4"
1102	1/8" Threaded Terminal	1/4" ID x 5/16" OD, 1/2" flange	5/16"
For 3/16" Cable			
1103	3/16" Quick-Connect®SS	35/64" ID x 5/8" OD, 55/64" flange	5/8"
1102	3/16" Cable	1/4" ID x 5/16" OD, 1/2" flange	5/16"
1100	3/16" Threaded Terminal	3/8" ID x 15/32" OD, 11/16" flange	15/32"
For 1/4" Cable			
1103	1/4" Quick-Connect®SS	35/64" ID x 5/8" OD, 55/64" flange	5/8"
1104	1/4" Cable	9/32" ID x 23/64" OD, 19/32" flange	23/64"
1105	1/4" Threaded Terminal	7/16" ID x 17/32" OD, 3/4" flange	17/32"

STAINLESS END CAPS

Decorative option for covering and finishing QuickConnect®SS fittings and Snug-Grip® Washer Nuts. Sold 4 per package.

3372-pkg Dome Style, 3/4"OD x 3/8"H

3373-pkg Crown Style, 3/4"OD x 3/8"H

3374-pkg Chamfer Style, 3/4"OD x 3/8"H



COLORED END CAPS (POLYETHYLENE) Decorative option for covering and finishing Quick-Connect®SS fittings and Snug-Grip® Washer Nuts.

Sold 10 per package.

7071-pkg Black, 3/4"OD x 3/8"H

7072-pkg White, 3/4"OD x 3/8"H

7073-pkg Brown, 3/4"OD x 3/8"H

7074-pkg Gray, 3/4"OD x 3/8"H



QUICK-CONNECT® RELEASE TOOL

For temporarily releasing the jaws of the Quick-Connect®SS fitting to remove or adjust the position. Reusable.

Sold 1 per package.

3128-pkg For 1/8" Quick-Connect®

3158-pkg For 3/16" Quick-Connect®

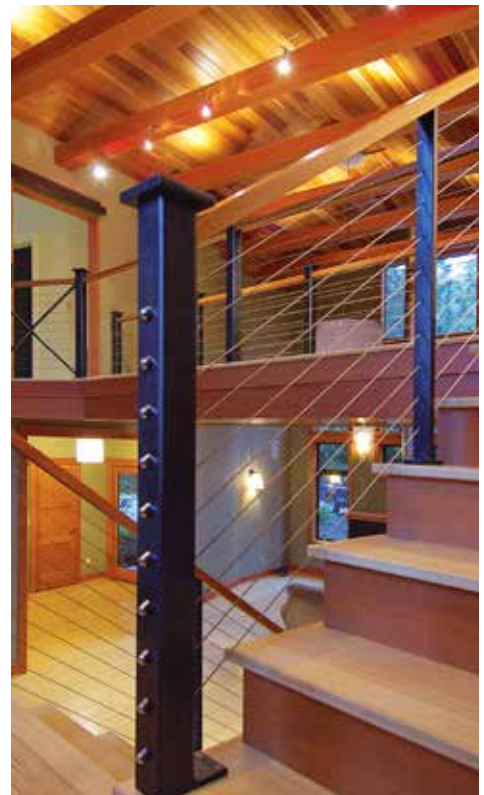

CABLERAIL BY FEENEY®

Custom Cable Assemblies

Projects with special installation conditions or design considerations may require certain styles of cable and fittings not addressed by our CableRail Standard Cable Assemblies. To fulfill those specific design and function needs, we offer an assortment of cables, turnbuckles, terminals, adjusters, and fixed ends for custom assemblies.

1x19 CONSTRUCTION CABLES

19 individual wires twisted into a single semi-flexible strand. Excellent for railings, fences, and trellises with straight runs or slight bends.

Sold by the foot.

4140-1/8" 1/8" Cable
4117-3/16" 3/16" Cable

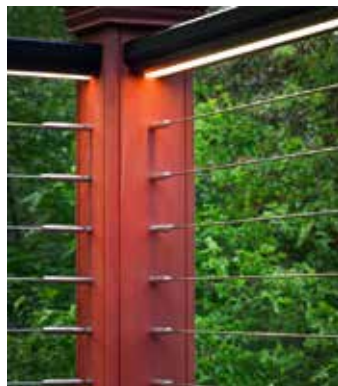

Quick-Connect® cable fittings come in two types.

Fixed Ends (FE) are non-adjustable end termination fittings that have no tensioning capabilities. Therefore, each Fixed End must be paired with a Tension Adjustment Fitting.

Tension Adjustment Fittings (TAF) include Threaded Terminals, Turnbuckles and Adjusters that are used to tighten the cable lines.

Every cable assembly must have at least one Tension Adjustment Fitting.

Quick-Connect® Fixed End Fittings

THE ORIGINAL QUICK-CONNECT®SS

Fits into a hole drilled in end post, and the lip rests against the outside post face.

3146 For 1/8" Cable
3147 For 3/16" Cable
3148 For 1/4" Cable



QUICK-CONNECT® FIXED SURFACE MOUNT

Attaches to the face of a wall or post using screws or bolts.

9903 For 1/8" Cable
9803 For 3/16" Cable



QUICK-CONNECT® LAG

Combines a lag thread hanger bolt with a Quick-Connect® Body. Screws into the face of a wood post. Can be paired with any Tension Adjustment Fitting.

9905 For 1/8" Cable
9805 For 3/16" Cable



QUICK-CONNECT® PIVOT

Screws into the face of a wood post or wall using a hanger bolt with lag thread (included). 180° pivoting allows for angled stair terminations.

9915 For 1/8" Cable
9815 For 3/16" Cable



Quick-Connect® Tension Adjustment Fittings

QUICK-CONNECT® THREADED TERMINAL

Inserts through a drill hole in the post and is secured and adjusted with a washer nut.

9904 For 1/8" Cable
9804 For 3/16" Cable



QUICK-CONNECT® SURFACE MOUNT TURNBUCKLE

Attaches to the face of a wall or post using screws or bolts.

9902 For 1/8" Cable



QUICK-CONNECT® LAG SWIVEL TURNBUCKLE

Screws into the face of a wood post using a hanger bolt with lag thread (included). Tension adjusted by spinning the special swiveling turnbuckle body.

9910 For 1/8" Cable
9810 For 3/16" Cable



QUICK-CONNECT® PIVOT SWIVEL TURNBUCKLE

Screws into the face of a wood post or wall using a hanger bolt with lag thread (included). Tension adjusted by spinning the special swiveling turnbuckle body. 180° pivoting allows for angled stair terminations.

9916 For 1/8" Cable 9816 For 3/16" Cable

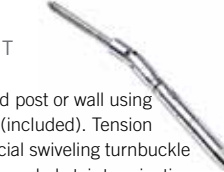

Cable accessories for metal and wood applications

CABLERAIL TENSIONING TOOL

Tensioning Tool includes the 1/8-in. diameter cable adapter head. Sold 1 per package 6005-pkg



TENSIONING TOOL ADAPTER

5071 For 3/16" and 1/4" cable

TENSION GAUGE

Designed for use on applications using 1/8, 3/16, and 1/4 inch sized cables with 1x19 construction. Sold 1 per package 6004-pkg



CABLE LACING NEEDLE

For quickly lacing cable ends through posts without snagging. 4-1/2" long. Resuable.

Sold 1 per package.
3221-pkg For 1/8" cable
3222-pkg For 3/16" cable
3223-pkg For 1/4" cable



CABLE CUTTERS

For shearing excess cable. Sold 1 per package.

2972-pkg For cable up to 1/8", 8" long, coated handles, hardened jaws



2971 For cable up to 1/4", 13" long, coated handles, hardened jaws



FEENEY STEELRENEWAL™ + STEELPROTECT™ COMBO

Stainless Steel Cleaner and Protectant Combination Pack.

Sold 1 kit per package

Kit contains:

- 1 Bottle Feeney SteelRenewal™ cleaner (100 ml.)
- 1 Bottle Feeney SteelProtect™ protectant (100 ml.)
- Applicator brush for cleaner
- Applicator sponge for protectant
- Protection gloves

5064-pkg



Prefabricated posts with adjustable saddle in 316 stainless steel



36" ROUND POSTS FOR FLOOR MOUNT

49-36-F-SM-A-AS	1/8" Cable Flange Anchor Post
49-36-F-SM-R-AS	1/8" Cable Flange Receiver Post
49-36-F-MD-A-AS	3/16" Cable Flange Anchor Post
49-36-F-MD-R-AS	3/16" Cable Flange Receiver Post
49-36-F-B-C-AS	Cable Flange Center Post
49-36-F-B-S-AS	Cable Flange Stair Center Post
49-36-F-B-L-SF	Cable Flange Corner Post

42" ROUND POSTS FOR FLOOR MOUNT

49-42-F-SM-A-AS	1/8" Cable Flange Anchor Post
49-42-F-SM-R-AS	1/8" Cable Flange Receiver Post
49-42-F-MD-A-AS	3/16" Cable Flange Anchor Post
49-42-F-MD-R-AS	3/16" Cable Flange Receiver Post
49-42-F-B-C-AS	Cable Flange Center Post
49-42-F-B-S-AS	Cable Flange Stair Center Post
49-42-F-B-L-SF	Cable Flange Corner Post



36" ROUND POSTS FOR FASCIA MOUNT

49-36-W-SM-A-AS	1/8" Cable Fascia Anchor Post
49-36-W-SM-R-AS	1/8" Cable Fascia Receiver Post
49-36-W-MD-A-AS	3/16" Cable Fascia Anchor Post
49-36-W-MD-R-AS	3/16" Cable Fascia Receiver Post
49-36-W-B-C-AS	Cable Fascia Center Post
49-36-W-B-S-AS	Cable Fascia Stair Center Post

42" ROUND POSTS FOR FASCIA MOUNT

49-42-W-SM-A-AS	1/8" Cable Fascia Anchor Post
49-42-W-SM-R-AS	1/8" Cable Fascia Receiver Post
49-42-W-MD-A-AS	3/16" Cable Fascia Anchor Post
49-42-W-MD-R-AS	3/16" Cable Fascia Receiver Post
49-42-W-B-C-AS	Cable Fascia Center Post
49-42-W-B-S-AS	Cable Fascia Stair Center Post

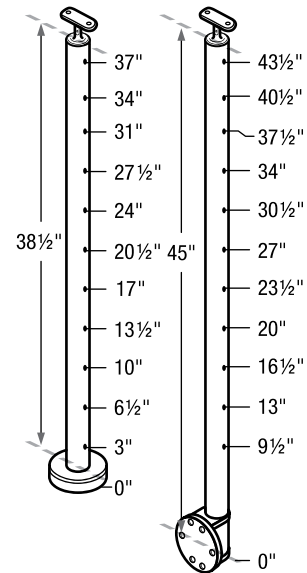
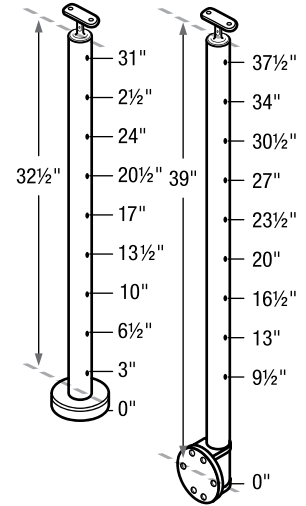

36" SQUARE POSTS FOR FLOOR MOUNT

49-36-F-E-AS	Cable End Post Floor Mount
49-36-F-C-AS	Cable Center Post Floor Mount
49-36-F-CS-AS	Cable Center Stair Post Floor Mount

42" SQUARE POSTS FOR FLOOR MOUNT

49-42-F-E-AS	Cable End Post Floor Mount
49-42-F-C-AS	Cable Center Post Floor Mount
49-42-F-CS-AS	Cable Center Stair Post Floor Mount

Metal Frame Requirements

Railing frames need to be designed and built strong enough to support the tension of properly installed cables, which is a load in excess of 300 lbs for each cable. Here are some basic guidelines to help you properly prepare your railing frames. These guidelines apply whether you are using 1/8", 3/16" or 1/4" cable.

Minimum sizes for all corner and end posts

All other posts should be sized as required for cap rail support strength or for code



FLAT BAR
2" wide, 1" thick



ANGLE IRON
2" wide, 1/2" thick



EXTRA STRONG PIPE
1-1/2" ID, 1-7/8" OD



SQUARE TUBE
2" wide, 1/4" wall

The Basic Frame Design

Spacing From Walls:

Set end posts 3 to 4 inches away from the house/wall face to allow access for attaching cable end fittings.

End Posts:

Use minimum end post sizes noted above, and securely bolt or screw to joists or deck surface.

Cap Rail:

Always include a strong, rigid cap rail that is securely fastened to all posts. Cap size is based on load strength needs and local code requirements. Set railing height per local code.

IMPORTANT NOTE

For railings we recommend spacing the cables no more than 3 inches apart and placing posts or vertical members no more than 3 feet apart.

Please note that since building codes vary by state, county and city, our recommendations may not comply with code requirements in all areas.

Always consult with your local building department before starting your project.

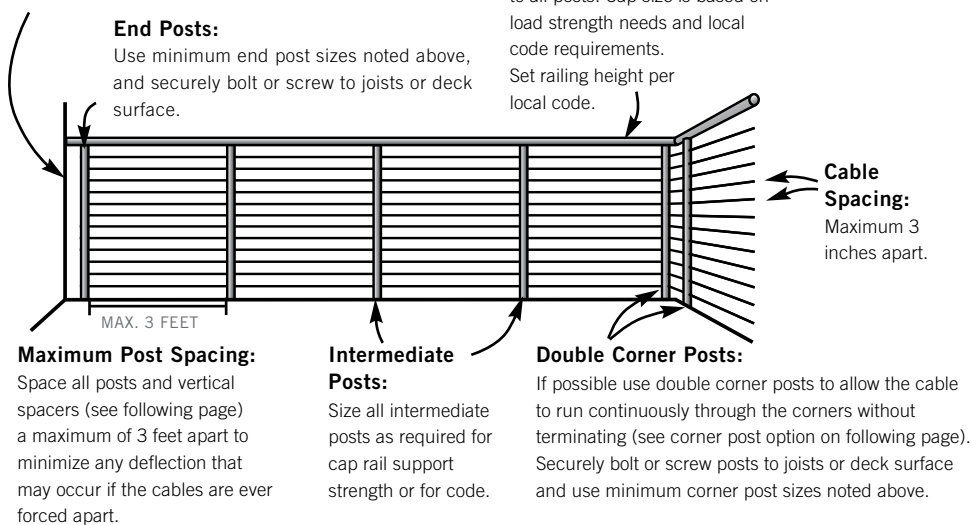

CABLE ASSEMBLY CARE & MAINTENANCE

The protective chromium oxide film on the surface of stainless steel gives it superior corrosion resistance. Properly maintained stainless steel provides excellent luster, strength, and durability. In most applications stainless steel will not rust or stain even after many years of service, but it is NOT rust or stain proof. When stainless comes in contact with chloride salts, sulfides, or other rusting metals, it can discolor or even rust and corrode. With proper care and maintenance, however, stainless steel can remain beautiful and functional for years to come.

- Clean stainless with soap and warm water. Never clean with mineral acids or bleaches.
- Never use coarse abrasives like sandpaper or steel wool on stainless. Use synthetic Scotch pads instead.
- Never leave stainless in contact with iron, steel, or other metals. This can cause rust spots or corrosion.
- Always remove stains or rust spots as soon as possible with either soap and water or a brass, silver, stainless, or chrome cleaner.
- Periodically inspect cable assemblies for proper tension and re-tension as necessary. This is important.



Step-by-Step Installation for Metal Frames

Installing the Standard 1/8" Cable System is easy. Just follow these simple steps:

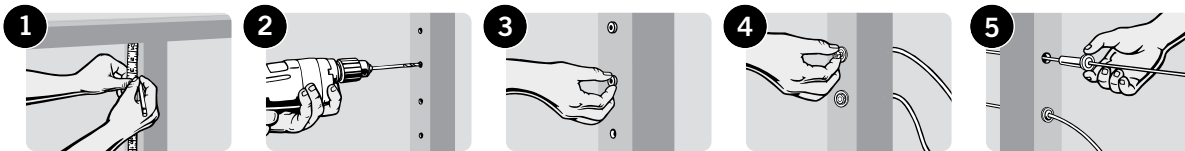

1 Mark drill hole locations on posts.

To minimize cable deflection, space cables no more than 3 inches apart and have a post or vertical spacer at least every 3 feet. Also, straight runs of cable (no turns/dips) should not exceed 70 feet. Runs with corners (2 bends at most) should not exceed 40 feet. (See Frame Requirements on previous page.)

2 Drill holes in posts. Hole diameter depends on cable size and type of fitting. See chart below.

Cable Size	Threaded Term. Post	Intermediate Posts	Quick-Connect Post
1/8"	5/16"	1/4"	3/8"
3/16"	3/8"	1/4"	9/16"
1/4"	7/16"	5/16"	9/16"

If desired, Quick-Connect®SS posts may be through drilled at 5/16" and then counter-bored with the recommended Quick-Connect®SS drill to countersink the fitting.

3 If using Isolation Bushings or Grommets (optional), insert them into their corresponding post holes.

Note: If using Isolation Bushings, call for special drill hole sizes.

4 Insert the Threaded Terminal through the Terminal end post and attach a flat washer and Snug-Grip® Washer-Nut. Spin the nut 2 full turns. Strong resistance will be felt as the Snug-Grip® threads engage; so hold the Terminal shaft with pliers.

5 Lace the free end of the cable through the intermediate posts and Quick-Connect®SS end post. Slide-on a flat washer and Quick-Connect®SS fitting until they rest against the face of the post.

Use a Lacing Needle if snagging becomes a problem.

Use Beveled Washers for stair termination posts with angled holes. Available for Threaded Terminal and Quick-Connect®SS fittings.

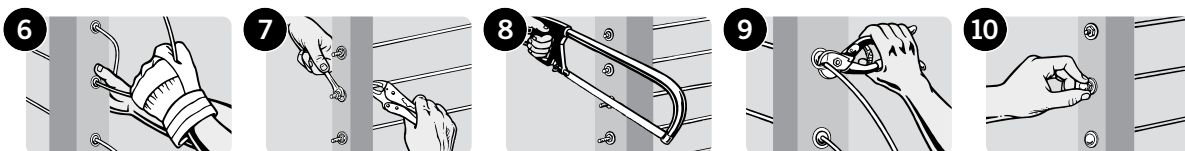
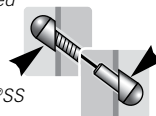

6 Hold the Quick-Connect®SS fitting with one hand and pull the cable tight with the other. The fitting automatically locks when you release the cable.

7 Tighten Snug-Grip® Washer-Nuts until you can't flex the cables more than 4 inches apart using your thumb and fingers on one hand. See diagram to the left for tensioning sequence.

Important Note: If using electric or pneumatic tools to tighten the Washer Nuts, spin the nuts very slowly otherwise they will heat-up causing the threads to seize.

8 Saw off the excess threads as close to the Snug-Grip® Washer-Nut as possible. Touch-up with electric grinder. The special Snug-Grip® threads prevent the nut from loosening.

9 Use cable cutters or cut-off disk to trim the excess cable. Grind flush the exposed cable ends with an electric grinder.

10 Snap on end caps over the exposed Quick-Connect®SS fittings and the Snug-Grip® Washer-Nuts. You're done.

SteelRenewal™ & SteelProtect™ can be used to clean and provide lasting protection of stainless steel cable and parts.

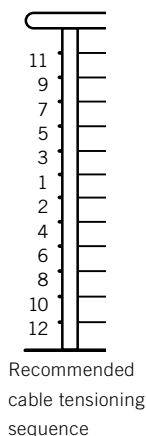

Cables can terminate or run through corner posts

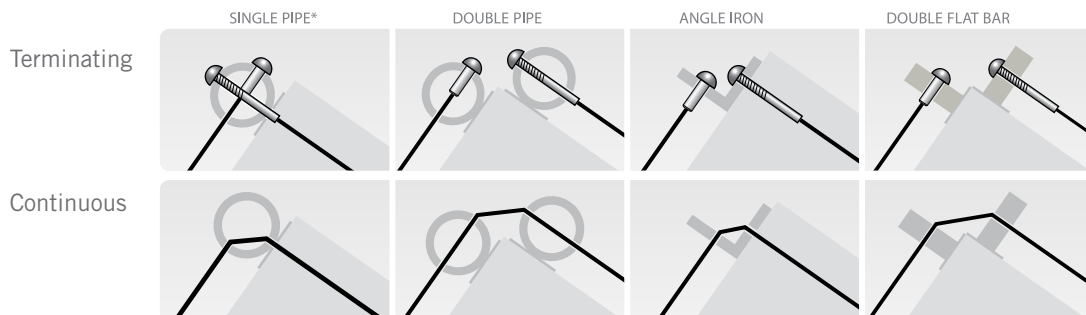

Offset drill holes at least 1/2" if you choose to have cable terminating at a single pipe post.

Wood Frame Requirements

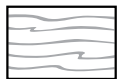

4X6 WOOD

3-1/2" wide, 5-1/2" thick

Minimum sizes for all corner and end posts

All other posts should be sized as required for cap rail support strength or for code

The Basic Frame Design

Spacing From Walls:

Set end posts 3 to 4 inches away from the house/wall face to allow access for attaching cable end fittings.

End Posts:

Use minimum end post sizes noted above, and securely bolt or screw to joists or deck surface.

Cap Rail:

Always include a strong, rigid cap rail that is securely fastened to all posts. Cap size is based on load strength needs and local code requirements. Set railing height per local code.

Cable Spacing:

Maximum 3 inches apart.

Wood Blocking (WOOD FRAMES ONLY):

Underneath the cap rail attach minimum 1"x 4" wood blocking between posts to provide additional lateral reinforcement to the posts so that they won't pull out of plumb when the cables are tensioned.

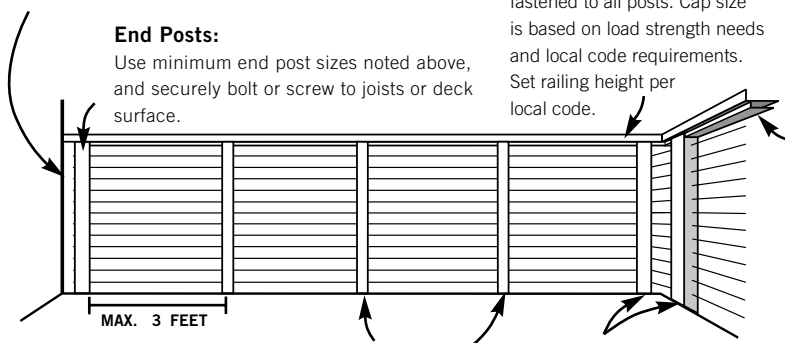

Maximum Post Spacing:

Space all posts and vertical spacers (see below) a maximum of 3 feet apart to minimize any deflection that may occur if the cables are ever forced apart.

Intermediate Posts:

Size all intermediate posts as required for cap rail support strength or for code.

Double Corner Posts:

If possible use double corner posts to allow the cable to run continuously through the corners without terminating (see single corner post option below). Securely bolt or screw posts to joists or deck surface and use minimum corner post sizes noted above.

And Some Other Options

Vertical Spacers (OPTIONAL):

Slender spacers may be used instead of some of the larger intermediate posts to achieve a more open railing design. These are non-structural members and are only intended to maintain cable spacing and minimize deflection. Examples are 2" x 2" wood strips, 1" metal tubing or 1/4" flat bar. Attach spacers to the cap rail and either the foot rail, deck surface or joists.

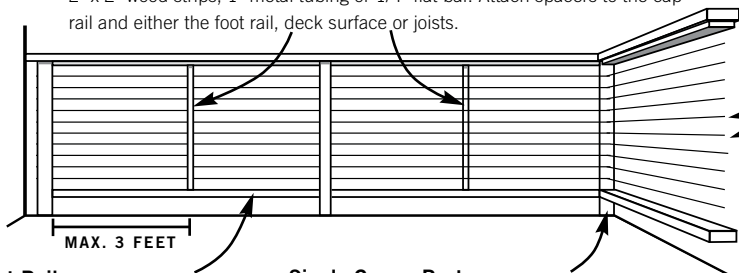

Foot Rails (OPTIONAL):

Foot rails should be spaced no more than 4 inches above the deck surface, or as required by local code, and should be sized as needed for support strength and design appearance.

Single Corner Post (OPTIONAL):

When terminating on a single corner post, be sure to offset the drill holes at least 1/2" to allow internal clearance for the cable fittings. Use minimum end post sizes noted above and securely bolt or screw to joists or deck surface.

Cable Spacing:

Maximum 3 inches apart.

CONSTRUCTION CHECKLIST

Space cables no more than 3 inches apart

Space posts/verticals no more than 3 feet apart

Observe minimum end/corner post sizes shown above

Securely fasten all posts and cap rails

Carefully plan all termination and corner posts for proper clearance, positioning, and maximum cable run lengths

Straight runs of cable (no turns/dips) should not exceed 70 feet; runs with corner bends (2 bends at most) should not exceed 40 feet

IMPORTANT NOTE

For railings we recommend spacing the cables no more than 3 inches apart and placing posts or vertical members no more than 3 feet apart.

Please note that since building codes vary by state, county and city, our recommendations may not comply with code requirements in all areas.

Always consult with your local building department before starting your project.

Step-by-Step Installation for Wood Frames

Installing the Standard 1/8" Cable System is easy. Just follow these simple steps:

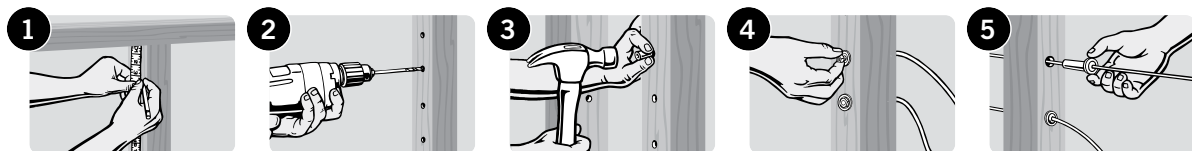

1 Mark drill hole locations on posts.

To minimize cable deflection, space cables no more than 3 inches apart and have a post or vertical spacer at least every 3 feet. Also, straight runs of cable (no turns/dips) should not exceed 70 feet. Runs with corners (2 bends at most) should not exceed 40 feet. (See Frame Requirements on previous page.)

2 Drill holes in posts. Hole diameter depends on cable size and type of fitting. See chart below.

Cable Size	Threaded Term. Post	Intermediate Posts	Quick-Connect Post
1/8"	5/16"	1/4"	3/8"
3/16"	3/8"	1/4"	9/16"

If desired, Quick-Connect®SS posts may be through drilled at 1/4" and then countersunk with the recommended Quick-Connect®SS drill to countersink the fitting.

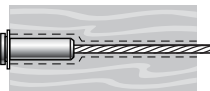

3 Insert Protector Sleeves at necessary locations. Tap in until flush.

Protector Sleeves prevent abrasion at angled transitions on wood posts (e.g. stair transition posts or outside faces of double corner posts.)

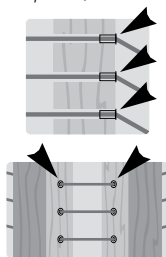

4 Insert the Threaded Terminal through the Terminal end post and attach a flat washer and Snug-Grip® Washer-Nut. Spin the nut 2 full turns. Strong resistance will be felt as the Snug-Grip® threads engage; so hold the Terminal shaft with pliers.



Use Beveled Washers for stair termination posts with angled holes. Available for Threaded Terminal and Quick-Connect®SS fittings. Always install the Quick-Connect®SS fittings in the top stair post to prevent rain water from running down the cable into the fittings.

5 Lace the free end of the cable through the intermediate posts and Quick-Connect®SS end post. Slide-on a flat washer and Quick-Connect®SS fitting until they rest against the face of the post.

Use a Lacing Needle if snagging becomes a problem.

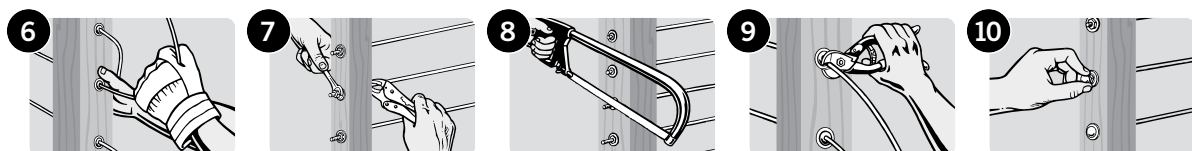

6 Hold the Quick-Connect®SS fitting with one hand and pull the cable tight with the other. The fitting automatically locks when you release the cable.

7 Tension the cables by holding the Threaded Terminal shaft with Vise-Grip pliers and spinning the Snug-Grip® Washer-Nuts with a wrench. A Feeney Tension Gauge may be used to check uniform tension.

8 Use hacksaw, reciprocating saw, or electric grinder with cut-off disk to saw off the excess threads as close to the Snug-Grip® Washer-Nut as possible. Touch-up with electric grinder. The special Snug-Grip® threads prevent the nut from loosening.

9 Use cable cutters or electric grinder with cut-off disk to trim the excess cable. Grind flush the exposed cable ends with an electric grinder.

10 Snap on end caps over the exposed Quick-Connect®SS fittings and the Snug-Grip® Washer-Nuts. You're done.

SteelRenewal™ & SteelProtect™ can be used to clean and provide lasting protection of stainless steel cable and parts.

Recommended cable tensioning sequence

Important Note: If using electric or pneumatic tools to tighten the Washer Nuts, spin the nuts very slowly otherwise they will heat-up causing the threads to seize.

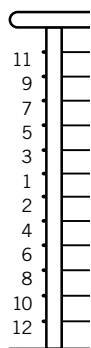

Cables can terminate or run through corner posts

Terminating

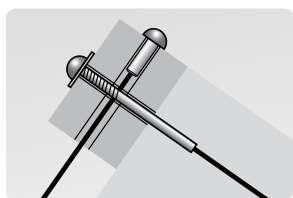

SINGLE WOOD POST
Offset drill holes at least 1/2"

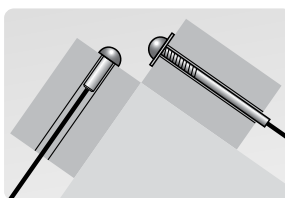

DOUBLE WOOD POSTS

Continuous

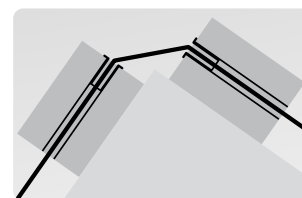

DOUBLE WOOD POSTS

Attractive ■ Versatile ■ Durable



ARCHITECTURAL IRON DESIGNS, INC.

950 South 2nd Street, Plainfield, NJ 07063

Ph: (800) 784-7444 or (908) 757-2323

Easy-to-install, prefabricated cable assemblies are an attractive, budget-friendly, and low-maintenance alternative to commonly used metal and wood picket infill. Assemblies use high-strength, weather-tough type 316 stainless steel cable and come in a wide range of standard lengths that can be quickly trimmed to size in the field. Each assembly includes special, easy-to-use Threaded Terminal and Quick-Connect[®]SS end fittings that remain concealed in your end posts. The result: an extremely durable, virtually invisible railing infill that leaves the view open and unimpaired.

Our special end fittings make cable installations quicker & easier than ever.

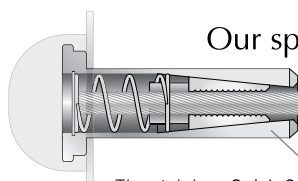

The stainless Quick-Connect[®]SS fitting is attached to the cable in the field without special tools. One-way jaws allow the cable to easily slide through the fitting in one direction but automatically grab and lock-on when the cable is released. Just slip it on, pull the cable tight, cut off the excess, and finish with an End Cap. Size: 3/8" O.D. x 1-1/4" Length

Our most popular cable is 1/8" diameter, 1x19 construction, type 316 stainless steel for strength, durability, and weather protection. Cables come in standard assembly lengths from 5 feet to 70 feet.

Snug-Grip[®] Washer-Nut and Flat Washers are all included. Colored and Stainless End Caps are also available to cover, protect, and finish both ends (caps sold separately).

The stainless Threaded Terminal fitting is fastened (swaged) to one end of the cable at the factory. Attach it to an end post using a special Snug-Grip[®] Washer-Nut and spin the nut to adjust final tension in the line. Finish with an End Cap. Size: 1/4" O.D. x 4-1/4" Length (for metal frames)

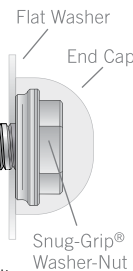

CHECK THE CABLE·RAIL[®] ADVANTAGES

- ☐ Attractive, affordable, and very low maintenance.
- ☐ Invisible appearance will not impair views.
- ☐ Made from strong and weather-tough type 316 stainless steel cable.
- ☐ Can be used on new or existing wood or metal railing frames.
- ☐ Simple, fast, do-it-yourself installation using prefabricated assemblies.
- ☐ Special easy-to-use fittings are hidden in the end posts.
- ☐ Made from over 70% recycled materials.
- ☐ Versatile uses: railings, trellises, fences, exterior, interior, residential, commercial.

10 YEAR WARRANTY

Feeney, Inc. warrants that all CableRail stainless steel cable and connectors shall be free from defects in material and workmanship under normal use, conditions, installation, and maintenance in accordance with product specifications for ten years from date of purchase. The complete text of this warranty is available upon request.